



Reimagining Wilderness

Upcycled jewelry shop & jewelry workshop

Jiayun Liao
Matter RCA ID 2022



CLED



-10 days

-1 mth

-1 mths

-3 years



-1 mth

-1 year

-5 years



-10 days

-1 mth

-1 year



-10 days

-1 mth

-1 year

-5 years



1

S I T E



2

B R A N D



3

M A T E R I A L
S T R A T E G Y

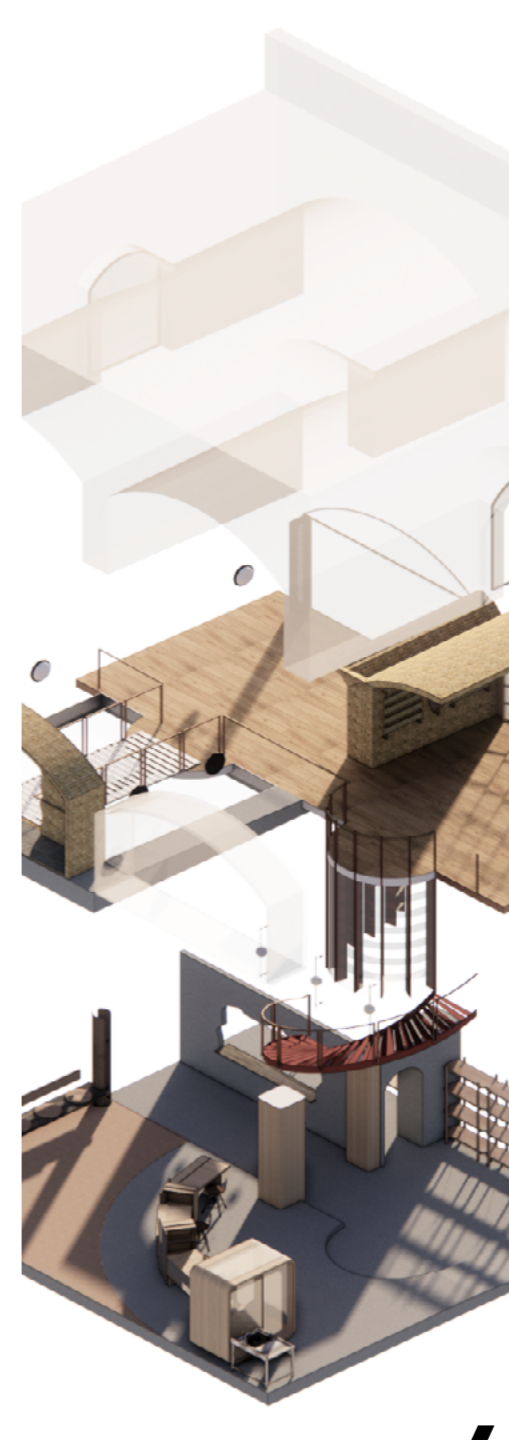

4

S P A T I A L
S T R A T E G Y



5

J O U R N E Y



1

S I T E



2

B R A N D



3

M A T E R I A L
S T R A T E G Y

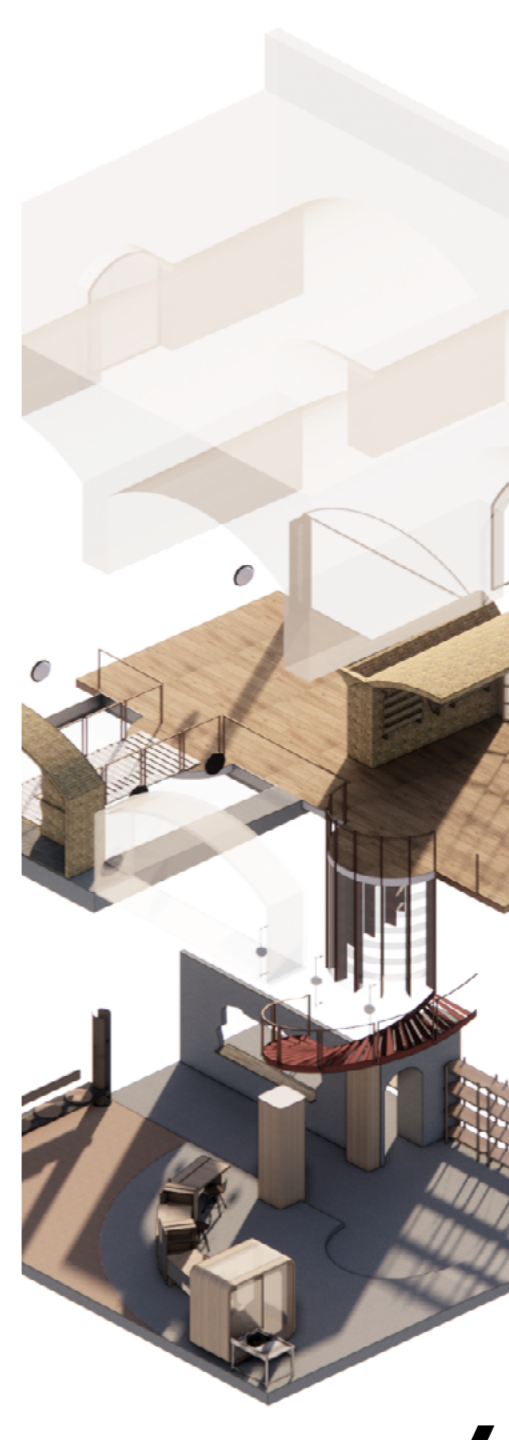

4

S P A T I A L
S T R A T E G Y

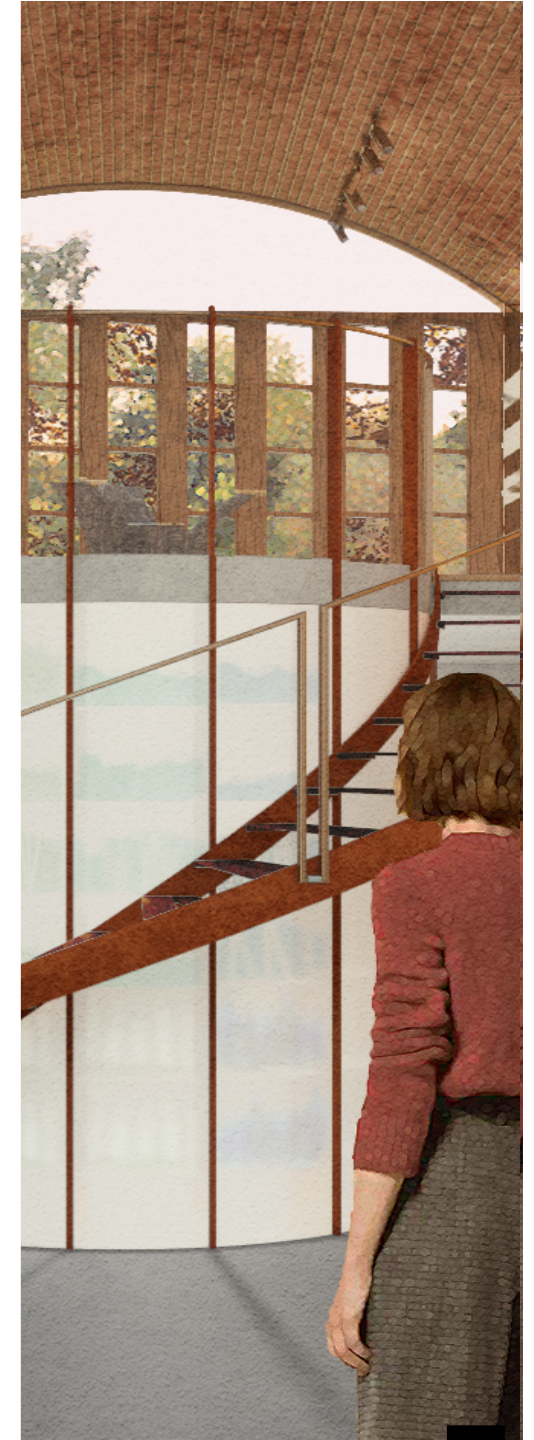

5

J O U R N E Y

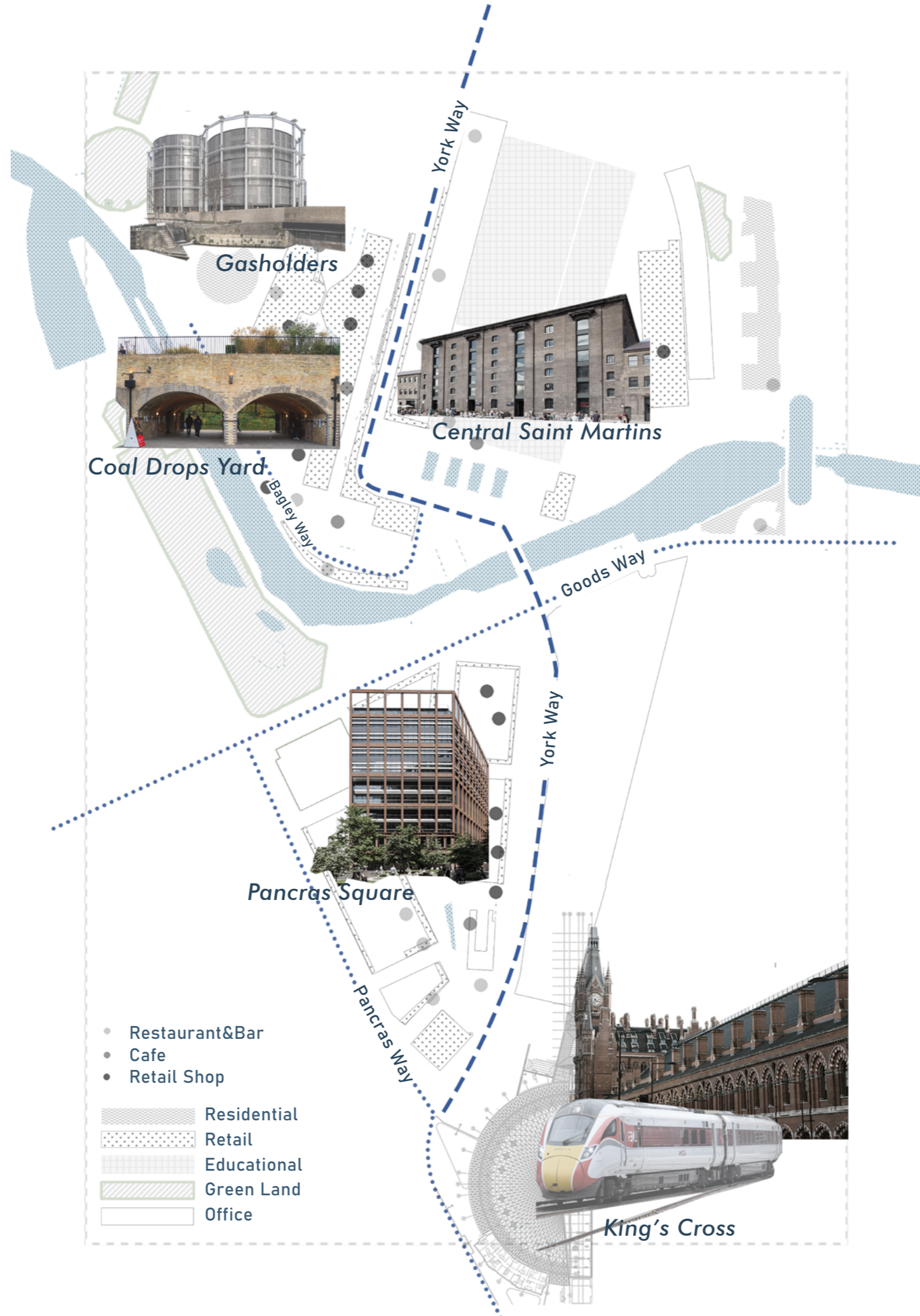



Low Sunlight

There is little sunlight in the arch all year round, so even during the day it is still dark.



Top Floor Garden

There is a walkway garden at the top of the arch.



Circulation Arch

The two arches also serve as a passage between the square and the canal walkway. Access will be closed at night.

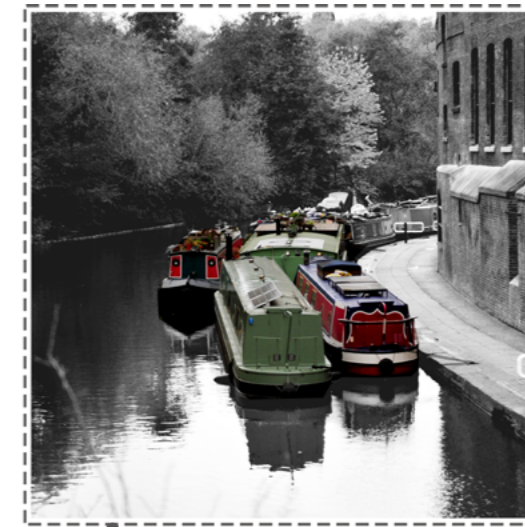

Regent's Canal

The arches are located next to the canal, which also serves as a mooring area for the boats.



1:25 Site Model



1

S I T E



2

B R A N D



3

M A T E R I A L
S T R A T E G Y

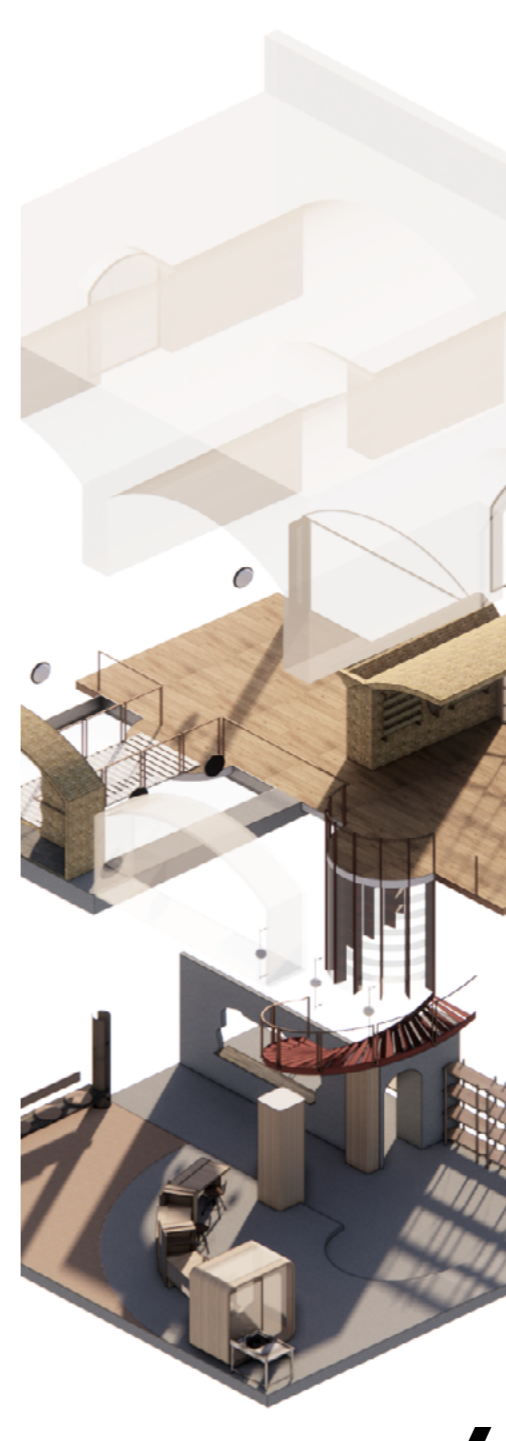

4

S P A T I A L
S T R A T E G Y

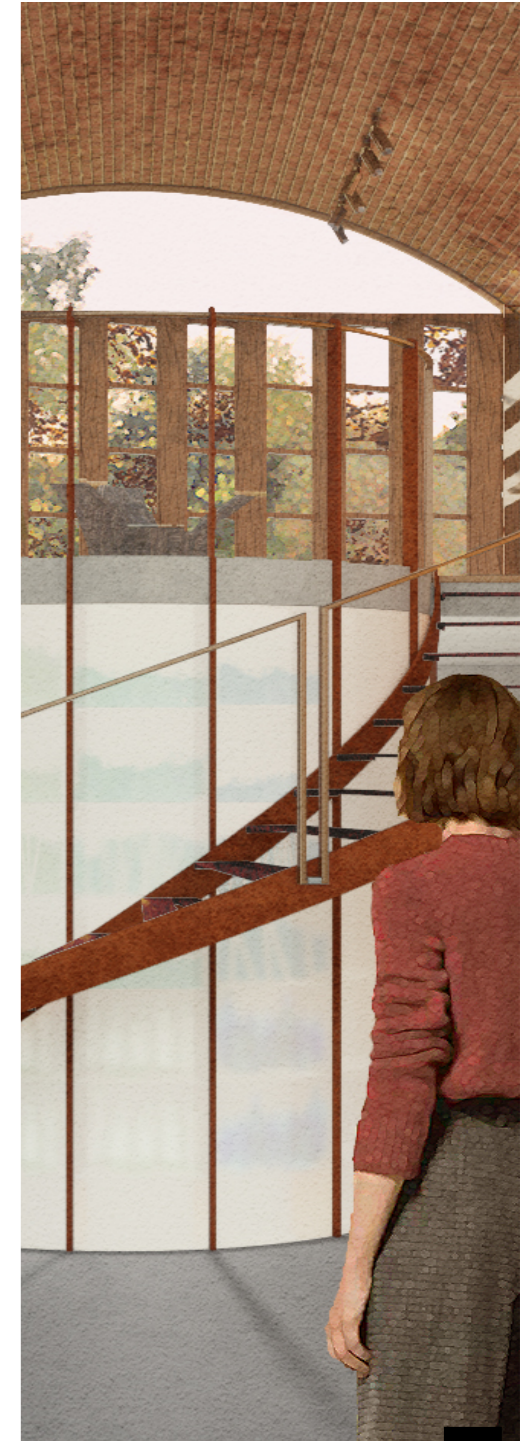

5

J O U R N E Y



CLED

CLED® /clæd/ is derived from the word cycle(d), reflecting the meaning of recycled and upcycled.

Reduce environmental impact by using discarded resources and repurposing them into new treasured objects without sacrificing quality or design



Sea glass is naturally weathered pieces of glass
Natural way of upcycled
Turn sharp discarded glass into beautiful curve glass







CLED

Upcycled: Trash is treasure

Appreciate what we receive from nature



1

S I T E



2

B R A N D



3

M A T E R I A L
S T R A T E G Y

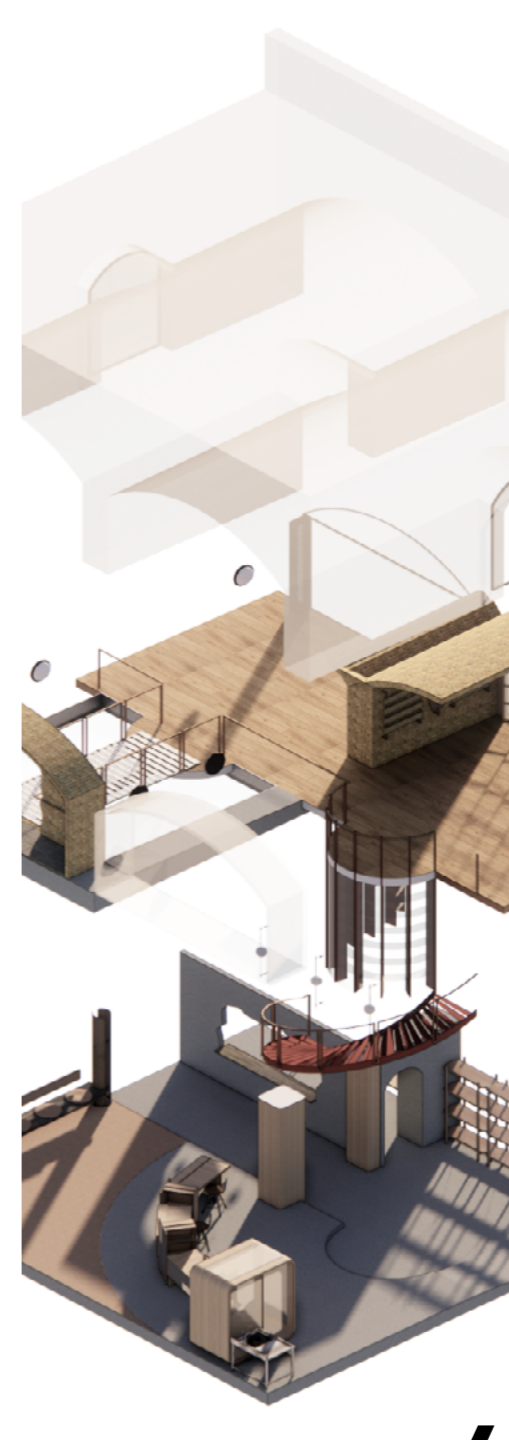

4

S P A T I A L
S T R A T E G Y



5

J O U R N E Y





Experiments simulating natural processes acting on synthetic materials
Find their potential in space design

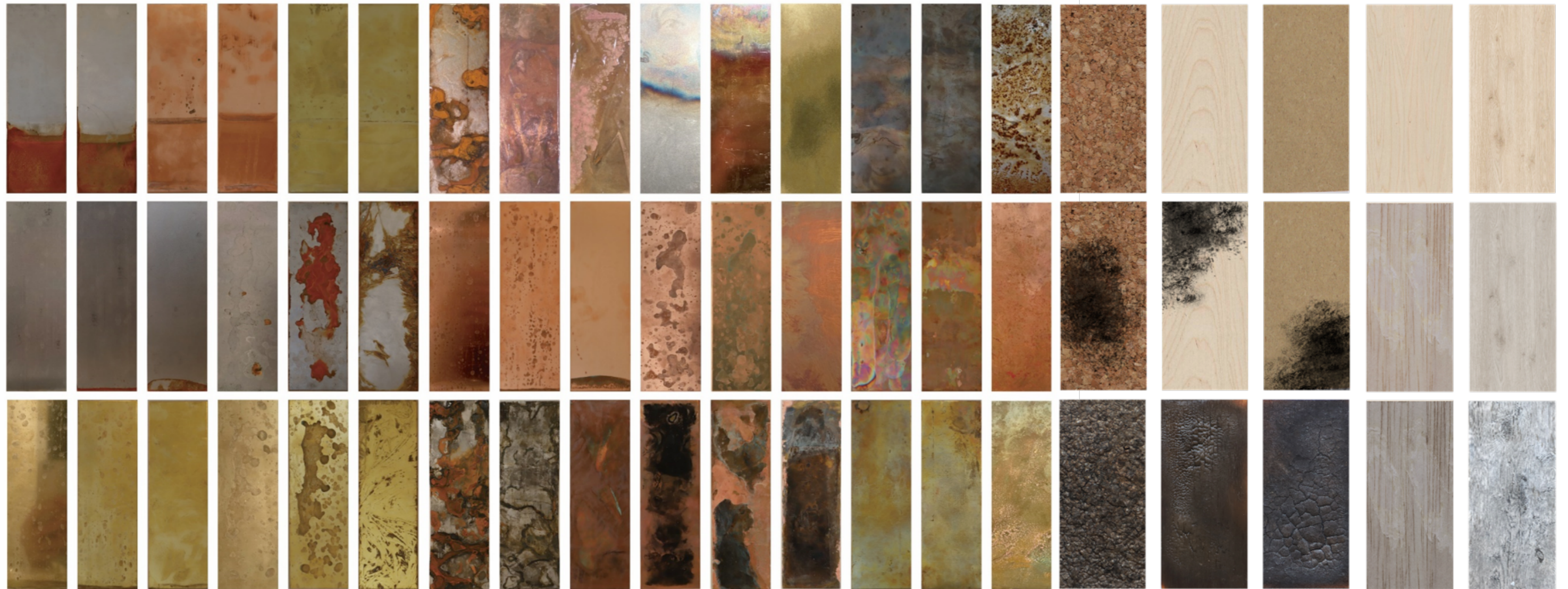

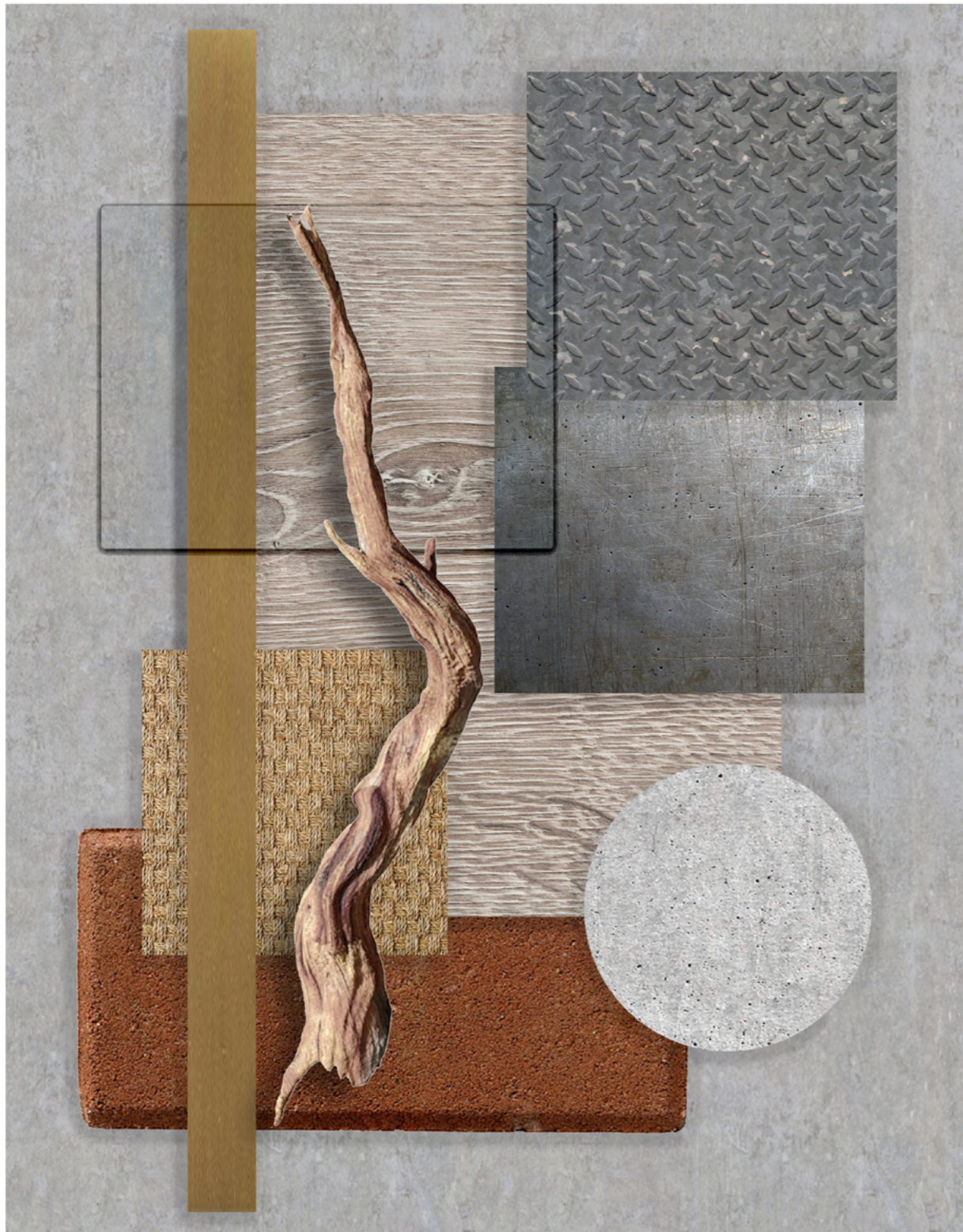

- Cor-ten
- Steel
- Brass
- Frosted glass
- Reclaimed wood
- Oak
- Brick
- Seaweed carpet



1

S I T E



2

B R A N D



3

M A T E R I A L
S T R A T E G Y

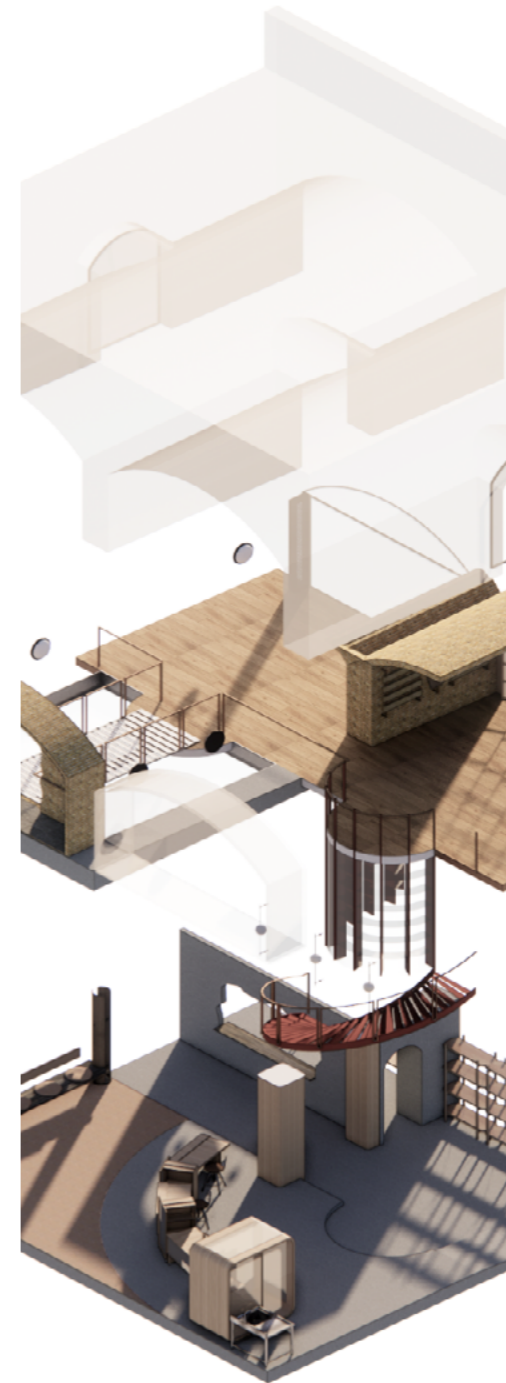

4

S P A T I A L
S T R A T E G Y



5

J O U R N E Y

~~Acrylic~~



Glass





Display: tell the story of CLED

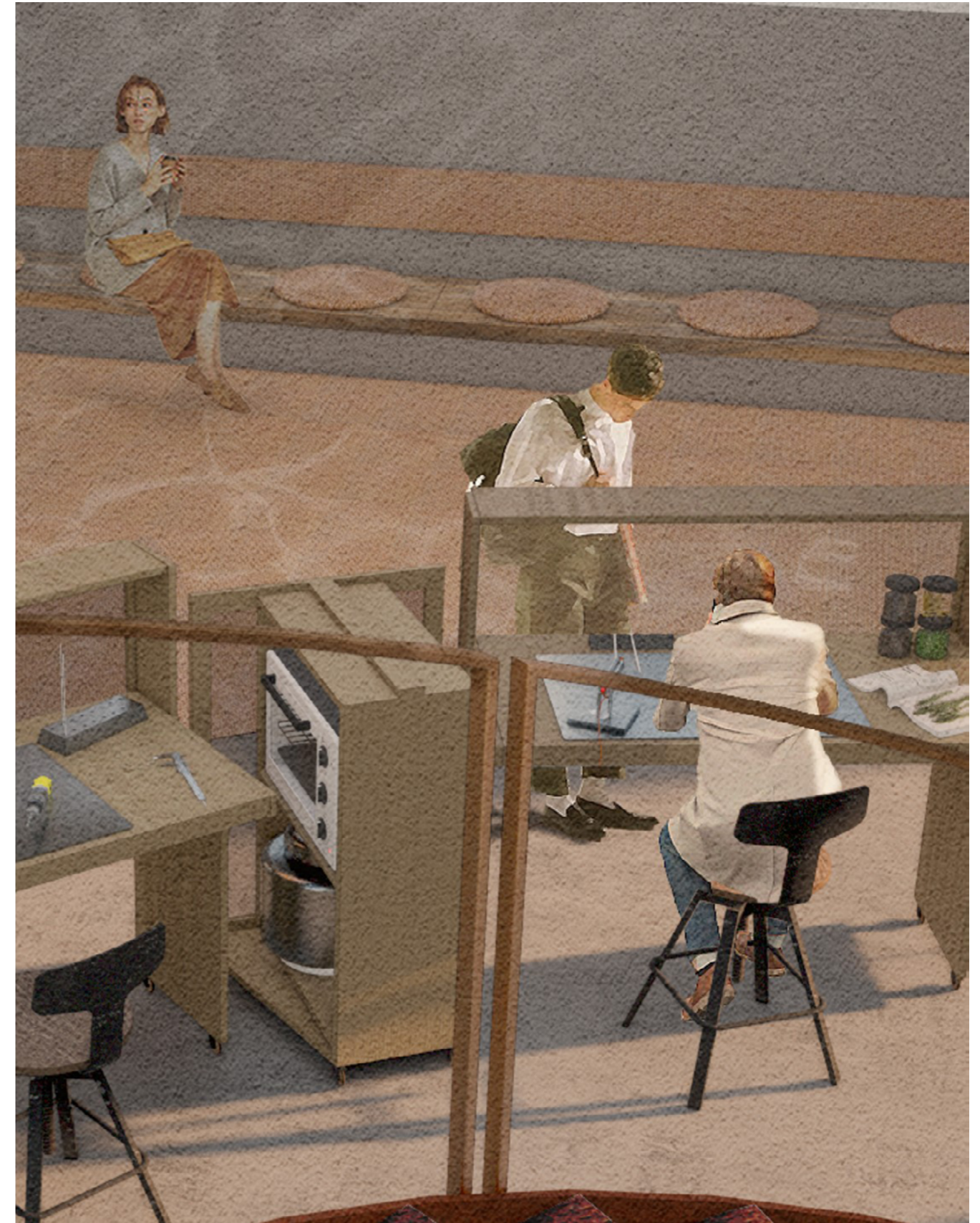

Jewelry workshop: understand the process of upcycled and engage in this new lifestyle

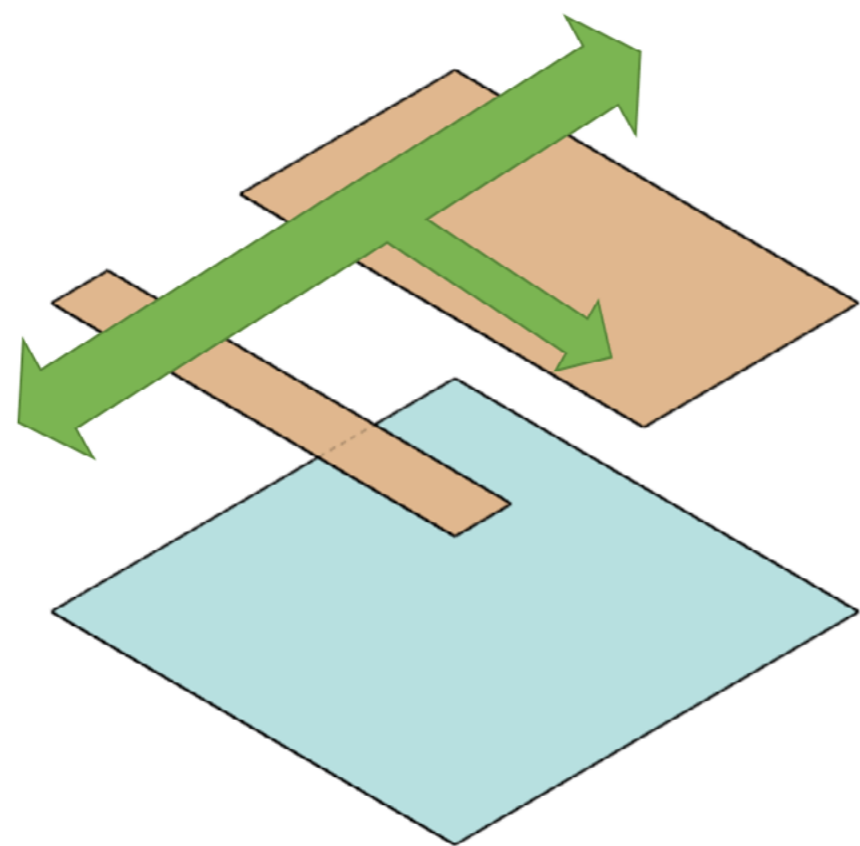

Display

Workshop

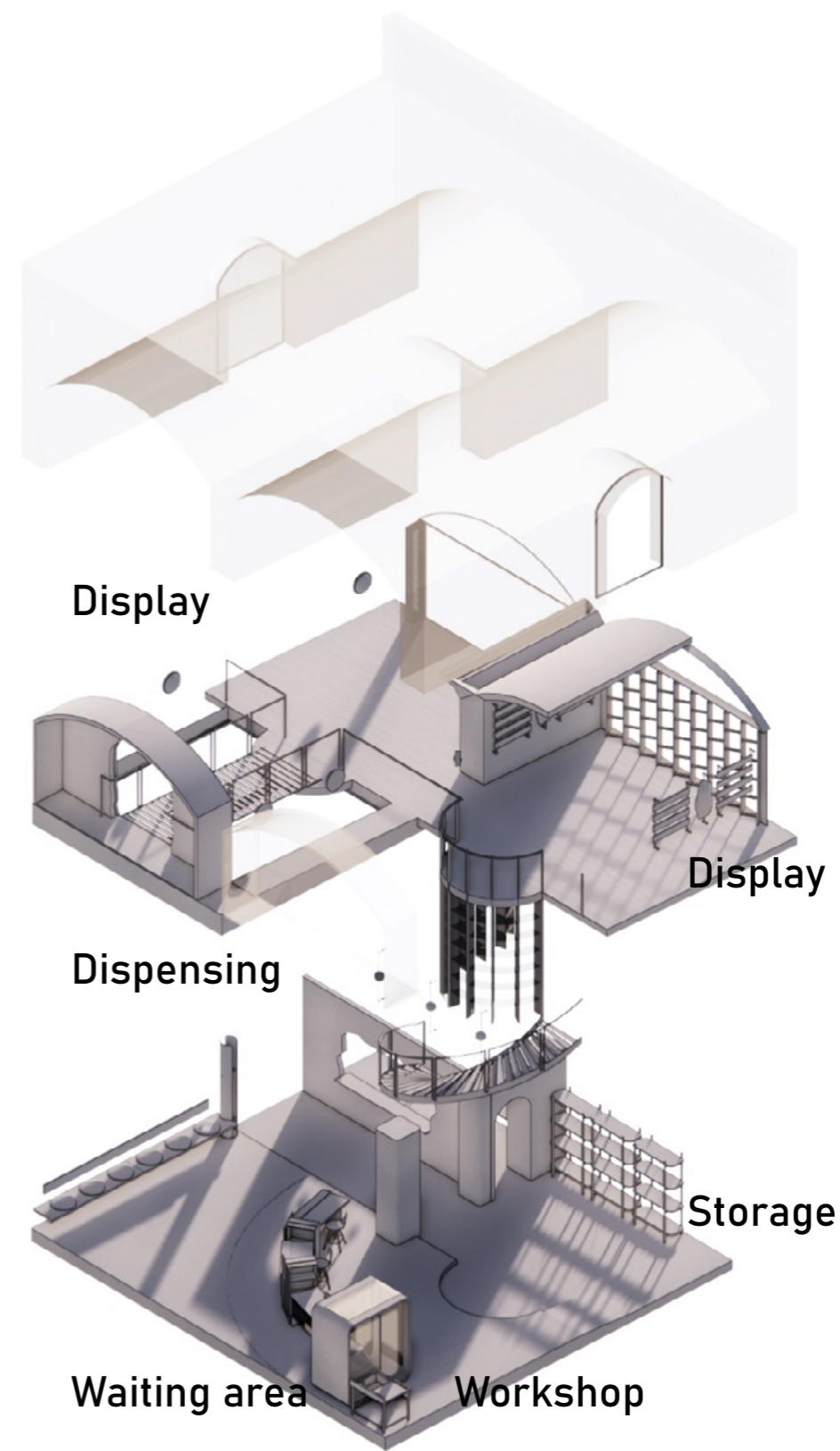

Display

Display

Dispensing

Storage

Waiting area

Workshop

0 1 5(m) 
1:100 Ground Floor Plan



0 1 5(m) 
1:100 Basement Plan





A-A 1:50 Left Arch Section





B-B 1:50 Right Arch Section





1

S I T E



2

B R A N D



3

M A T E R I A L
S T R A T E G Y

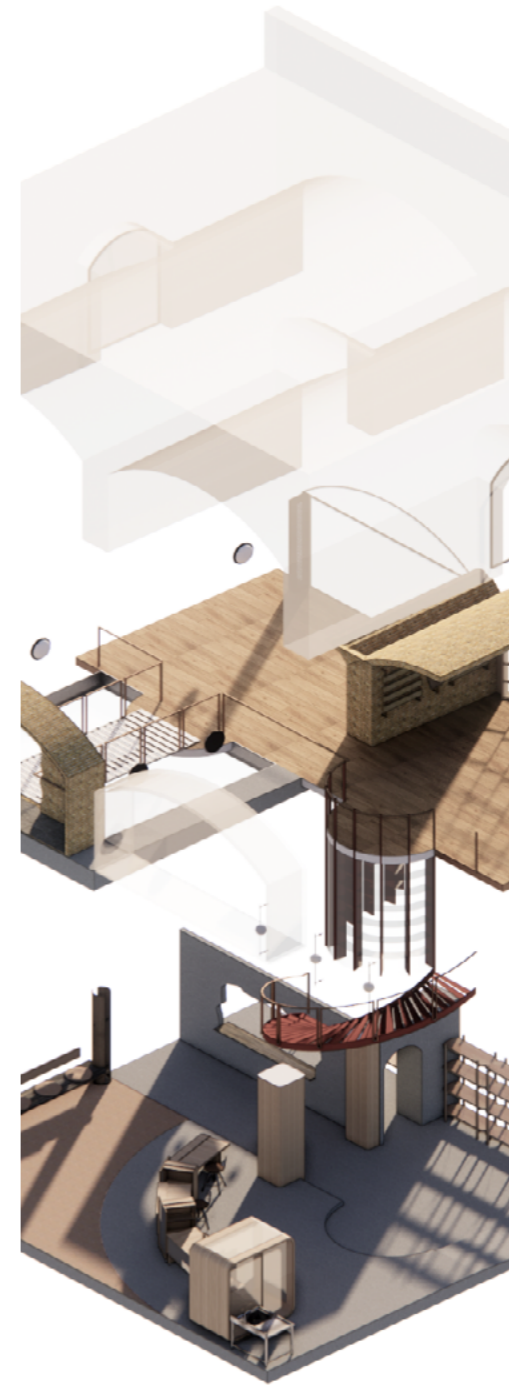

4

S P A T I A L
S T R A T E G Y

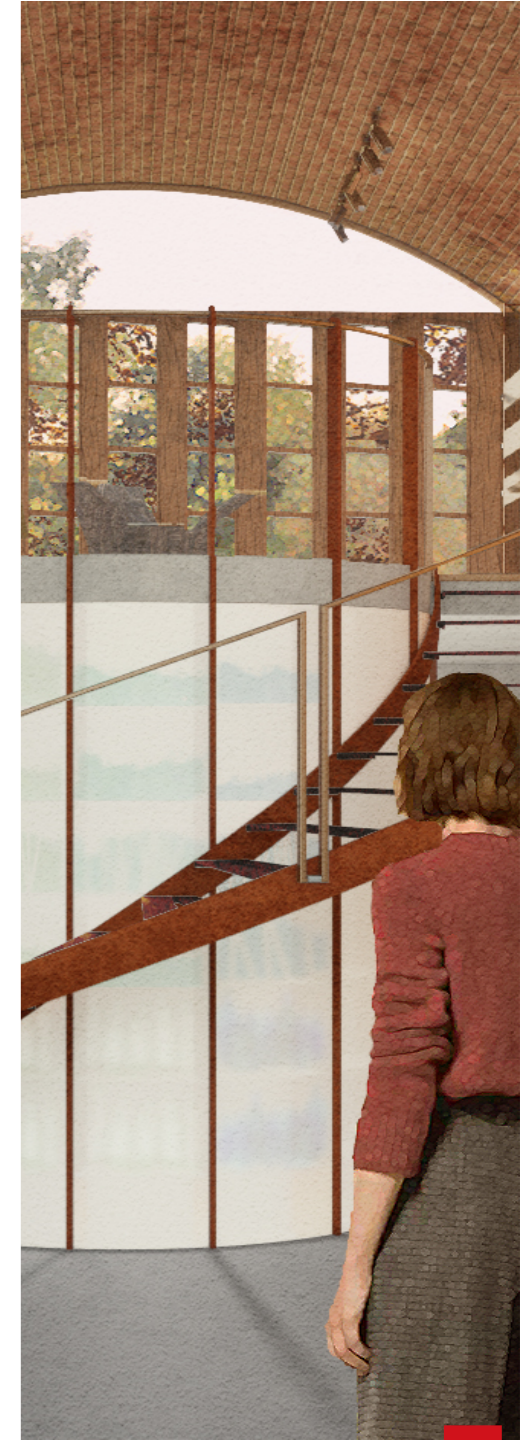

5

J O U R N E Y

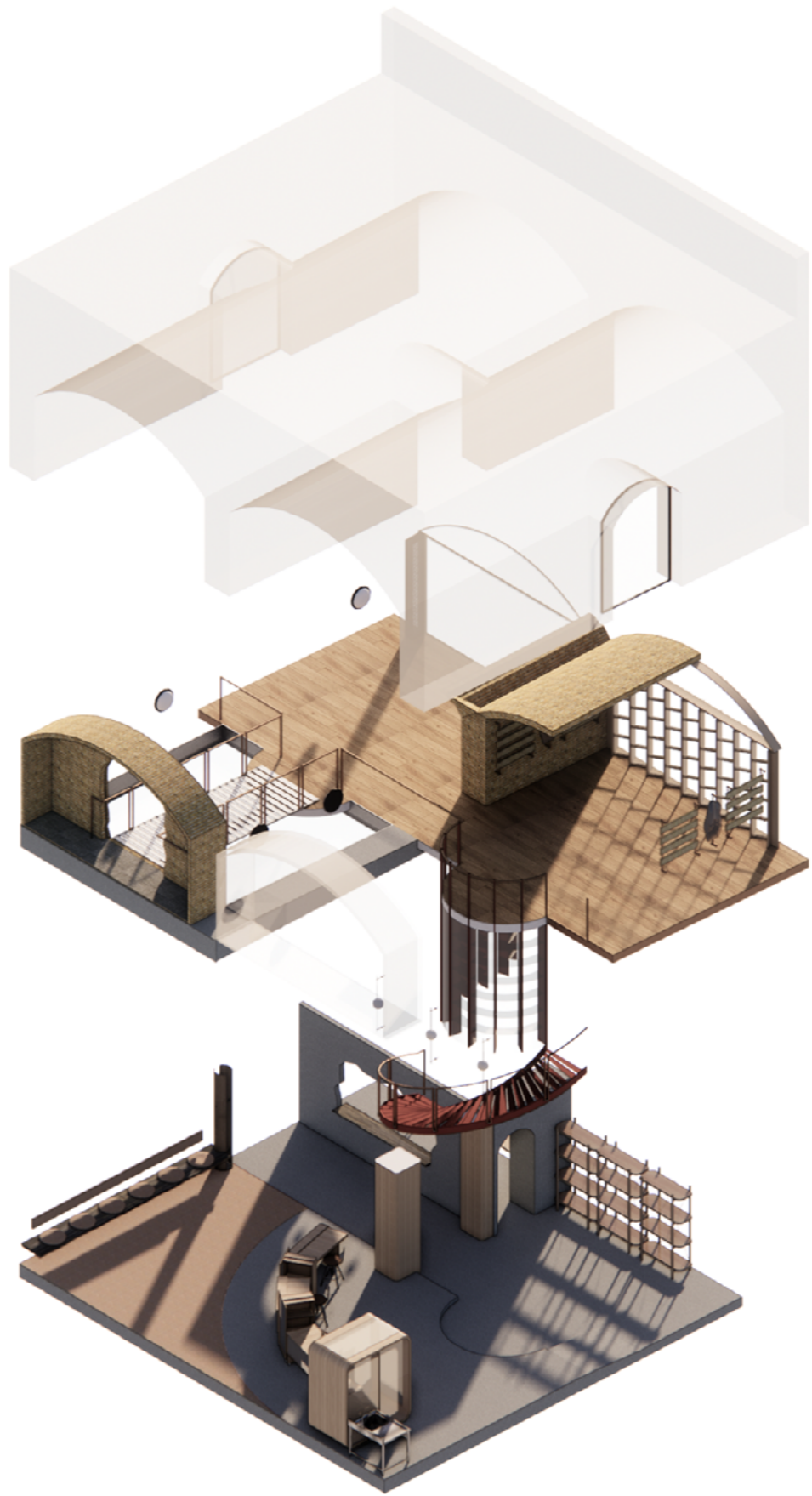

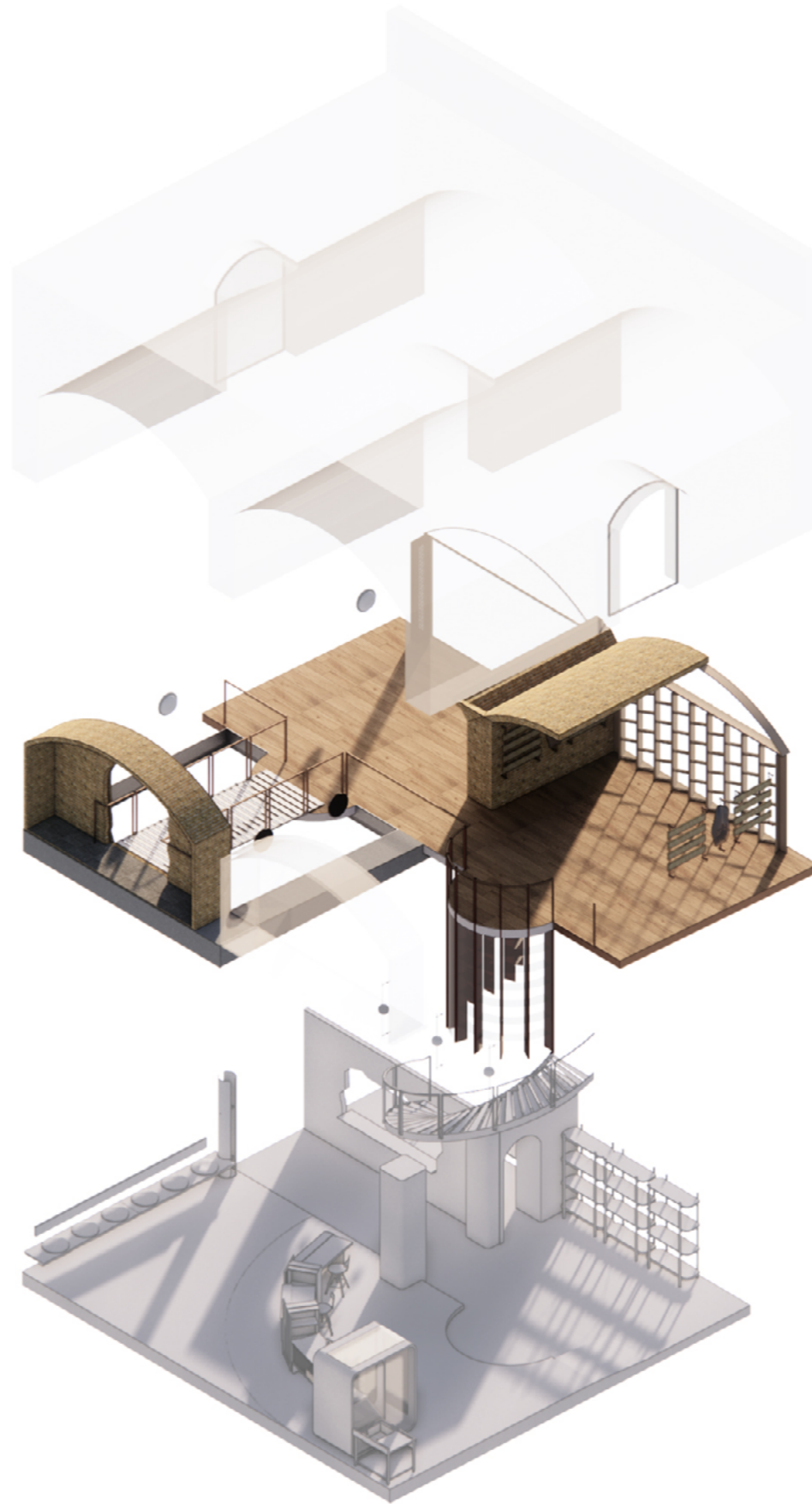

DISPLAY



-10 days

-1 mth

-1 mths

-3 years



-10 days

-1 mth

-1 mths

-3 years

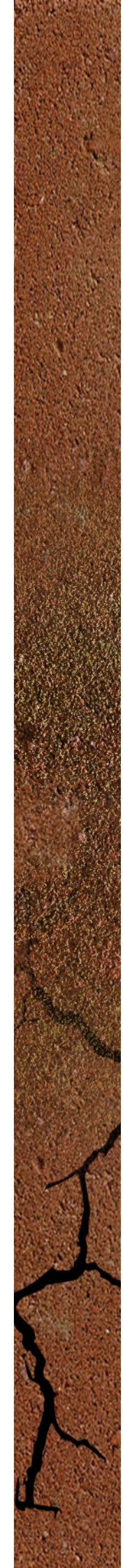



DAY: open to public



NIGHT: close for security

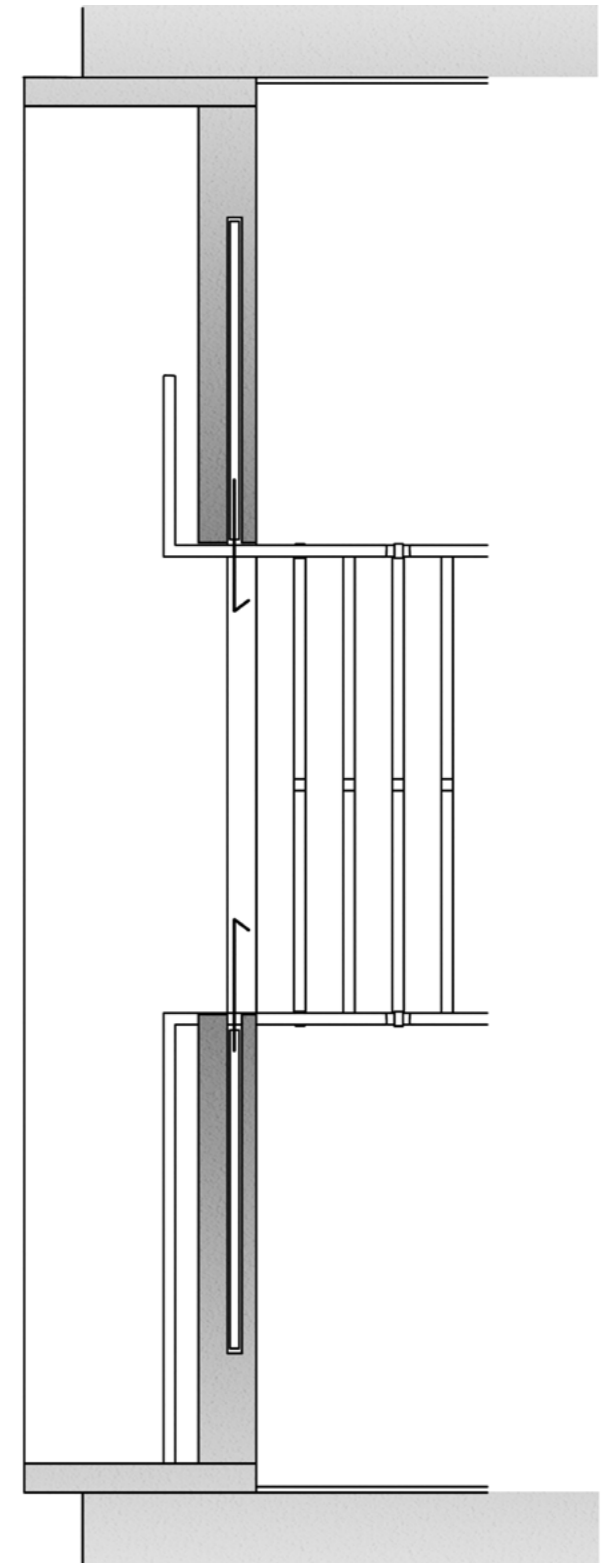

PLAN

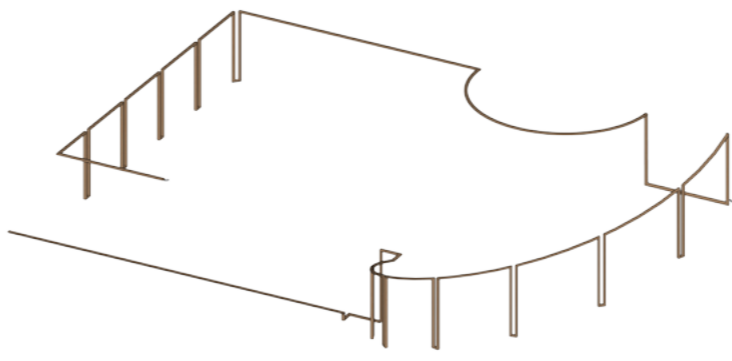
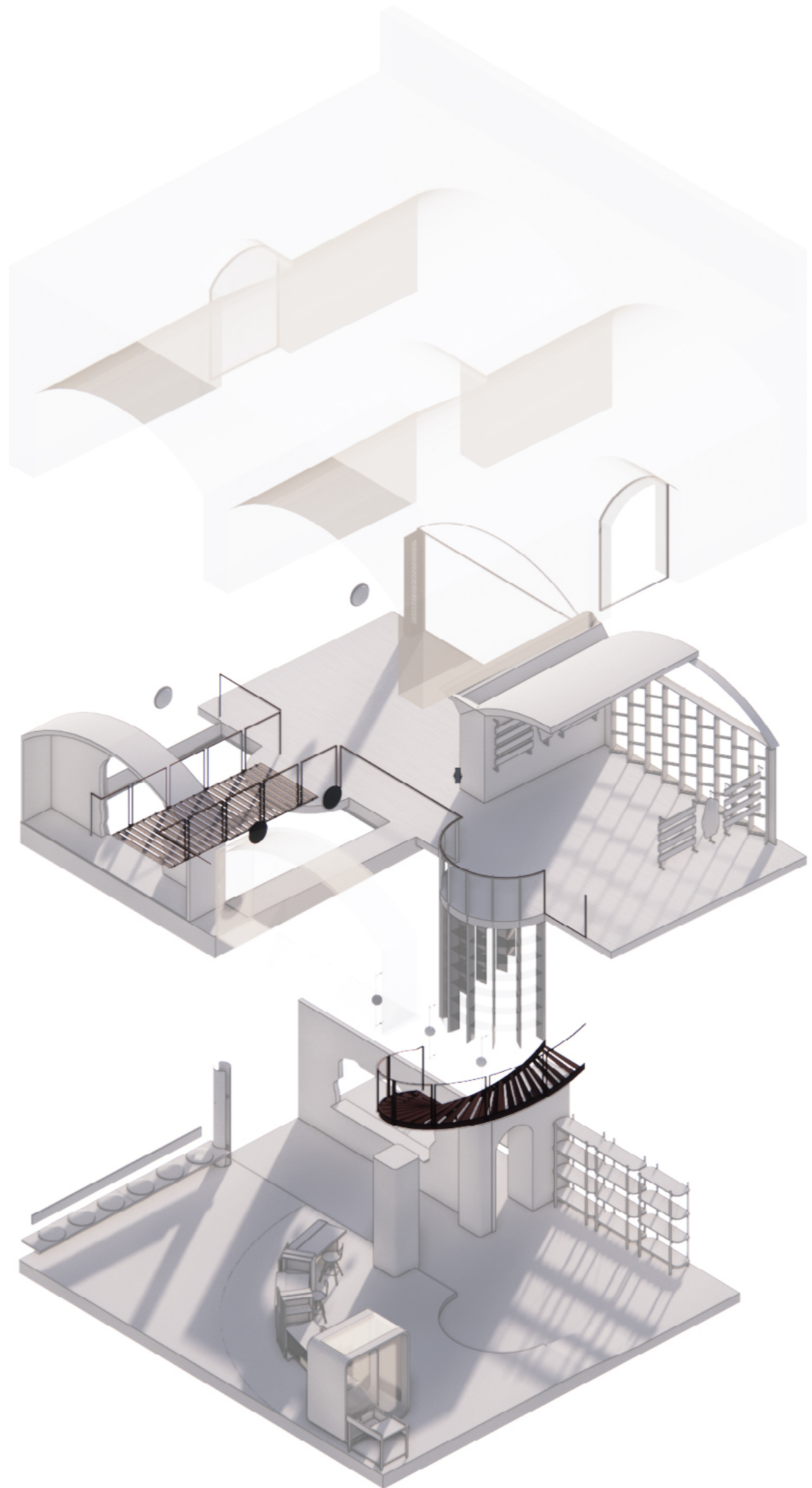

A continuous handrail connects not only the interior and exterior of the space, but also the two main circulation.

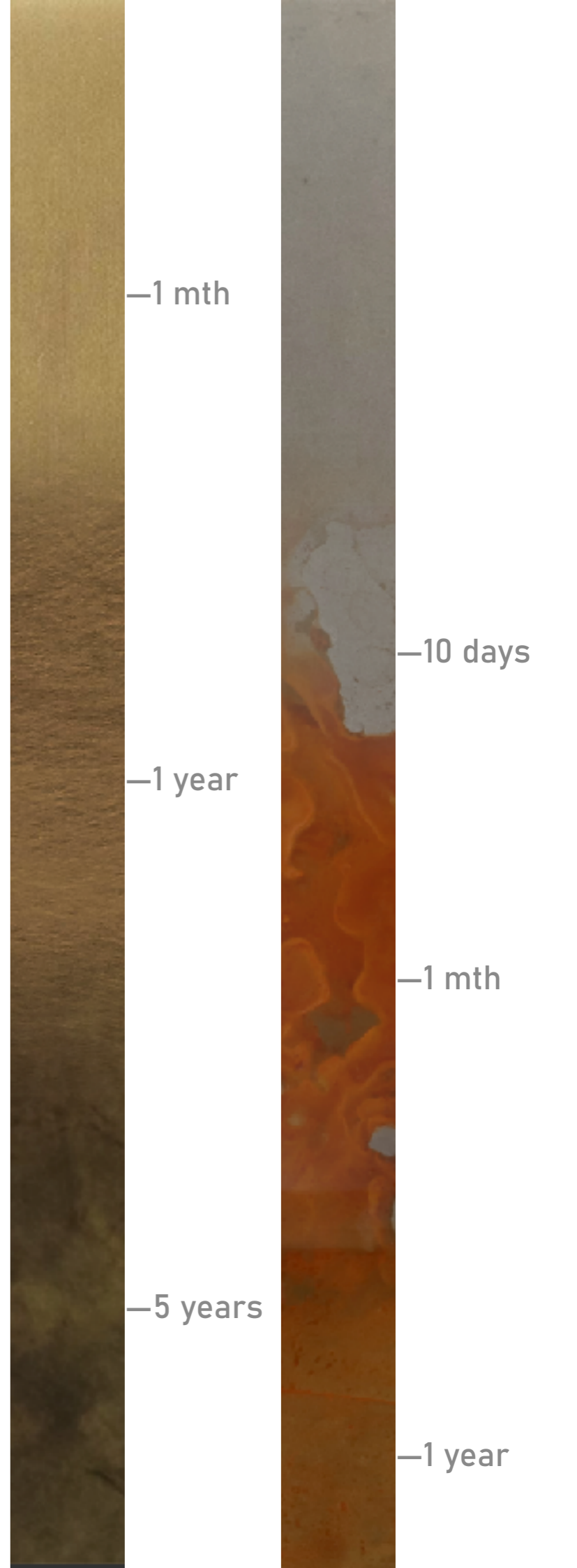

-1 mth

-10 days

-1 year

-1 mth

-5 years

-1 year



-10 days



—5 years



-10 days



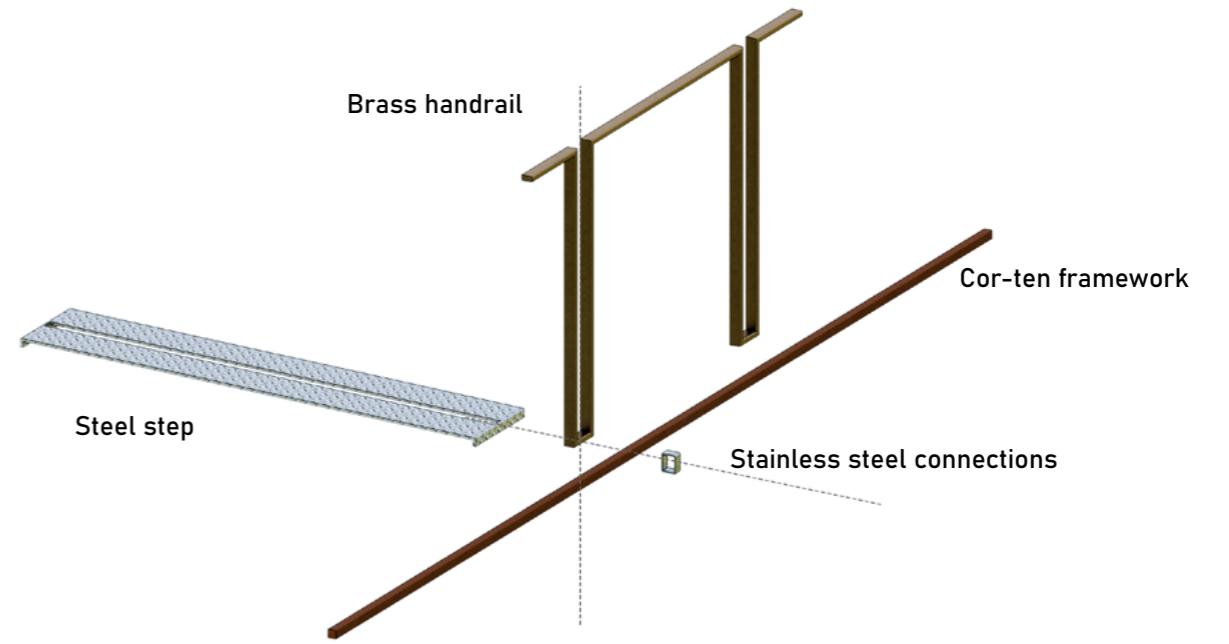
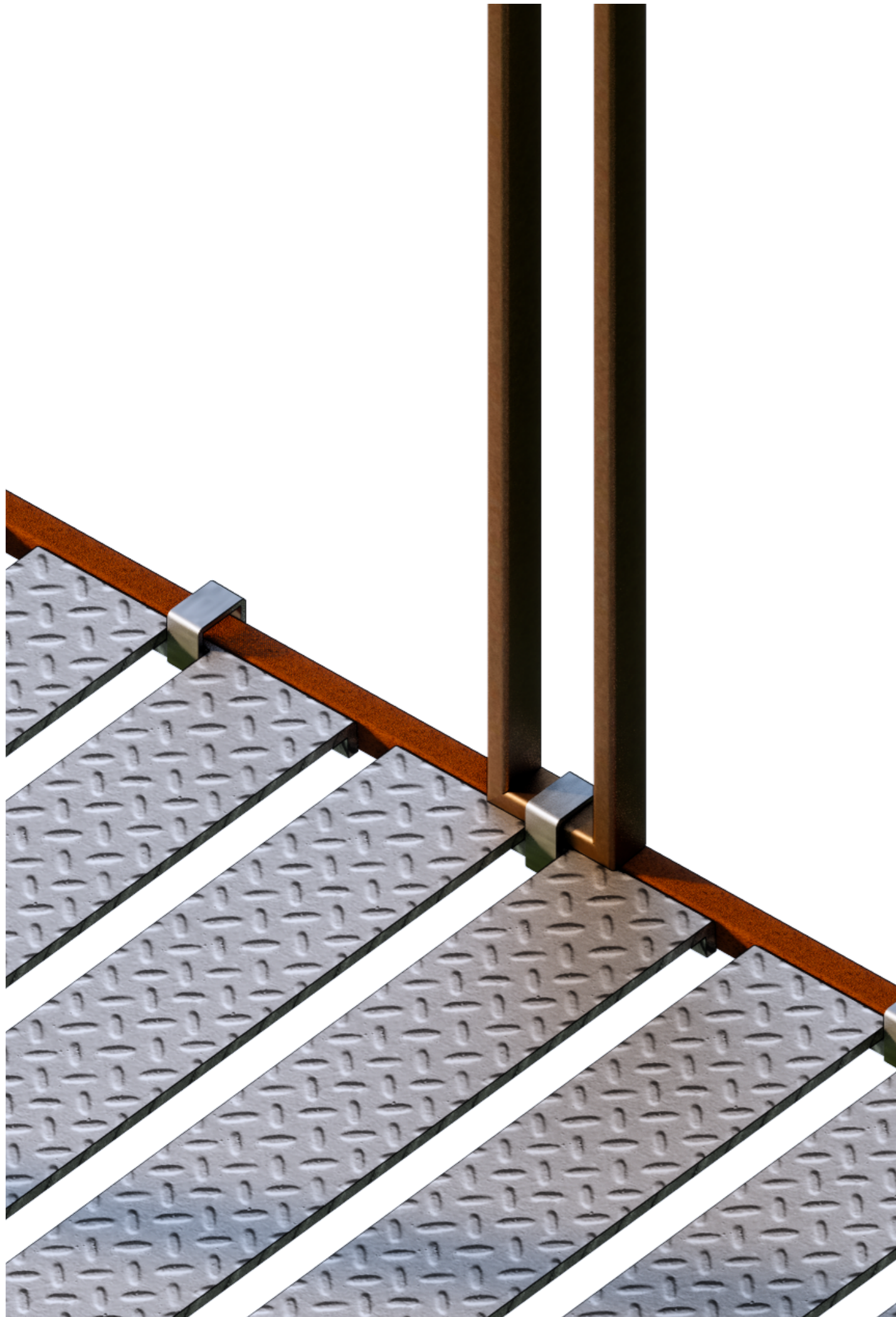

Detail from CLED jewelry







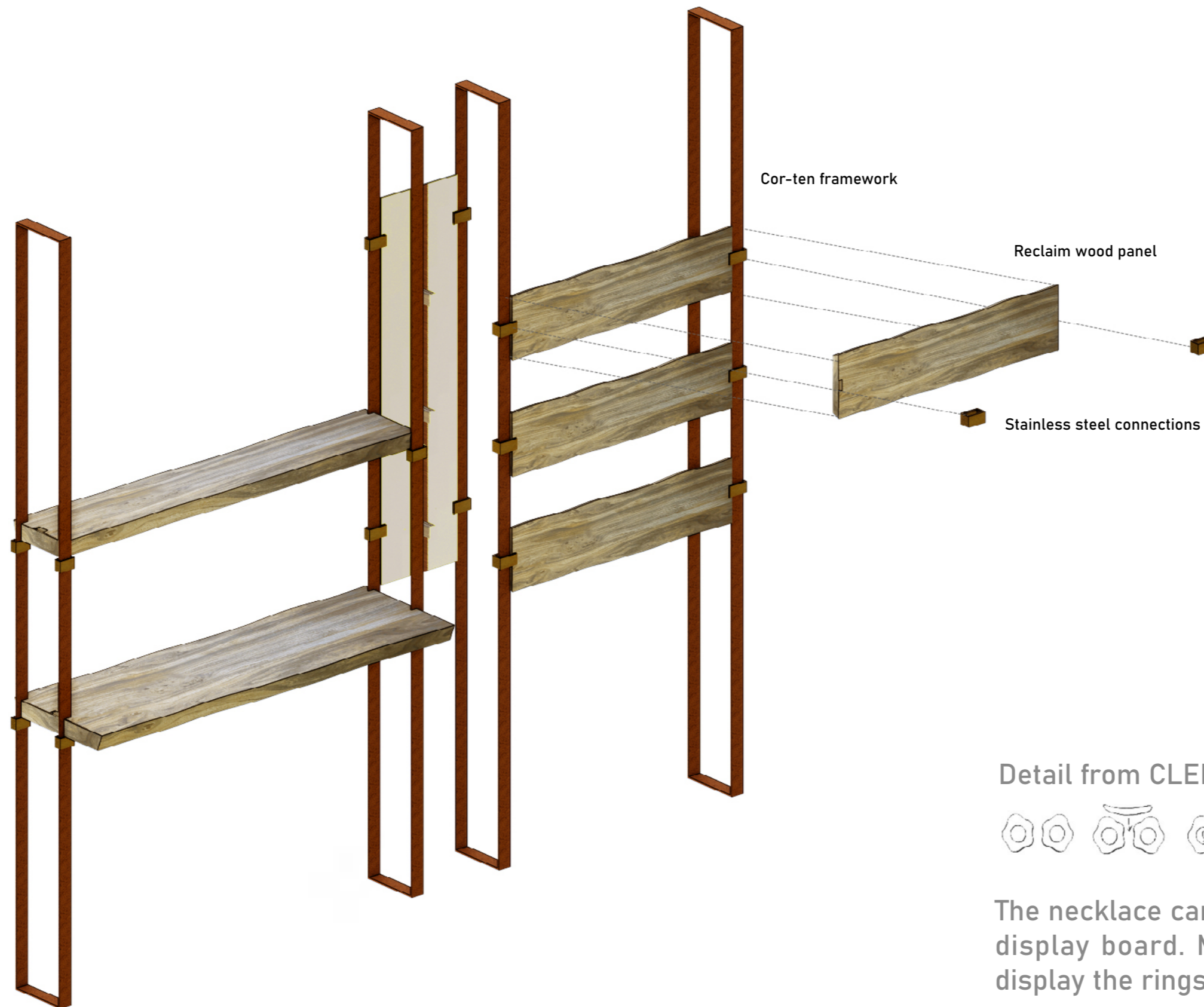

Cor-ten framework

Reclaim wood panel

Stainless steel connections



Detail from CLED jewellery



The necklace can be mounted directly on the vertical display board. Magnets are set into the panels to display the rings and also for security purposes.

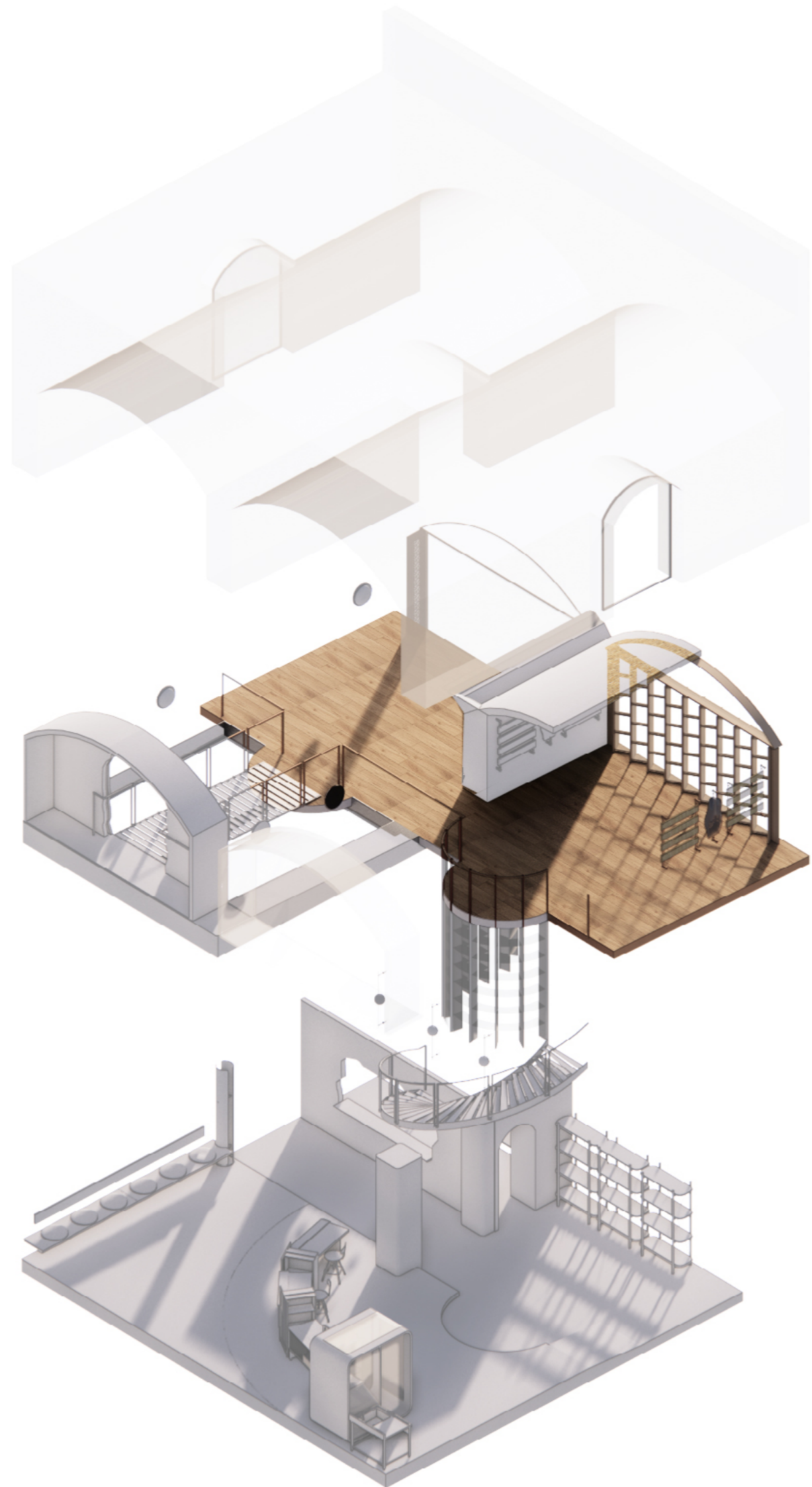

The wood will weather and bleach on the exterior, become grey and more textured. Inside the wood will remain the same colour.



-10 days

-1 mth

-1 year

-5 years



—0 day



—5 years



Rust Celebration



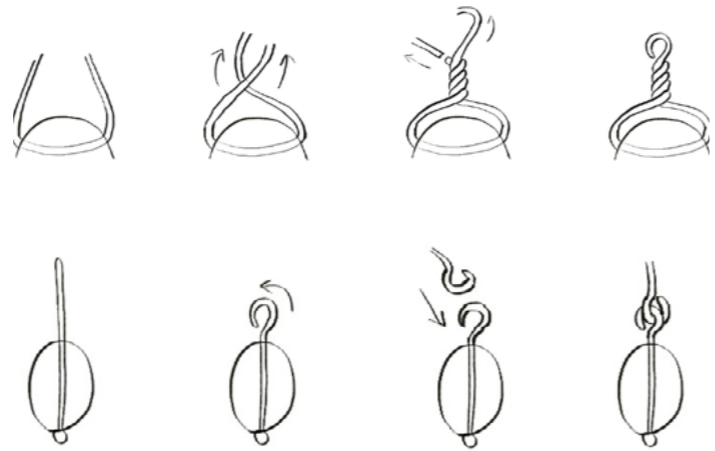

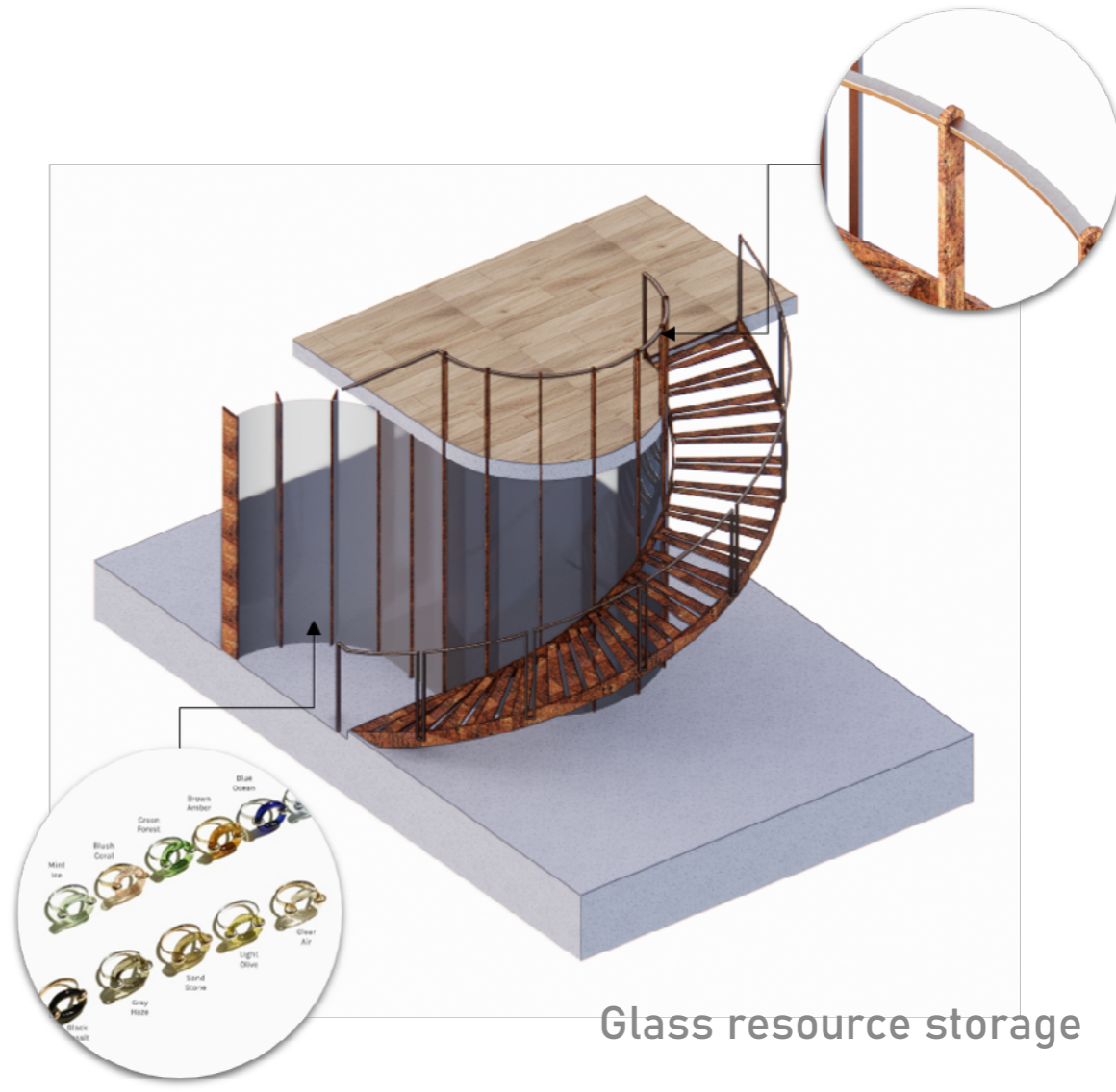

Glass resource storage

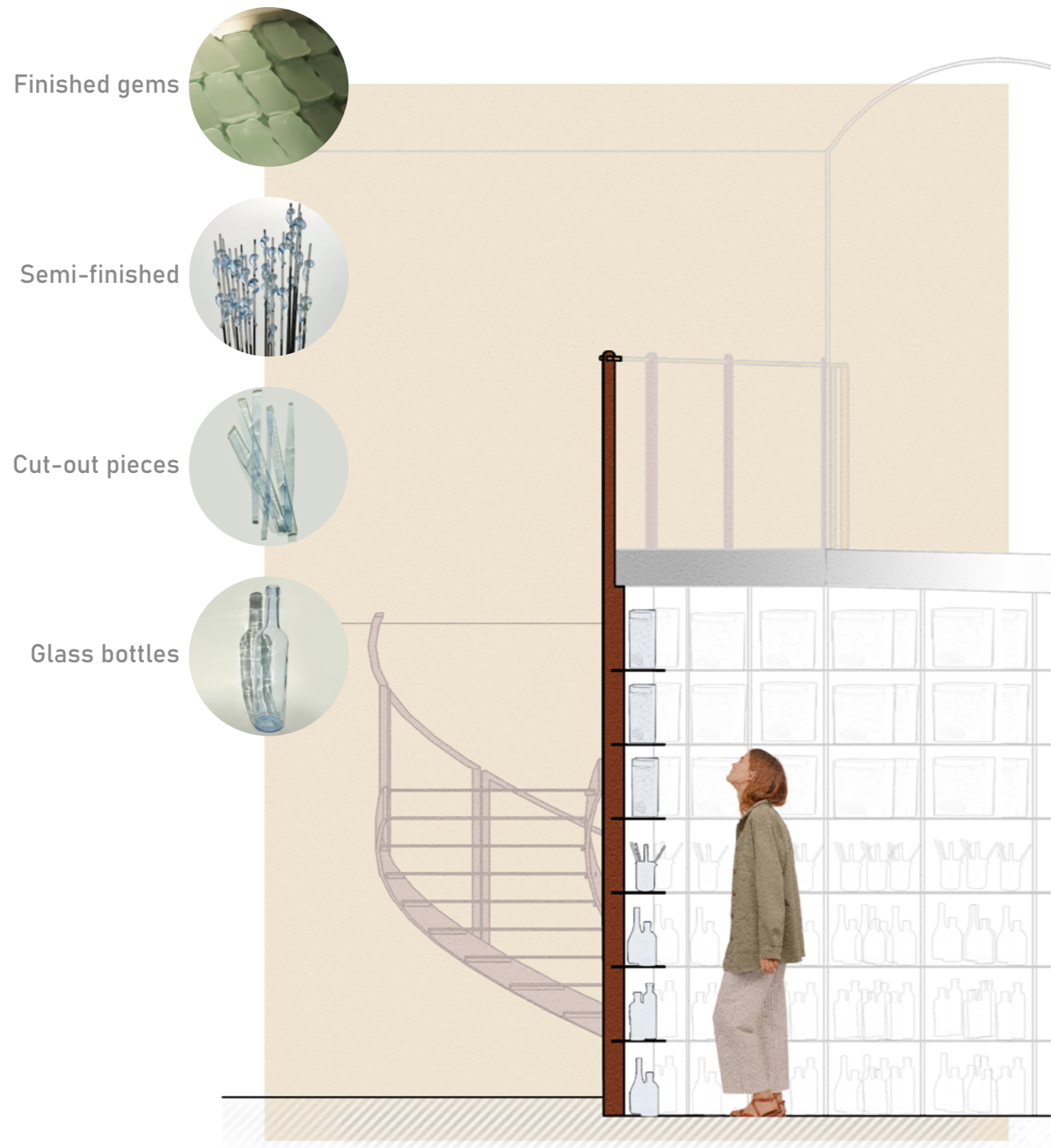





WORKSHOP
+Waiting area & dispensing room

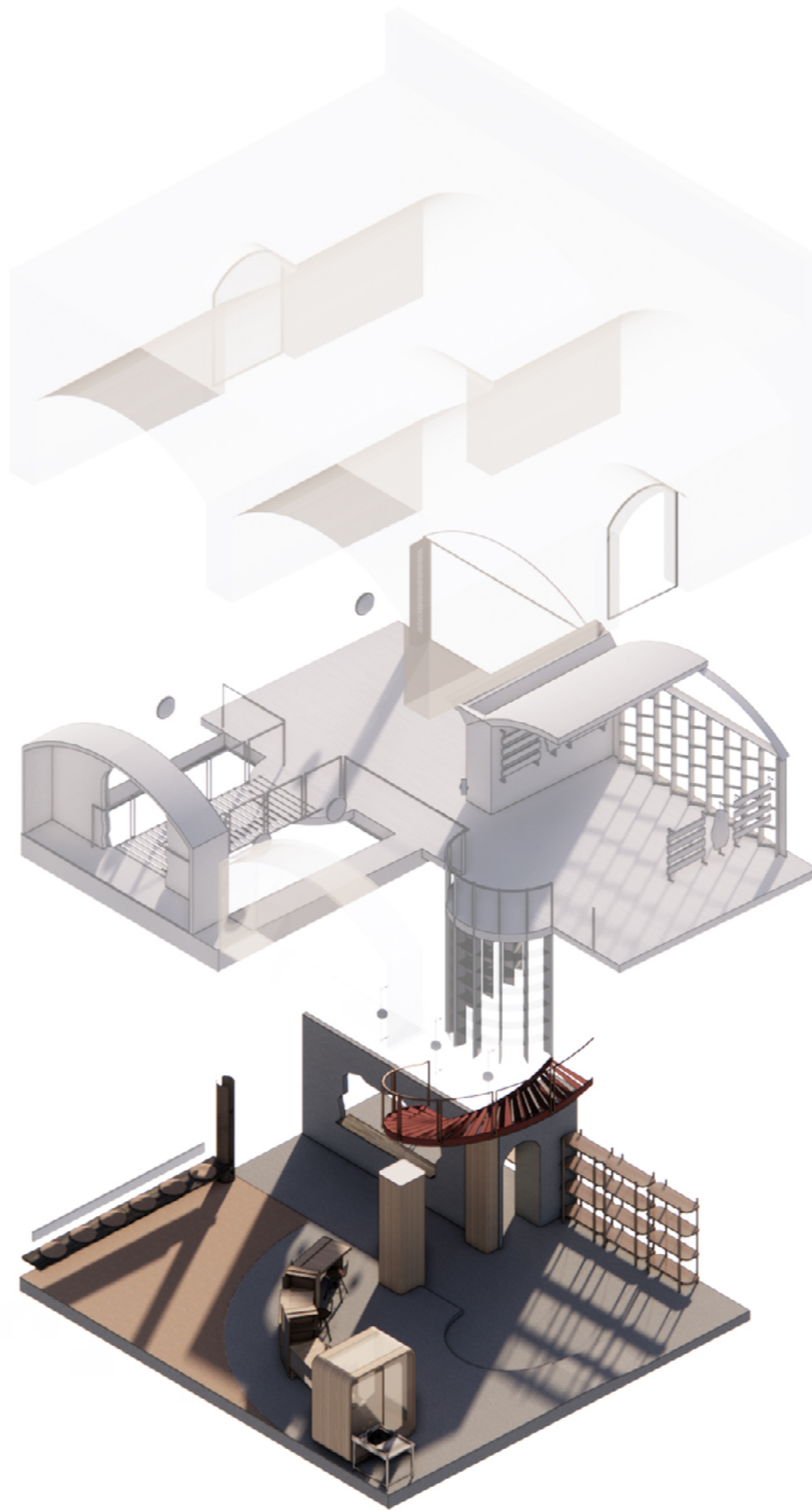

CLED Jewellery



After the glass gem is formed, it is annealed to remove stresses and to increase the glass hardness and durability.



Current status of CLED Studio

- 1. Apron
- 2. Dust Mask
- 3. Brush Set
- 4. Detergent
- 5. Towel
- 6. Strainer
- 7. Sink
- 8. Sponge
- 9. Waste Bin
- 10. Boxes for glass bottles
- 11. Protective Glasses
- 12. Insulated Gloves
- 13. Pliers Set
- 14. Clamps
- 15. Graphite Shaping Knife
- 16. Cooling Water Bowl
- 17. Tweezers
- 18. Tool stand
- 19. Jewellery Mandrel
- 20. Raw Material Buckets
- 21. Graphite Paddle
- 22. Torches
- 23. Graphite Sheet
- 24. Stainless Steel Insulation Pad
- 25. Graphite Marble Paddle
- 26. Ruler Set
- 27. Glass Cutter
- 28. Scissors
- 29. Calipers
- 30. Butane
- 31. Oxygen Concentrator
- 32. Annealing Kilns
- 33. First Aid Kit
- 34. Dust Extraction Workstations
- 35. Rotary Multitools Kit
- 36. Grinding&Cutting Machine

Workshop Equipment

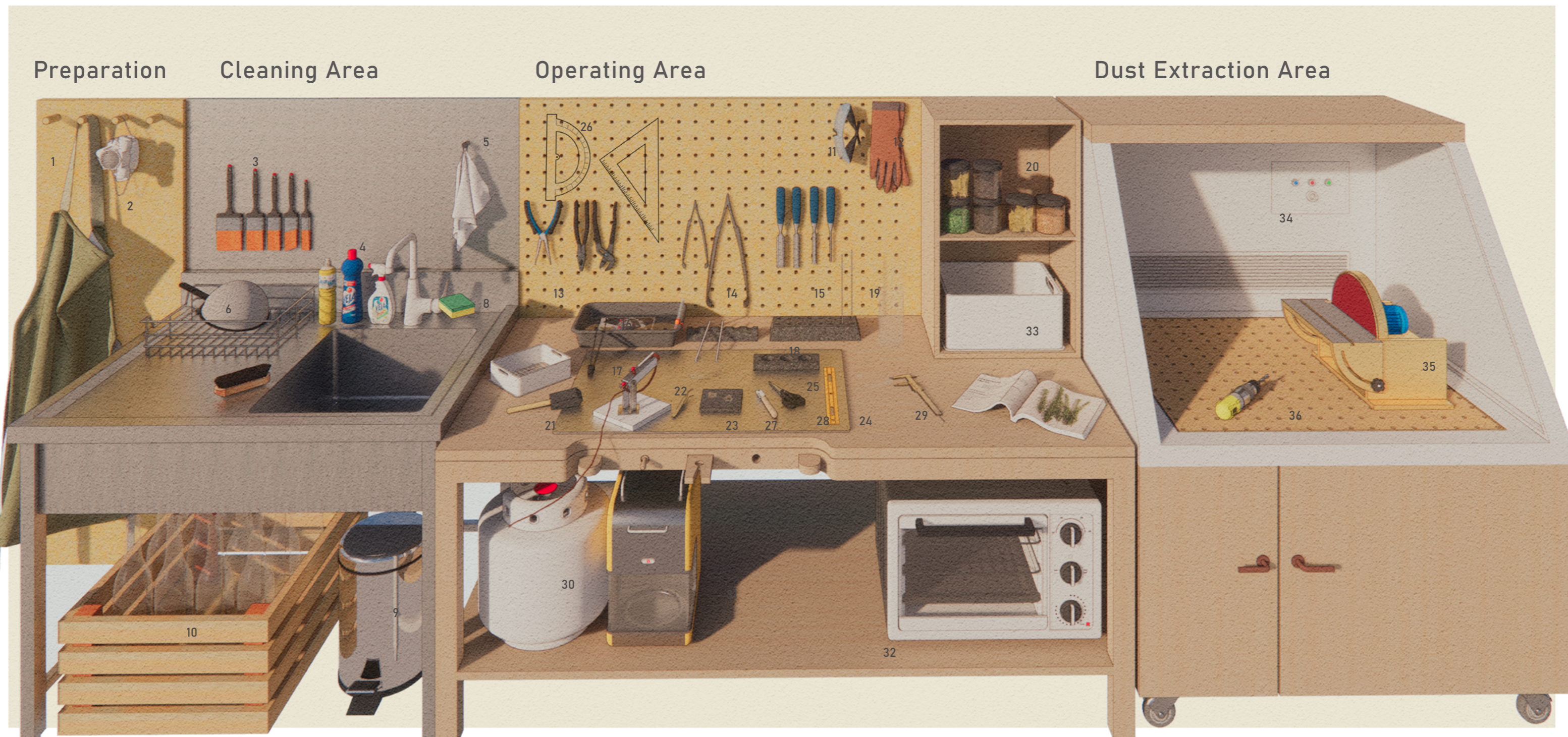

Observation:
Daily working time

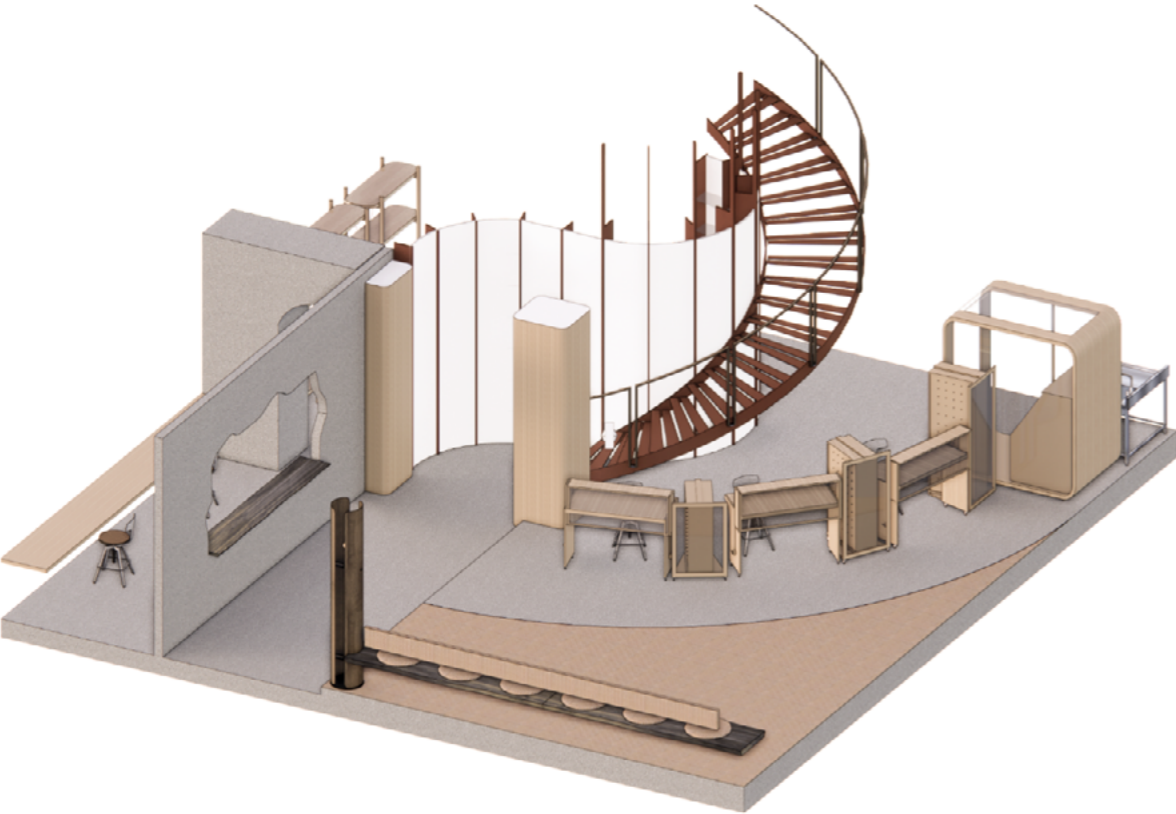

Engaging:
Workshop open day

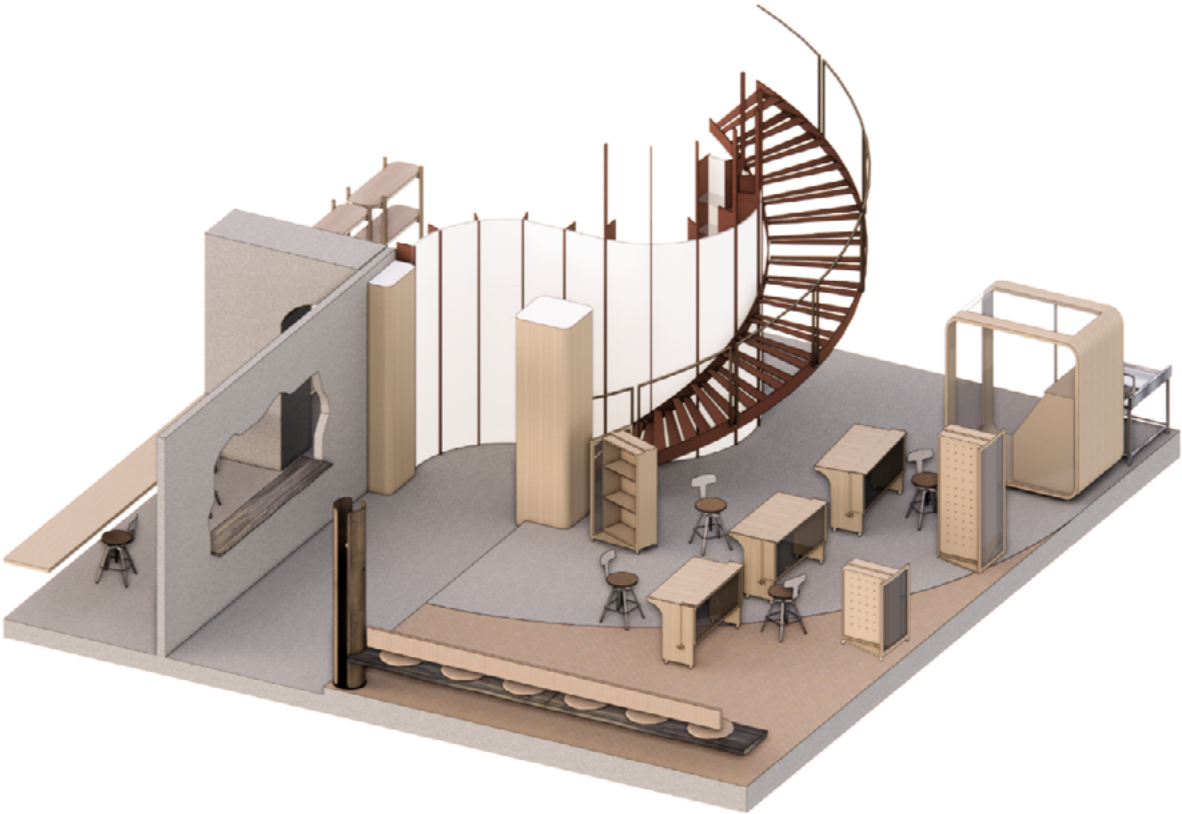



Dispensing room



In conclusion: Through this project, I hope to make more people know about this eco-friendly jewellery brand CLED and the story of natural weathering behind it.

I also hope to provoke thoughts on the longevity and reuse of materials that have been weathered.