

A high-contrast, black and white photograph. On the left side, a person is shown in silhouette, sitting on a ledge or windowsill. They are leaning forward with their arms resting on their knees, looking out towards the right. The background is a vast, bright, and somewhat hazy landscape, possibly a body of water or a wide plain, extending to the horizon. The sky is very bright, creating a strong backlighting effect. The overall mood is contemplative and serene.

THE OPPOSITE OF LONELINESS

Coronavirus

## UK travellers complain of 'prison-like' conditions in quarantine hotels

Concerns raised over food, lack of fresh air and social distancing after coming back from red list countries

[Coronavirus - latest updates](#)

[See all our coronavirus coverage](#)

Diane Taylor

Tue 11 May 2021 11.27 BST



▲ A picture taken on a coach transporting travellers returning from red list countries to quarantine hotels.  
Photograph: c/o Dr Sanjay Gupta

Travellers staying in quarantine hotels in the UK after returning from “red list” countries have complained of “prison-like” conditions, including windows that do not open, a lack of fresh air, exercise and decent food.

Quarantine hotel Design in the context of COVID-19 isolation.  
-How can materials be used to improve people's comfort, health and well-being?

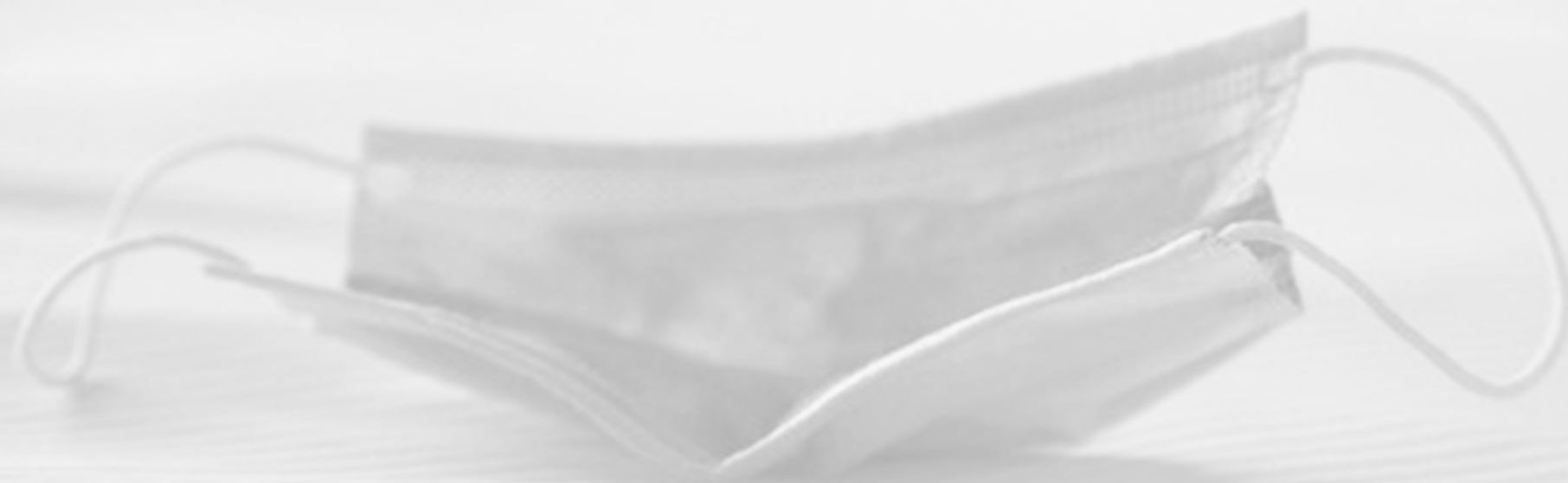

SAFETY

COMFORT



*health*  
SAFETY



*well-being*  
COMFORT



“I’m **afraid the virus** is still in the hotel. Maybe I will be infected.”



- Air transmission is the primary means of spreading the CoV-19 virus - through coughing, sneezing or heavy breathing.



- The disease is also spread through physical contact with infected people



### **By touching an infected surface.**

- The corona virus can live on an object for several days. If a person touches an item with the virus on their hands, the next person can pick up that virus by touching the same object.

How can we reduce transmission via surfaces?

CLEANING



INHERENT  
RESISTANCE



# MATERIAL COMPARISON

 Virus resistance

 Chemical resistance

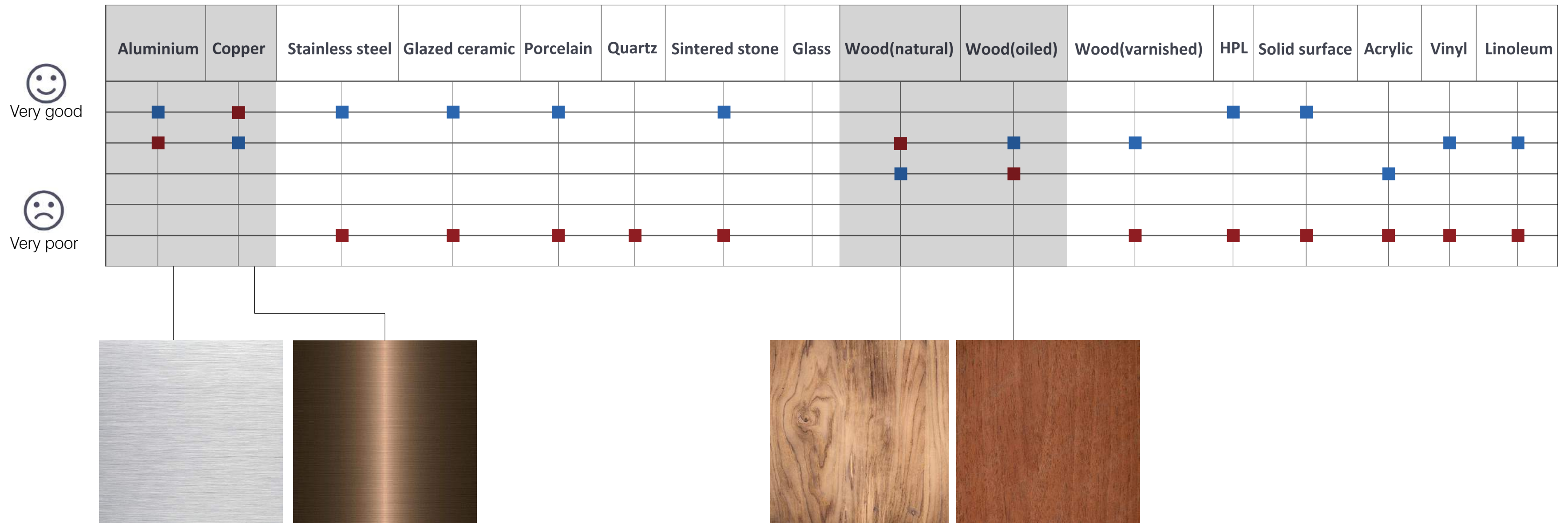



# SAFETY MATERIAL ASSEMBLY

*Hygiene, Protective, Easy to clean*

Copper

Aluminum

Ash(natural)

Fabric

Brass

Ash(oiled)

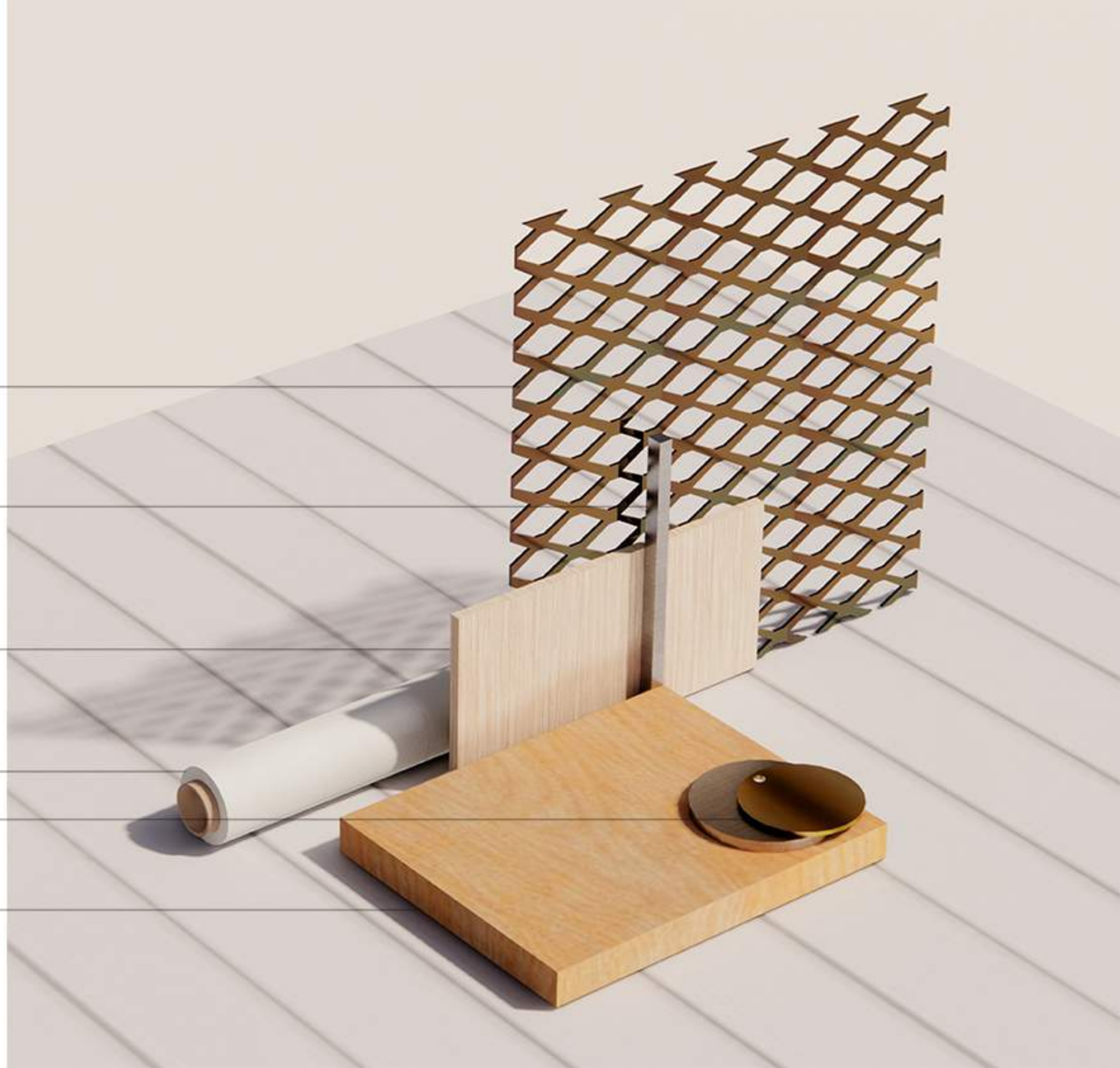

*health*  
SAFETY



*well-being*  
COMFORT



"I can only communicate with others through mobile phone, sometimes I feel **lonely.**"







"I have never been in jail in my life but this experience felt like it. I have never before suffered from depression but after my time in the quarantine hotel I now understand the meaning of the word."

# EMOTIONAL CHANGES IN THE QUARANTINE HOTEL

Day 1-3

From feeling new to getting used to it.



Day 14 Excited



Day 4-6

Getting bored.



Day 13 Hopeful.



Day 11-12

Begin to numb.

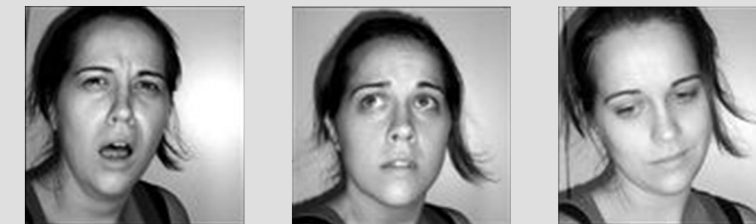

Day 7-9

Begin to feel lonely.

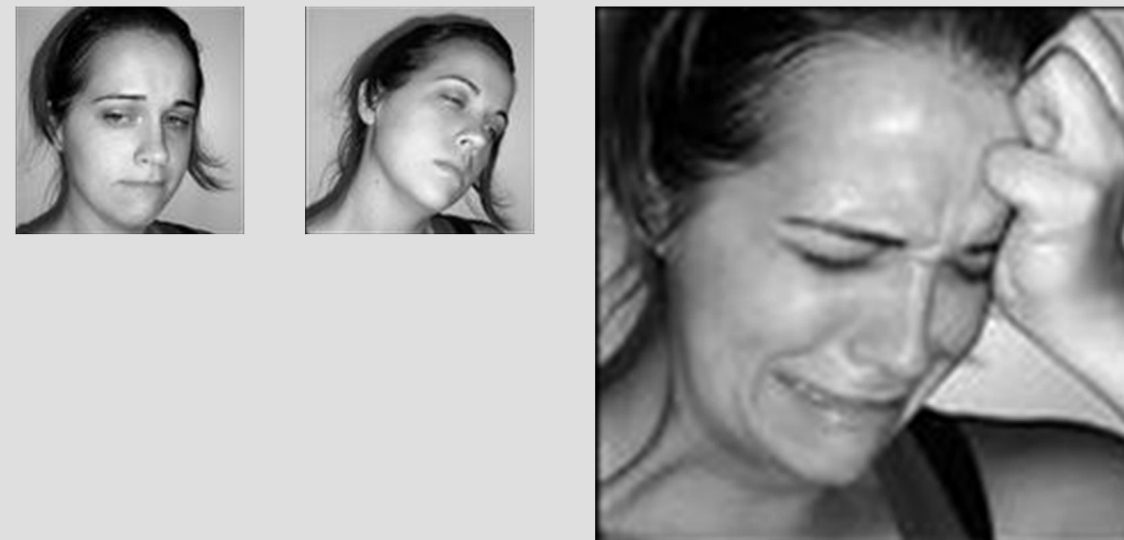

Usually, people can't bear isolated life in the ninth day.



# WHAT CAN I DO TO REDUCE THEIR NEGATIVE EMOTIONS?

SEPARATION



Let people be happy alone.

CONNECTION



Create places for people to interact with each other.

# SEPARATION



*COLD*

*WARM*



*HARD*

*SOFT*





*ESTRANGEMENT*



*INTIMATE*





*REGULAR*

*NATURAL*





# SEPARATION MATERIAL ASSEMBLY

WARM

SOFT

INTIMATE

NATURAL

Linen

Ash

Cotton

Beech

Sponge

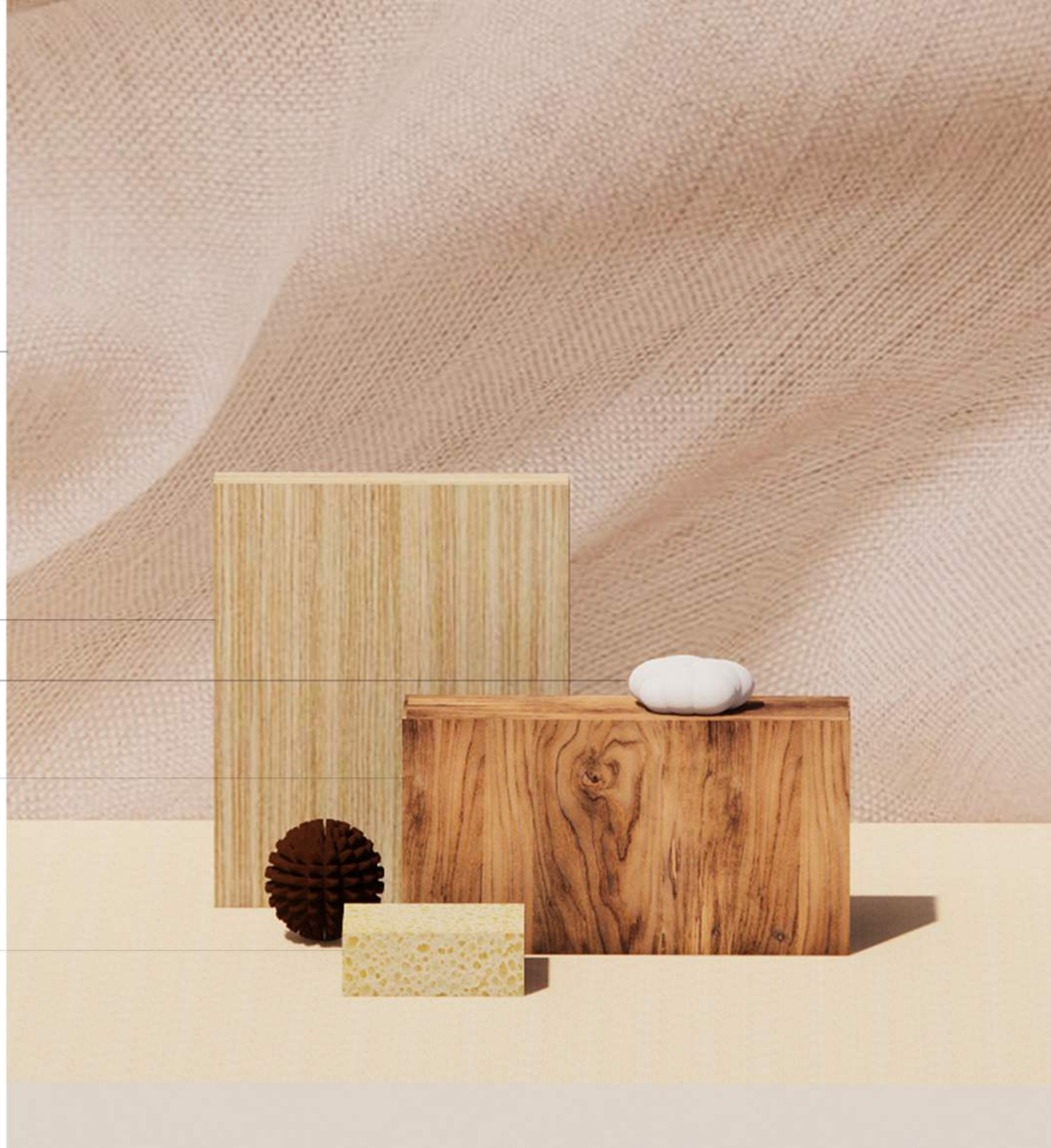



WARM

SOFT

Linen

upholstered wall panels



Beech

bed frame



INTIMATE

NATURAL





CONNECTION



CONNECT WITH SOMEONE YOU LOVED



It can only be achieved through electronic devices.

CONNECT WITH SOMEONE YOU DO NOT KNOW



Direct contact

Make contact with strangers.



Shared experience

Communicate at a distance with people from the past.





## SHARED EXPERIENCE



It allows you to "meet" people who have been through the same thing at different times.





Jason Bruges Studio, Sunderland Station

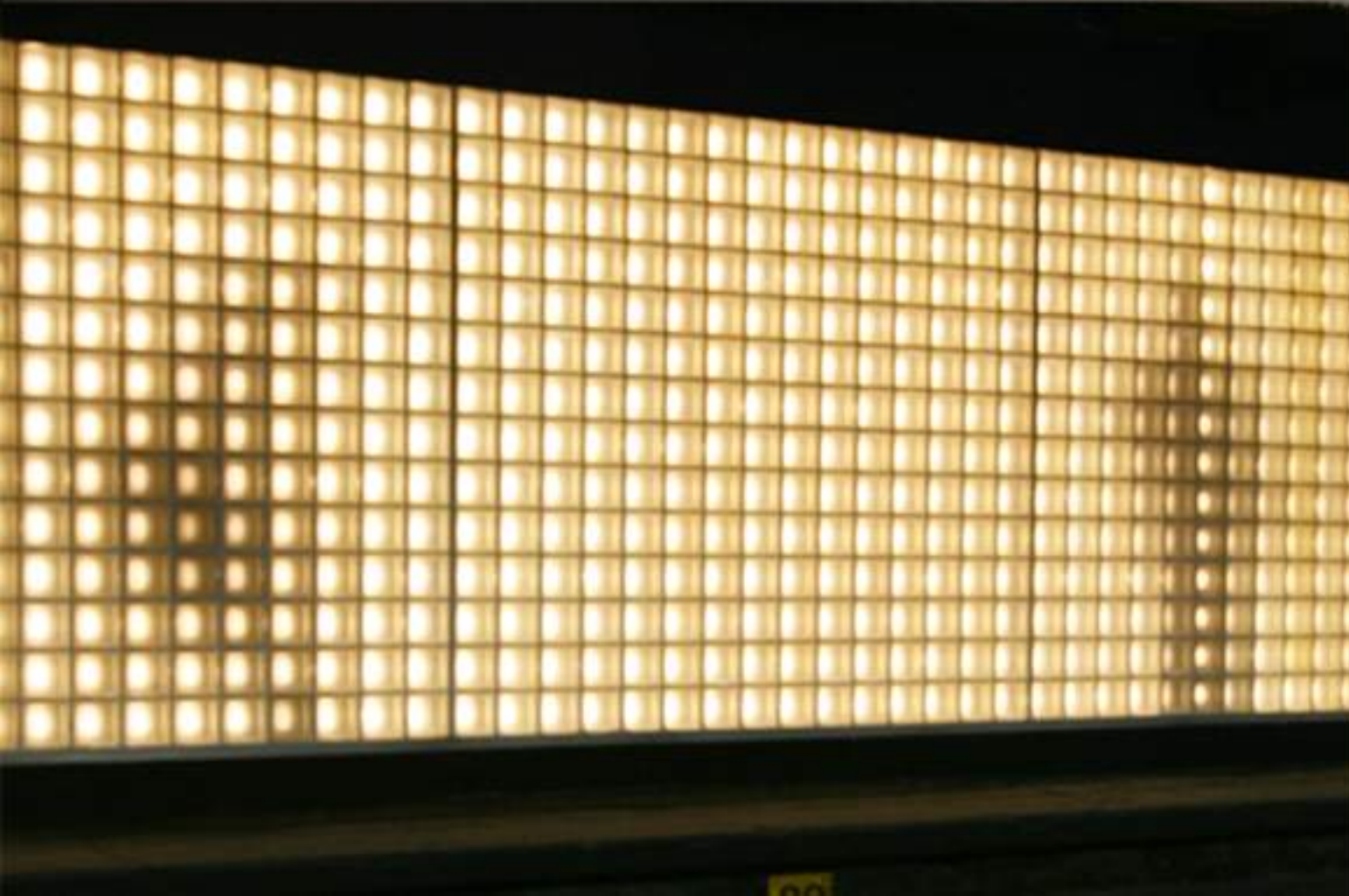

Behind the wall is a disused platform, which long ago used to see passengers waiting for trains.





## MATERIAL CONSIDERATIONS



Recordable



Ages



Can be controlled on or off



# MEMENTO MATERIAL ASSEMBLY

LED nodes

Patinated Copper

Paper





# MEMENTO WALL

## Patinated Copper

*provide some sense of the passage of time.*



## Bespoke LED nodes

*The screen will show the shadow of the previous tenant.*



## Glass Block

*providing moderate light transmission, and it also provides a hazy effect for the shadow.*



## White Wall

*The simple background keeps people's eyes focused on the screen*

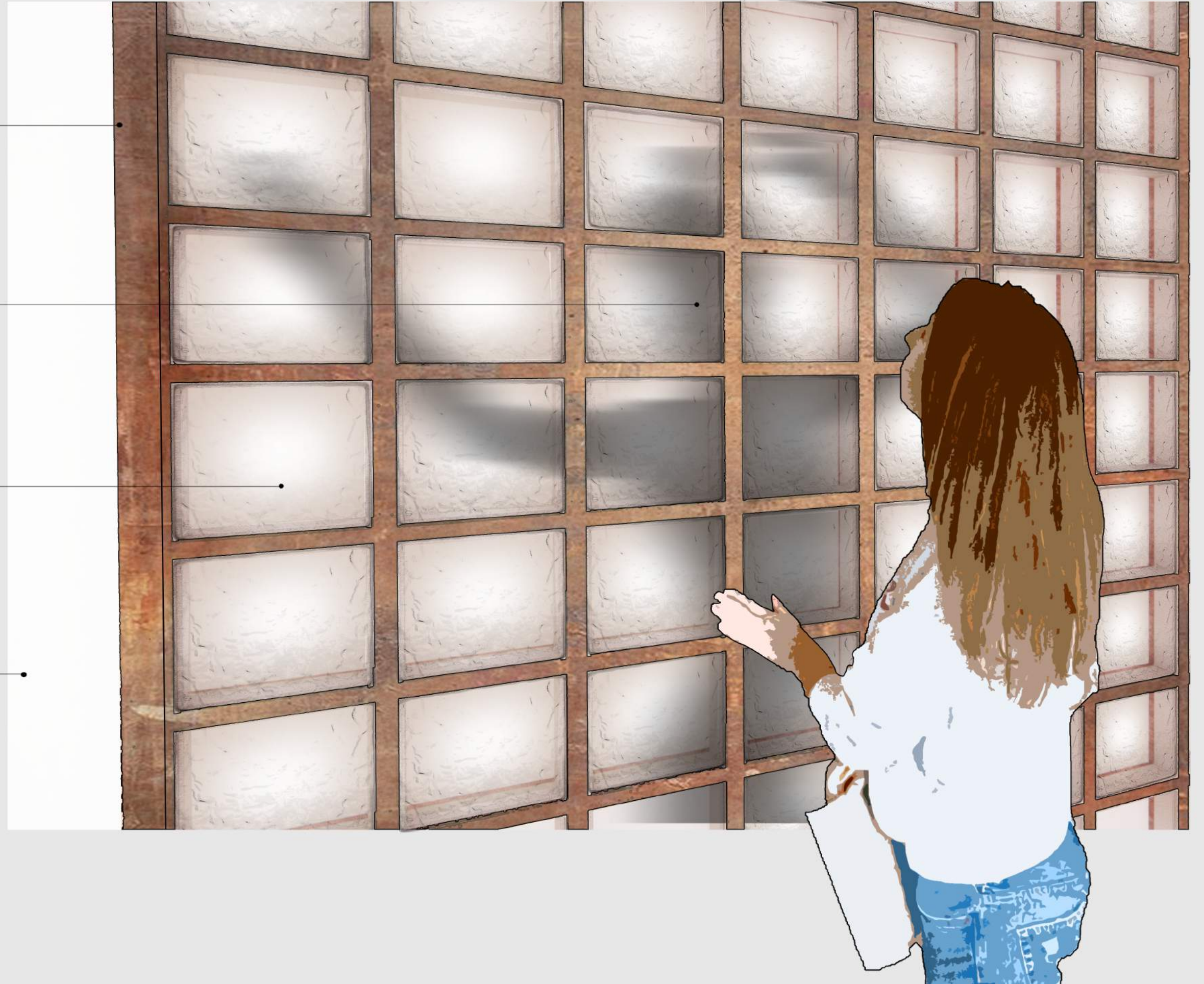





## DIRECT COMMUNICATION



For safety reasons, people are only allowed to make eye contact and use their phones to assist voice communication.



# Glass Comparison



Annealed Glass



Frosted glass



Emulsion opal glass



Laminated Glass



Textured Glass



Glass block



# INITIAL IDEA

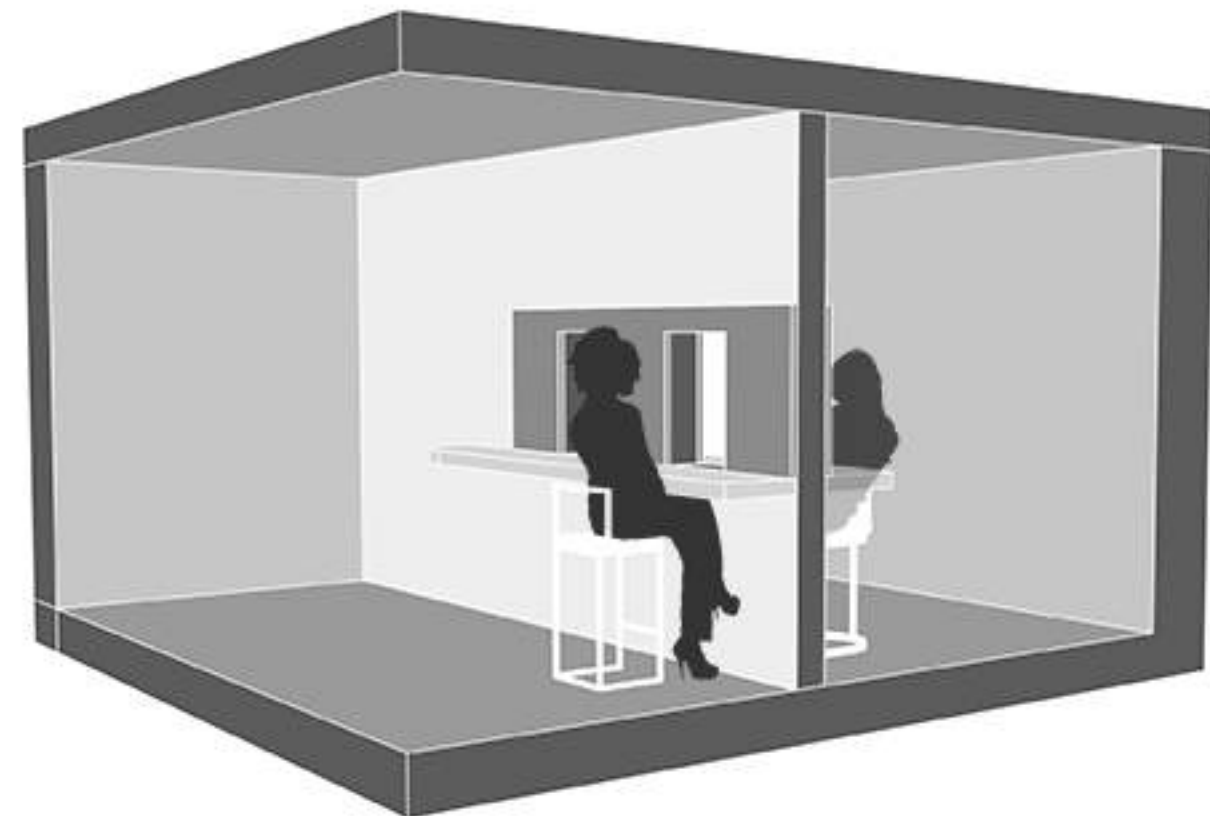
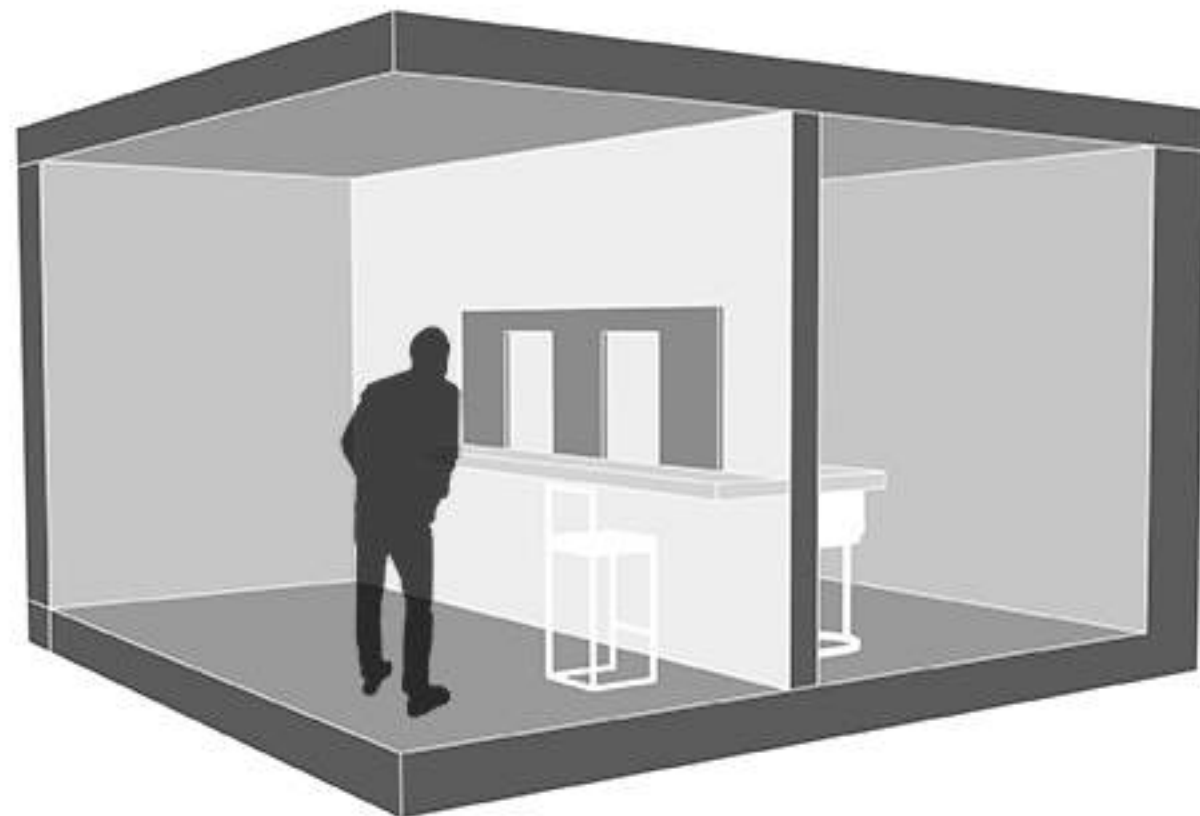
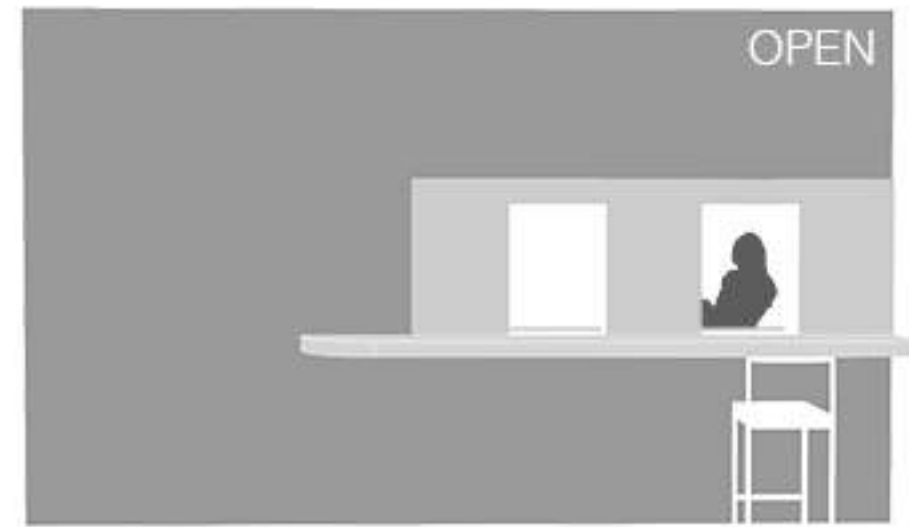
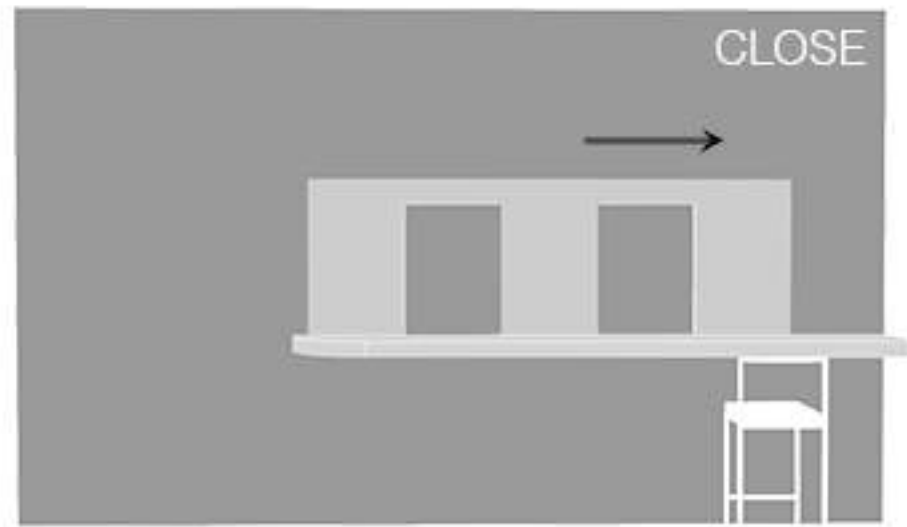





**MARBLE**  
Providing a sense of luxury and elegance feel to the bar.  
Soft textures make people relaxed.



**OILED OAK WOOD**  
Resistant to dings and dents.  
Easy to clean.



**MIRRORED BRASS**  
Very durable.  
Has the same healthy surface as copper , but cheaper.





Laminated Glass



Texture Glass







*health*  
SAFETY



I'm afraid the virus is still in the hotel. Maybe I will be infected.

*well-being*  
COMFORT



"Some people like to sing in the room, which **bothers me.**"





# ACOUSTIC ABSORPTION

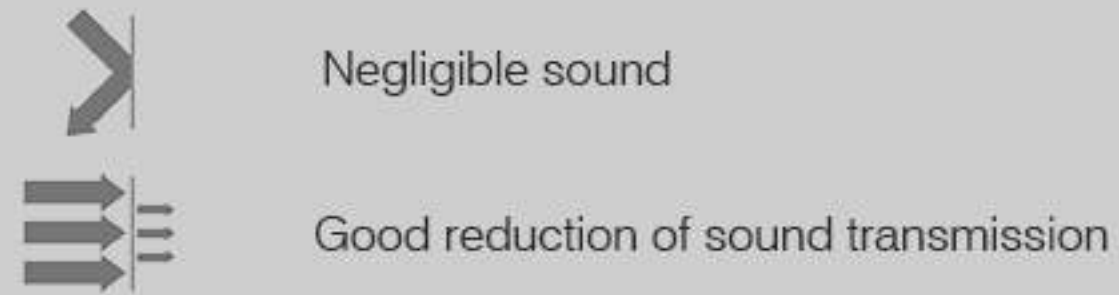
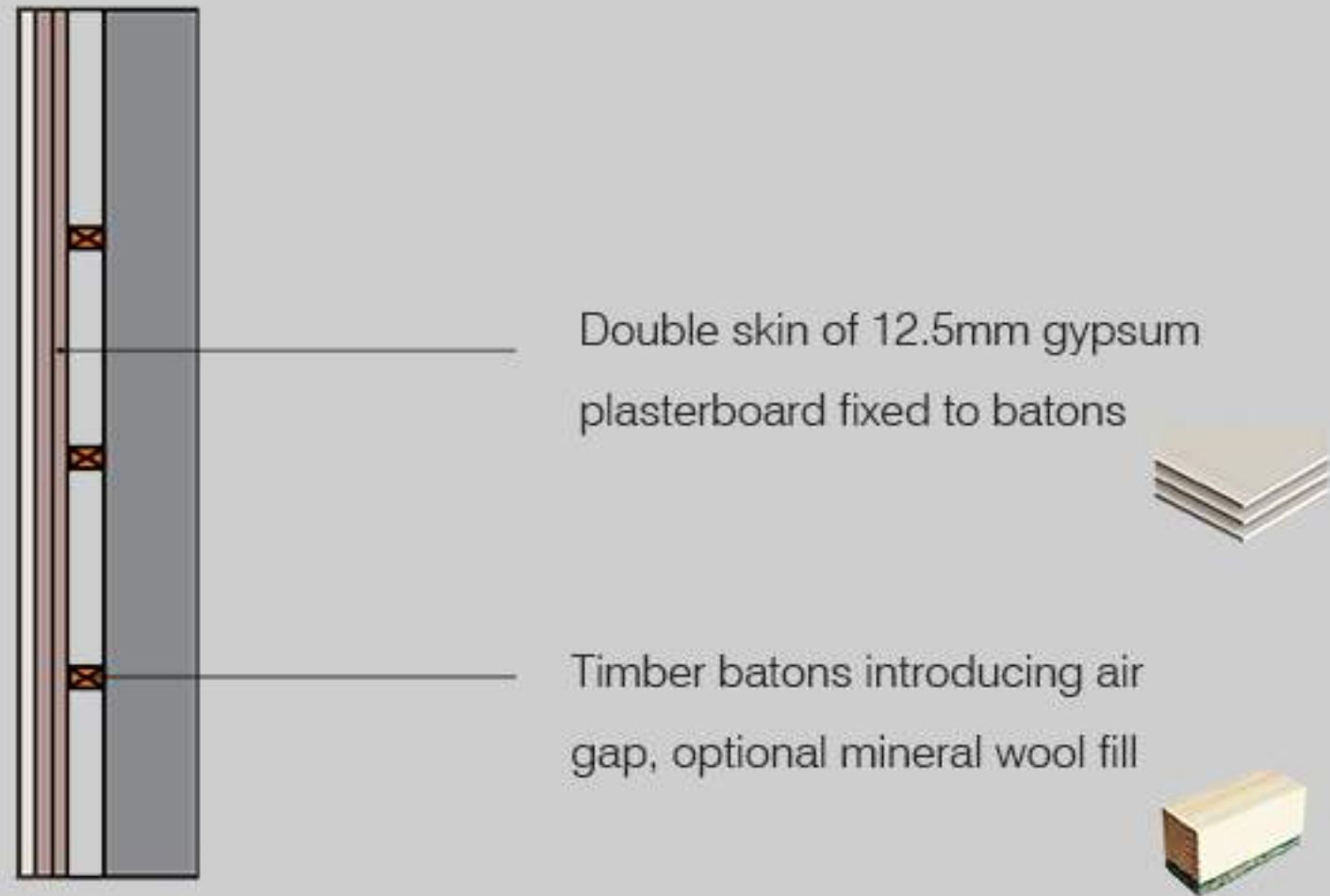

# ACOUSTIC REFLECTION

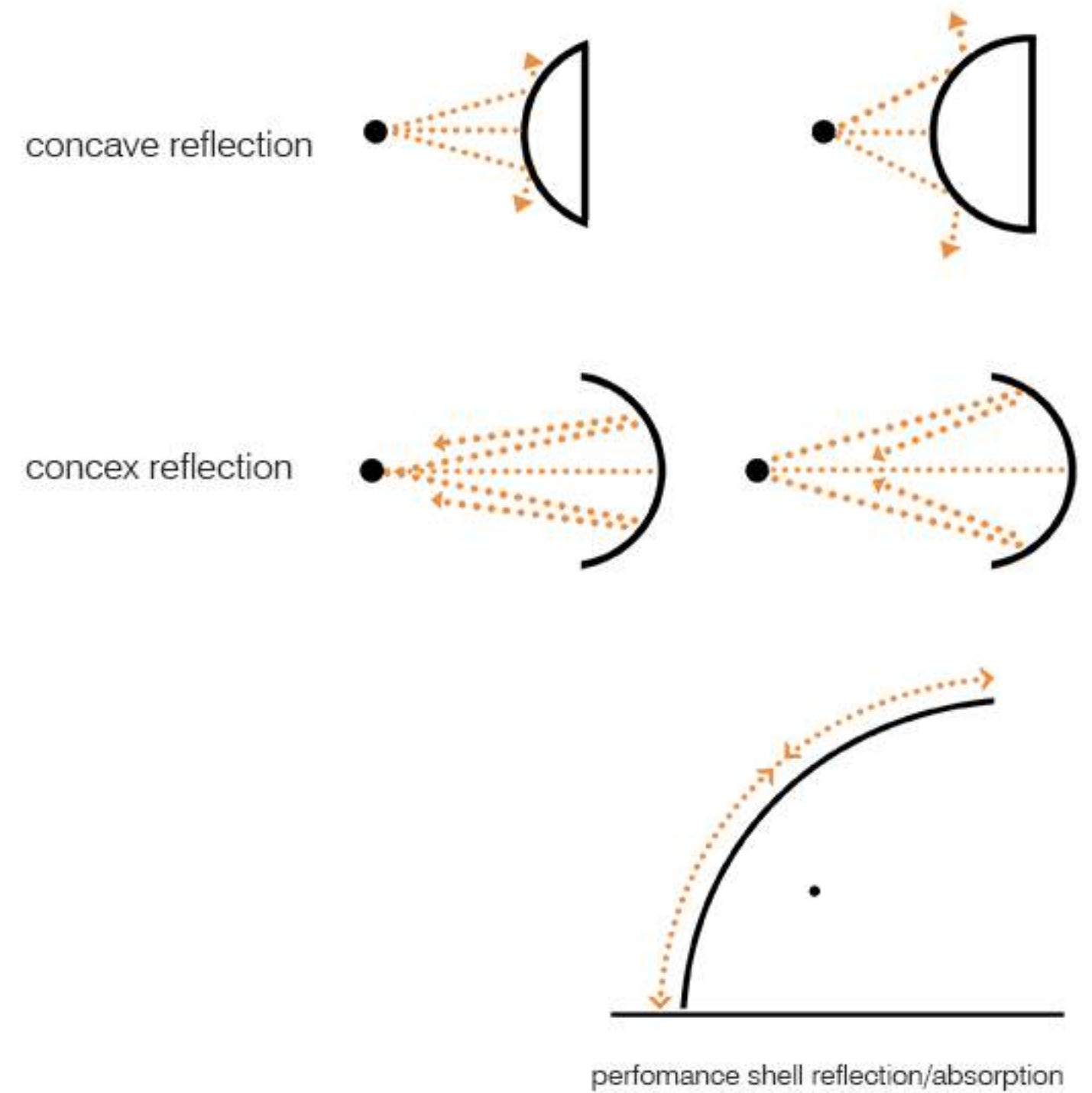



# ACOUSTIC REFLECTANCE

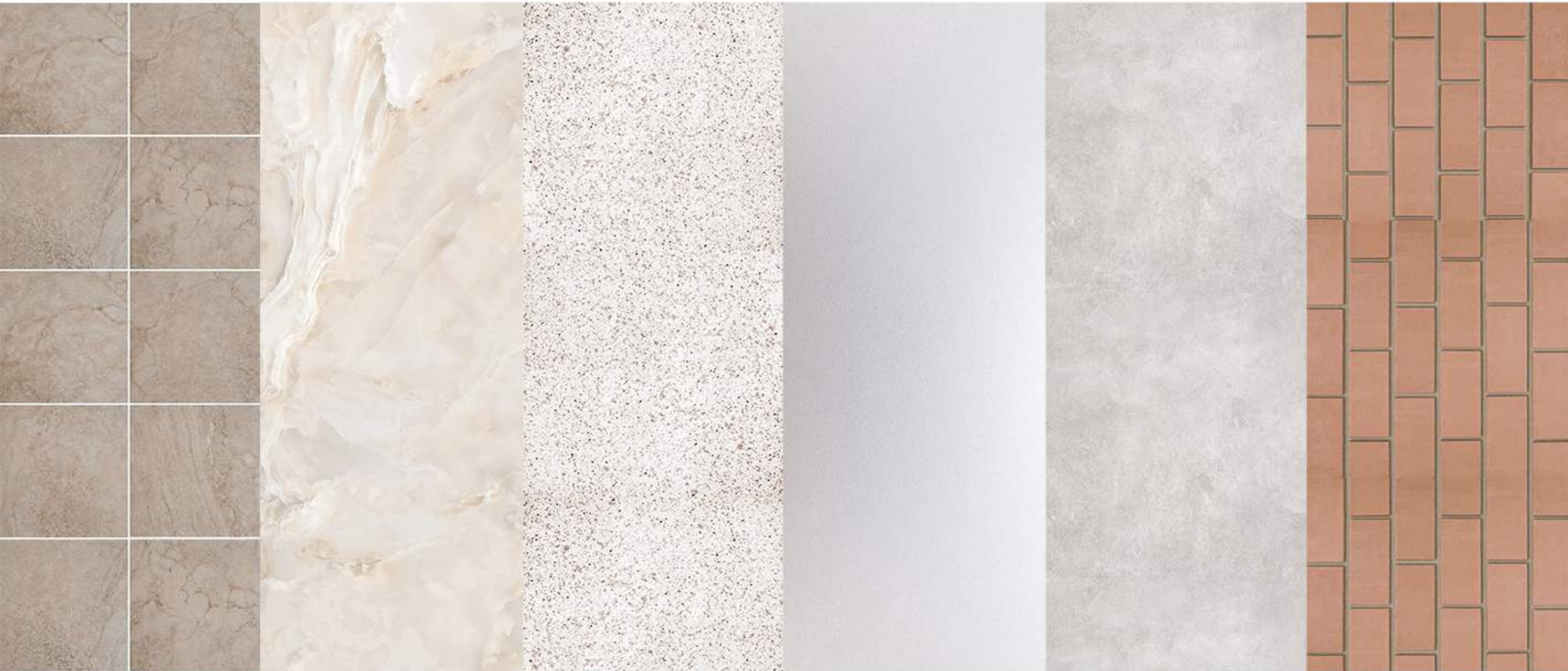

Ceramic tiles



Marble



Granite



Glass



Smooth concrete



Clay brick



# REFLECTION MATERIAL ASSEMBLY

Marble

Glass

Ceramic tile

Brass

Ceramic

Granite











## BATHROOM MATERIALS



Granite



Marble



Ceramic Tiles



Marble



Brass



Glass



*health*  
SAFETY



*well-being*  
COMFORT

“I have no place to **exercise**  
and I'm getting weak.”





### STEEL WIRE

The very high strength of the rope wires enables wire ropes to support large tensile forces.



### BEECH

Very hard, tough and strong , with a close straight grain .  
Polishes well and with stands shocks and wear.





## Rubber Floor

Mainly used in the gym, it can protect the body very well.

Very soft and easily deformed, not suitable for holding heavy objects for long periods of time.

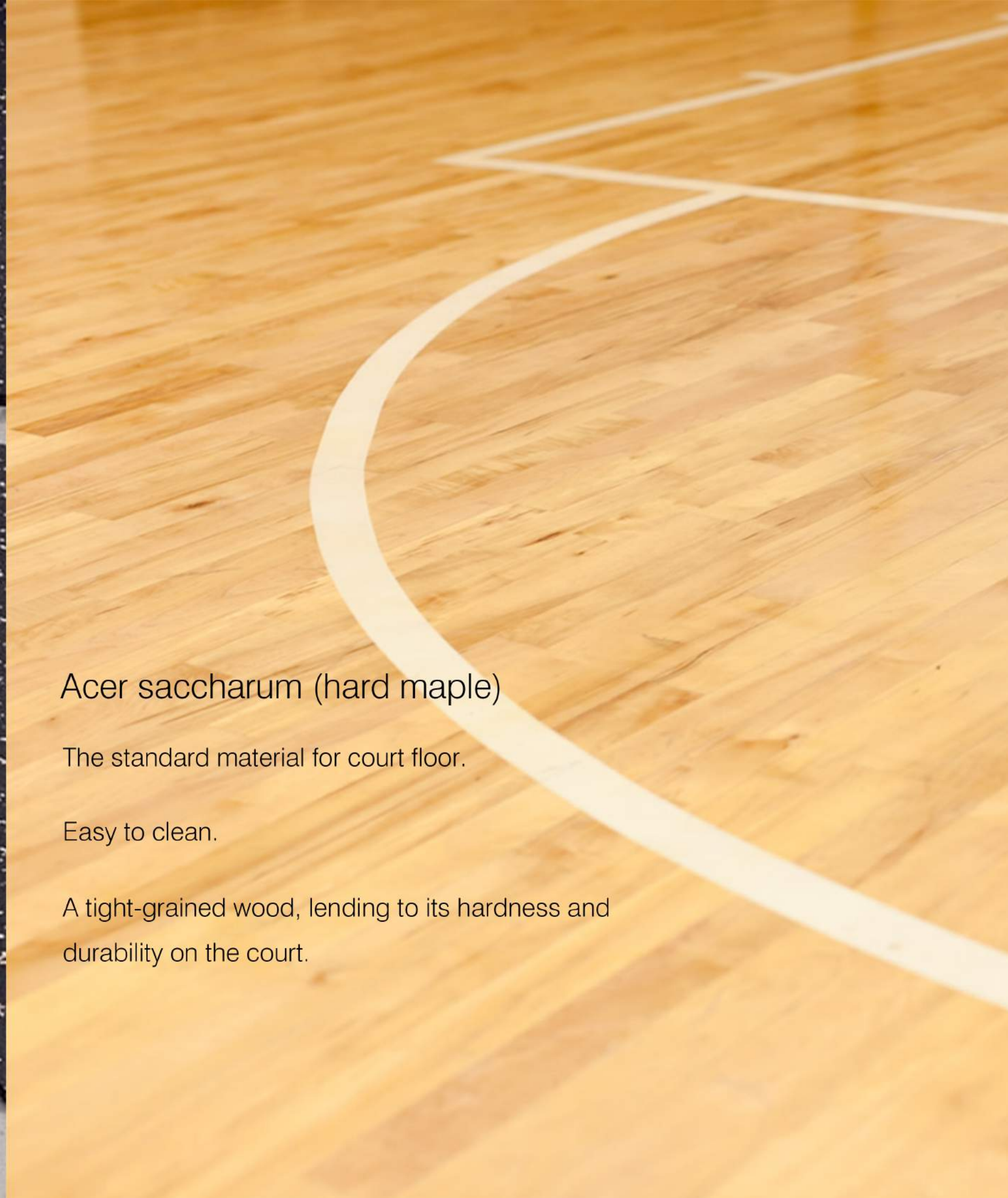

## Acer saccharum (hard maple)

The standard material for court floor.

Easy to clean.

A tight-grained wood, lending to its hardness and durability on the court.



COMFORT AND RELAX ASPECT

Linen

Upholstered wall

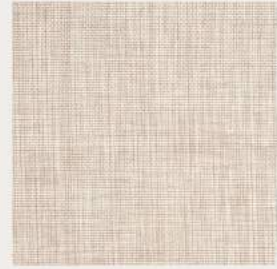

Beech

Bed frame



Ash

Furniture



EXERCISE AND SAFETY ASPECT

Hard maple

Floor



Brass

Furniture





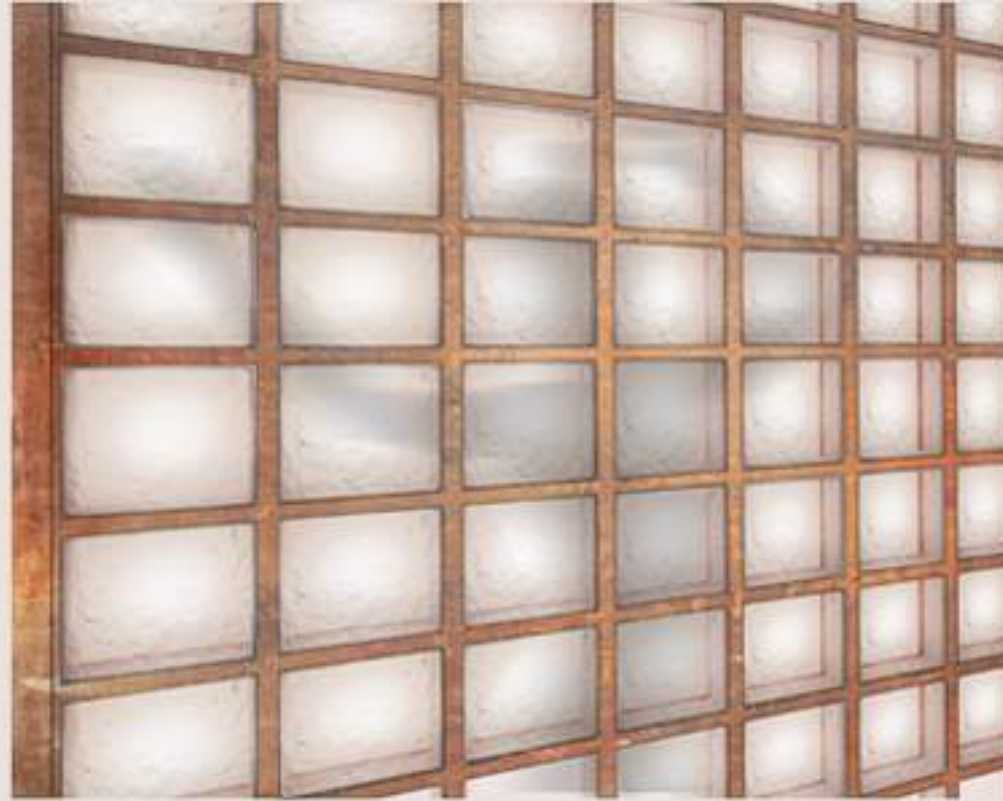



*THANK YOU*