

Make It Rain





Love is based on things unrelated to affection and attraction

*The Lobster (2015)*



The let-there-be-light moment turns on  
a lamp of critical awareness

*Movies and Midrash : Popular Film and Jewish Religious Conversation*  
Wendy I. Zierler and Eugene B. Borowitz

*The Truman Show (1998)*

**In what ways is scenography utilised to resonate with people in the construction of human-scenographic relationships?**

## **Scenography**

**the dynamic organisation of different senses within spaces for certain design purposes**

## **Human-scenographic relationships**

**experiences and emotions created when the connection is built between people and the space**

*the art or job of designing and creating scenery (= paintings or images used to represent a place) for a show or event.*

*Cambridge dictionary*

*...designing communication which influences the performance environment to shape the **audience's experience**.*

*Stage Management : Communication Design As Scenography  
by Michael Smalley , and Simon Shepherd*

Floor Plans as a way to illustrate space

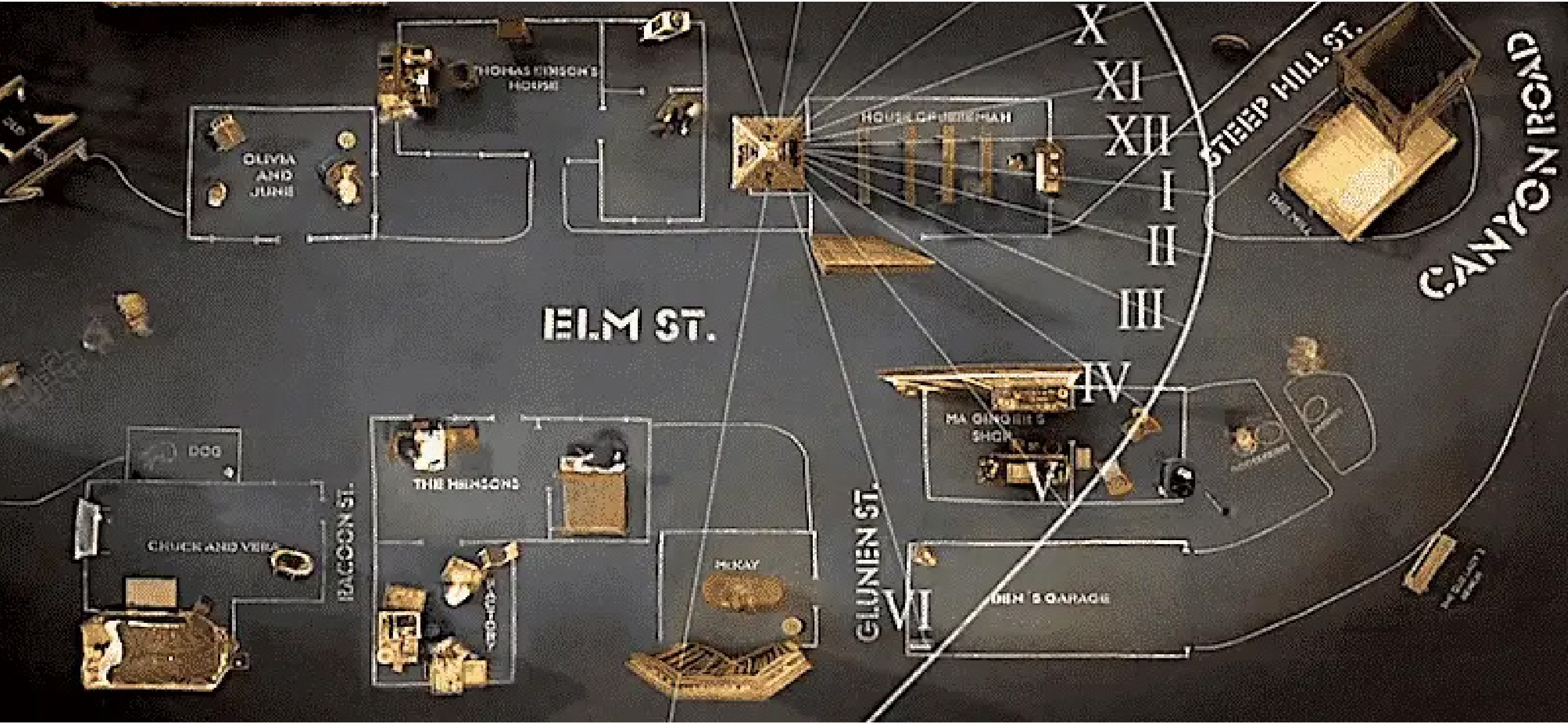

Dogville(2003), Lars von Trier

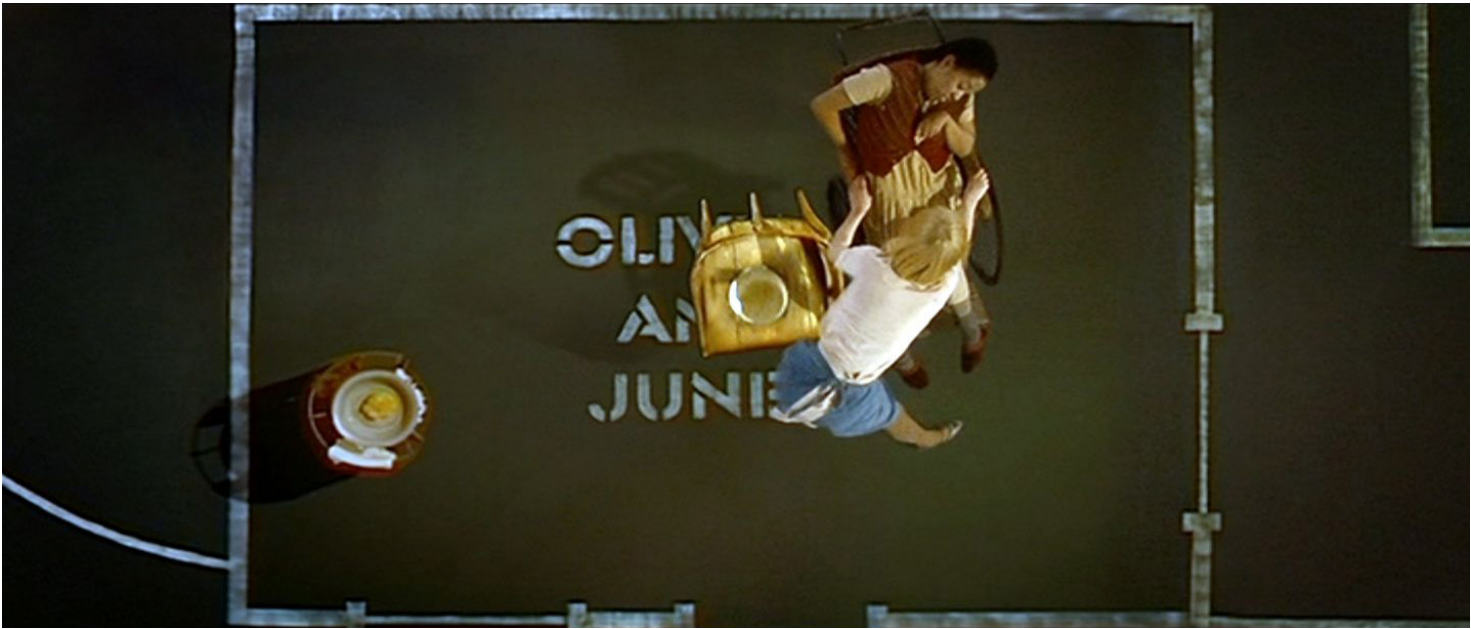

Using placards, a common convention in epic theatre, scenes were introduced to the spectators. **Chalk lines** are applied on the floor to **divide and mark spaces**, allowing the audience to observe from a **critical perspective**.

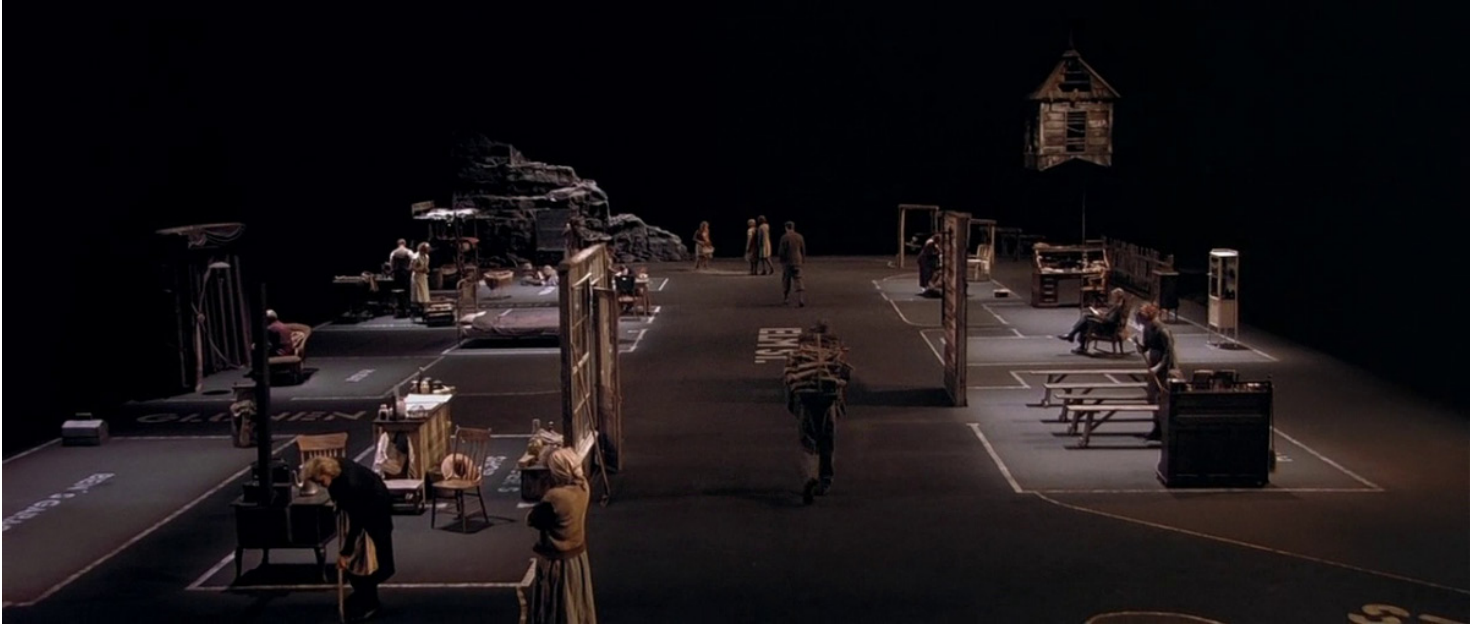

Sets in movie Dogville

On the other hand, the **wall-less design** of the set directs the audience's focus primarily on the performance and narration itself, encouraging them to fill in **missing information** within the minimalism. The characters interact with the space as they normally would, but in an almost **surreal** fashion.

## Techniques from stage

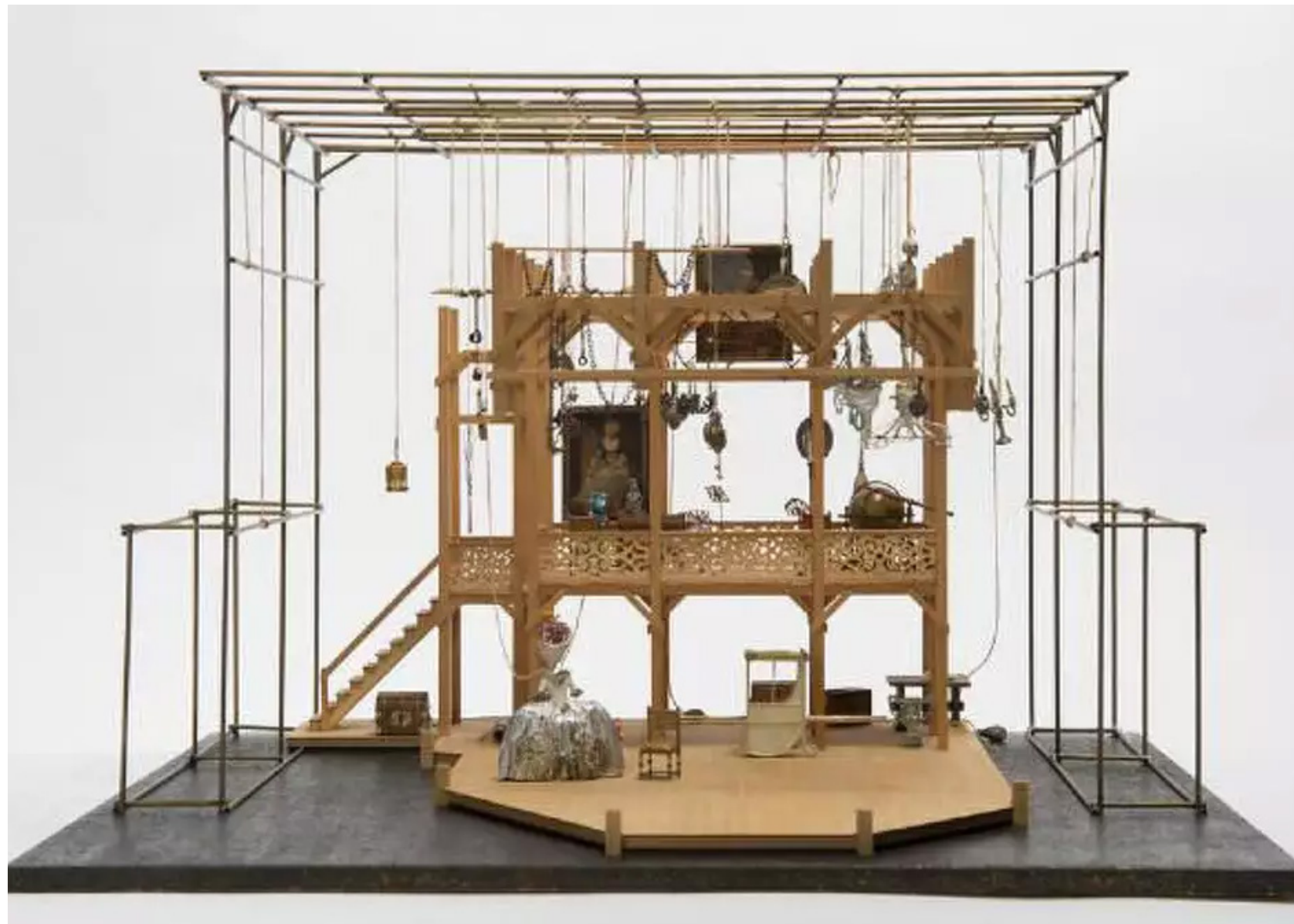

*The Beggar's Opera, Tony Straiges, 1979*

Everything the hero needs is **suspended** above the stage. **Wooden trusses** provided a fly space for props. Lightings, ceilings and other systems can be **lowered** or **replaced** for staff to access and work.

## Scaffolding&Trusses

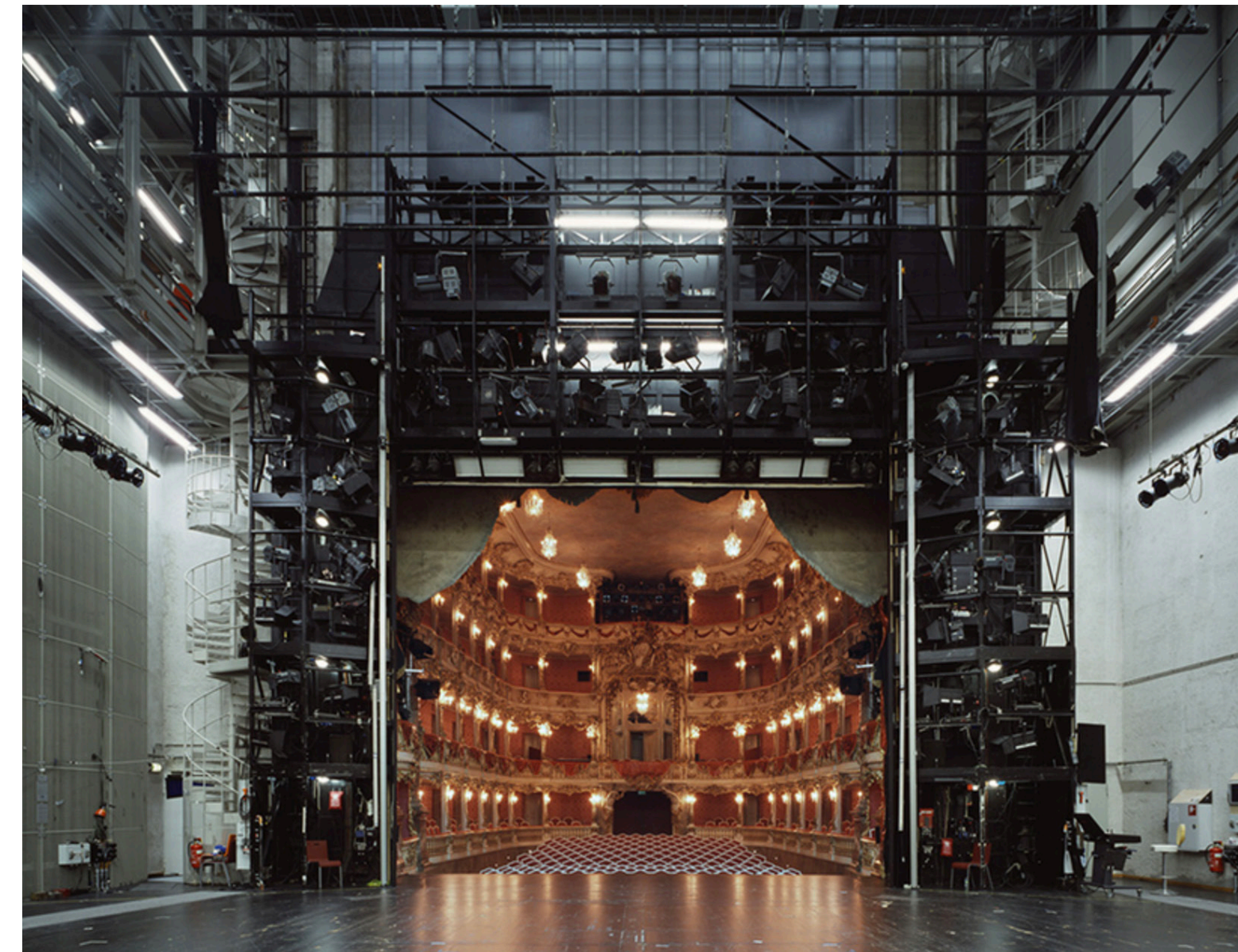

*The fourth wall, Photographer Klaus Frahm, 2010*

The fourth wall (the invisible stage barrier), which includes classical construction elements such as intricately **constructed networks of scaffolding** and **complex lighting structures**, architectural details, and properties of a play, offers an overlooked vantage point for the actor. Scaffolding can be used to highlight the **features** of a **stage**.

# Special effect on stage

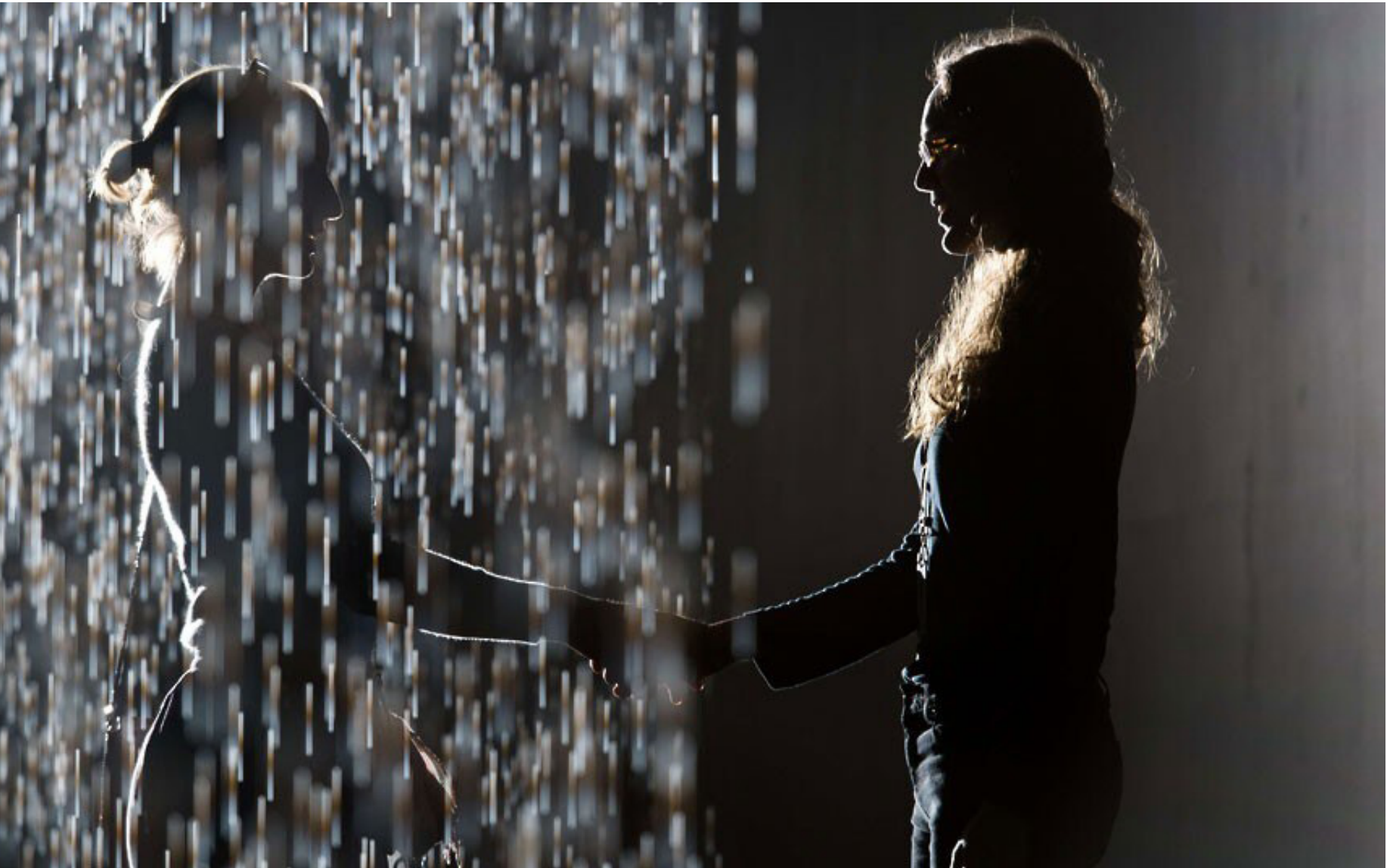

*Rain Room, Curve gallery, Barbican Centre, 2012*

The visitor hears the sound of water and feels moisture in the air before discovering thousands of **falling droplets** that respond to their presence and movement. A **controllable water system** can serve as a means to control the environment.



*The Crucible, Es Devlin, National Theatre, 2022*

A hidden gutter drains the downpour, allowing water to be reused, creating an environment that captivates its audience through **illuminated rainfall**. Water can be applied to the set to create **various experiences**.

This project critiques whether a perfectly designed **artificial world** can fulfill people's desires through **manipulation**.



Name: Annie

Gender: Female

Date of Birth: 19 Feb 2015

Address: Flat pineapple, Alice Court, The World's End, Shanghai, China

Email Address: 760372564@qq.com

Profession: Librarian

Time : 2050

## A Glass Prison

Midjourney  
Prompt:

Wide office windows of a skyscraper like a glass prison, loads of people busy working talking and walking, only cold white lighting at midnight, stressful lifestyle in mega city, long exposure of heavy traffic on the street. --ar 16:9



Escape

<https://10016125.wixsite.com/theworldsend> To

The World's End

Midjourney  
Prompt:  
An Asian girl meditating and having a stretch out, eyes closed, wide shot from side, linen round mat, warm environment, relaxed time to escape from the modern world, simple floor lamp, large tropical plants, elegant cabinet professional photography. --ar 16:9

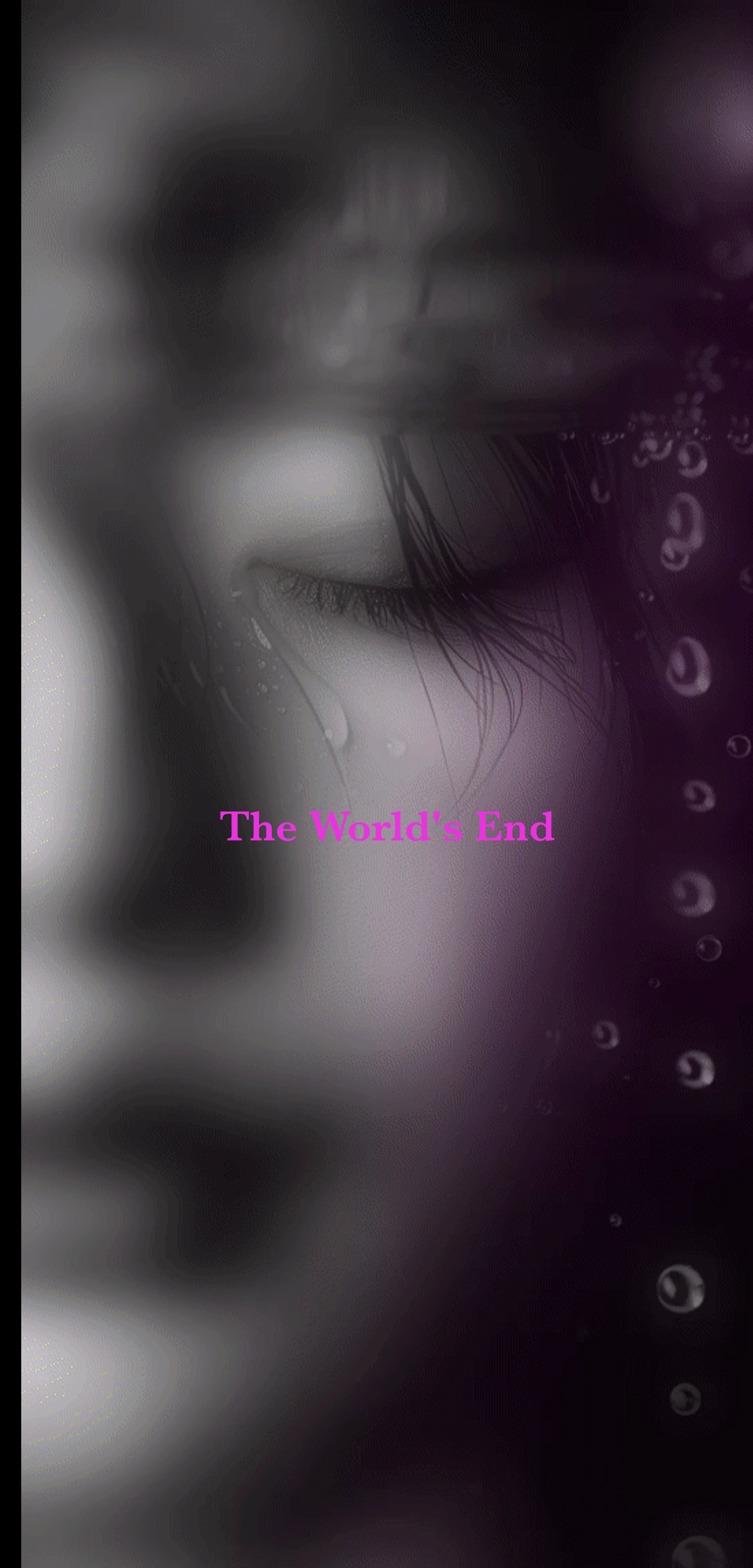

Shanghai City



A wide-angle photograph of a modern Chinese resort entrance in a lush forest. In the center, a bronze sculpture of a man in a long suit holding an umbrella stands on a rock, with water spraying from the umbrella's handle to form the shape of the umbrella. To the left, a large, dark rock sits in a shallow pool of water. In the background, a traditional Chinese building with a tiled roof is visible, partially obscured by trees. On the right, a modern building with a dark, overhanging roof and large glass panels is illuminated from within. The scene is set in a dense forest with various types of trees, including weeping willows. The overall atmosphere is serene and elegant, with a focus on traditional Chinese aesthetics integrated with modern architecture.

The rain leads you to the entrance

Midjourney

Prompt:

Extra wide shot, a brass gentelman in long suit holding an umbrella wearing a hat sculpture fountainon, water sprays out from the handle forming the umbrella, the sculpture stands on the right side of the road, a huge rock on the leftside of the road, entrance to a morden chinese sesort in forest by a lake, rooftop of resort hided in the forest , few warm lights inside, highly detailed, photography. --ar 16:9



## A Warm Welcome Package

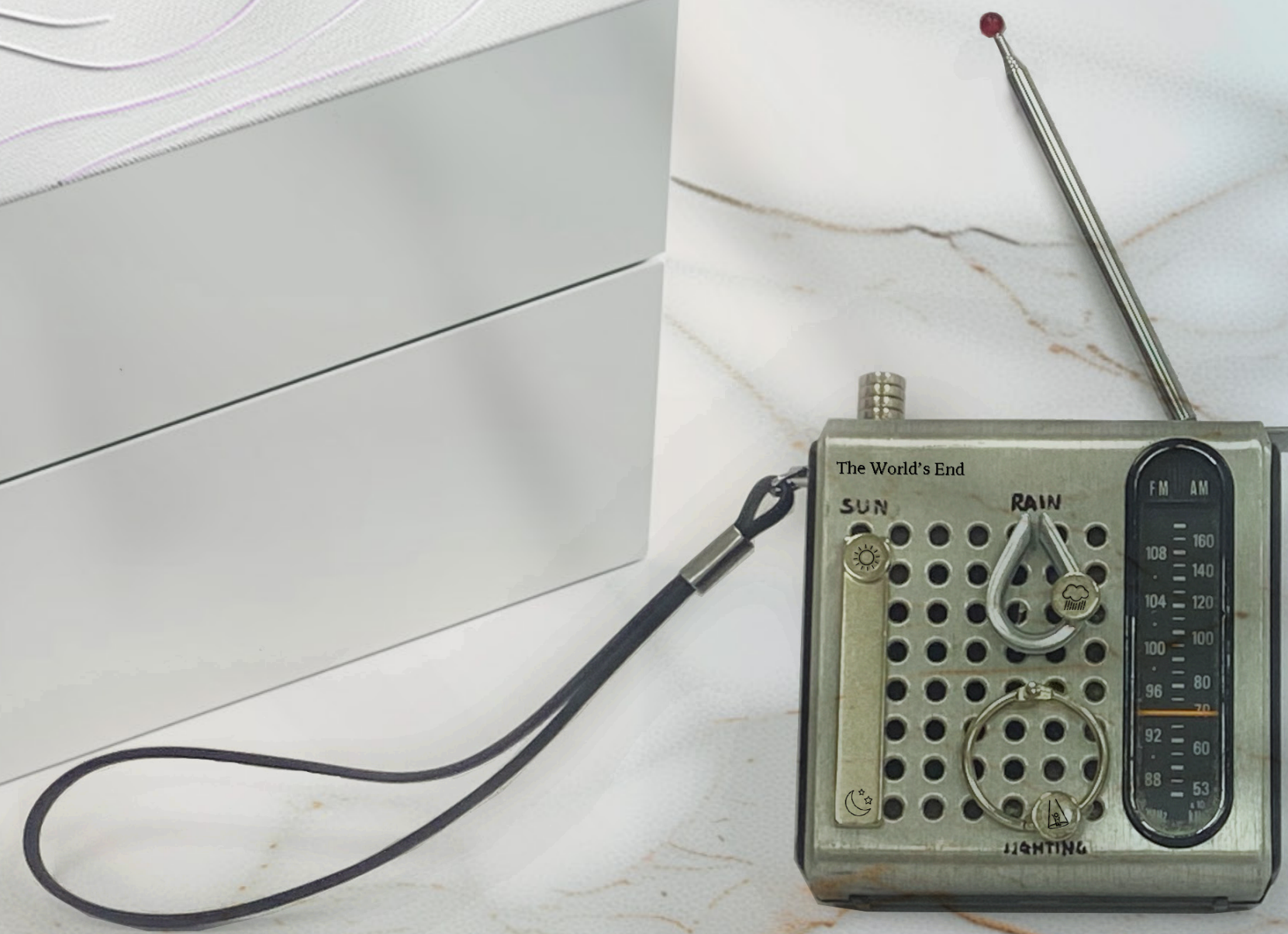

Midjourney&Photoshop

Prompt:

minimalist Japanese style, luxury white square deep box, round shape ripples in fine and thin lines embossed on lid, classic Italian Calacatta gold marble background, welcome package for new residents of the community, highly detailed, product photography, professional 3 point lighting. --ar 16:9



**Check-in at Pineapple**

Midjourney  
Prompt:

wide shot, big window, plants outside, sun shines through the window, warm atmosphere, soft and cozy bed with duvet and pillows, beige wall paper, creamy carpet under the bed, an armchair by the window, a floorlamp and a side table by the chair, highly detailed, professional photography. --ar 16:9

# Make It Rain



# Private space

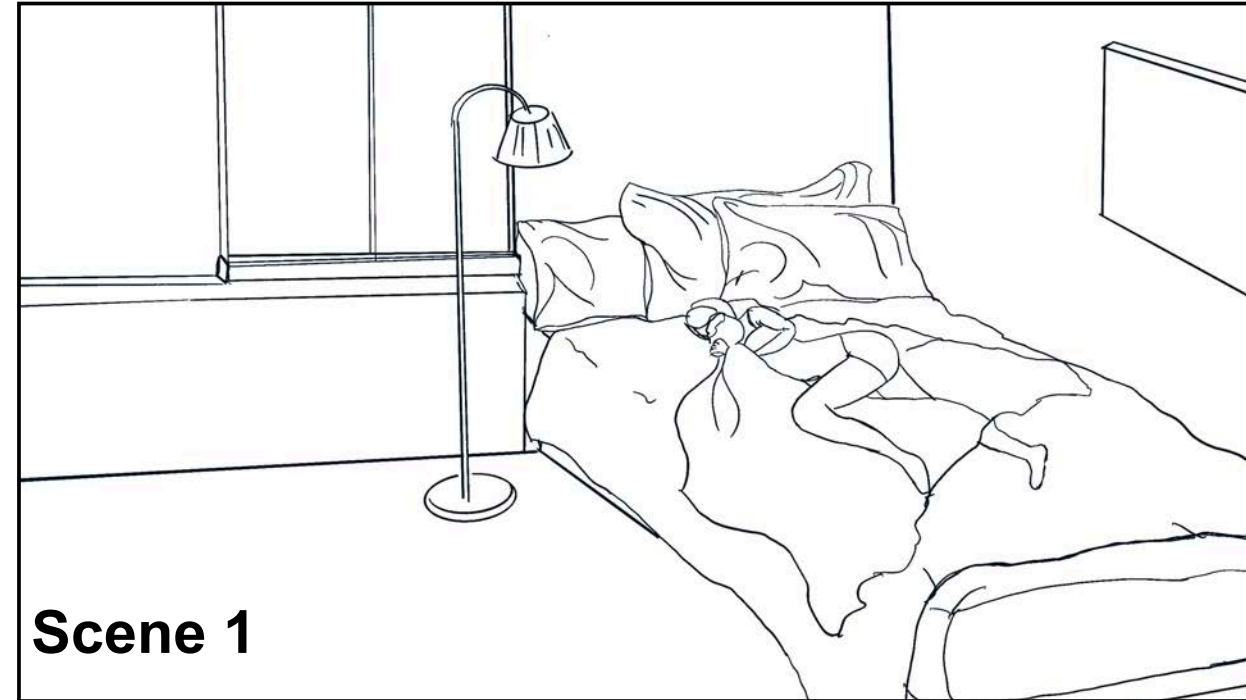

**Scene 1**

INT.-Bedroom-Morning

Full shot

Description: lying in bed, scrolling her phone



**Scene 2**

INT.-Kitchen-Morning

Close up

Description: making coffee with a moka pot

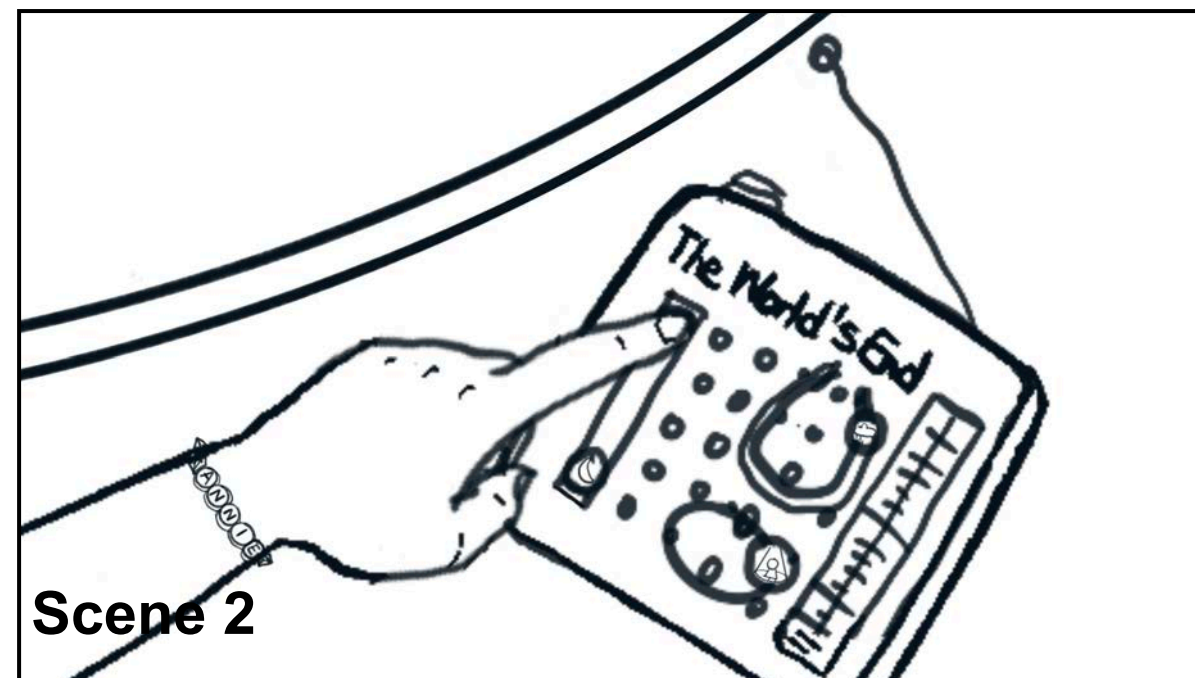

**Scene 2**

INT.-Bedroom-Morning

Close up

Description: sliding up the button, lighting gets brighter

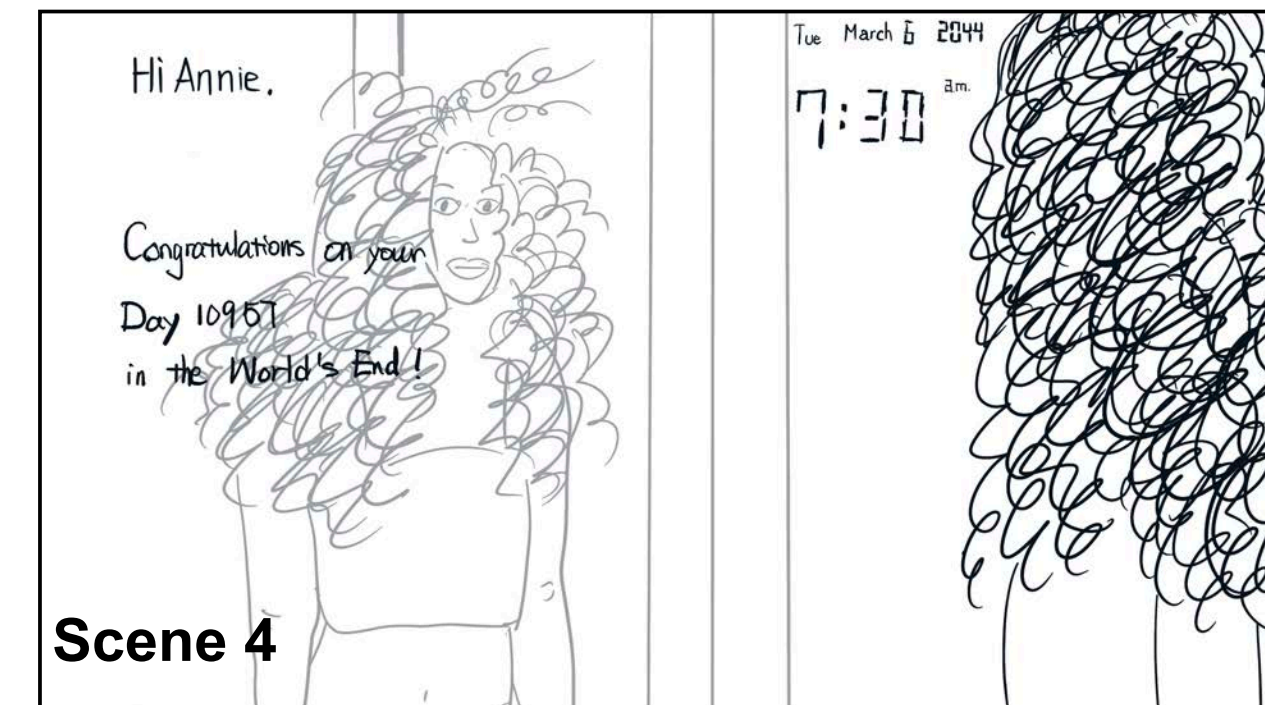

**Scene 4**

INT.-Bathroom-Morning

Medium shot

Description: standing in front of mirror, tapping bracelet, combing hair with hands

# Iterations in Mid journey



Prompt:cinematic poster, a young single messy long black hair Asian girl, relaxed, holding a cup of espresso, a small white living room, large plain white walls, a wide French window with veneer, large plants, a small cozy white sofa, a simple white round side table, futuristic living style, highly detailed, natural landscape and tall modern buildings outside, the sun light gently shines into her face, professional lighting, realistic photography --ar 16:9



Prompt:cinematic poster, a young single messy long black hair Asian girl relaxing and holding a cup of espresso, a small white living room, large plain white walls, a wide French window with veneer, the sun light gently shines into her face, large plants around, a small cozy beige armchair with pillows, a round side table made with clear glass, highly detailed, natural forest and lake window view, shanghai suburb, professional lighting, realistic photography --ar 16:9



Prompt:an asian girl sitting on a creamy linen beanbag with pillows relaxing and holding a cup of espresso, a white bedroom, beige fabric wallcovering, a wide window with veneer, the sun light gently shines onto her face, large plants around, a round side table made with clear glass, artwork on wall, natural forest and lake window view in shanghai suburb, highly detailed, professional lighting, realistic photography --ar 16:9

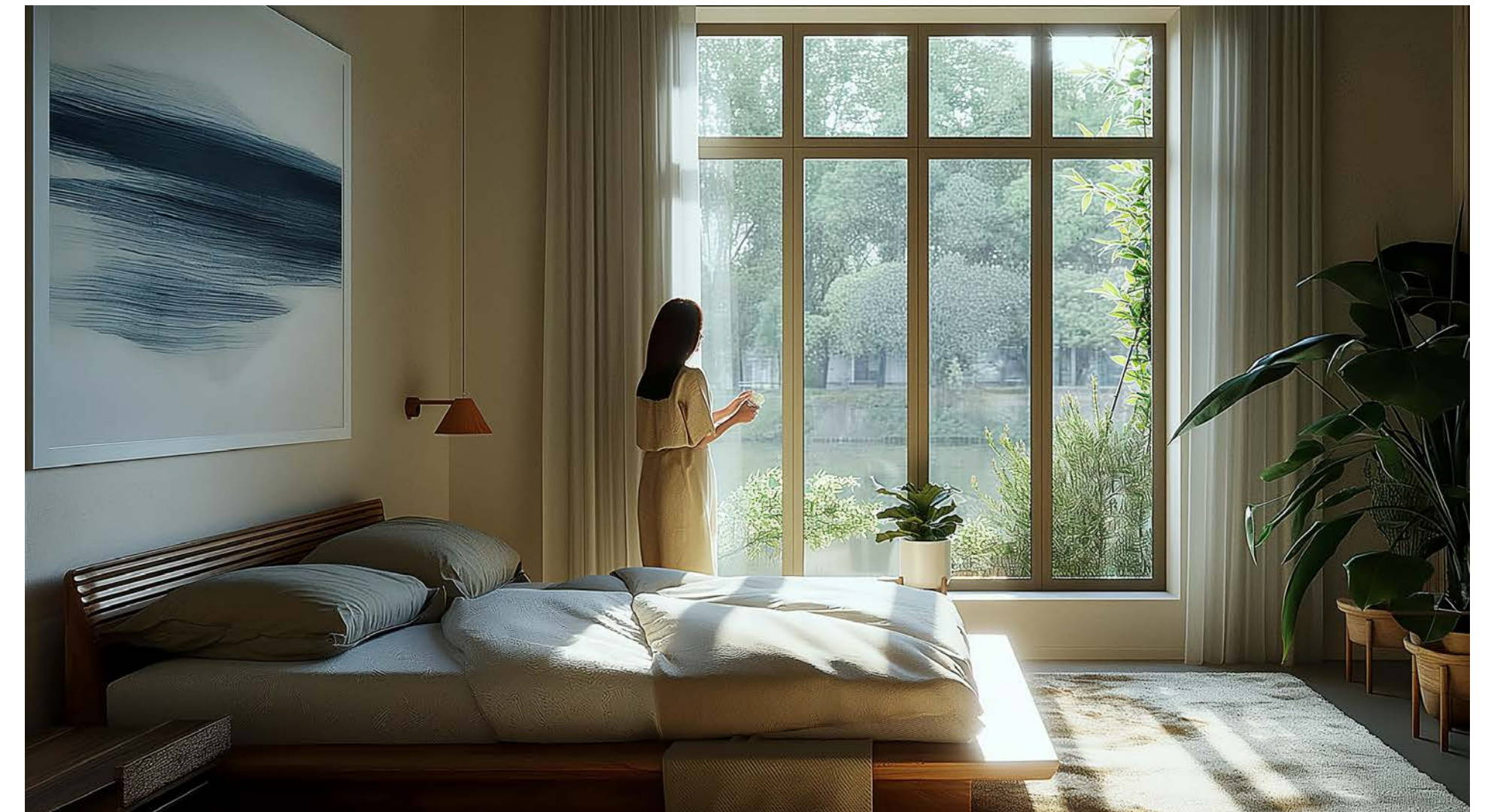

Prompt:an asian girl standing next to the huge window with veneer relaxing and holding a cup of espresso, grey and creamy paint wall, a wide window with veneer, the sun light gently shines onto her face, large plants around, creamy linen sheet with 5 pillows, wooden frame bed, artwork on wall, natural forest and lake window view in shanghai suburb, linear style lighting, wool carpet, highly detailed, professional lighting, realistic photography --ar 16:9



Mid journey  
Prompt:  
an asian girl standing next to the huge window with veneer relaxing and holding a cup of espresso, grey and creamy paint wall, a wide window with veneer, the sun light gently shines onto her face. large plants around, creamy linen sheet with pillows, 2 white duvet pillows in large size, 2 rectangular navy pillows in medium size, wooden frame bed, artwork on wall, natural forest and lake window view in shanghai suburb, linear style lighting, wool carpet, highly detailed, professional lighting, realistic photography --ar 16:9

To cheer up



00:00:05:23

The bed, with its fluffy white pillows, light duvet, and cotton sheets, offers a **soft** and **cozy** space for **relaxation**. Small bedside wall lamps provide lighting, while the **minimal** decorations in the bedroom create a restrained yet **warm** ambience.



00:00:16:25

When it rains outside, she can adjust the button to simulate a sunny morning. It feels like living in an **ideal world** where one can **choose** what suits them best.

# Communal spaces

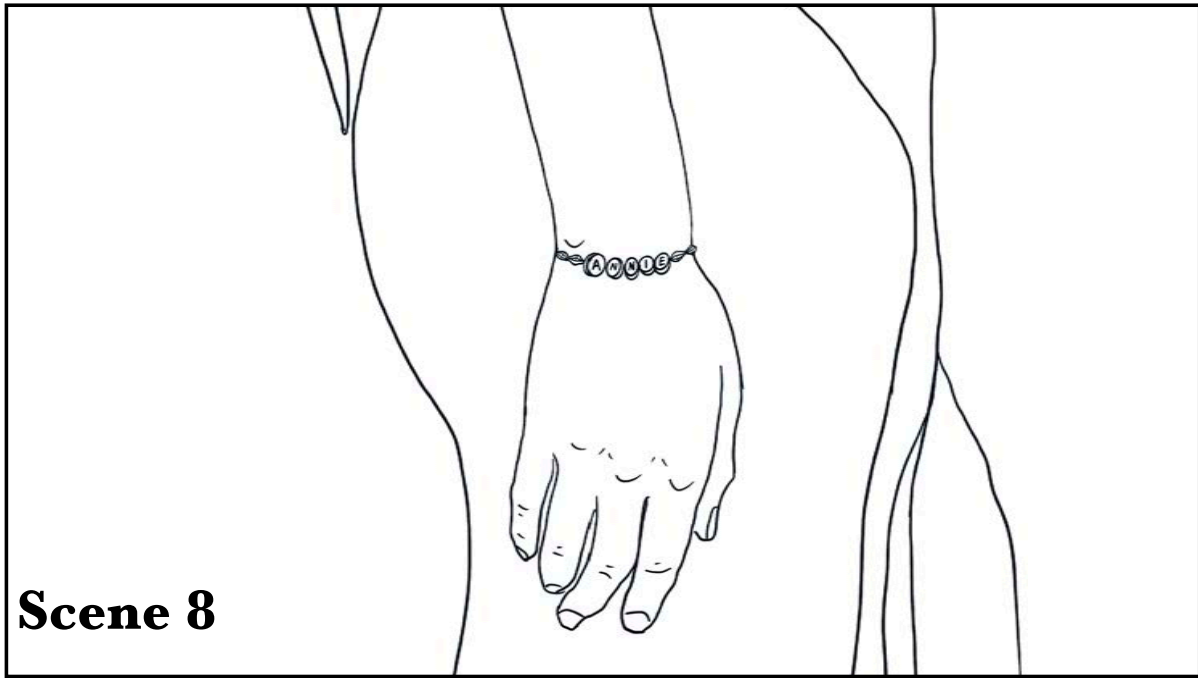

**Scene 8**

INT.-Corridor-Evening  
Close up  
Description: walking to the bar, right to left



**Scene 9**

INT.-Bar-Evening  
Wide shot  
Description: getting bored, small moves on hands

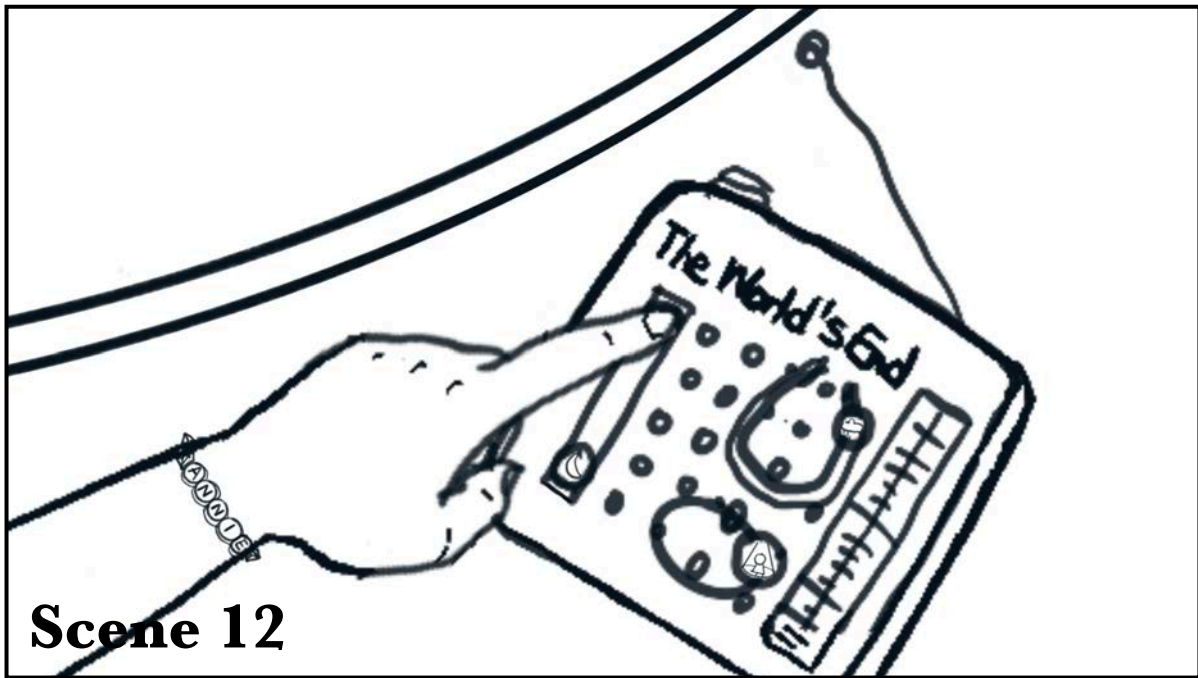

**Scene 12**

INT.-Bar-Evening  
Close up  
Description: sliding the button, lighting gets dim, starting to rain



**Scene 13**

INT.-Bar-Evening  
Wide shot  
Description: starting to rain

# Iterations in Mid journey



Prompt:ambiguous atmosphere, a girl sitting in the corner away from the other people, mist around the figure, large romantic gallery bar, dim lighting, lots of separated seats divided by decorations and plants, lots of lamps and floor lamps, lots of decorations, cinematic photography, comfortable for introvert people, modern Chinese style interior, communal space, Italian marble floor, studio lighting --ar 16:9



Prompt:an Asian girl sitting in a post modern dark green cute armchair in the corner away from the other people, romantic bar, dim lighting, seats separated by decorations and plants, warm lighting from glass lamps and floor lamps, neon lights, mirror walls covered by black velvet, an open matt shelf against a black wall decorated with old fashioned TV and boutiques, matt black floor, forest and lake view from ground floor, raining outside, cinematic photography, communal space, studio lighting --ar 16:9



Prompt:an Asian girl sitting in a minimalist style cute dark green armchair in the corner away from the other people, glass round coffee table, forest and lake view from ground floor, raining outside, dim lighting, seats separated by decorations and plants, warm lighting from old fashioned glass lamps and floor lamps, neon lights, mirror walls covered by black velvet, an open matt shelf against a black wall decorated with vintage TV and radio and rotary phone and alarm and boutiques, matt black floor, cinematic photography, communal space, studio lighting --ar 16:9



Prompt:an Asian girl sitting in a clear acrylic armchair with creamy cotton cushions on the left side of the camera, transparent glass round table with iridescent shadows on the floor, forest and lake view from ground floor, raining outside, dim pinkish lighting, seats separated by decorations and plants, warm lighting from glass lamps and floor lamps, neon lights on the wall, walls covered by black velvet, an open shelf against a black wall decorated with vintage TV and radio and rotary phone and alarm and boutiques, matt black floor, comfortable for introvert people, cinematic photography, communal space, studio lighting --ar 16:9



Mid journey

Prompt:

an Asian girl sitting in a post modern dark green cute armchair in the corner away from the other people, romantic bar, dim lighting, seats separated by decorations and plants, warm lighting from glass lamps and floor lamps, neon lights, mirror walls covered by black velvet, an open matt shelf against a black wall decorated with old fashioned TV and radio and jukebox and old rotary phone and books and candles and boutiques, matt black floor, matt black floor, forest and lake view from ground floor, raining outside, comfortable for introvert people, cinematic photography, communal space, studio lighting --ar 16:9

# Iterations in Mid journey



Prompt:close-up shot, retro-futuristic Koran coffee shop, dim lighting, iridescent shadows of plants in the background, an Asian girl in white sitting with legs crossed, rain on the left, informal outfit and white shoes, walnut wood legs of a small chair with burgundy velvet cushion, simple clear glass round side table, reflective metal walls with decorations, classic Italian white Carrara marble flooring, antique Chinese floor lamps, sunset, lake view by the window, romantic atmosphere, highly detailed, cinematic poster, realistic photography, professional lighting, futuristic interior --ar 16:9



Prompt:close-up shot, an asian girl wearing black dress sitting in the corner, looking the other way, black floor, emerald green velvet corner sofa, stainless steel bar counter with neon lights, linear wall lamps, a glass of mojito, small candle lighted up, one pink rose in small vase, artworks on black walls, cinematic photography, communal space, studio lighting --ar 16:9



Prompt:close-up shot, an asian girl with black long hair wearing black dress sitting in the corner, looking the other way in a gloomy expression, black floor, dark green chair, stainless steel bar counter with neon lights, linear wall lamps, foil strips, artworks on black walls, plant leaves, cinematic photography, communal space, studio lighting --ar 16:9



Prompt:close-up shot, an asian girl with black long curly hair in black dress sitting in the burgundy red fixed round sofa, laughing out with a big smile, feeling a bit tipsy, round mirror table top in chrome black, black wall lamps, artworks on black walls, plant leaves, highly detailed, cinematic photography, communal space, studio lighting --ar 16:9



Mid journey

Prompt:

close-up shot, an asian girl wearing black dress sitting in the corner, looking the other way, black floor, dark green chair, stainless steel bar counter with neon lights, copper lamps, dim lighting, a glass of mojito, small candle lighted up, one pink rose in small vase, artworks on black walls, highly detailed, cinematic photography, communal space, studio lighting --ar 16:9

## To connect



00:00:51:00

It is provocative how she controls her surroundings to achieve the optimal lighting and artificial raindrops, creating an **attractive** moment for a **faint sparkle**.



00:00:58:00

She adjusts the lights to create a sense of **ambiguity** and **adoration** with **drizzling** around. Without words, she communicates through her eyes and body expressions.

# Prototypes and experiments

## Original plan

Suspended above, the stage model presents various individual event spaces, transitioning from projected steps to full-scale displays of public areas. The audience is invited into the black box, creating an experience of a controlled environment.

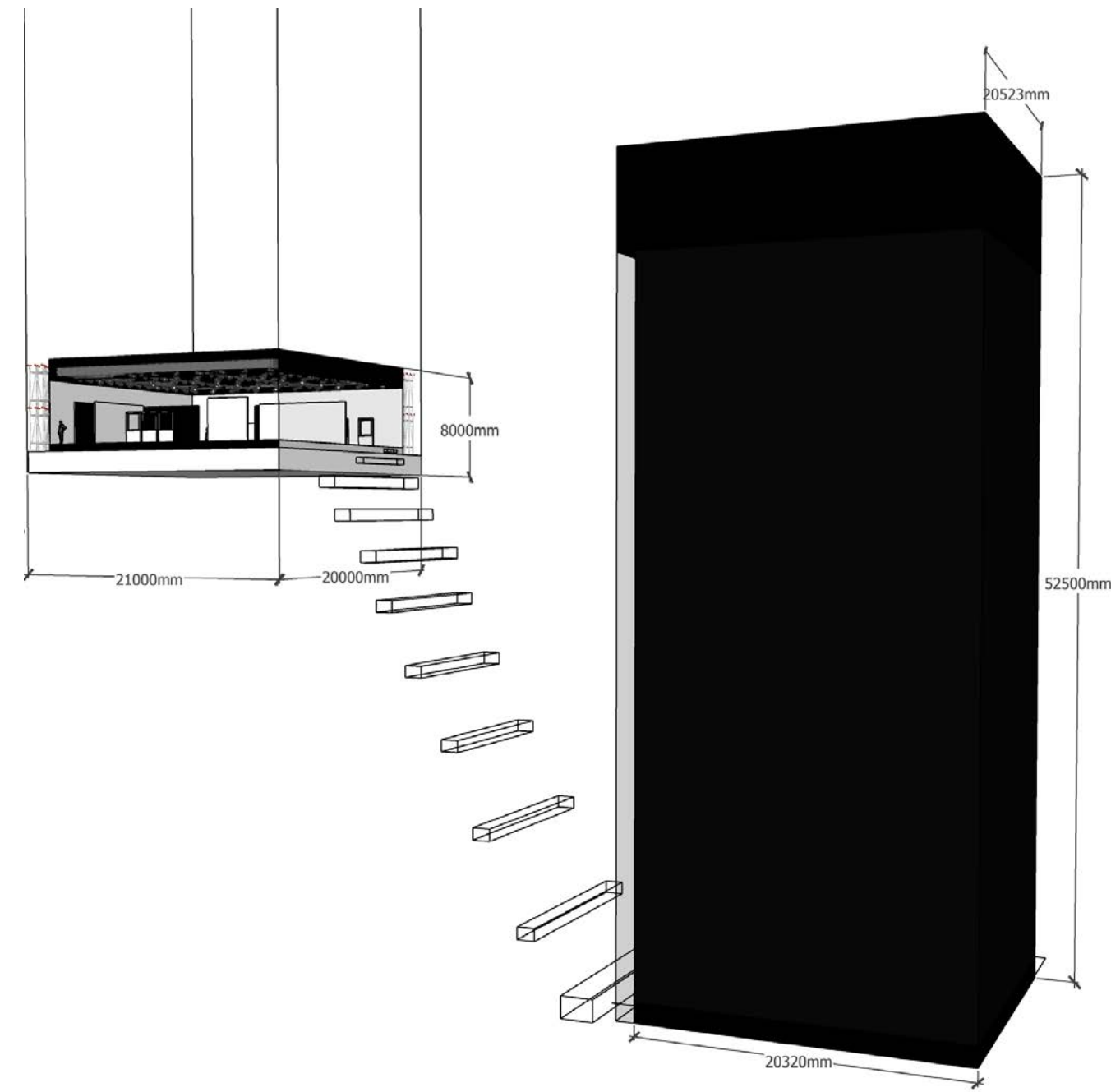

## Stage mockup scale (1:100)

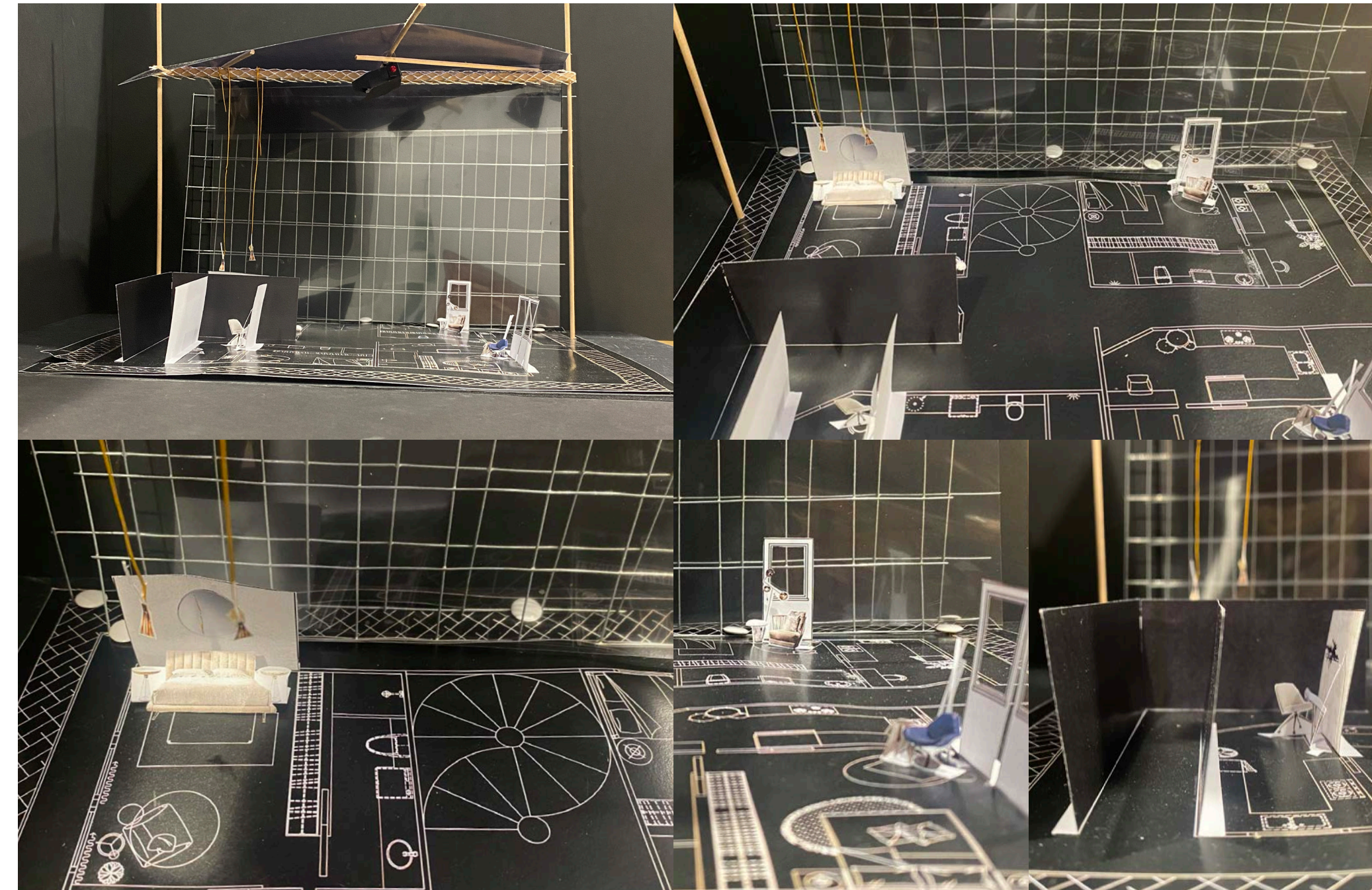

printed layout  
acetate sheet  
metal wires  
mesh scaffolding  
paper furniture  
& lighting & walls

Create a segment of the setting that portrays the characters' actions and atmosphere of the space, incorporating lighting and water elements

## Scaffolding & trusses

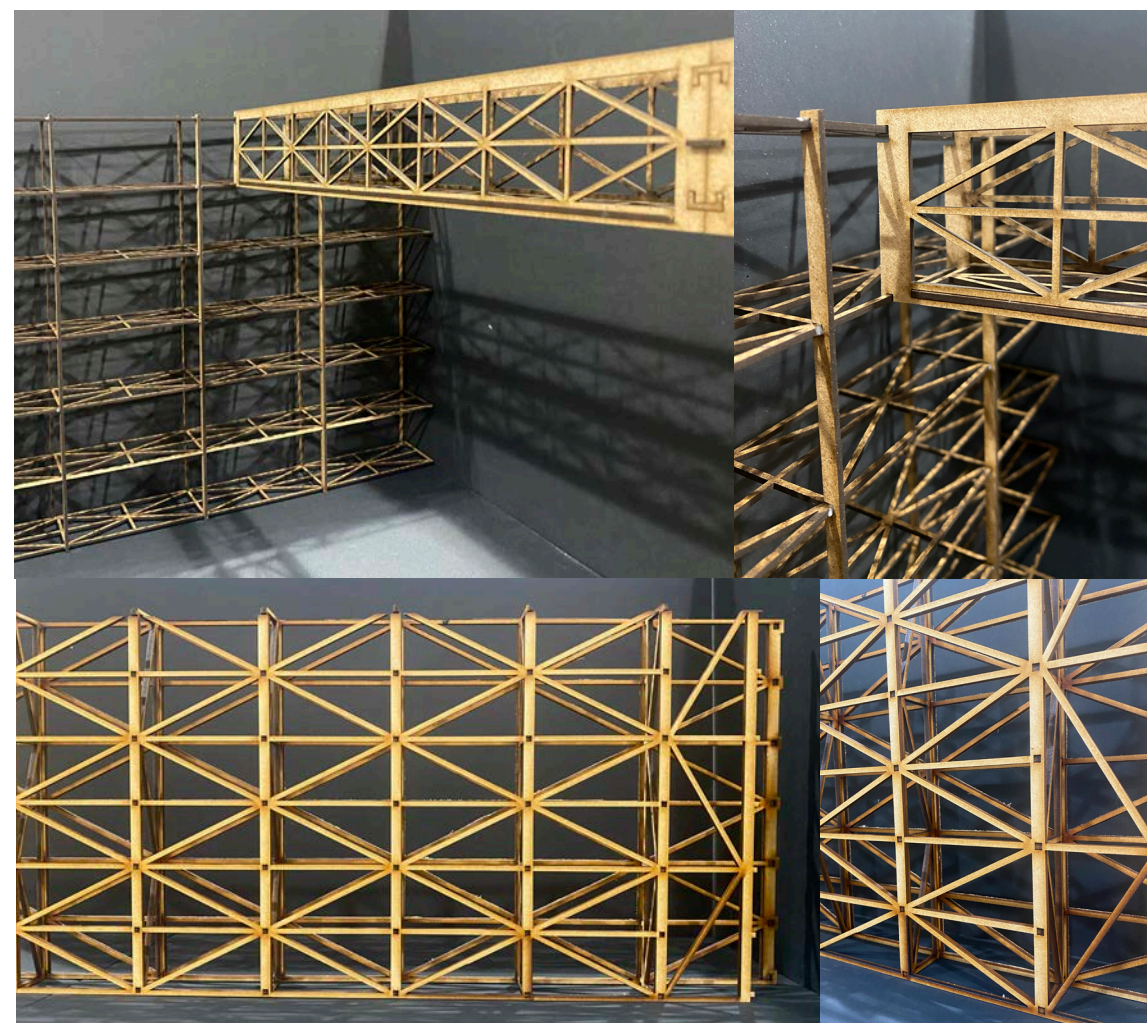

Laser cut  
2mm MDF  
4mm MDF

Experiment with different thicknesses and erection techniques to identify the most stable and robust solution.

## Stairs Projection

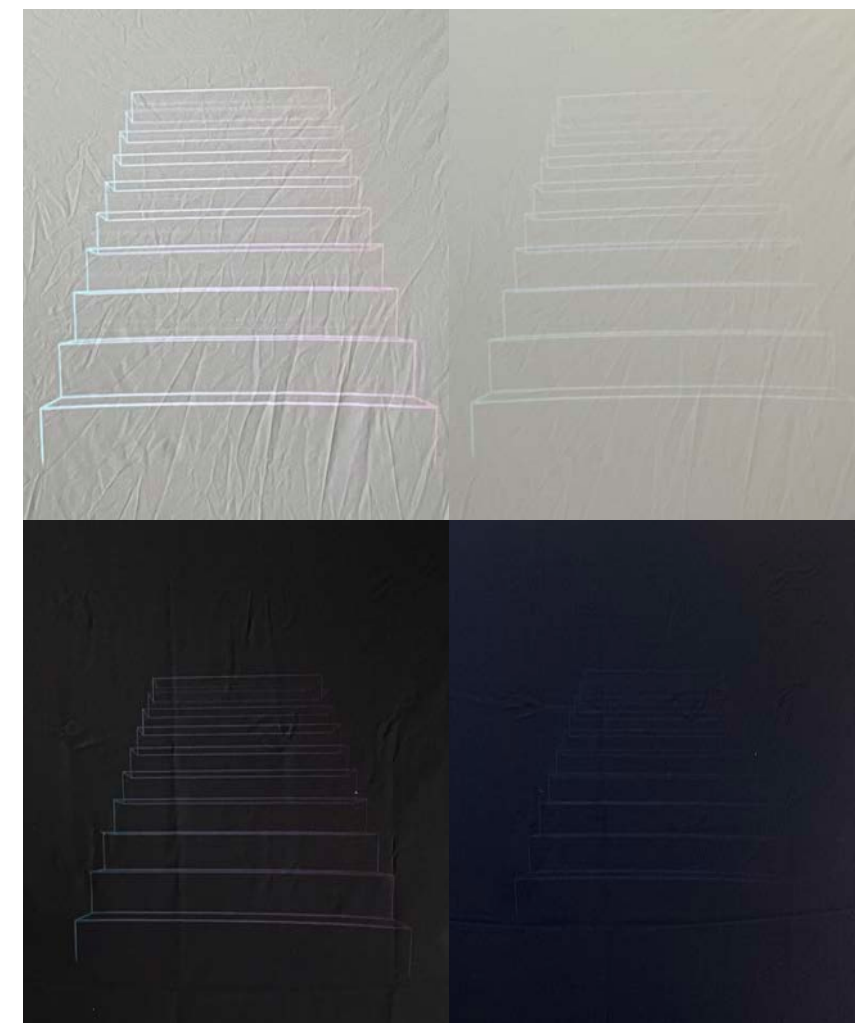

Projector testing  
1. natural light on white fabric  
2. artificial light on white fabric  
3. natural light on black fabric  
4. artificial light on black fabric

The lighting conditions at the exhibition are not ideal for laser projection, and creating an artificially dark space is not the most suitable option.

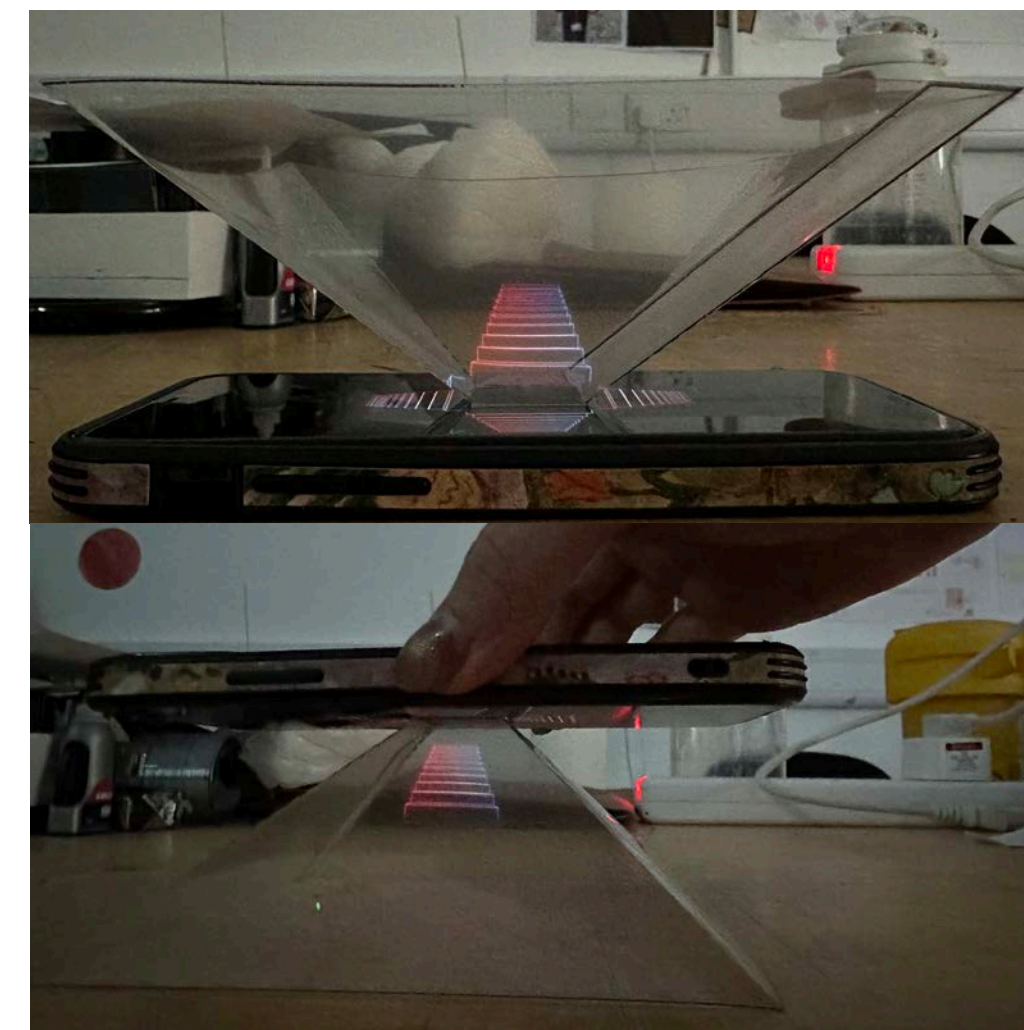

Holographic projection  
two ways of hologram in natural light

Despite its stereoscopic effect, holographic projection necessitates projecting onto a surface and cannot manifest out of thin air.

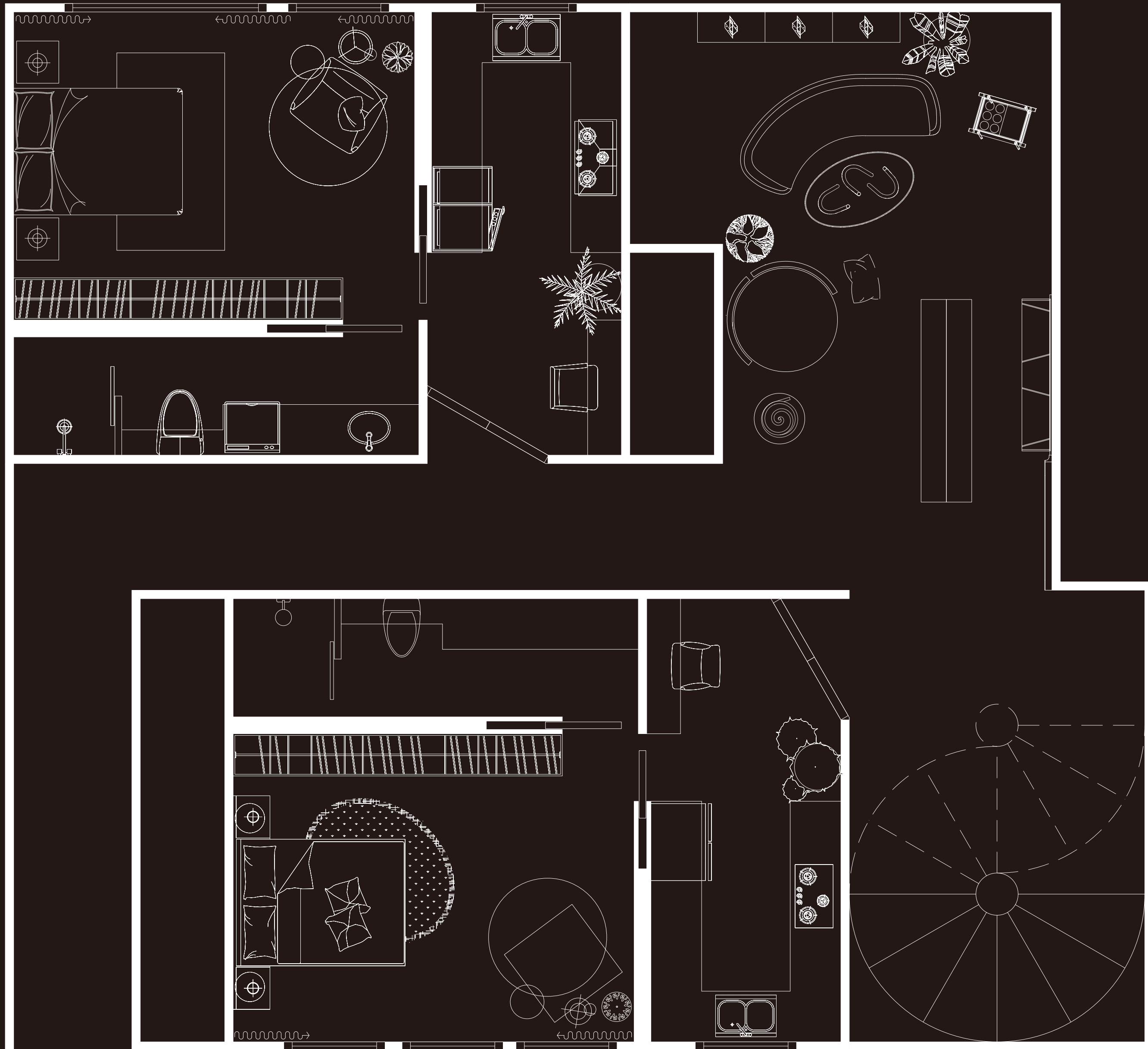

Stage layout

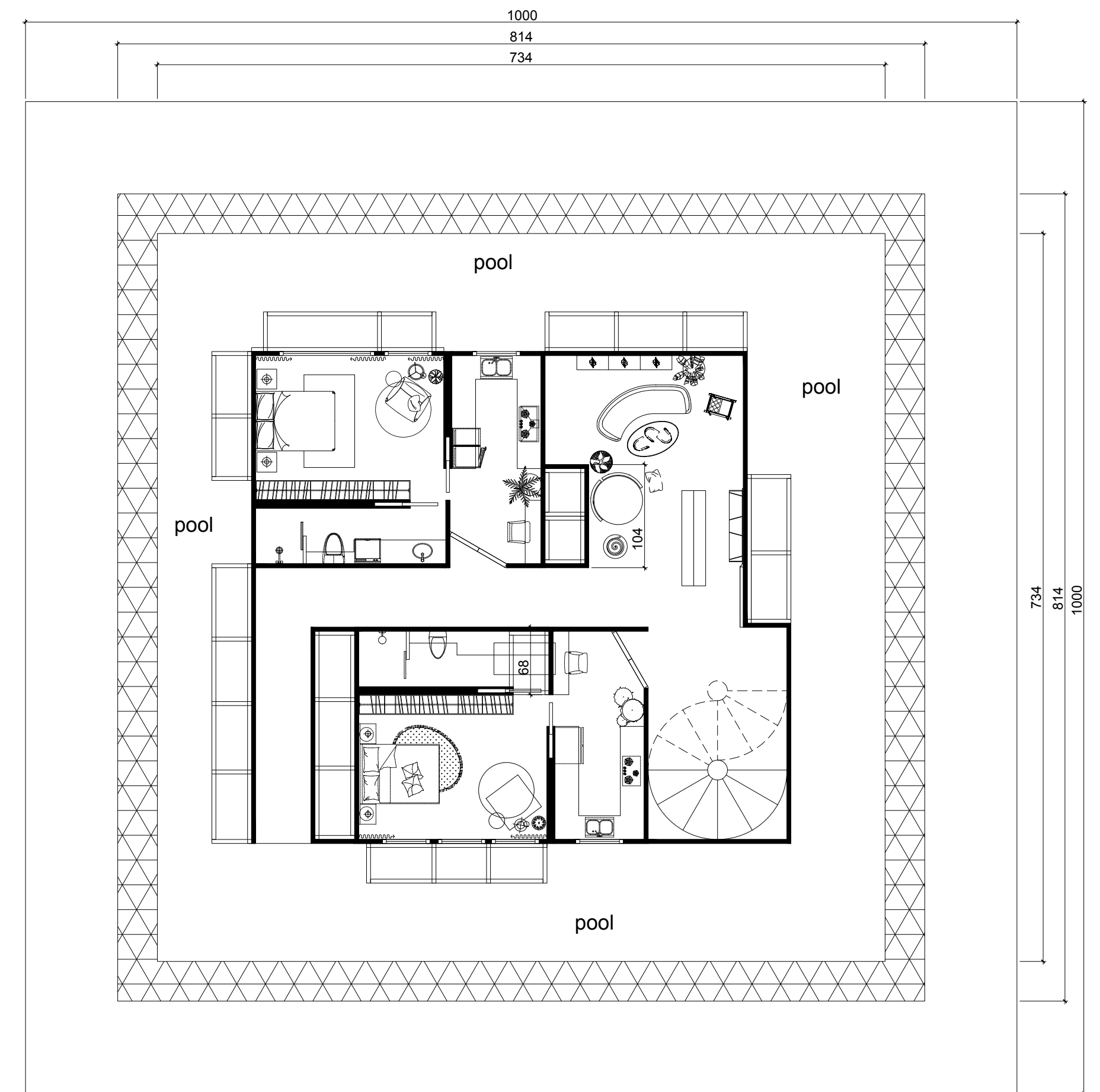
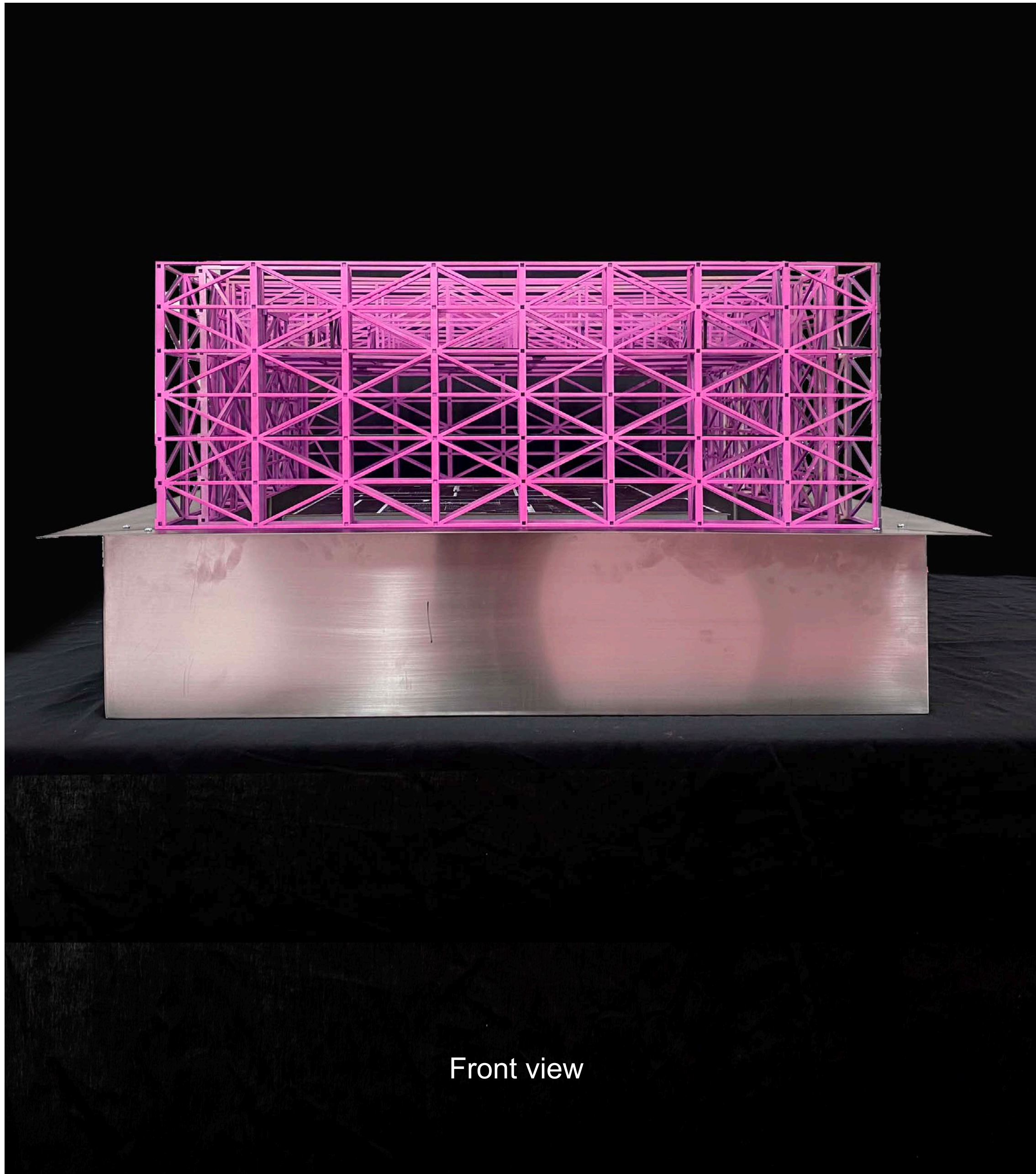
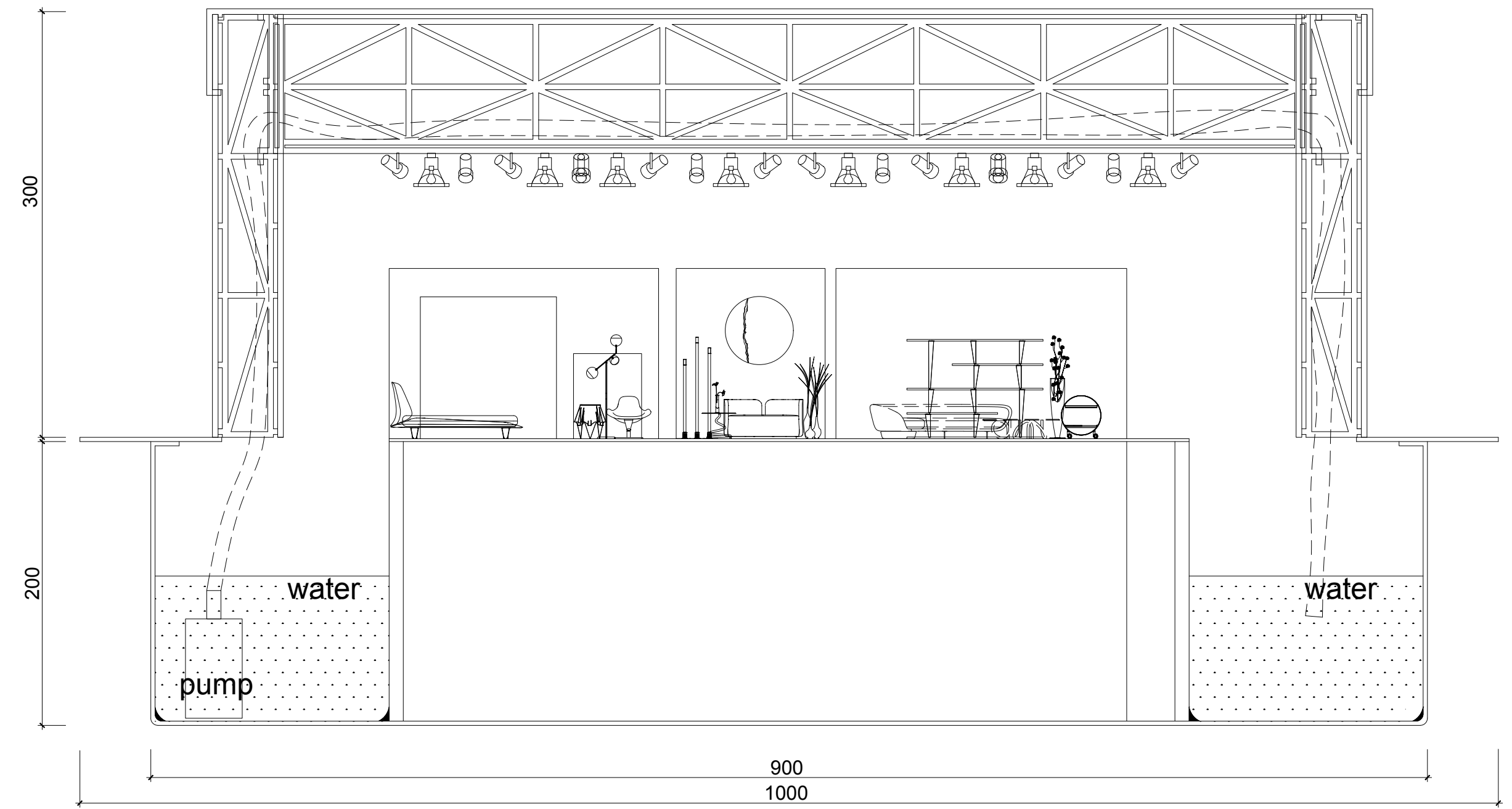

Exhibit layout

The model incorporates a stainless steel reservoir at the base and an internal stage with scaffolding at the top. Both the inside and outside of the reservoir are coated with black paint to conceal the stage bottom, pumps, and associated components. The pump is securely anchored at the bottom of the reservoir and connected to a transparent water pipe to create a water screen around the stage. A preliminary stage layout was outlined in chalk on the black floor. To emphasize the structure and reflect the project's design concept, the scaffolding and trusses were painted pink. Lights were hung beneath the trusses to illuminate the stage and contribute to achieving an artificially controlled ambience.



Front view



Section view

The model illustrates the **interaction** between the stage's interior **walls, furniture and fixtures**. **Sharp and reflective effects** are carefully considered in both private and public spaces. The base of the stage is a cavity surrounded by acrylic panels. Although it doesn't hold water, the seams are sealed with silicone to prevent water ingress and minimize resource waste. **Lighting and ambient fixtures** are suspended from trusses at **different heights**. **Plants**, on the other hand, create an **ecological and natural living environment** indoors and outdoors.

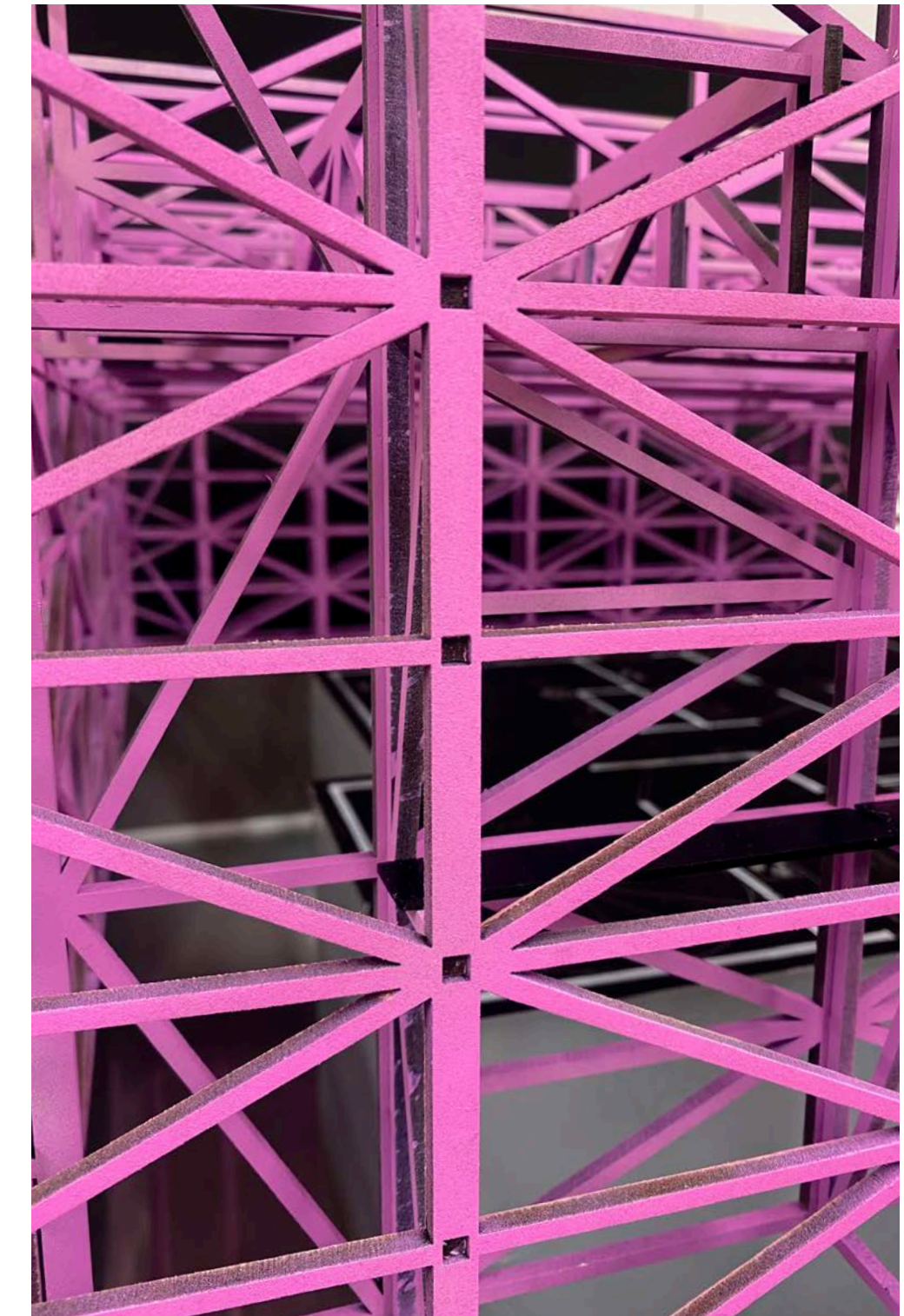
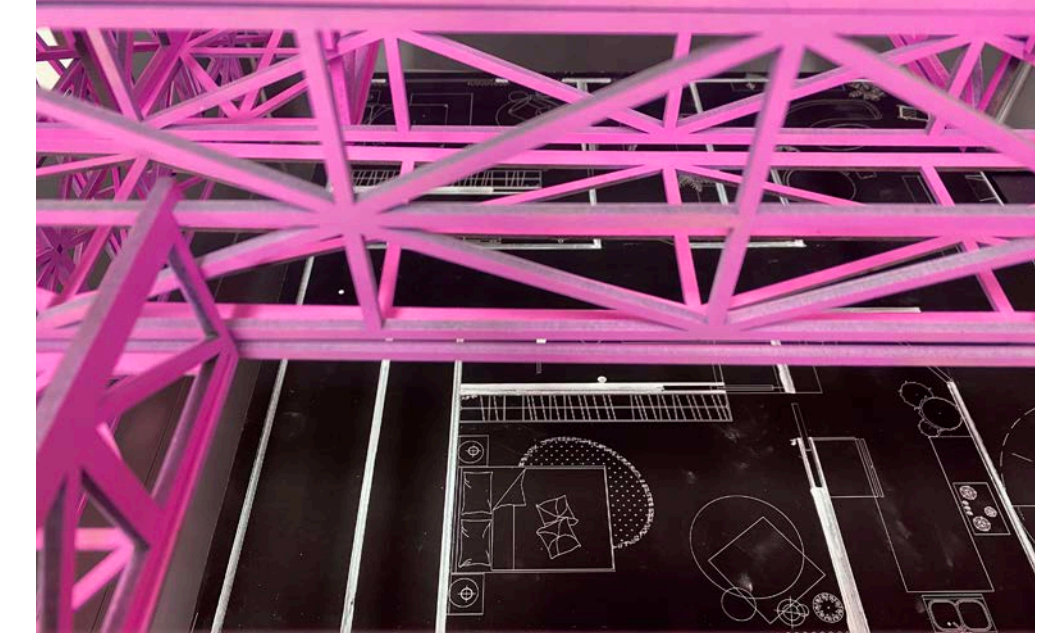
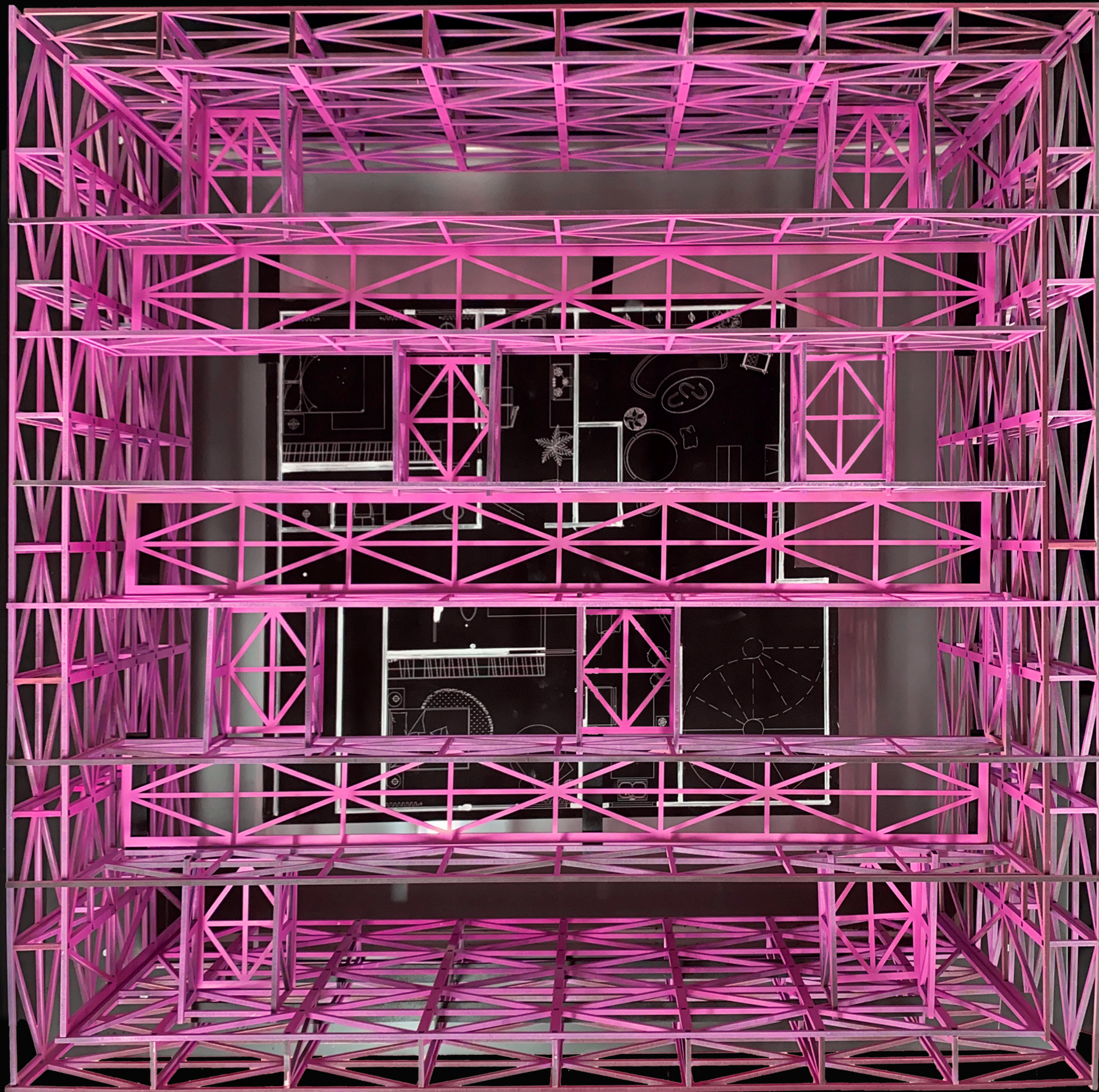

Viewing the stage and characters through the scaffolding encourages the audience to imagine various activities and contemplate their preferred spaces for **envisioning** their own stories. Simultaneously, from a higher perspective, viewers cannot ignore the realization that everything is **meticulously crafted** and aesthetically pleasing.

# Experiment on textures and colours



cold colour tone and caroset for calm space



contrasting colours and patterns for dynamic space



tint and warm colours made with natural materials for relaxed space

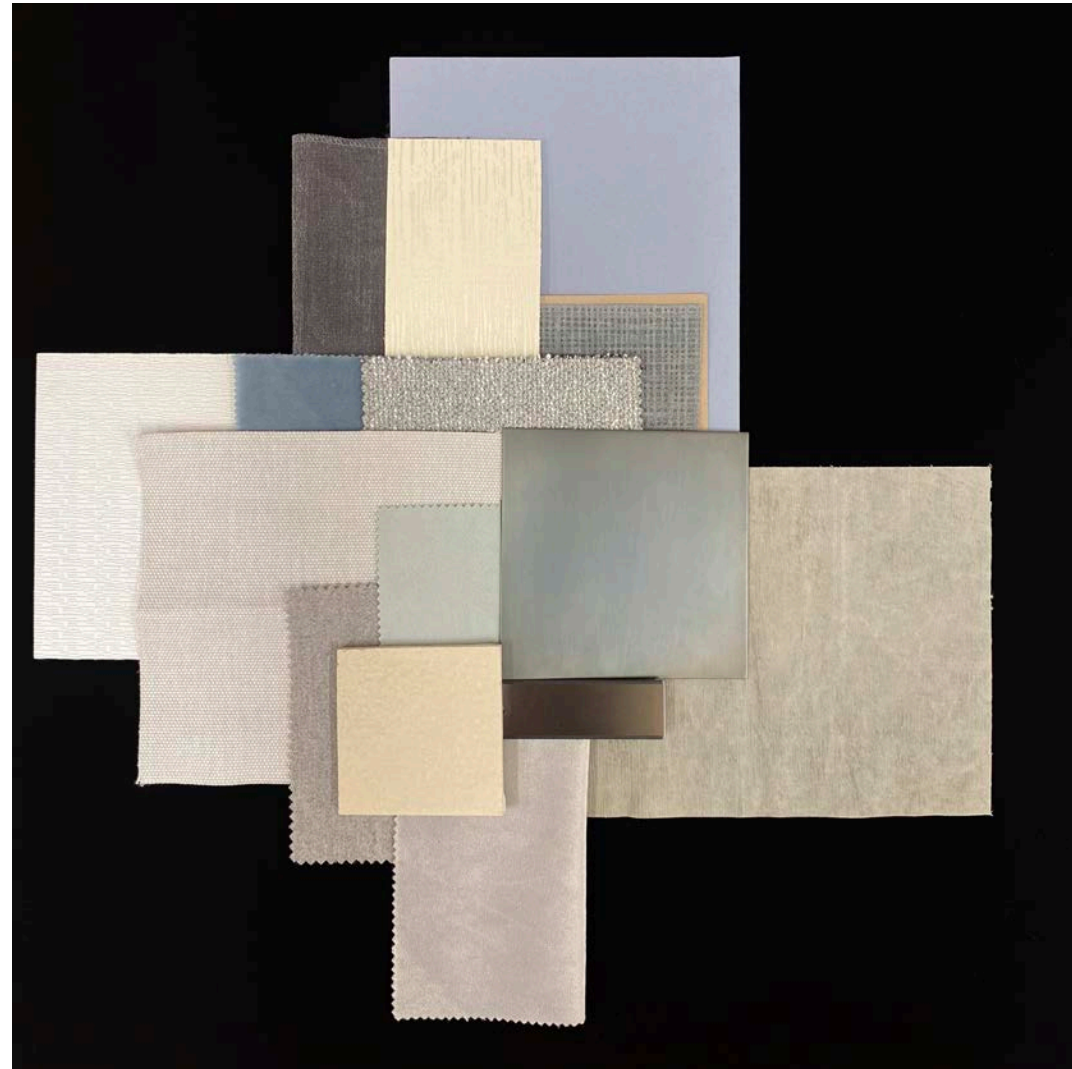

tint and cold colours made in various textures for relaxed space

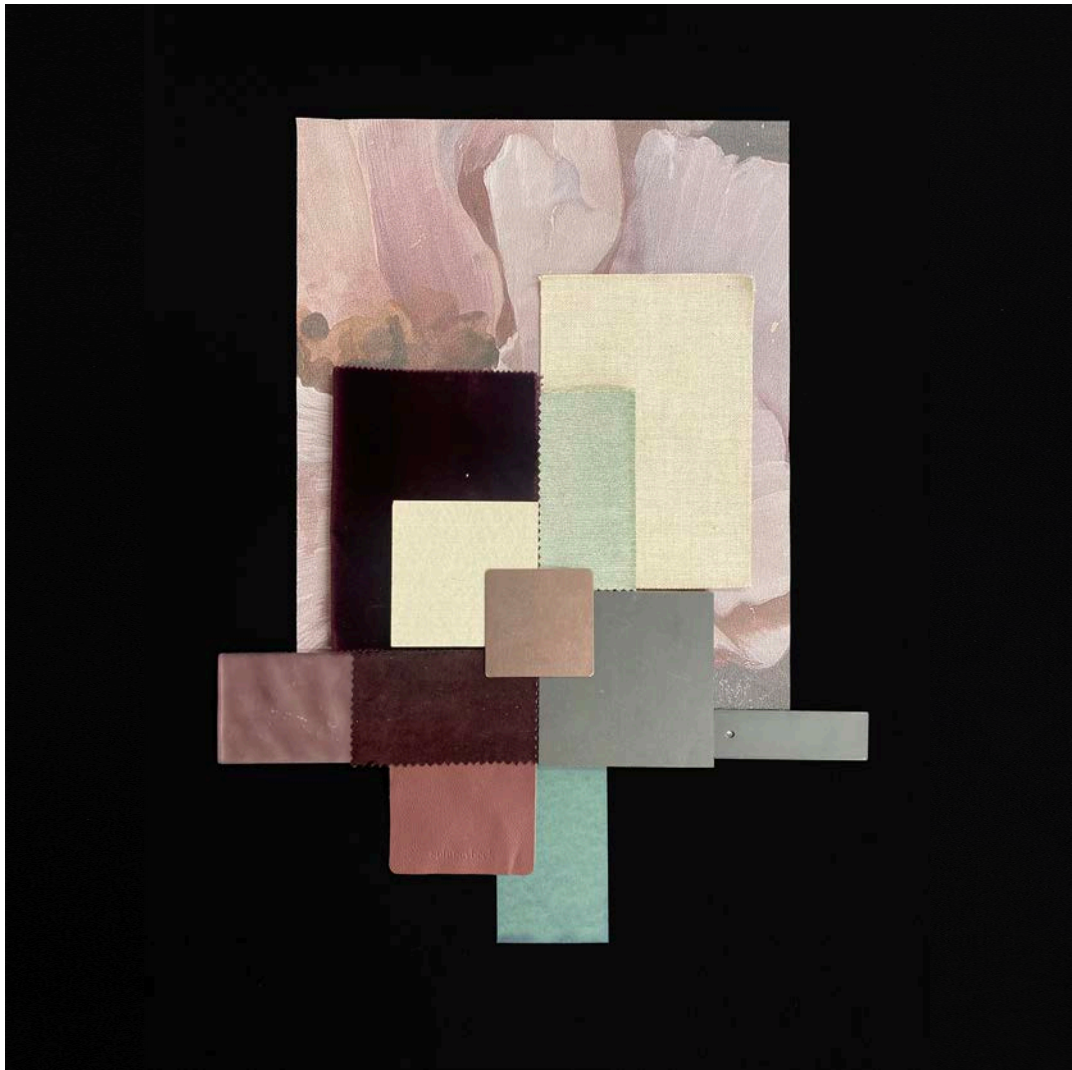

artistic patterns and multiple surfaces for provocation



pattern in natural vegetations and high saturated colour for active spaces



vibrant colours with iridescent effect and materials with reflections for stimulations

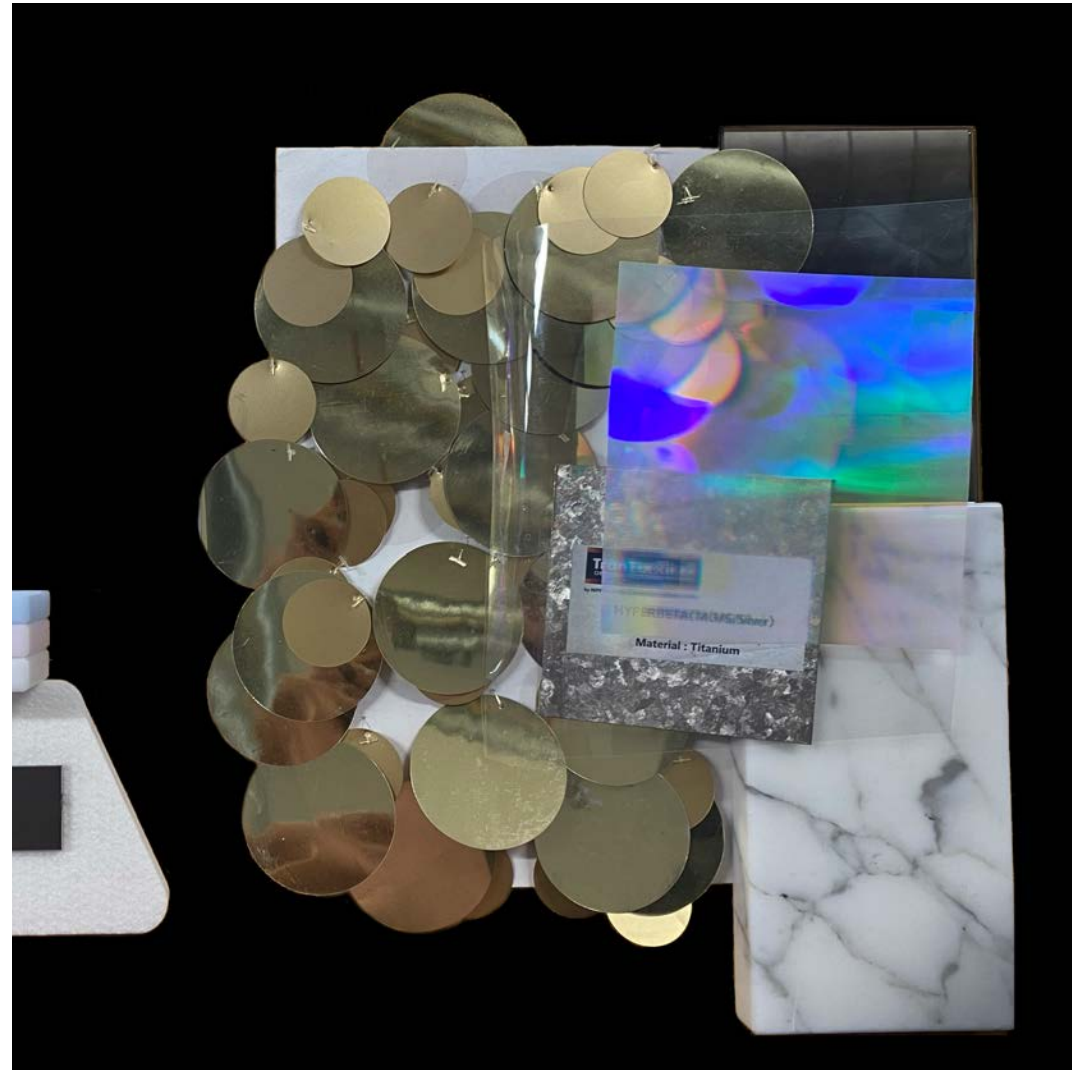

shiny and heavy materials for excitement

## Set model making



The space predominantly features white and **low-saturation** pink to establish a clean and tidy tone. **Soft** textures and **fluffy** materials provide a **comfortable** tactile experience, while rounded lamps, furniture, and other forms enhance the overall softness of the space.





Mid journey  
prompt:  
white fluffy furniture such as adult bean bag, fluffy cotton and linen pillows,  
frosted floor lamp shield, wool duvet, creamy wool wallcovering, clear glass  
coffee table, round white night table, small plants indoor and outdoor, black  
floor, highly detailed, realistic photography, studio 3-point lighting. --ar 9:16

# Rainfall system testing



After connecting the water pump outlet and hose, drill holes evenly along the transparent hose to allow the water to flow out. Keep the hose straight to ensure equal water pressure in all the holes. Once set up, you can power it on to achieve the artificial rain scene.

# Fibre optics testing

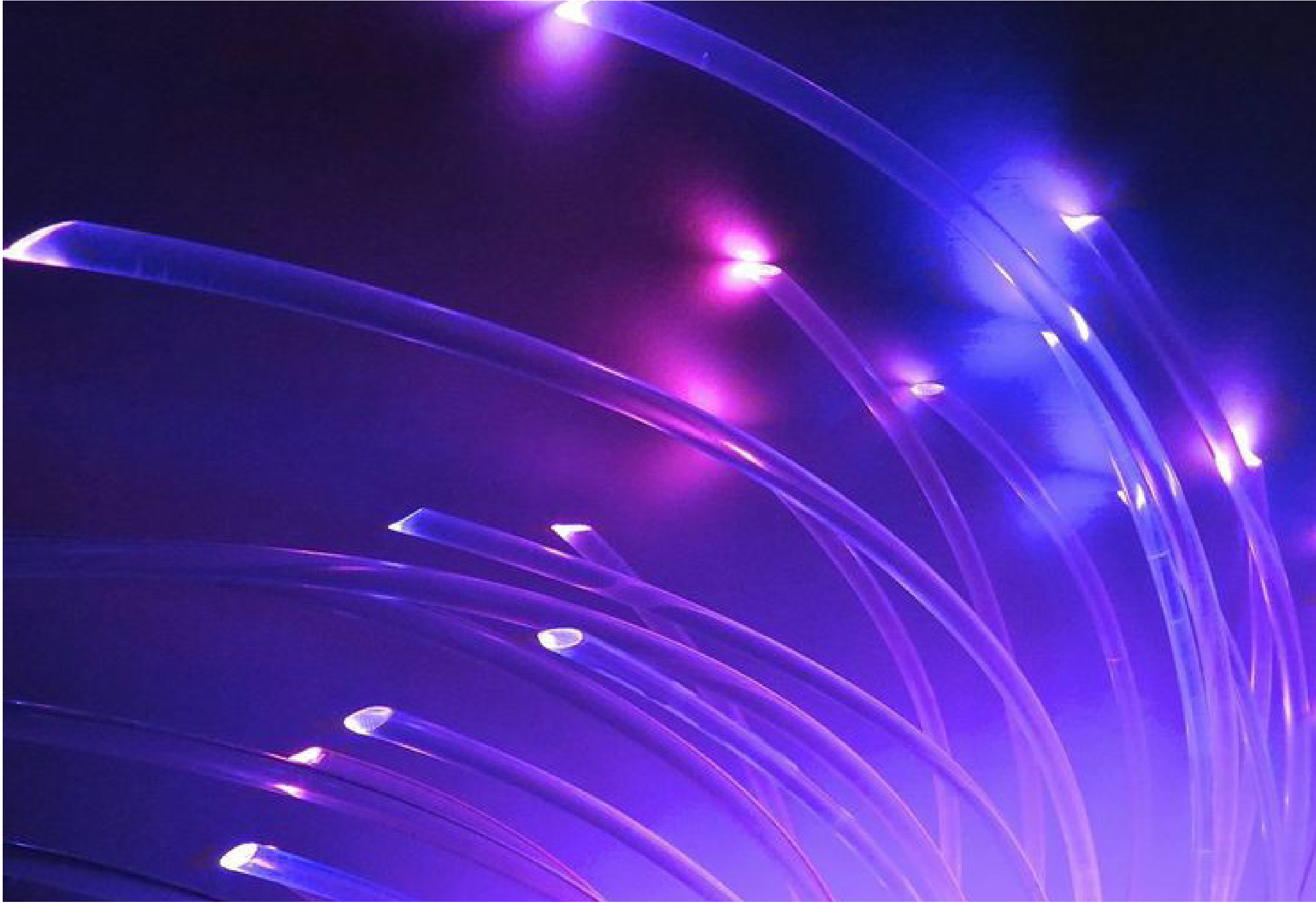

Unlike LED beads, fiber optics can be used to provide a low-brightness point light source, while LEDs are suitable for floodlighting.