

Islands of Eros's Believers

2054



XIAOPENG CHEN

If we could break away from the era of materialistic consumption, would we perceive love through spaces in the same way Plato's "Symposium" philosophy have conditioned us to?



Due people are increasingly reliant on experiencing love through social media, the purpose of this project is to provide a space for offline dating. This project is based on Plato's "Symposium" and explores the concept of love devoid of material desires, as well as the relationship between intimate connections and space within this context.



PART 1 BACKGROUND

The organization behind is company Tinder, which is the sponsor and creator of the islands. They created a new New religious areas provide people with offline dating, Tinder will cover all the expenses on the islands, however people must follow by the rules set by Tinder.



New religion

2054 - Los Angeles

People break away from material desires and begin to look for spiritual sustenance, the new religion has been build, this religion is Based on the ancient Greek mythology system



Believe in Eros



2054-Sea-level rise - LA

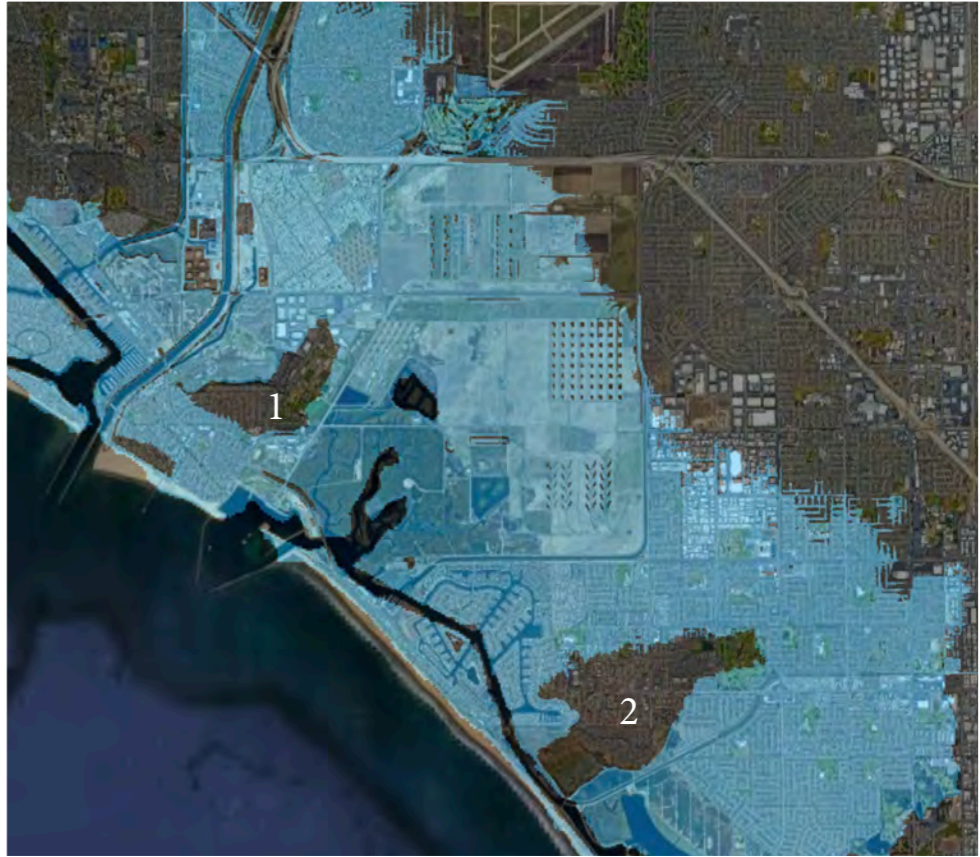

The religion of Eros decided to create two islands to help people find their true love



About God of Love - Eros

Pausanias divided the God of Love into two: the heavenly God of Love and the mortal God of Love. The mortal Eros from Homer's epic, where Aphrodite is born from Zeus and Dione (a daughter of Zeus), making her a deity with both a father and a mother, and her son Eros is the god of love on earth. The heaven Eros from Hesiod's Theogony, where Aphrodite is the daughter of the sky god Uranus, born without a mother, and her son Eros is the heavenly god of love.

The two Eros reflect two different kinds of love, one pursuing sexual desire and the other pursuing spiritual communication.

General information of Islands

Island Of True Love

Belongs to heaven Eros



- 1. Empty space
- 2. Empty space
- 3. Original living area
- 4. Original living area
- 5. Empty space

Island Of Lies

Belongs to the mortal world Eros



- 1. Empty space
- 2. Original living area
- 3. Empty space
- 4. Empty space

Transportation

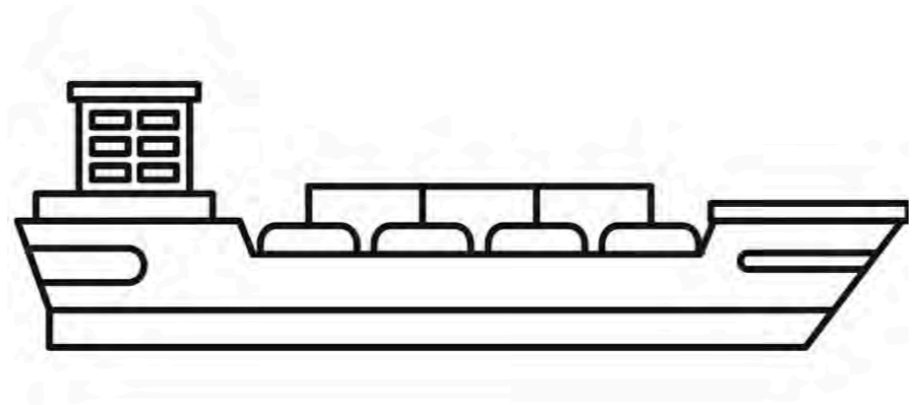

Port

Island Of True Love



LA



Island Of Lies



PART 2 Islands

Perspectives on Love Relationships in the Symposium

Homosexuality



Polyamory (Polyandry)



In the Symposium, it advocates for male homosexuality, where adult men often already married and had children, engaging in poly amorous relationships. Moreover, same-sex love isn't portrayed as egalitarian, with distinct roles for each party. Each man must attract a younger boy or youth and serve as his mentor, guardian, friend, and inspire him to pursue noble virtues in their intimate daily lives. This custom thrived particularly in the city-state of Athens. Alcibiades concludes that any city-state prohibiting love between men rejects noble love, symbolizing low moral standards and the ignorance of rulers and the weakness of the ruled.

Dying for love is a brave action

Island of Lies and Island of True Love Rules

Island of lies

- 1. Regardless Of Sexual Orientation**
- 2. Polyamory is Allowed**
- 3. Fighting to Death allowed**

Island of True love

- 1. Regardless Of Sexual Orientation**
- 2. Loyalty**
- 3. Fighting to Death **NOT** allowed**



Eros Church

Aristophanes' view on the temple of the god of love

Aristophanes said, "All right, I'll take your advice, Eryximachus. I intend to praise the god of love in a new way, different from yours and Phaedrus'. I am sure humanity has never understood the power of love. If we truly knew what love is, we would surely build the most solemn temples for the god of love, construct the most beautiful altars, and hold the most magnificent ceremonies."



Worship Eros and perform the ritual.

The love story mentioned in the Symposium

By Phaedrus



Argos died in place of her husband



Orpheus turned around to see his wife



Aqilu avenged his lover

By Aristophanes



Story of androgynes

People are divided into three types: men, women, and androgynes. They are all double beings with two heads, four hands, and a combination of back-to-back. Zeus, in order to control and punish humanity, split people apart.

Master Plan Based On Symposium's Story Narrative

1



Orpheus possessed extraordinary musical talent. His performances could move trees and stones to sorrow, and tame fierce beasts. When Orpheus played by the forests and the sea, Eurydice fell in love with him because of it.

2



The wedding of Orpheus and Eurydice, Eurydice was bitten to death by a poisonous snake at the wedding

3



On the journey out of the underworld, Orpheus and Eurydice encountered steep cliffs and forests shrouded in mist.

4



After Patroclus died, Achilles often came alone to the seaside to mourn for Patroclus.



Forest of True Love

A forest on the Island of True Love, where couples can pour out their hearts to each other.



True Love Wedding Venue

The wedding venue surrounds the church and is set by the seaside. Originating from the heavens, Aphrodite emerges from the foaming bubbles of the sea. Couples marrying here receive the blessings of the heavenly god of love, Eros.



Sunrise&sunset cliffs

To the east is Sunrise Cliff, where one can admire the sunrise, catering to a younger audience. To the west is Sunset Cliff, a place to enjoy the sunset, targeting an older audience.



True love sea burial

All those who die on the Island of True Love will receive a sea burial, blessed by the god of love.

Master Plan Based On Symposium's Story Narrative

5



Orpheus went to the underworld to see his beloved. On the way back to the world of the living, he violated the agreement by turning back to look at his wife, resulting in her being taken back by the Lord of the Underworld.

6

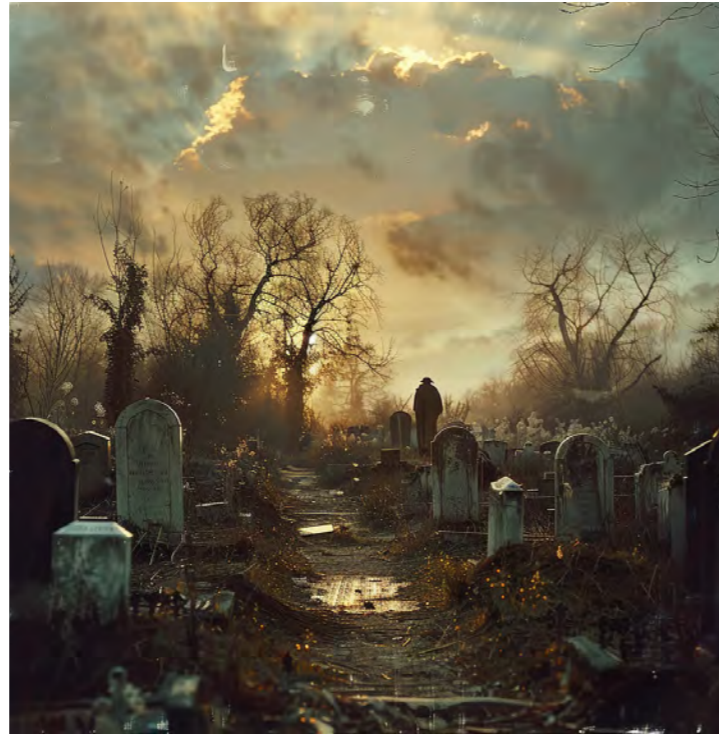

After Eurydice died and descended to the underworld, Orpheus was killed by women because he rejected their advances. In death, Orpheus's soul joined Eurydice in the underworld, where they were reunited.

7



Those androgynous individuals who were split apart, if one half dies while the other half survives, the surviving half will seek out a mate. Regardless of age or gender, when they encounter one another, they embrace and mate with each other.

8



Patroclus died in the Trojan War, and when Achilles found out, he decided to enter the battlefield to avenge Patroclus. The story took place at the Love Sea, the location of the Trojan War.



Corridor of lies

The couples in multiple relationships will confront each other here, a place that also serves as the path to the graveyard. The victorious side in the battle on the beach will take the ashes of the defeated with their loved ones to the graveyard.



Cemetery

All bodies will be buried here, including but not limited to those who died on the battlefield beach.



Sexual intercourse Garden Hotel

The Garden Hotel on Deceit Island, highly private, provides a venue for extramarital affairs, where individuals can engage in sexual encounters. People can also arrange rendezvous with their affair partners in the garden.



Battlefield Beach

A place for fighting for love, where men and women can battle for their beloved. Based on ancient Greek nude athletics, the fights must be conducted naked (which may result in death).

LOS ANGELES

Regardless Of Sexual Orientation Prohibition Of Polyamory

 300

Island Of True Love

- 1. Port A
- 2. True love sea burial
- 3. Sunrise cliff
- 4. Forest of True Love
- 5. True Love Wedding Venue
- 6. Eros Church
- 7. Sunset cliff
- 8. Port B



Island Of Deception



500

LOS ANGELES

True Love Island

Island Of Lies

- 1. Corridor of lies
- 2. Cemetery
- 3. Eros Church
- 5. Battlefield Beach
- 6. SexualintercourseGardenHotel
- 7. Port



1KM

**Regardless Of Sexual Orientation
Polyamory is Allowed
Fighting to Death allowed**

LOS ANGELES



The religion of Eros is based on the ancient Greek mythology system. The main Material on the islands keep the architectural characteristics of ancient Greece, mainly built with limestone or tuff. The people on the islands lead simple and natural lives.





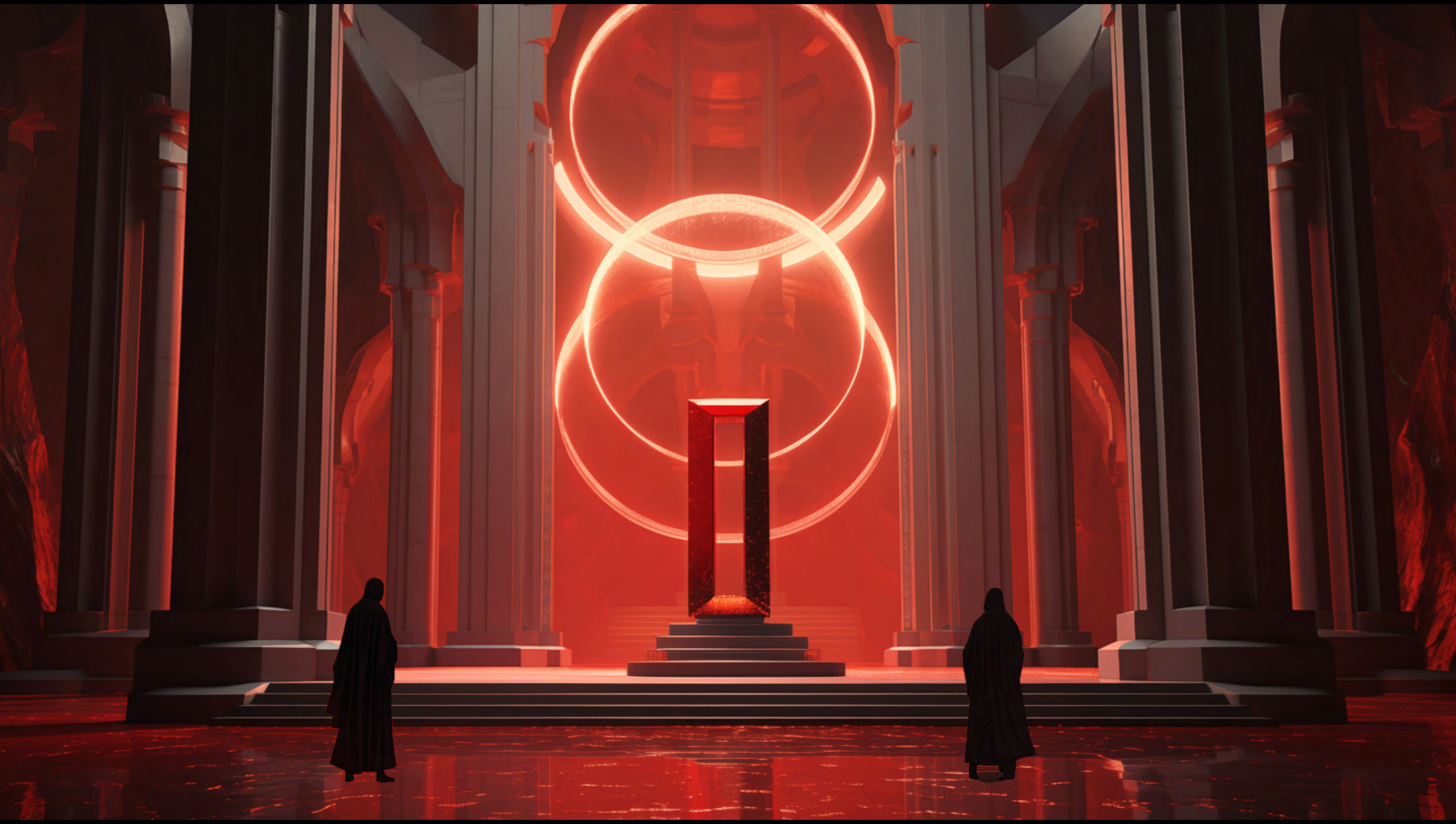

“Humanity did not understand what true love was and was convinced that humans had never recognized the power of love.”

-Aristophanes Symposium

True Love Button



Island of True Love



Eros Church - True love button Located



Island of Lies

True Love Button-PROPS

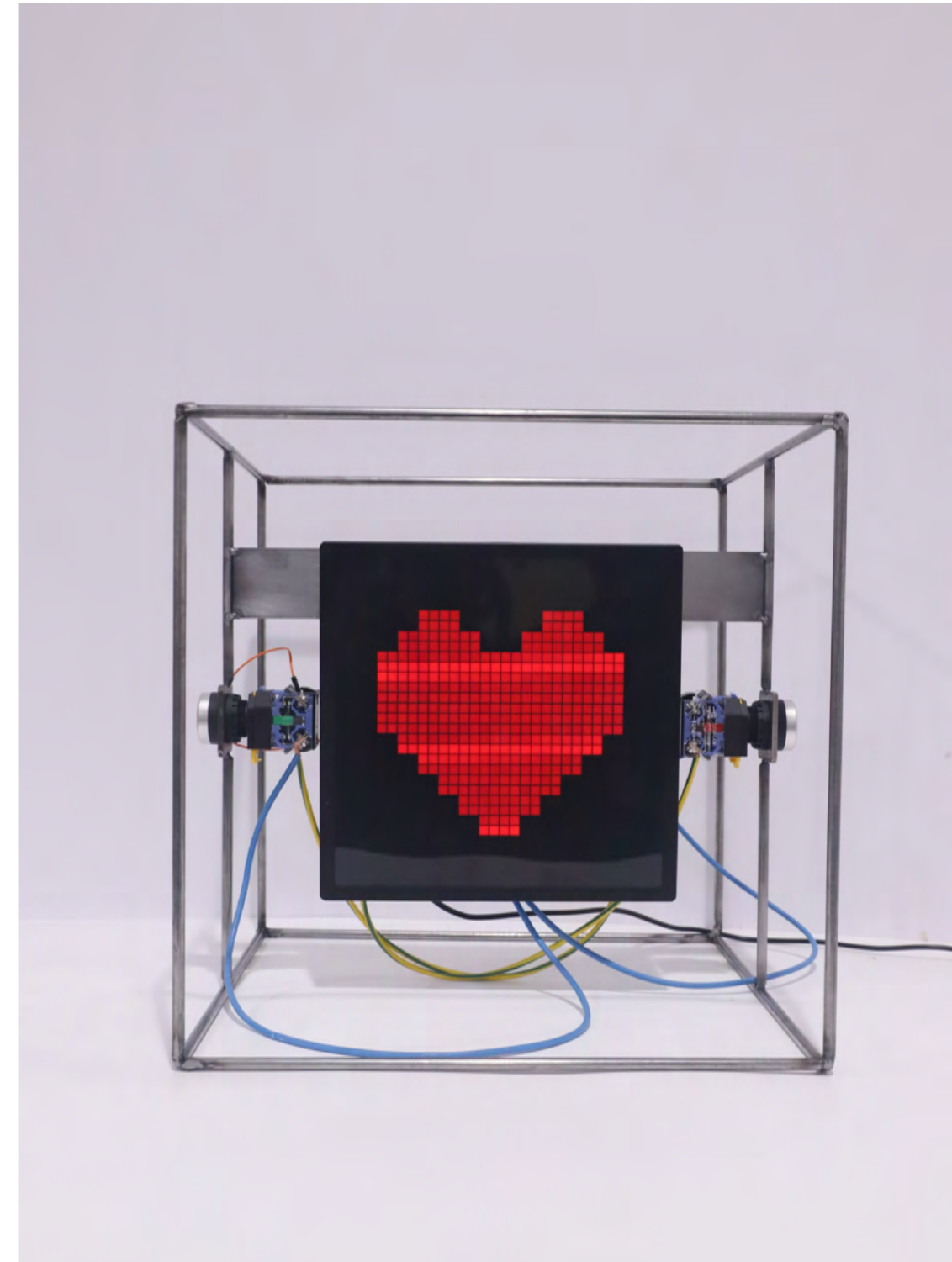
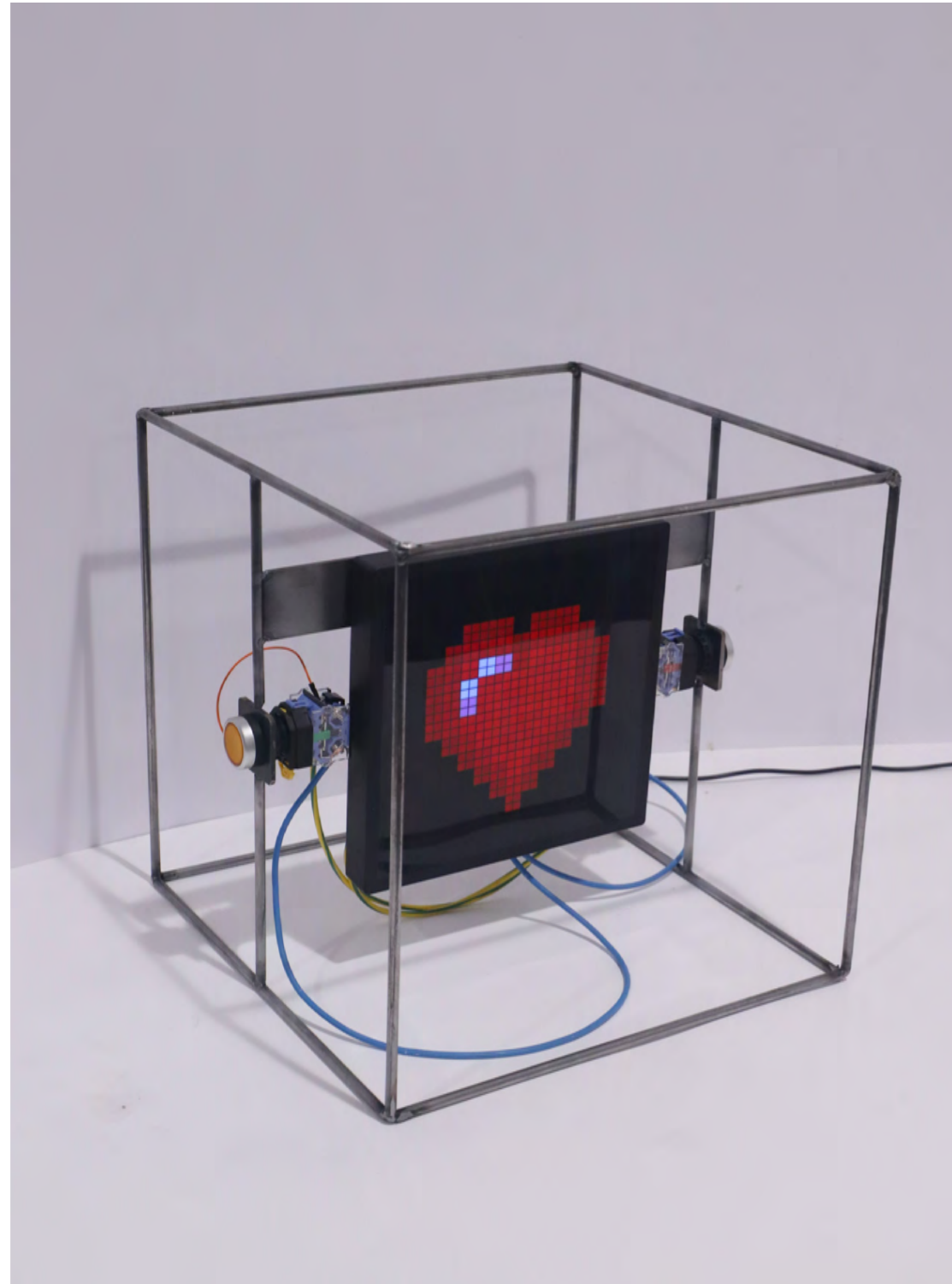



Eros Church

Diotima Ladder Of Love - Symposium

Section 10: 210a - 212c



Diotima maps out the stages in this ascent in terms of what sort of beautiful thing the lover desires and is drawn toward.

1. **A particular beautiful body.** Something we don't have,
2. **All beautiful bodies.** All beautiful bodies share something in common, something the lover eventually comes to recognize.
3. **Beautiful souls.** Next, the lover comes to realize that spiritual and moral beauty matters much more than physical beauty. So he will now yearn for the sort of interaction with noble characters that will help him become a better person.
4. **Beautiful laws and institutions.** High moral.
5. **The beauty of knowledge.** The lover turns his attention to all kinds of knowledge, but particularly, in the end to philosophical understanding.
6. **Beauty itself** – Contains all the above conditions

6 SPACES

Space1. A particular beautiful body



Beautiful place but can't get in

Space2. All beautiful bodies



Familiarity/ Liminal spaces

Space3. Beautiful souls



Shadow

Space of Beauty itself

Space4. Beautiful laws and institutions



Orderly

Space5. The beauty of knowledge



Data Room

Space5. True love button room



Eros Church

Eros Church - Design Concept

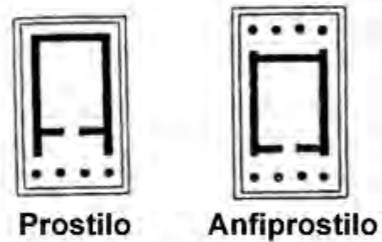
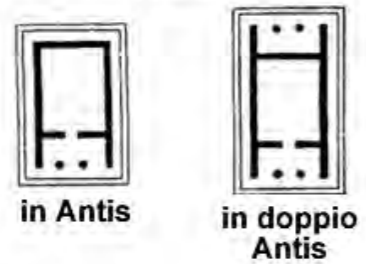
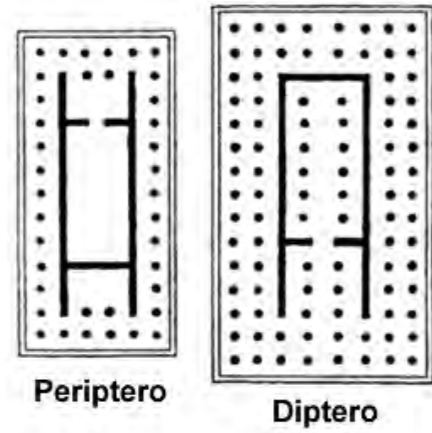
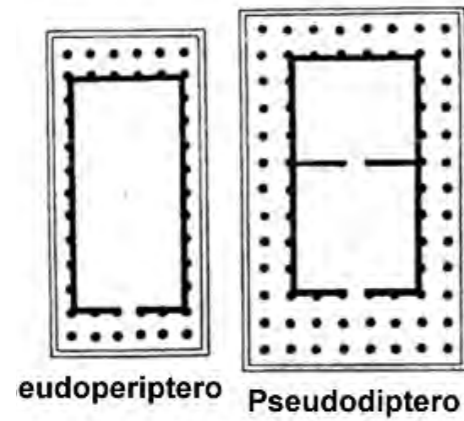

Space 6

Space 5

Space 4

Space 3

Giant Eros sculpture

Space 2

Space 1

Ground floor - Believers worship God of Love and pray



Space functions



Longitudinal space-Cella



Auditorium space-Worship Area



Longitudinal space-Aisle



Communal space-Reflection room
(6 spaces)

"longitudinal space emphasizes the procession and return of sacramental acts, auditorium space is suggestive of proclamation and response, and new forms of communal space designed for gathering and return depend to a great degree on minimized scale to enhance intimacy and participation in worship." Richard Kieckhefer

Traffic flow

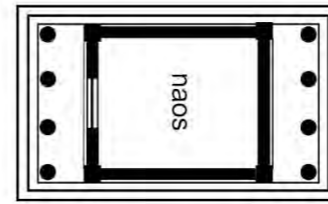

Amphirostyle

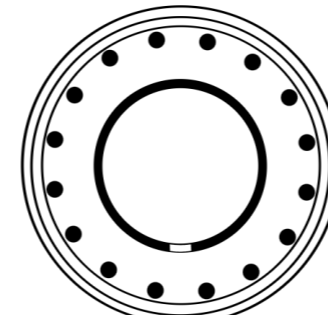
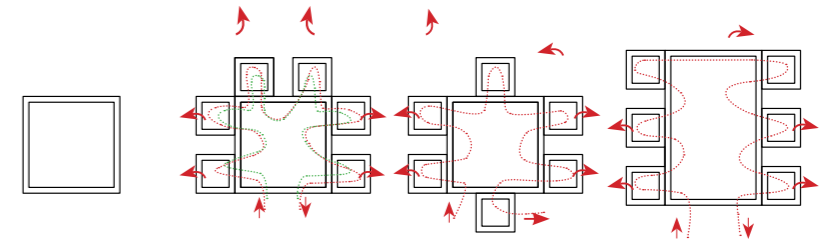

Tholos

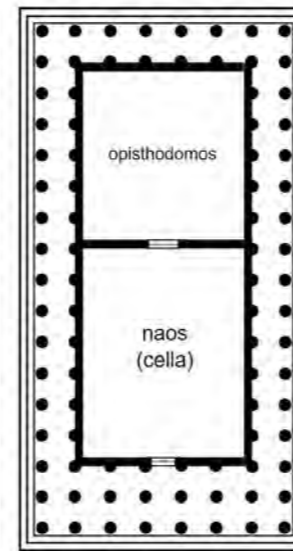
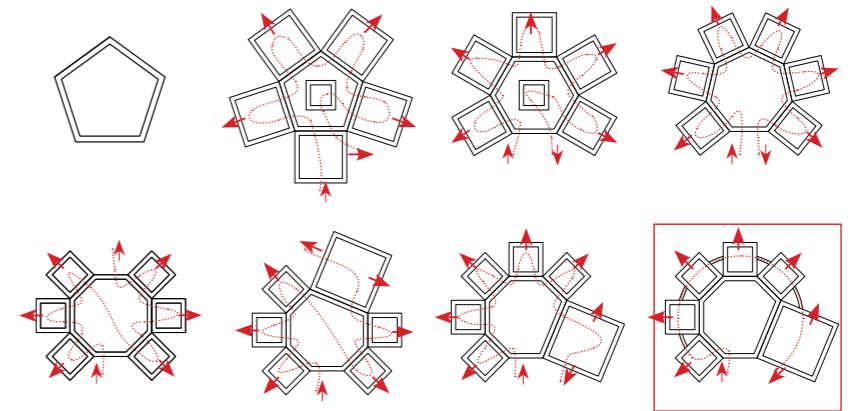

Pseudodipteral

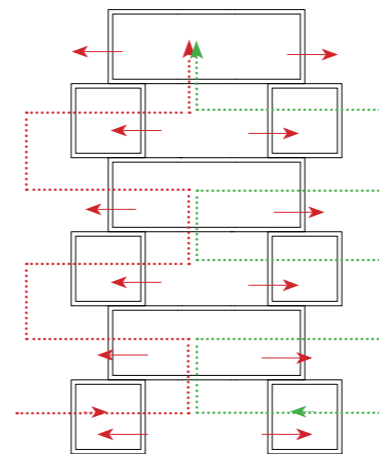
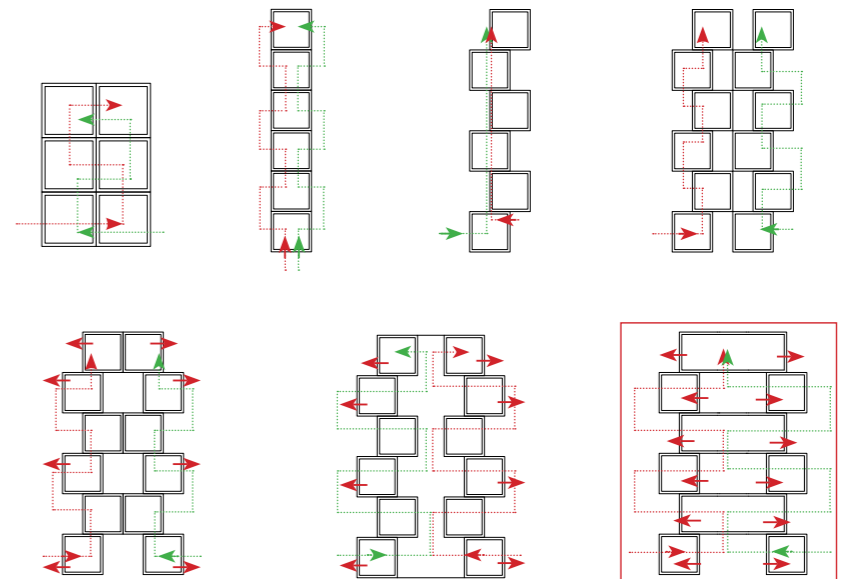

+

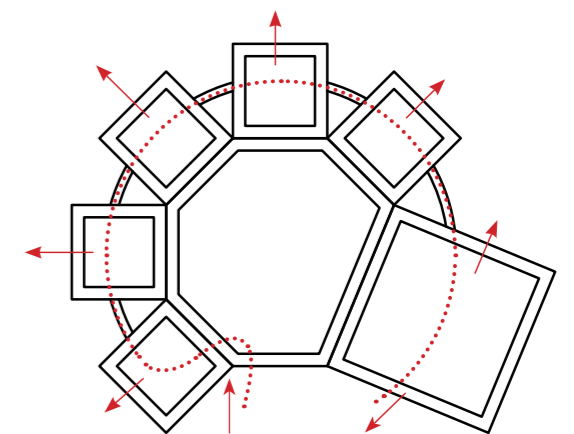

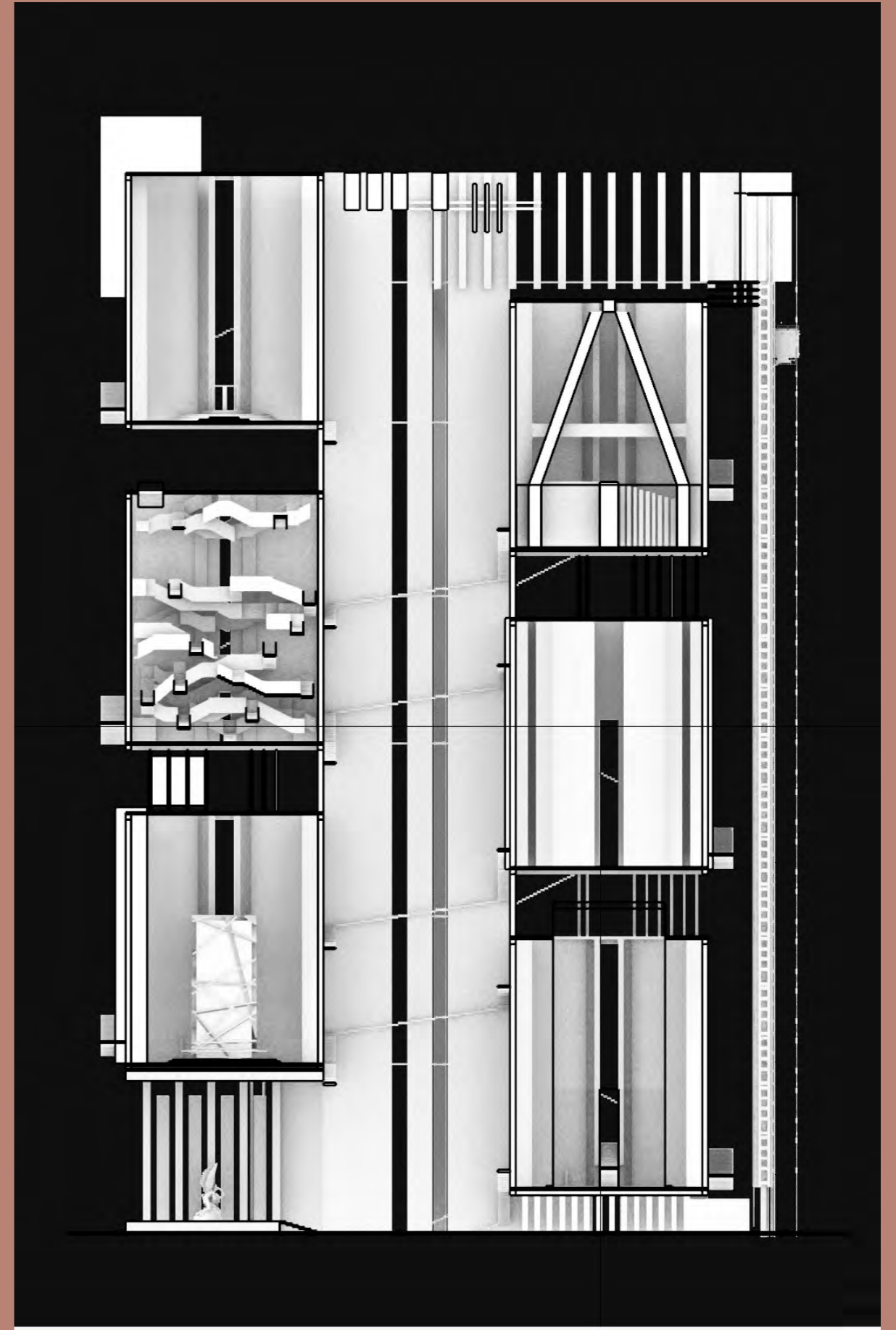
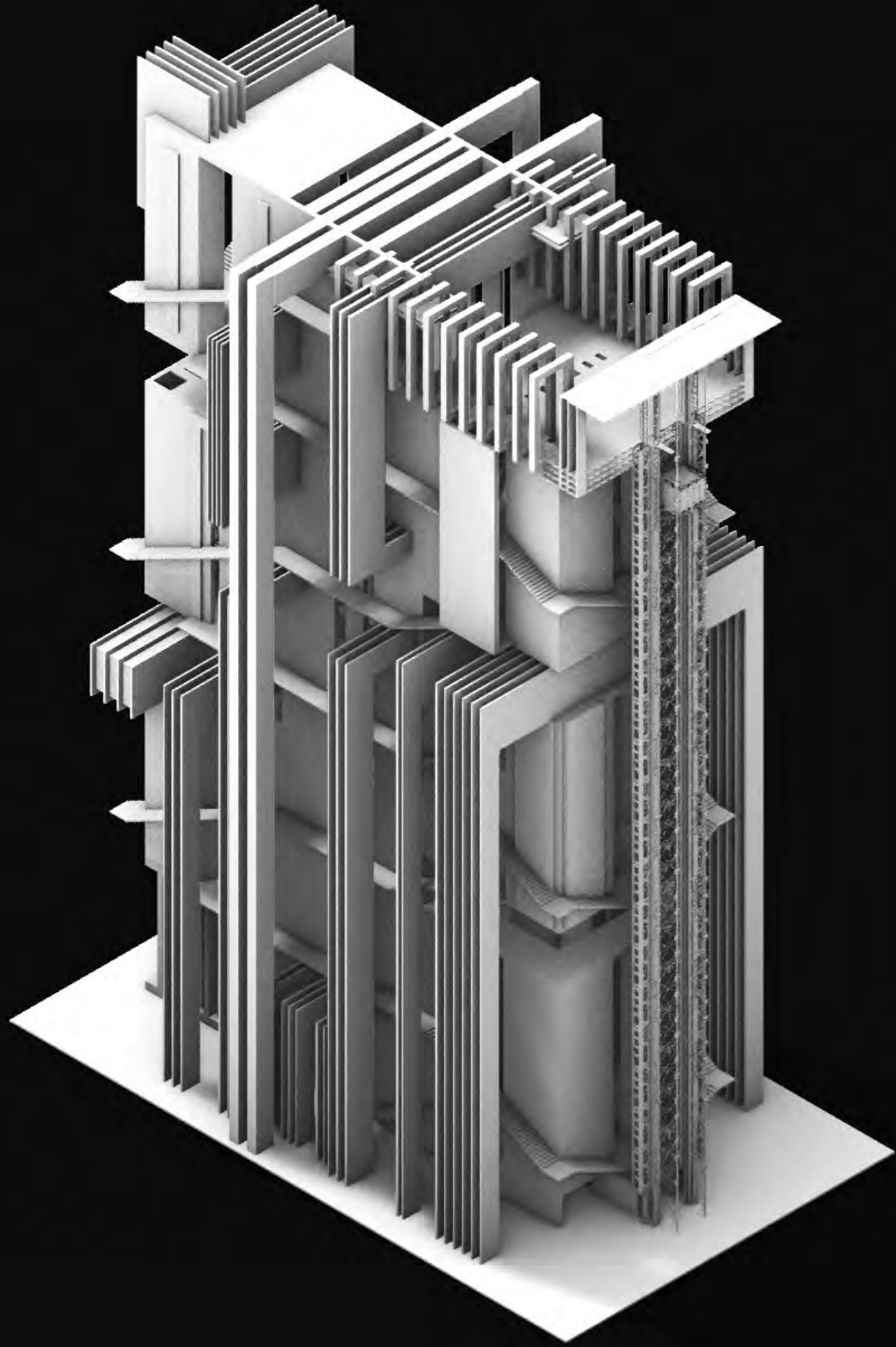

The route to the next space

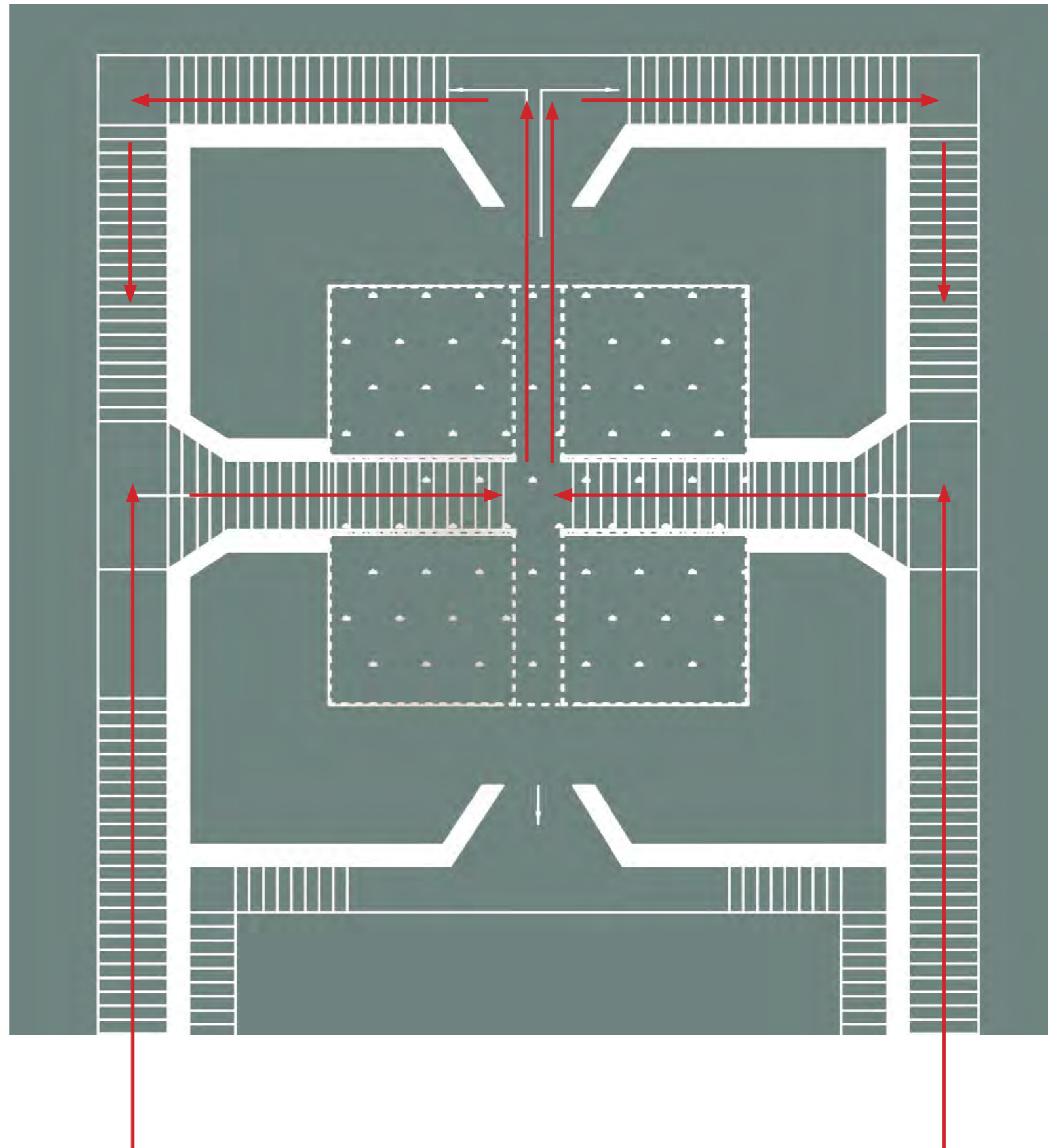

The route to stop experiencing

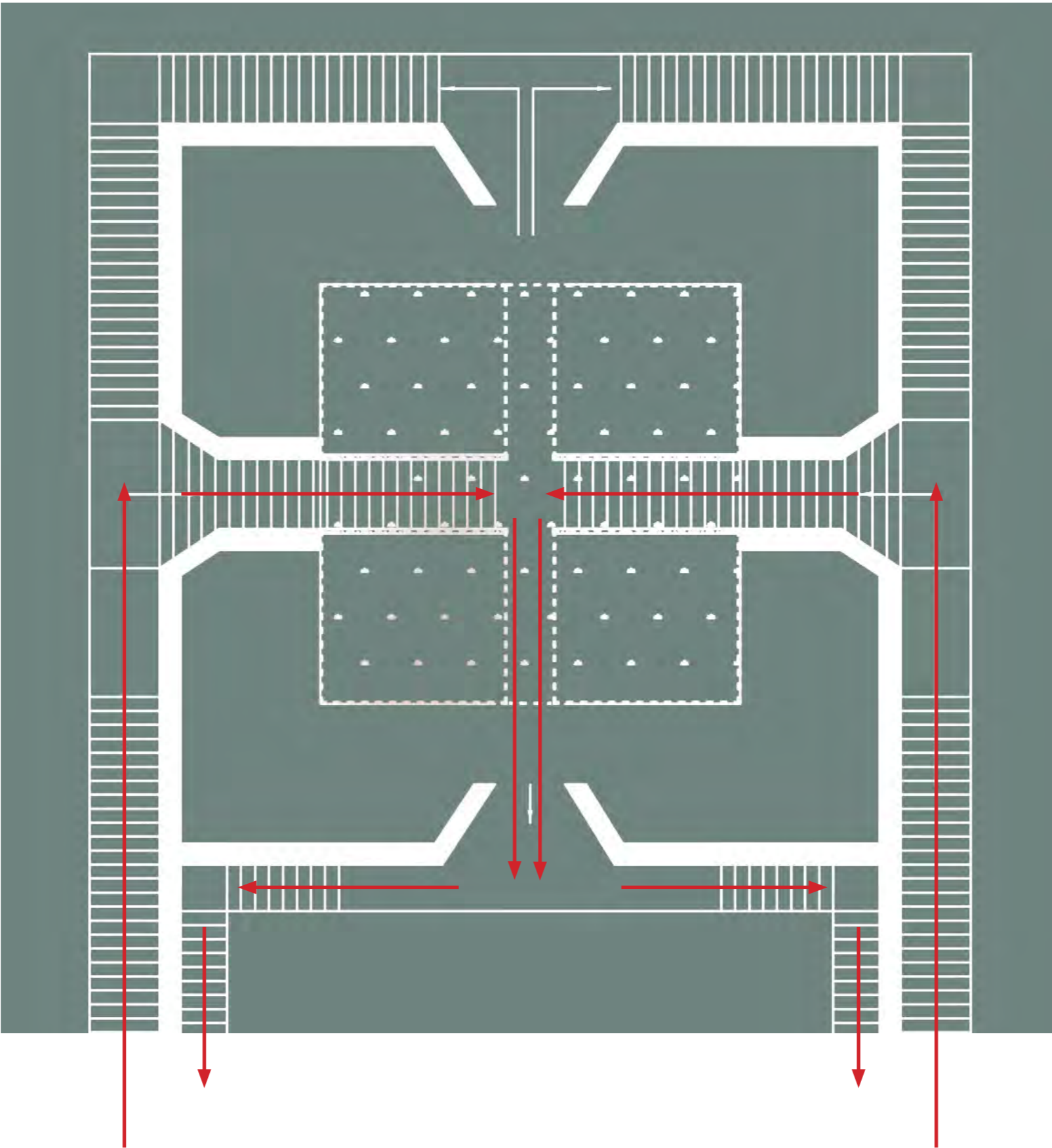

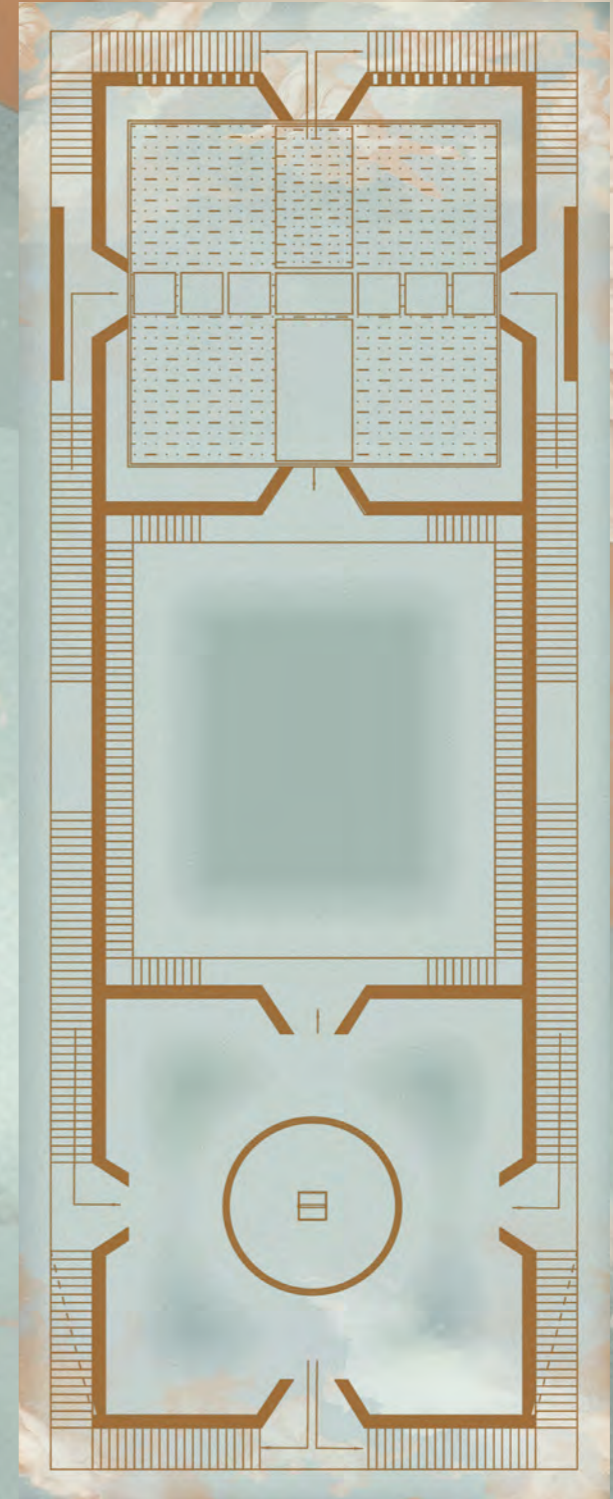
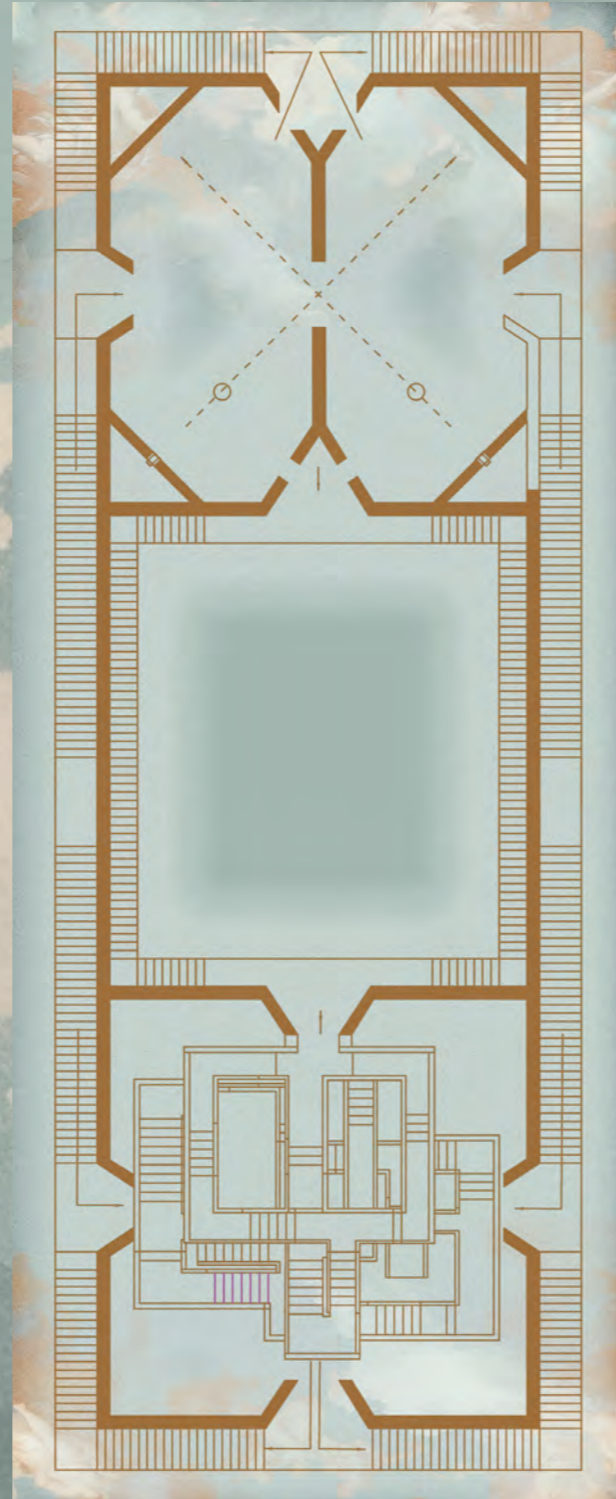
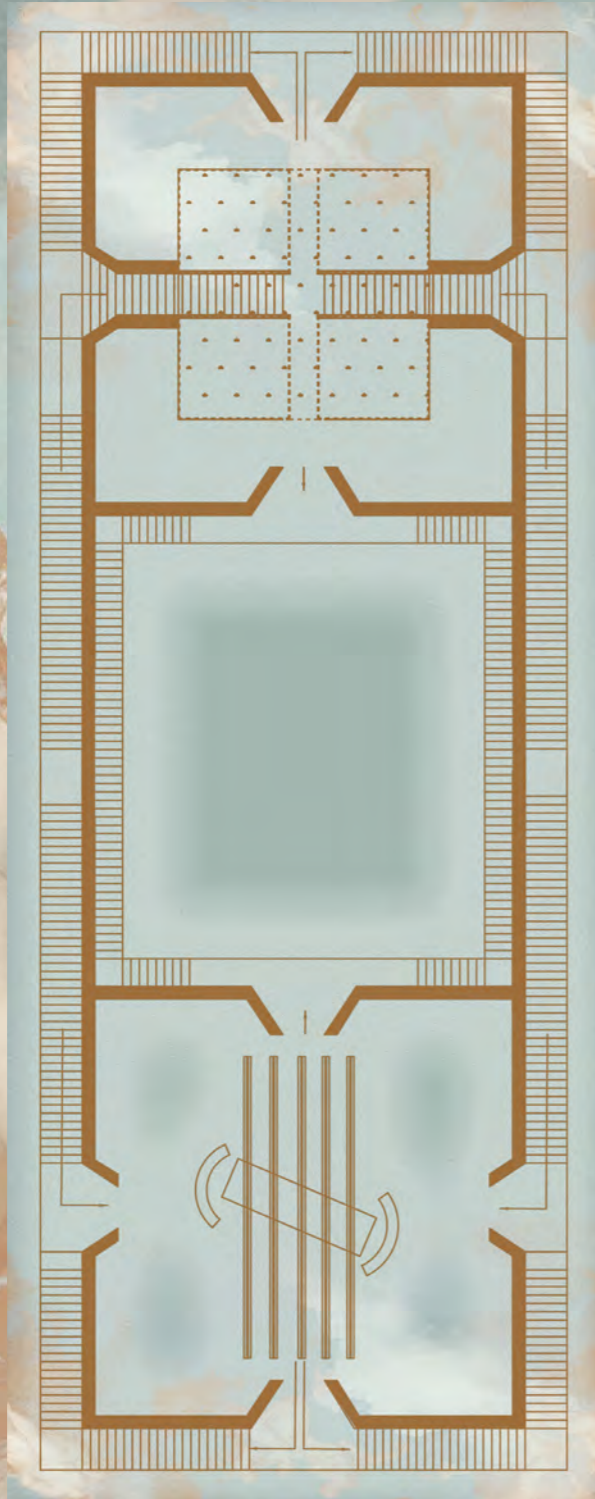

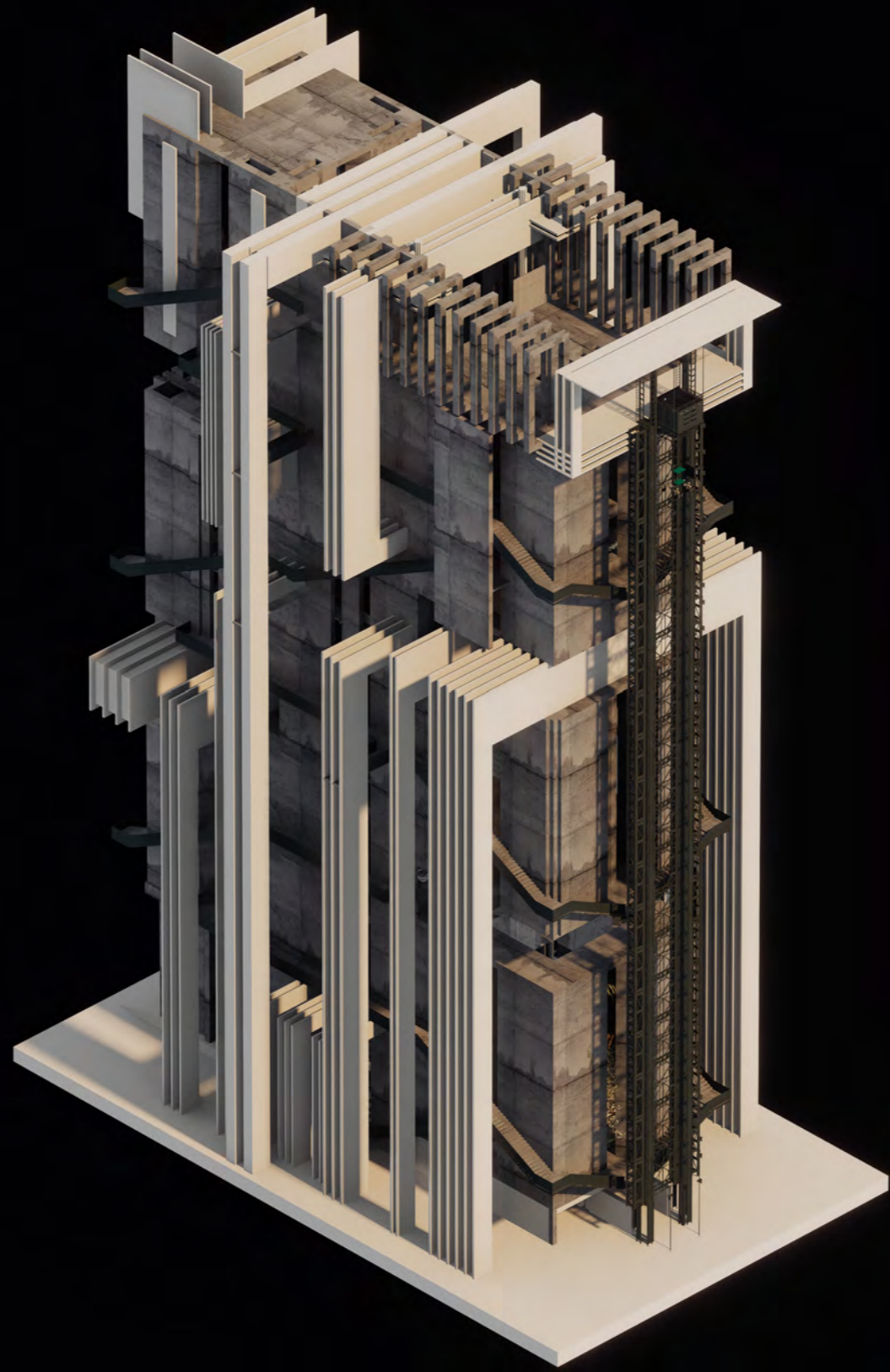









This space represents the first level of the Ladder of Love, "A particular beautiful body." The design concept is to create a beautiful scene that people can get very close to, but never actually enter. The scene is surrounded by glass walls, each 5 meters high. From the entrance, people will initially see a blurred view of the scene through a water curtain. As they move closer, the view will gradually become clearer. Inside the scene, there are four sections, each filled with plants representing the four seasons and adorned with statues of Cupid. Visitors can only walk around the outside of the glass walls.





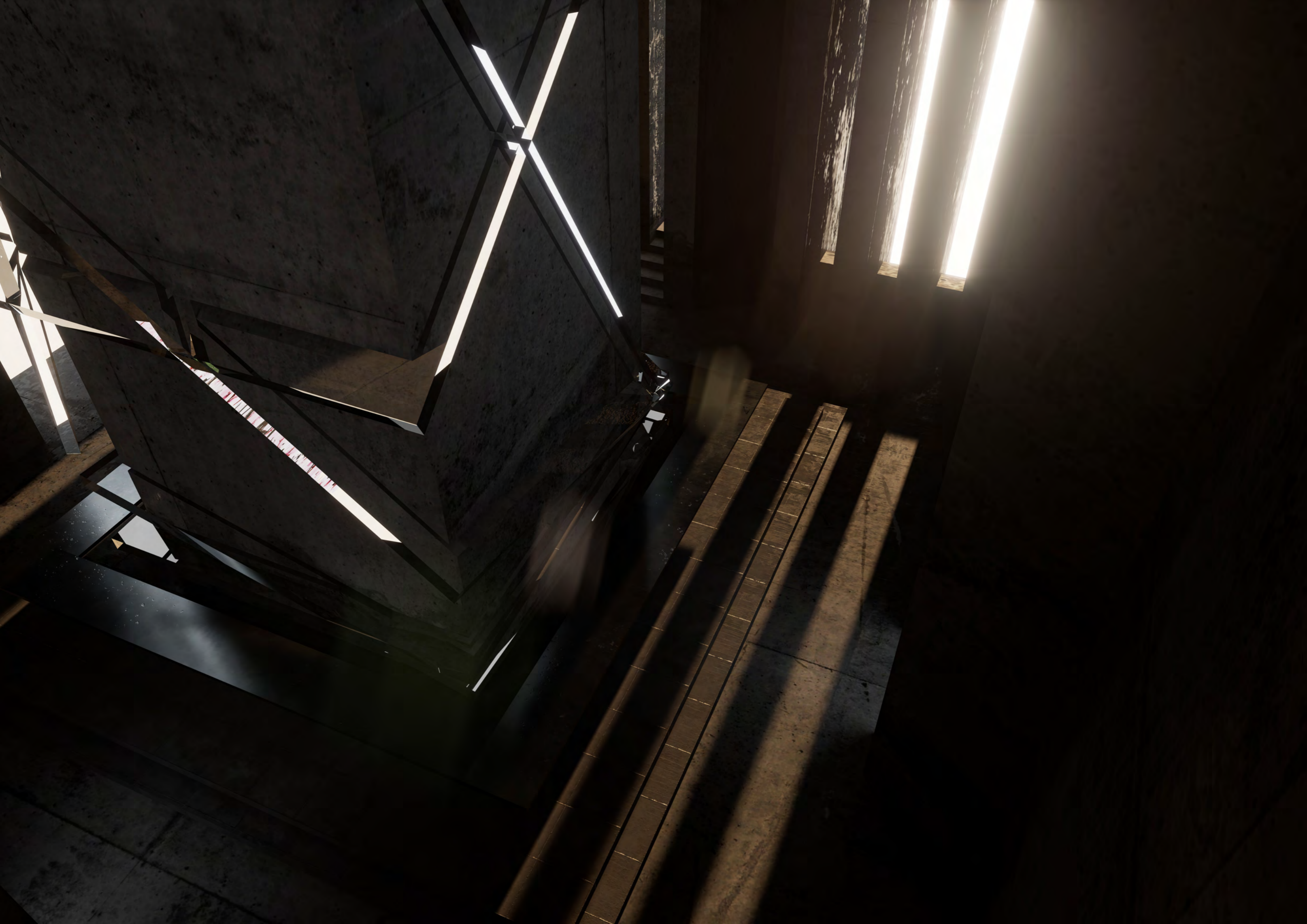





This space represents the second level of the Ladder of True Love, "All beautiful bodies," signifying the shared qualities of beauty in a relationship. At the center of this space, there is a massive column with glass sections inserted in the middle. Surrounding the column are tables where couples can experience the space and have dates through the glass. The glass is 20 centimeters thick, so they can only see parts of each other's bodies, and the parts they see are identical.









This space represents the third level, "Beautiful souls." In this space, couples can only interact with each other's shadows. The space is divided into two sections by a wall with a 5-meter-wide opening in the middle to reflect shadows. High-intensity spotlights are placed behind the seating area, and when someone sits down, their shadow is cast through the opening and reflected onto the opposite wall at a 45-degree angle.









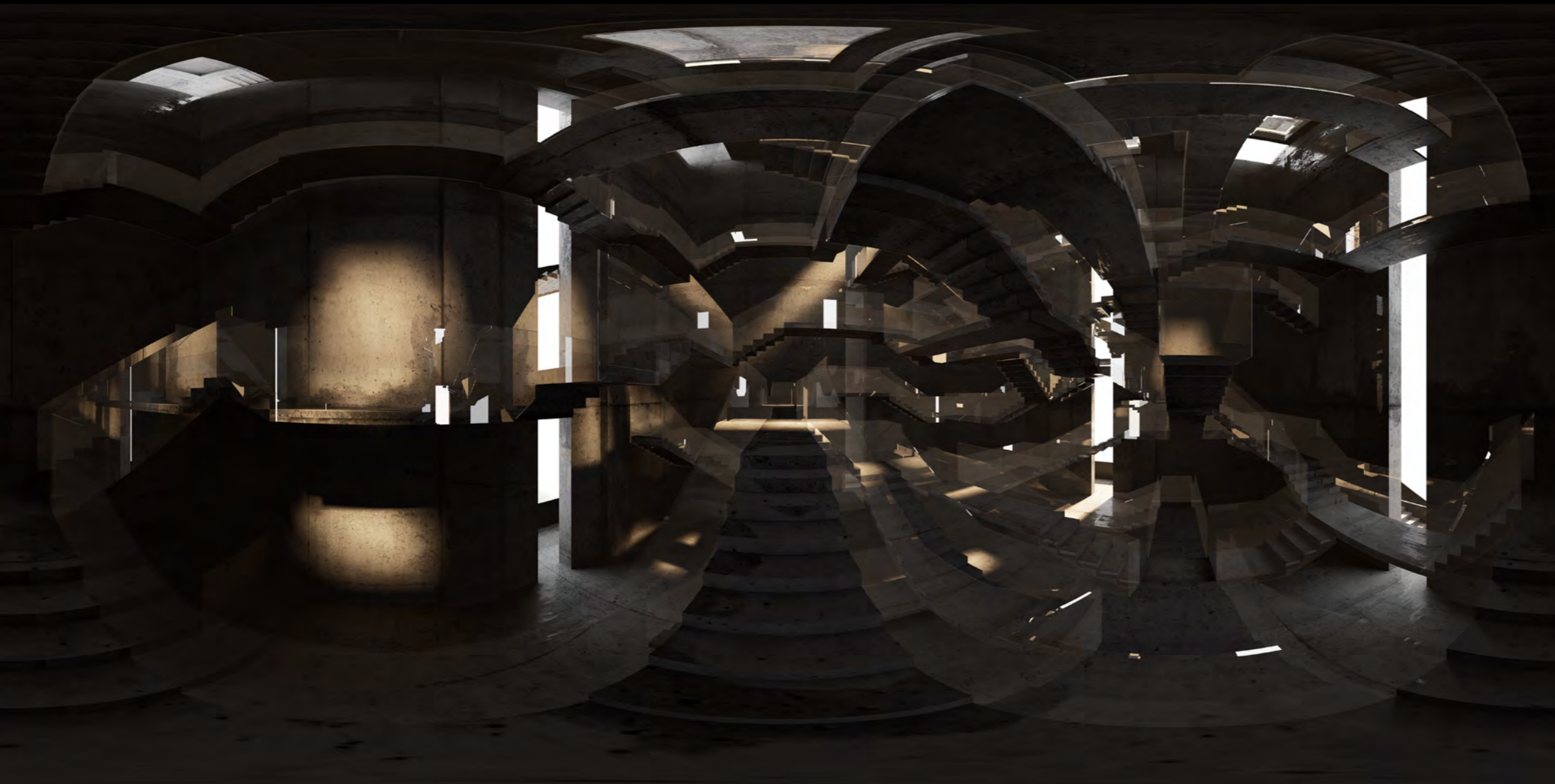

This space represents the fourth level, "Beautiful laws and institutions," which signifies high moral values. The design concept for this space is a maze, intended to symbolize the idea of helping each other to find the way out. The maze has three entrances and one exit. Couples can explore different routes separately and inform each other of the correct paths to assist in exiting the maze. The handrails of the maze are made of glass to allow couples to see each other's positions and facilitate communication.





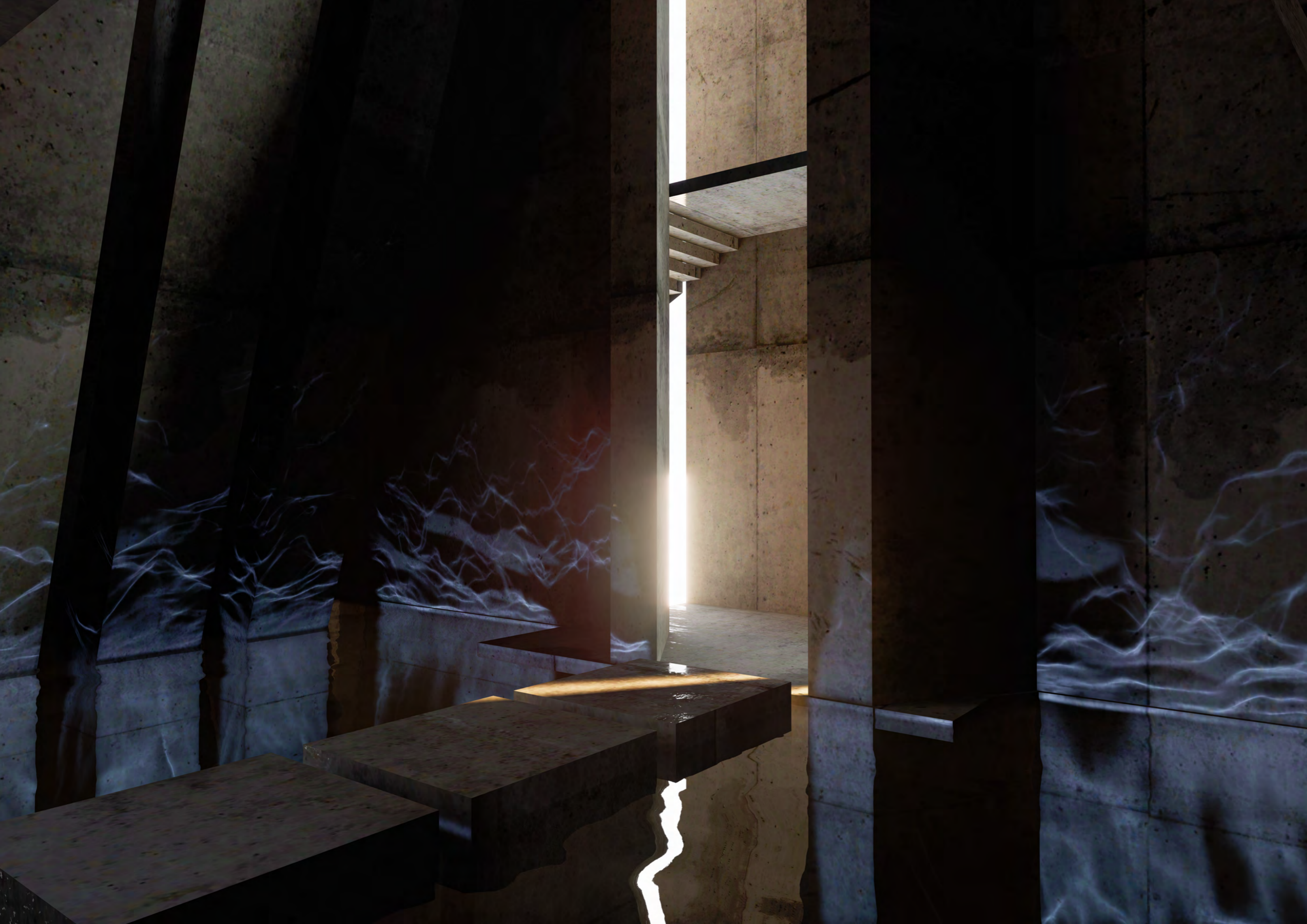



This space represents the fifth level, "The beauty of knowledge." According to the description in the Symposium, the fifth level involves more spiritual connection and resonance, independent of the physical body and language. Therefore, the design concept for this fifth space is a meditation area. Couples will arrive at this space from two different paths, with the exit hidden underwater. They can choose any block for meditation, each block connected to an underwater drainage system. Through gravity sensing, when someone sits down, the drainage will begin. After they have sat for a certain period, the exit hidden underwater will be revealed, allowing them to proceed to the next space.





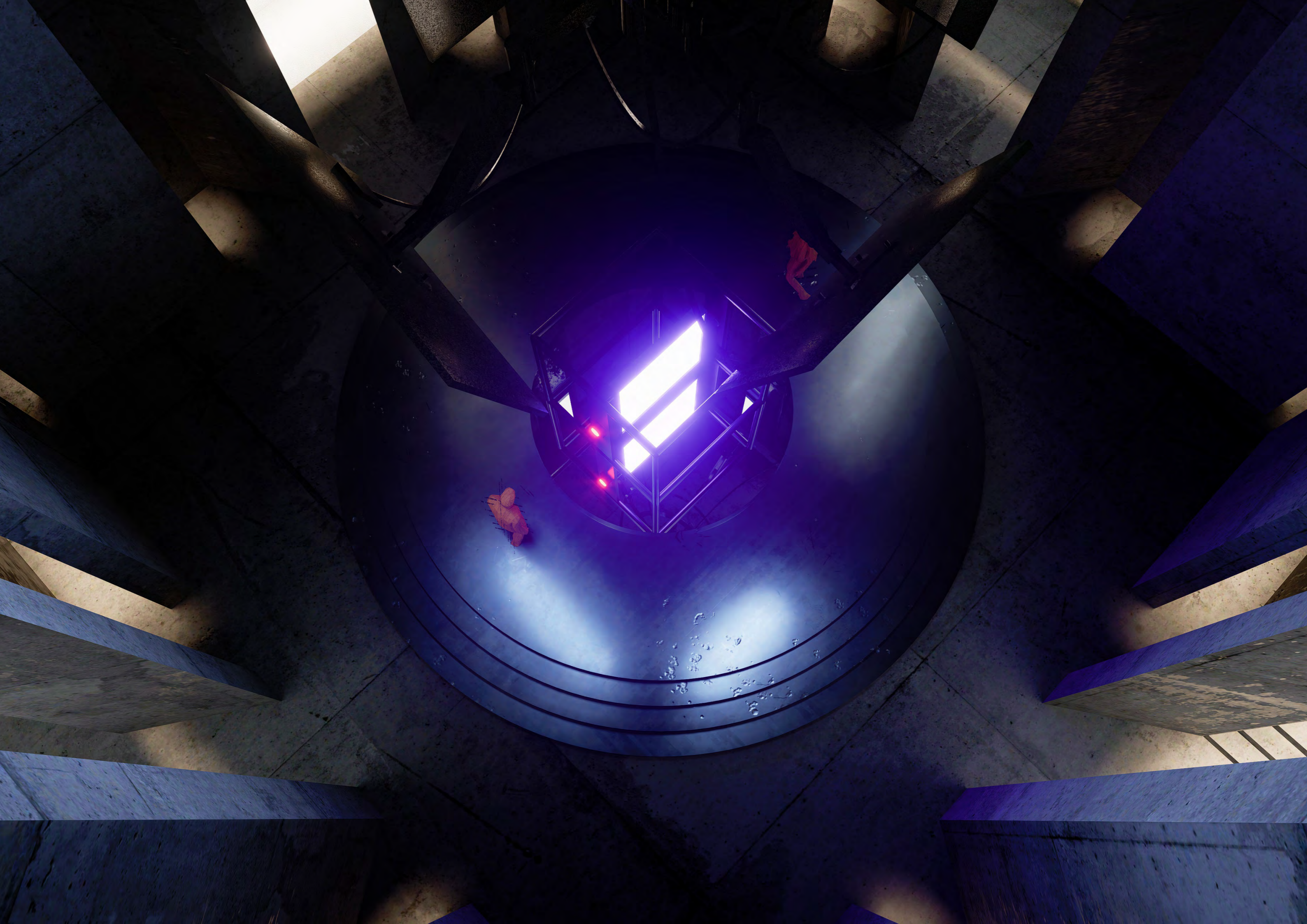

The sixth space is where the True Love Button is located. When the couple successfully reaches this point, they will decide whether to press the True Love Button. If the button confirms their true love, they will ascend to the ground level via the rear elevator, pass through a tunnel, and arrive at the hall of the Eros Chapel, where they will receive blessings from Eros and those waiting for them. If they fail, they will exit through an internal staircase.









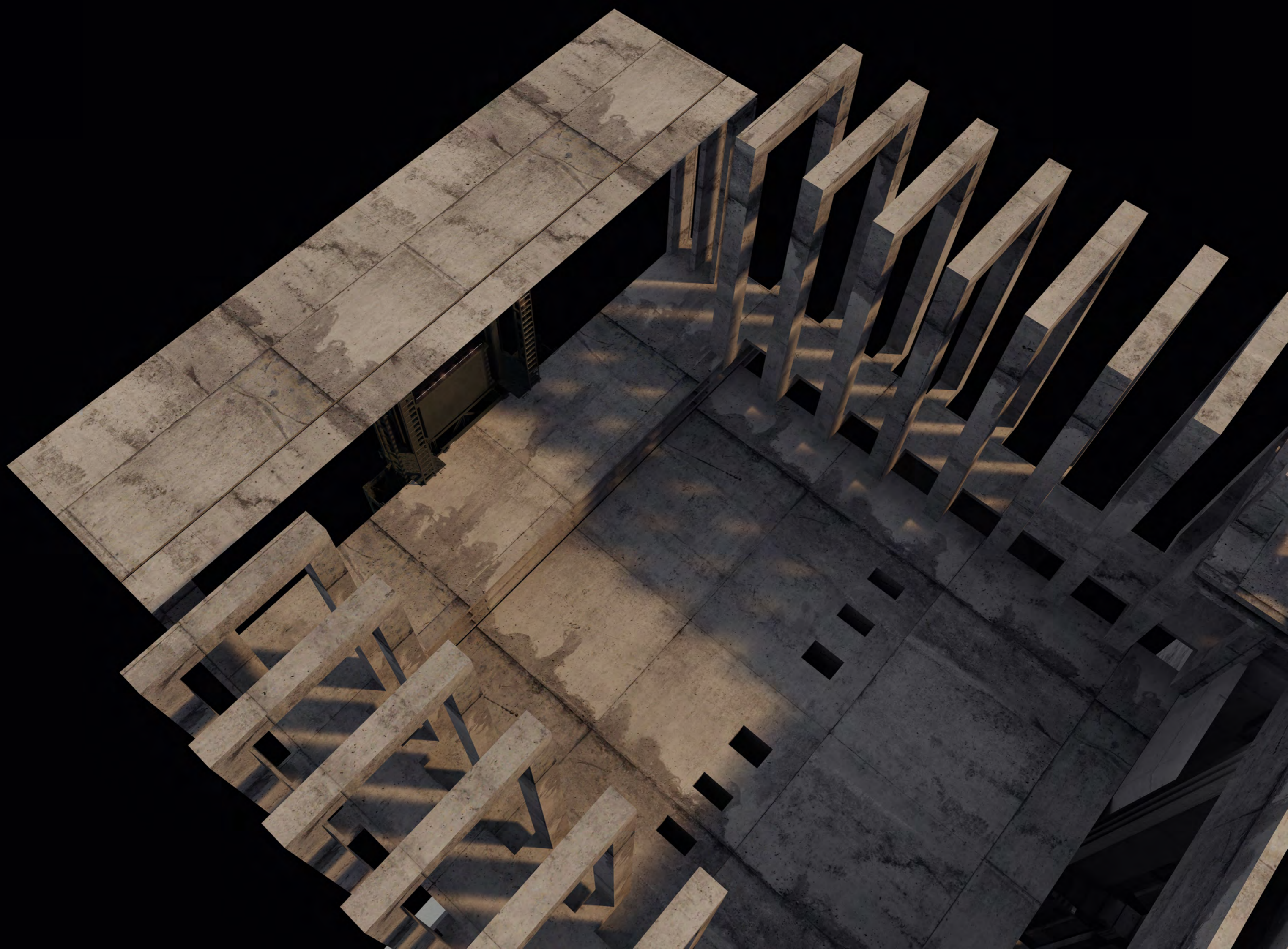











The entire Eros Church represents the sixth level of the Ladder of Love: Beauty Itself.

The diagram shows the main hall of the Eros Church, which is divided into three sections: the forehall, the central hall, and the tunnel. The forehall features a statue of Eros. The central hall is designated for worshippers to perform services and to welcome couples who have successfully pressed the True Love Button. The tunnel, located at the rear of the central hall, connects the central hall to the elevator leading to the True Love Button.

360 Tour



<https://www.modelo.io/dam-share/panorama/1802363869008523264/197461?logo=false>

STORY BORAD



END.

