

# VAISHALI ODEDRA

Interior Design 2024-25

RCA

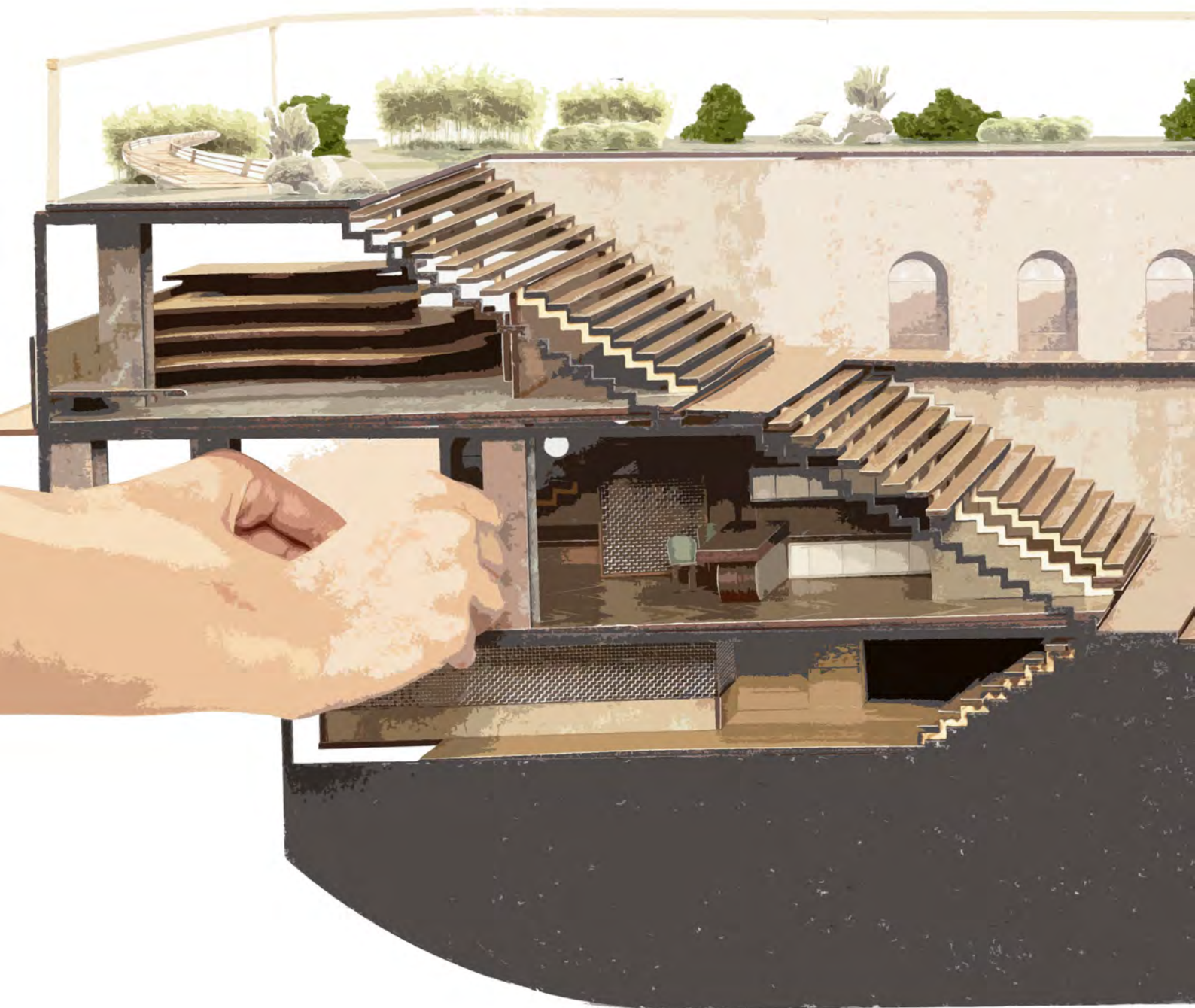

# TIDES OF RESILIENCE

Reimagine sinking islands by **expanding land** through floating **repurposed ships** without abandoning their home

**Empower** indigenous **women artisans** by transforming home-based crafts into sustainable livelihoods.

Integrate collaboration & technology with traditional techniques to **boost product value**.

**Bridge the gender economic gap** (India ranks 142/146 in women's economic participation<sup>1</sup>).

**Design compact**, mixed-use neighborhoods where **essential services** are a few minutes' **walk away**.

Enable **women to balance home, family & enterprise** without long commutes.

Create a **living cultural archive** that shares indigenous stories, memories & identities globally.



## TRUE PRICE OF PARADISE

SuperFUTURES  
(Interior Design)  
What Is?  
RCA | NOV 2024

The research short film focus on cruise holidays that promise luxury and adventure but rely on a vast network of people: tourists seeking leisure, workers supporting operations, and communities sustaining the supply chain. Behind the scenes, marginalized workers keep these floating cities running, while destinations like Jamaica offer curated experiences, often disconnected from local realities. Cruises contribute to pollution, overtourism, and economic dependency, disproportionately impacting vulnerable communities. Efforts like emission-free ships and private ports aim to reduce harm, but fair treatment and sustainability remain crucial for a responsible future.

Made from found footage & research  
Edited with Adobe Premier Pro  
Credits: Youtube, Freesound, Pixabay

Youtube found footage credits

SI  
IT  
OF  
Q  
S  
Y  
G  
R  
2  
4  
5  
1  
00  
1  
2  
3  
4  
5  
6  
7  
8  
9  
10  
11  
12

# Interwoven Landscapes

Physical collage of different scales of landscapes that relate around cruise industry and their connections explored.

## Docking Damage

Cruise lines reduced heavy fuel oil use from 74% to 57%, but their extended port stays in pristine areas raise concerns about pollution—questioning if the 17% cut is enough.

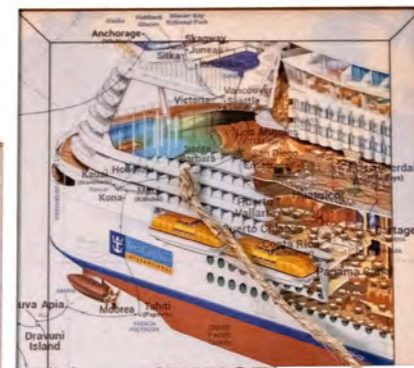

## From Mega To Minimal

The royal caribbean ship is 4 times the football pitch

## Contrasting Lives

Male dominated bridge room taking control of the ship and managing it. And huge contrasting difference in cabin size for crew and guests.



## Silent Workers

The impacts on portside communities, questions remain about fair pay and working conditions for local artisans and vendors.



## Sinking Communities

Residents note that cruise tourists spend most of their money on the ship or related businesses, while jobs created by the industry are seasonal and unstable.



## Supply Chain: Supply chain of people-toruist, workers & communities

Cruise holidays promise luxury and adventure but rely on a vast network of people: tourists seeking leisure, workers supporting operations, and communities sustaining the supply chain. Behind the scenes, marginalized workers keep these floating cities running, while destinations like Jamaica offer curated experiences, often disconnected from local realities. Cruises contribute to pollution, overtourism, and economic dependency, disproportionately impacting vulnerable communities. Efforts like emission-free ships and private ports aim to reduce harm, but fair treatment and sustainability remain crucial for a responsible future.



# THE TRUE PRICE OF PARADISE

A young traveller, inspired by social media, dreams of a luxurious cruise vacation but discovers the hidden environmental costs of the industry through research. She opts for a sustainable hybrid-electric vessel in Norway, documenting her journey and sharing her experiences. However, she uncovers the deeper challenges of cruise tourism, including over-tourism and its impact on local communities and ecosystems. Realizing that even “green” solutions have limitations, she shares her insights through blogs and videos, sparking awareness and influencing others to rethink their travel choices. The story ends with a cycle of influence, showing that change starts with knowledge.

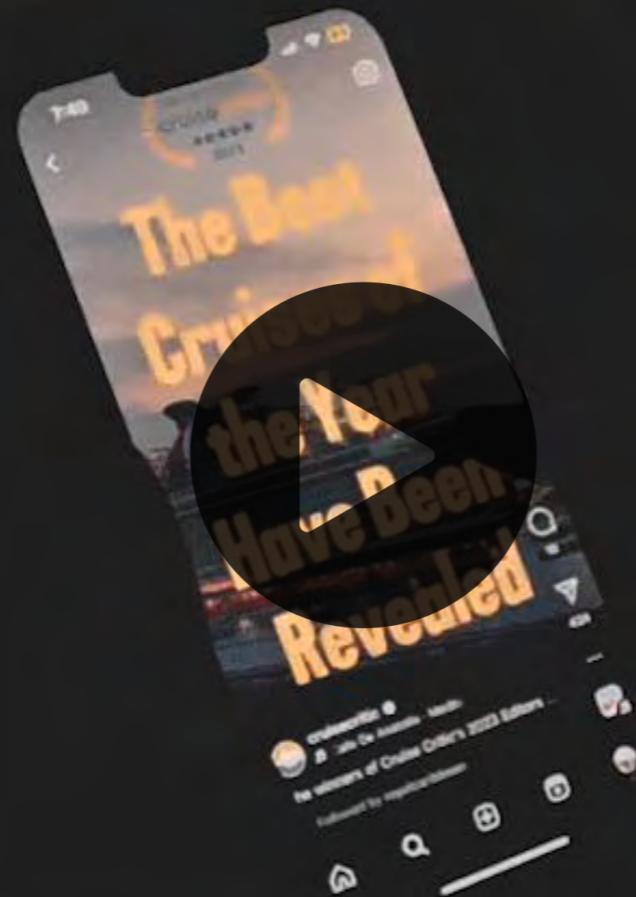

## ECHOS OF RIPPLE



## SHIPSCAPE

SuperFUTURES

(Interior Design)

What If?

RCA | JAN-MAR 2025

This speculative spatial design project envisions a resilient future for the Andaman Islands located in east coast of India in the wake of climate catastrophe. It follows a tsunami survivor whose personal journey—marked by memories of gender oppression and the wisdom of indigenous traditions—merges with a community effort to rebuild sustainable lives through the Habitation Shipscape Program. The rehabilitation initiative begins with the introduction of a new policy for repurposing decommissioned cruise ships as floating shelters, gardens, schools, clinics, and community hubs for climate refugees.

It leverages renewable energy, traditional craftsmanship integrated with modern technology, and local job creation. Complementing these efforts is a cultural revitalisation strategy that promotes community-centric agriculture, heritage storytelling, environmental reconnection, and the digital empowerment of traditional handicrafts, ultimately paving the way for economic recovery and gender empowerment.



# Recalibrating Paradise: A 2035 Policy Response

A future policy set in year 2035, affected after ship ban to study the consequences building upon the research done in true price of paradise and other contextual elements.

## POLICY

International policy: Repurposing Cruise Ships for Climate Refuge Rehabilitation

Following the UN cruise ship ban, the structures of all decommissioned ships will be repurposed to support islands affected by rising sea levels. These ships will be transformed into floating shelters, schools, clinics, and community hubs for climate refugees. Retrofitting will prioritise renewable energy, traditional crafts method with technology, repurposing the ship modification materials, and local job creation, bolstering regional economies.

A collaborative effort between public such as government and private sectors such as companies will provide funding and oversight, with transparent mechanisms dictated by UN guidelines.

## AIMS

To stop the cruise industry's pollution and over-tourism while simultaneously protecting vulnerable islands from climate change, conserving their identity and culture with technology, and repurposing cruise ships.



# Climate Refugee ID

Climate Refugee ID showing person's identity in the shipscape rehabilitation program of reusing the ship, along with rights and cultural heritage record secured with finger prints.



Formal workers protesting card as part of resultant initial opposition and justice for workers who lost job due to ban.



# Tides That Shifted Policy



Severe climate change effects escalate globally, with record heatwaves, intensifying storms, widespread droughts, and rising sealevels, putting vulnerable communities and ecosystems under unprecedented strain.

2025



At Alang, the world's largest shipping yard gains a technological edge as Reliance invests in robotic systems to remove toxic parts and dismantle cruise ships.

2030



International policy on repurposing Cruise Ships for Climate Refugee Rehabilitation is introduced to address the ban on cruise ships and its consequences.

2035

Cruise ships pumped out 17% more carbon dioxide in 2022 than they did in 2019, the report found, and methane emission rose 500% over the same time period.

2022



People started gathering in large groups & organizations protesting against cruise industry effects

2026



The global cruise market was valued at \$7.25 billion in 2021 and is expected to grow 11% from 2022 to 2028.

2021



The first model is established on South Asian islands in the Indian Ocean, specifically in the Andaman Islands of developing countries.

2040

The UN cruise ban policy sparked chaos by limiting jobs to a few, infrequent emission-free electric cruises, prompting protests for justice.

2030



UN imposed complete ban on cruise ships

2030



Tiny island communities are severely threatened by rising sea levels, displacing 1 million+ people and threatening over 1,000 islands with land loss and flooding.

2026

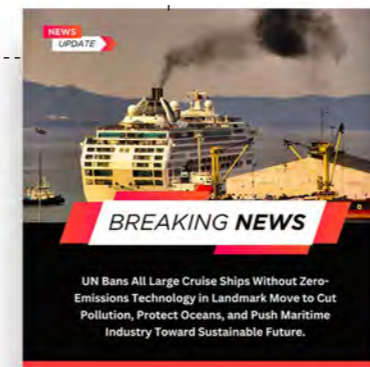

Governments partnered with organizations to re-skill workers in hospitality, tourism, and logistics, while promoting eco- and land-based tourism for sustainable travel.

2032



Adding 250-375 ships would nearly double the global fleet size to 600-800 ships by 2050, depending on the pace of growth and retirements.

2022



ST  
IT  
OF  
2  
3  
4  
5  
6  
7  
8  
9  
10  
11  
12

# Charting Andaman's Shifting Shores: Land Loss & Shipscape Extensions

Three maps illustrate the Andaman Islands' transformation under rising seas and adaptive reuse of decommissioned cruise ships: rising seas submerge Andaman's natural coastline by 2040, prompting floating ship decks to restore habitable ground. By 2100, a linked network of modular vessels replaces much of the lost shore, sustaining community life.



# Charting Andaman's Shifting Shores: 2100 Shipscape Network (Zoom-In)

By 2100, interlinked floating vessels (shipscapes), connected by pedestrian bridges containing house living shelters, schools, research hubs, learning centers, and animal sheds. This interconnected vessel grid replaces lost shorelines with a multifunctional marine community.



# Weld & Weave: Visualisation's Ship-to-Sanctuary Process

Visualisation of new ship dismantling station with robots working on it, people weaving inside the repurposed ship and ship's connection to land for sacred rituals. These visuals were produced through rigorous output using **Mid journey AI** where below a glimpse of process images and the compiled book of process.

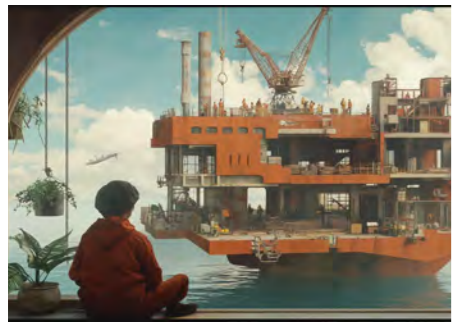



# Spatial Strategy: Ship Section Analysis

Decks are zoned into functional blocks—living, workshops, communal, arranged by volume and adjacency. Strategic spatial links optimize flow, connectivity, and program synergy.

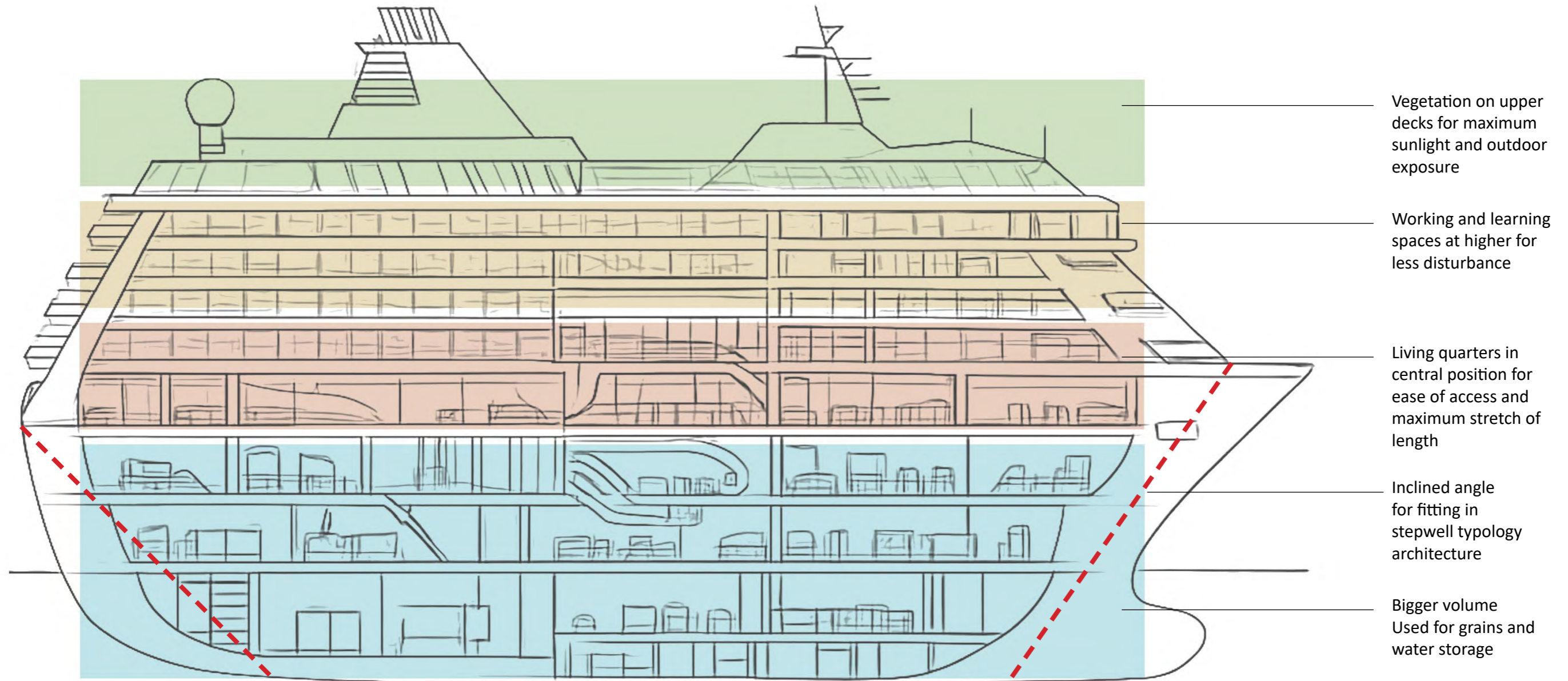

SI  
FT  
01  
0  
8  
Y  
9  
2  
4  
E  
5  
I  
00  
1  
2  
3  
4  
5  
6  
7  
8  
9  
10  
11  
12

# Descending Volumes: Stepwell-Inspired Zoning & Section Blueprint

The plan arranges programmatic zones in concentric, tiered rings—public, communal, and private that mirrors a stepwell’s descending geometry. The section cuts through cascading platforms, guiding circulation and gathering toward a central “well” core.

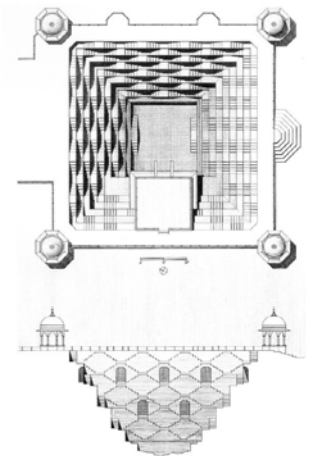
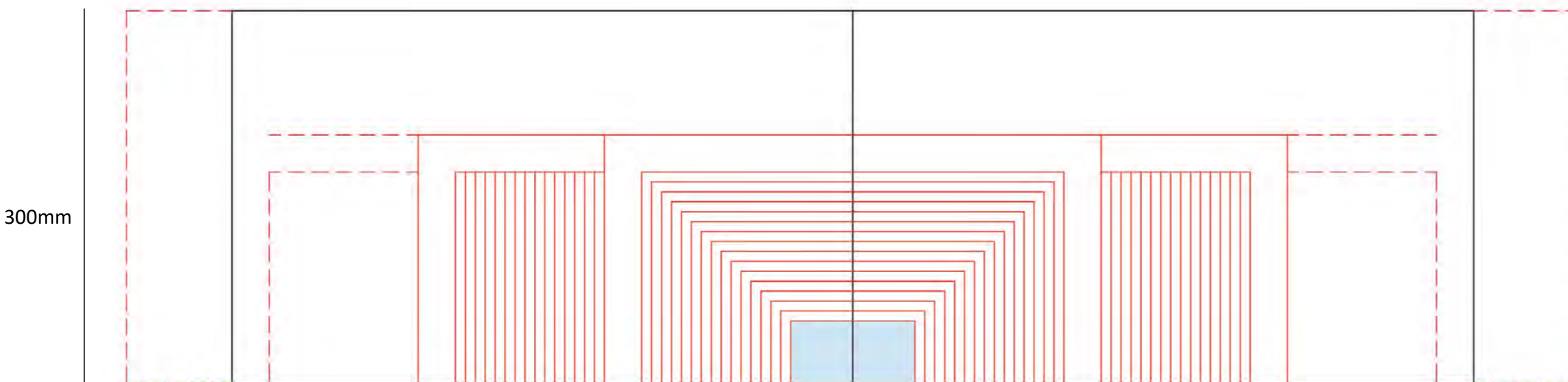
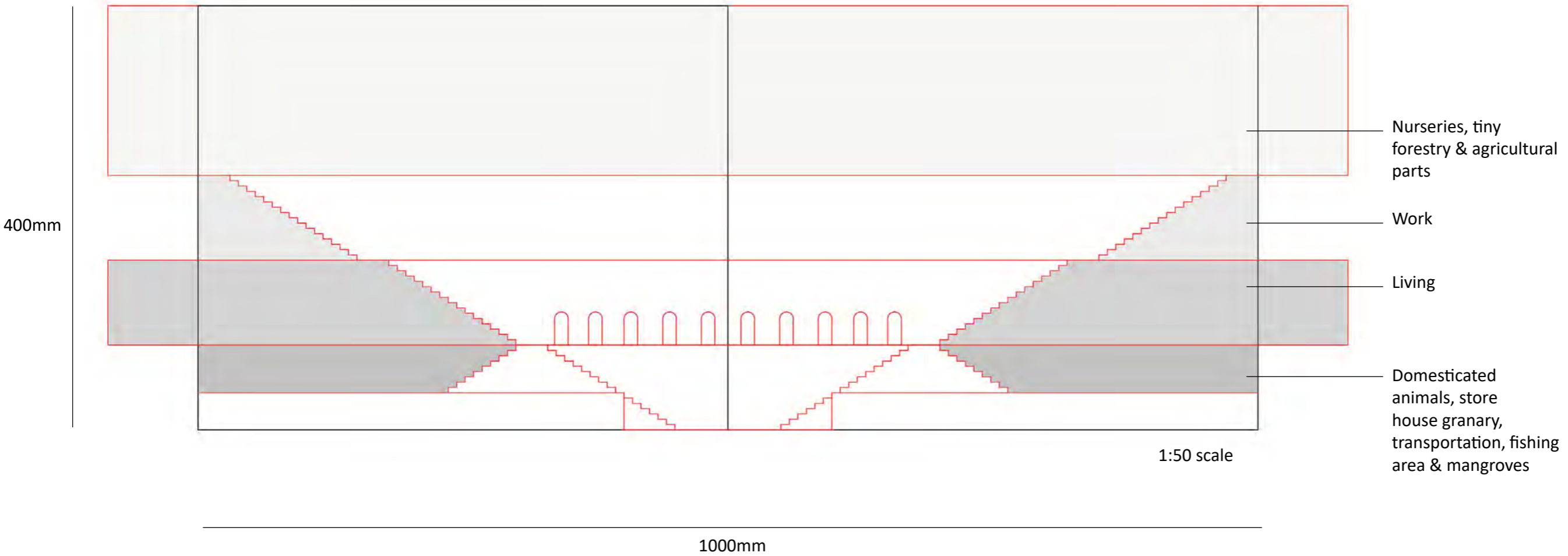

References from stepwells in India to store freshwater supply and generate communal spaces.



# Adaptive Interiors: Sectional Sketches & Spatial Layouts

Sectional perspectives and plans showcase compact, multifunctional spaces—each optimized through thoughtful furniture layouts and zoning. Local materials shape interiors from living quarters to farms, workshops, sheds, and stepwell-inspired communal hubs.



Collage for LVL 2- R (workshop space)

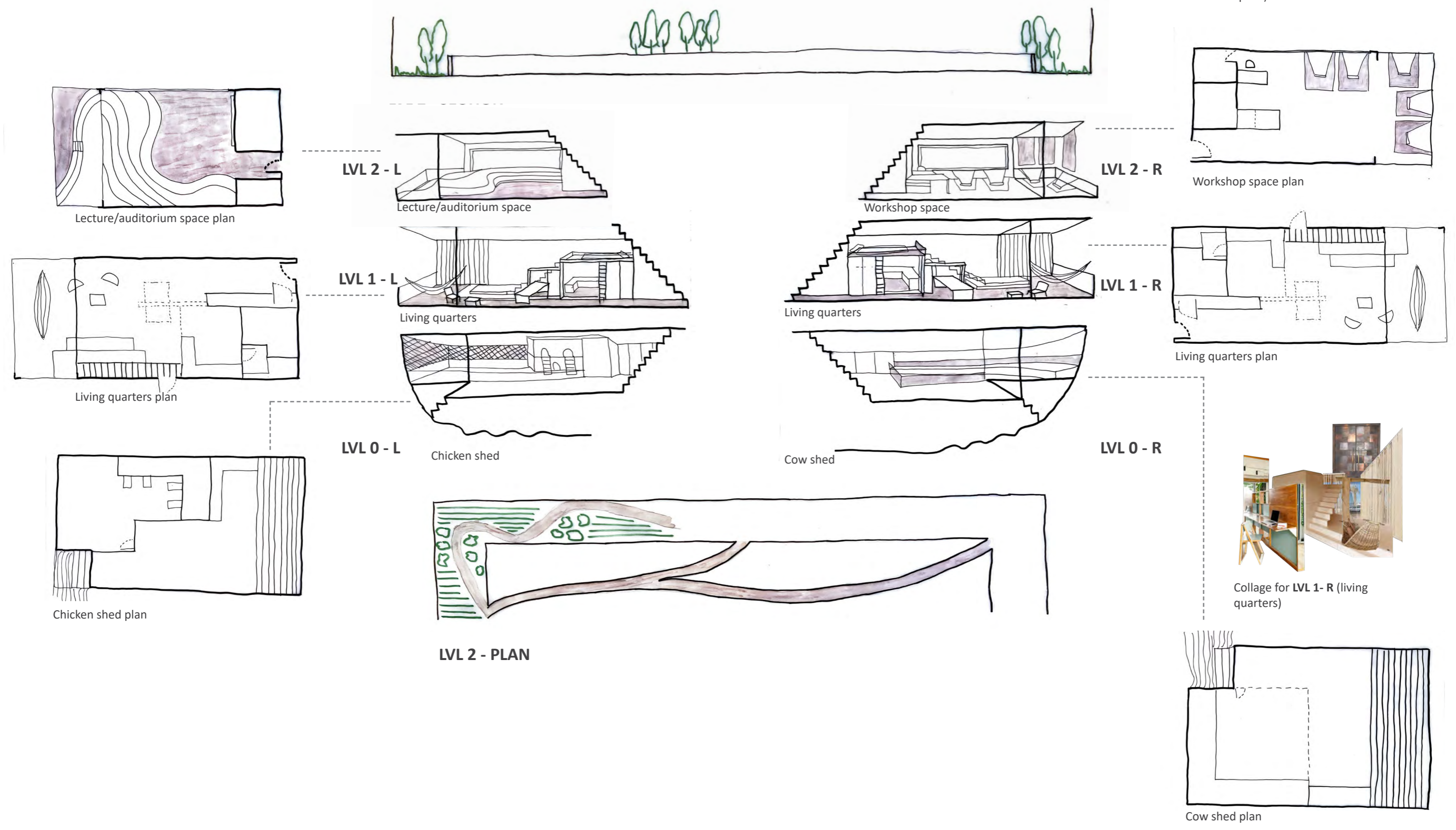

# Concept Model & Material Moodboard

The overall set model is paired with texture samples, capturing spatial character and material mood through form and finish.

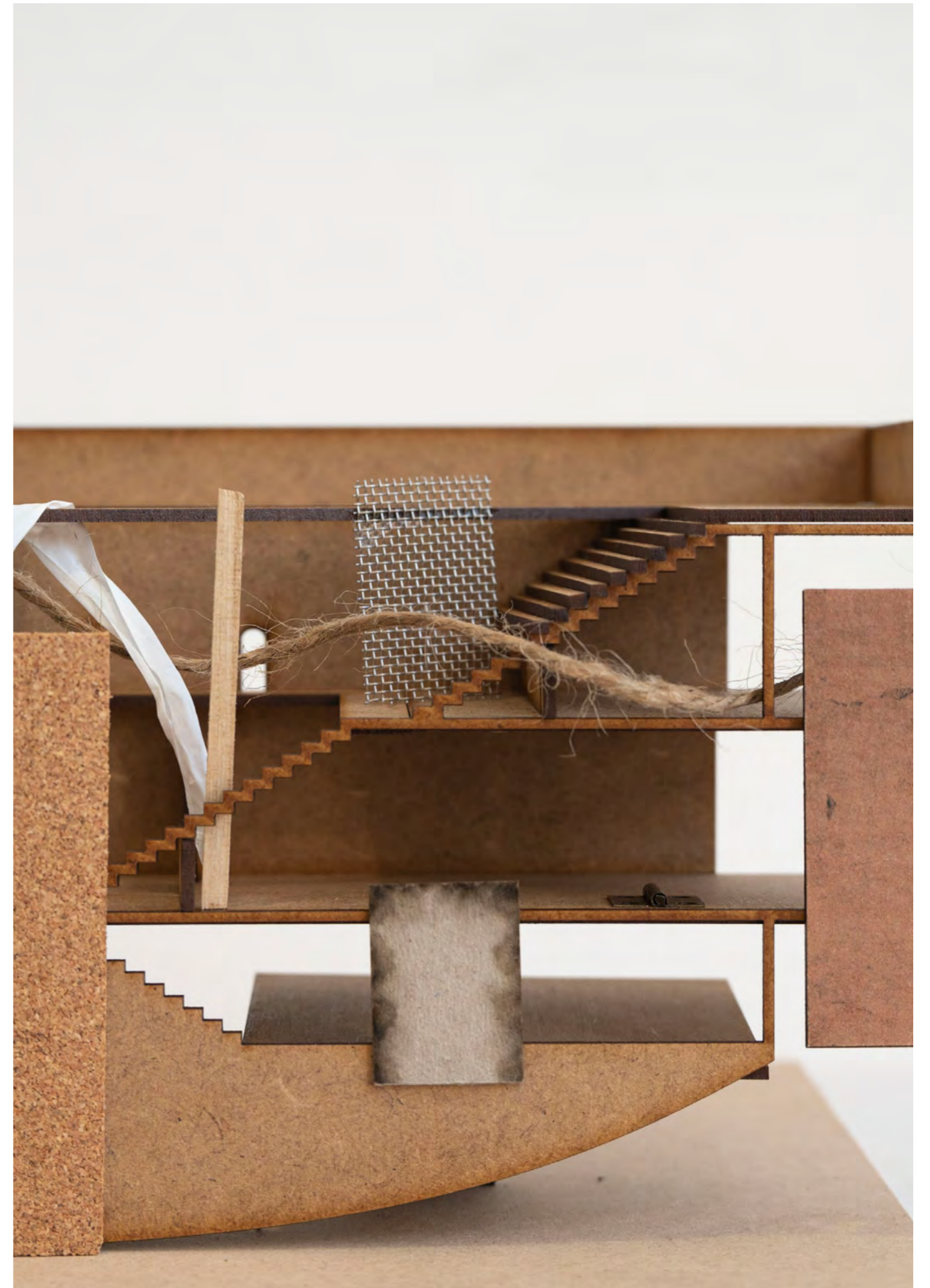



## TIDES OF RESILIENCE

SuperFUTURES

(Interior Design)

Short Film

RCA | MAR-JUN 2025

In December 2035 on Havelock Island in Andaman Islands, a woman haunted by her mother's gender-based oppression finds her fragile peace shattered by ensuing natural disasters. Three years later, as a resilient tsunami survivor, she joins a community initiative—the Habitation Shiscape Program—to rebuild sustainable lives. By blending traditional wisdom, art, and innovative technology, she challenges oppressive norms and spearheads efforts toward economic recovery and gender empowerment.



# Narrative Structure & Sequence Breakdown

## Title: Tides of Resilience

**Genre:** A post-disaster eco-drama

**Reference:** *Moana* (2016) in its exploration of cultural heritage and connection to the ocean, *Tides of Resilience* blends elements of survival, personal growth, and environmental stewardship.

## Synopsis

Under the starry night of Havelock Island in December 2035, with sounds of waves crashing on sand, protagonist strolls along the shore at night. While finding solace in nature's embrace, the memories of her mother's suffering—enduring relentless gender-based oppression and confinement to household duties—linger painfully in her mind.

The following day, her nightmares comes to life when a series of devastating earthquakes and tsunamis ravage the Andaman Islands, leaving widespread destruction and profound loss.

Three years later, now a resilient tsunami survivor, the protagonist enters a transformative new world through the Habitation Shipscape Program. Here, a diverse community of Andaman tribes and locals unites to rebuild sustainable, self-reliant lives. Through a unique blend of art, environmental, and traditional wisdom, they strive to revive their deep-rooted connections to the land and customs as they adapt to the challenges of climate resilience.

Determined to defy the oppressive patriarchal system and the constraints of familial expectations, the protagonist embarks on a journey of renewal and rebuilding. With the support of her community and innovative technology, she pioneers initiatives to preserve their history, ecology, and the spirit of non-human allies. By revitalising traditional handicrafts through digital literacy, virtual marketplaces, and entrepreneurial support, she forges new pathways for women to contribute to economic recovery and achieve gender empowerment.

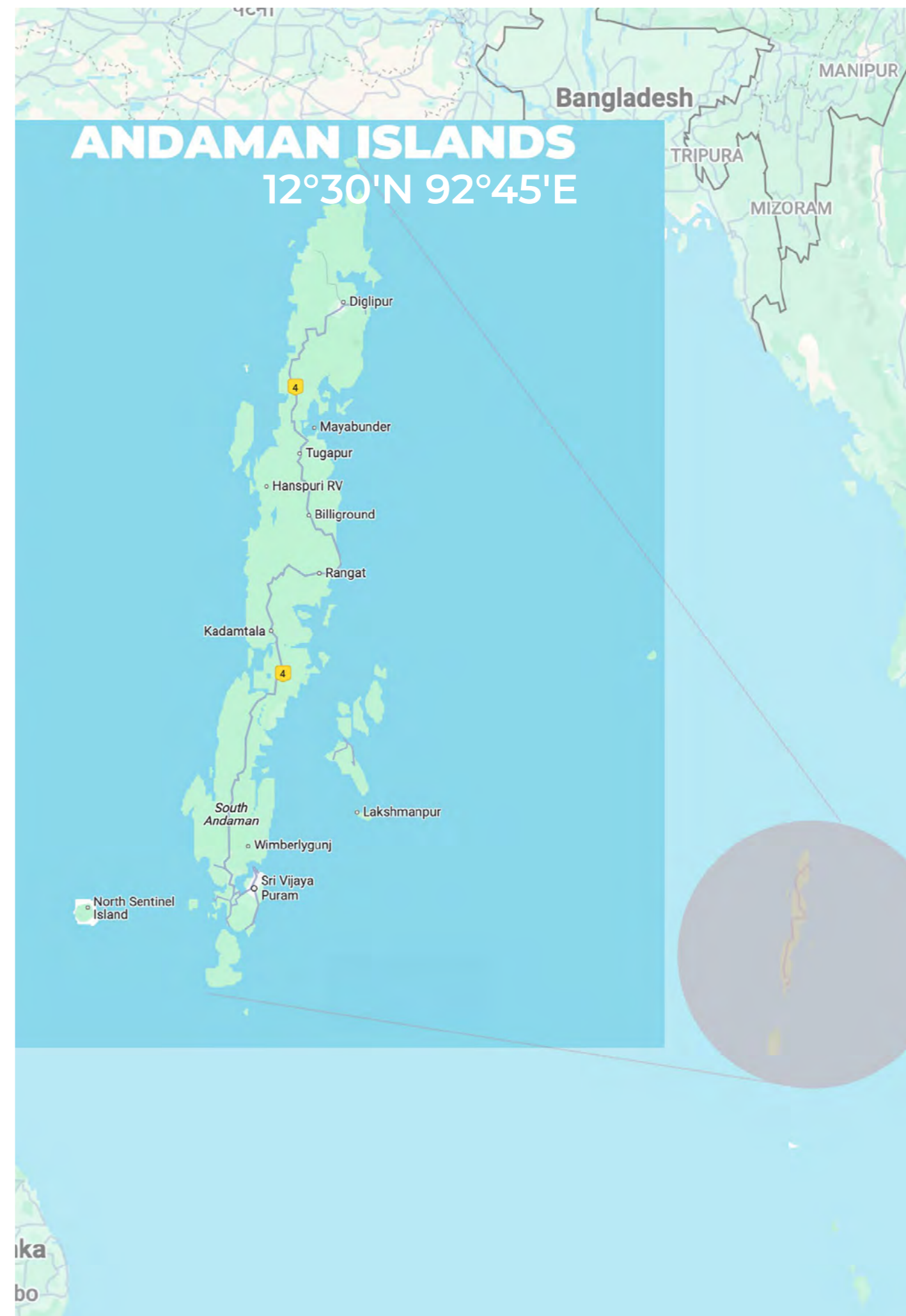

Scene: 1 Style: live action	Scene: 2 Style: live action	Scene: 2.5 Style:	Scene: 3 Style: Set	Scene: 4 Style: live action
		As she walks finding Solace in nature's embrace, the memories flash back.		
Description: A sweeping view of ocean under starry sky. The sound of waves softly crashing along the shore	Description: Protagonist, a solitary figure strolls the beach, her silhouette outlined against the night	Description:	Description: Memories of her mother's suffocating - enduring relentless gender based oppression & confinement to household duties	Description: As it haunts painfully in her mind, she encounters a mysterious object in the ocean
Sound: Wind, waves & birds in background	Sound: Wind, waves & birds in background	Sound:	Sound: working in kitchen & sad	Sound:

Through series of polaroid memory pictures of her life going through top shot with her hands also in it.

Scene: 10

Style: Set



Description: As the view expands while all structures come together, it shows overall context with the island which is submerged. Perhaps a timelapse of all parts of modular structure set come together. Generated by MidJourney AI



Scene: 11

Style: Set



Description: The scene goes through each sectional views of spaces within the structure to show how life has been adapted. Generated by MidJourney AI

Each spaces in sectional views before transformation of old techniques

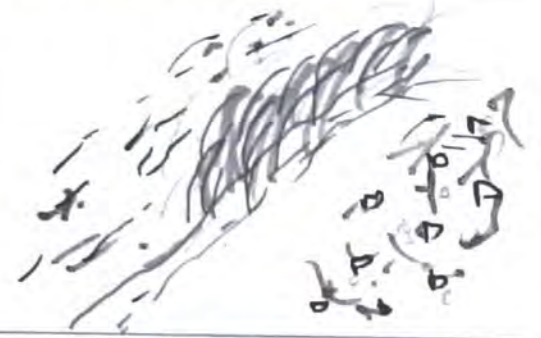
Scene: 5 Style: Set	Scene: 6 Style: live action overlay Set	Scene: 7 Style: live overlay set	Scene: 7.5 Style:	Scene: 8 Style: Set overlay
			Deeply connected to the coast, ocean, and unseen spirits, her tribe honors nature as both guide & guardian.	
Description: As she takes a closer look that mysterious object is a shipwreck drifting in the ocean Sound:	Description: She looks at with worried memories of ancient legends warnings. Sound:	Description: A sight that evoked the memories of legends ancient warnings shared by the island's elders, who believed such omens foretold impending storms or disasters Sound:	Description: Sound:	Description: This tragic peace shall end the following day when a series of devastating earthquakes & tsunami ravage island leaving widespread destruction & profound loss Sound: profound loss

Through series of visuals (stills, short videos) with screen black out.

Scene: 12

Style: Live action



Description: The resilient tsunami survivor, the protagonist - a close up scene inside their dwelling having deep conversation with her dad. She explains her desires to defy patriarchal norms and pursue innovative cultural revival. Her dad reacts in concern and resistance way. Generated by MidJourney AI



Dialogue conversation in Hindi written on page X inside a dark room

Scene: 13

Style: Live action

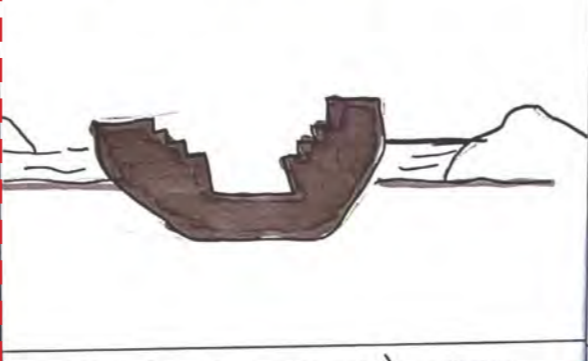
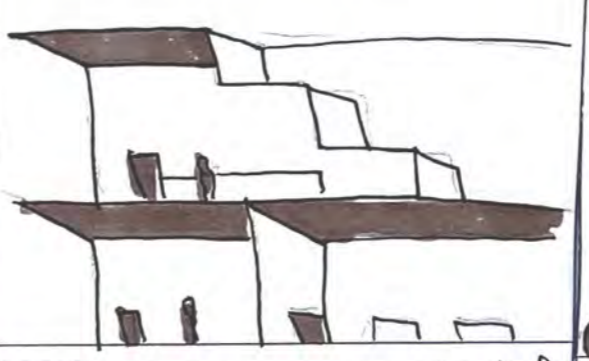

Description: As she looks through pile of waste materials from ship wreck for inspiration the scene is top shot. Generated by MidJourney AI

Scene: 8.5 Style:	Scene: 9 Style: Set	Scene: 10 Style: Set	Scene: 11 Style: Set	Scene: 12 Style: Live action
3 years later				
Description:	Description: people working on building up their lives by uniting with tribes & workers as sustainable & self-reliant lives	Description: As view expands while all structures come together, it shows overall context with the island which is submerged	Description: Through a unique blend of art, environmental & traditional wisdom, they strive to revive their deep-rooted connections to the land & customs as they adapt to the challenges	Description: The resilient tsunami survivors, the protagonist - a close up scene inside their dwelling having conversation with her dad.
Sound:	Sound:	Sound:	Sound: of climate resilience.	Sound:

Scene: 14

Style: Live action



Description: She finds lots of waste fishnet and other scraps which gives her idea to generate new form of craft using these discarded material as an intention for not to end up in sea. Generated by MidJourney AI

Scene: 15

Style: Live action



Description: The scene shows calling out for help in joining this movement of change through putting out poster and arranging community meeting to use existing materials and traditional techniques, emphasizing the need to preserve their methods and culture through adaptation. Generated by MidJourney AI

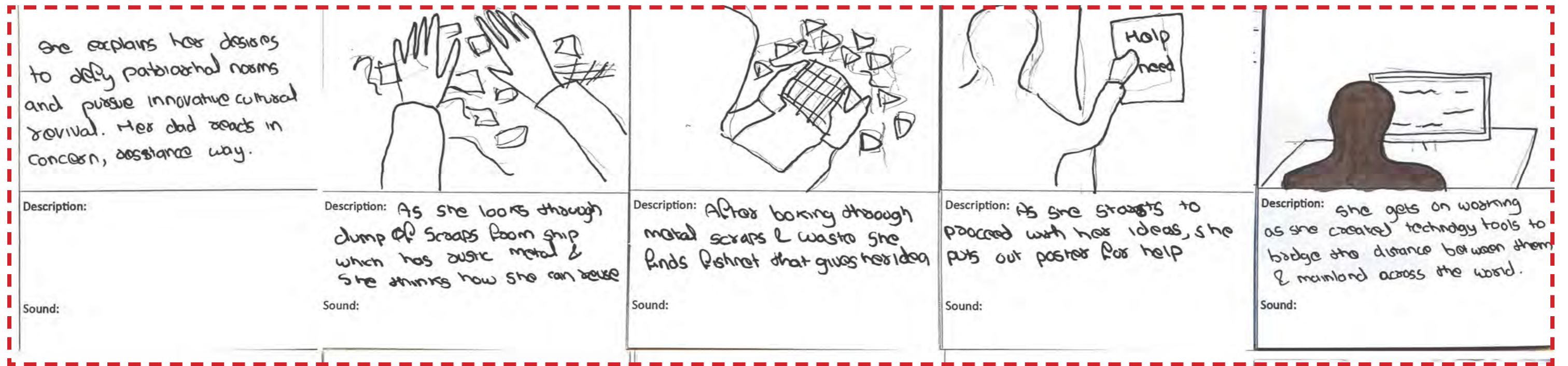

Scene: 16

Style: Live action



Description: She gets on working as she creates technology tools to bridge the distance between them & mainland across the world to spread their identity & story of continuity & resilience. Generated by MidJourney AI

Scene: 17

Style: Desktop documentary

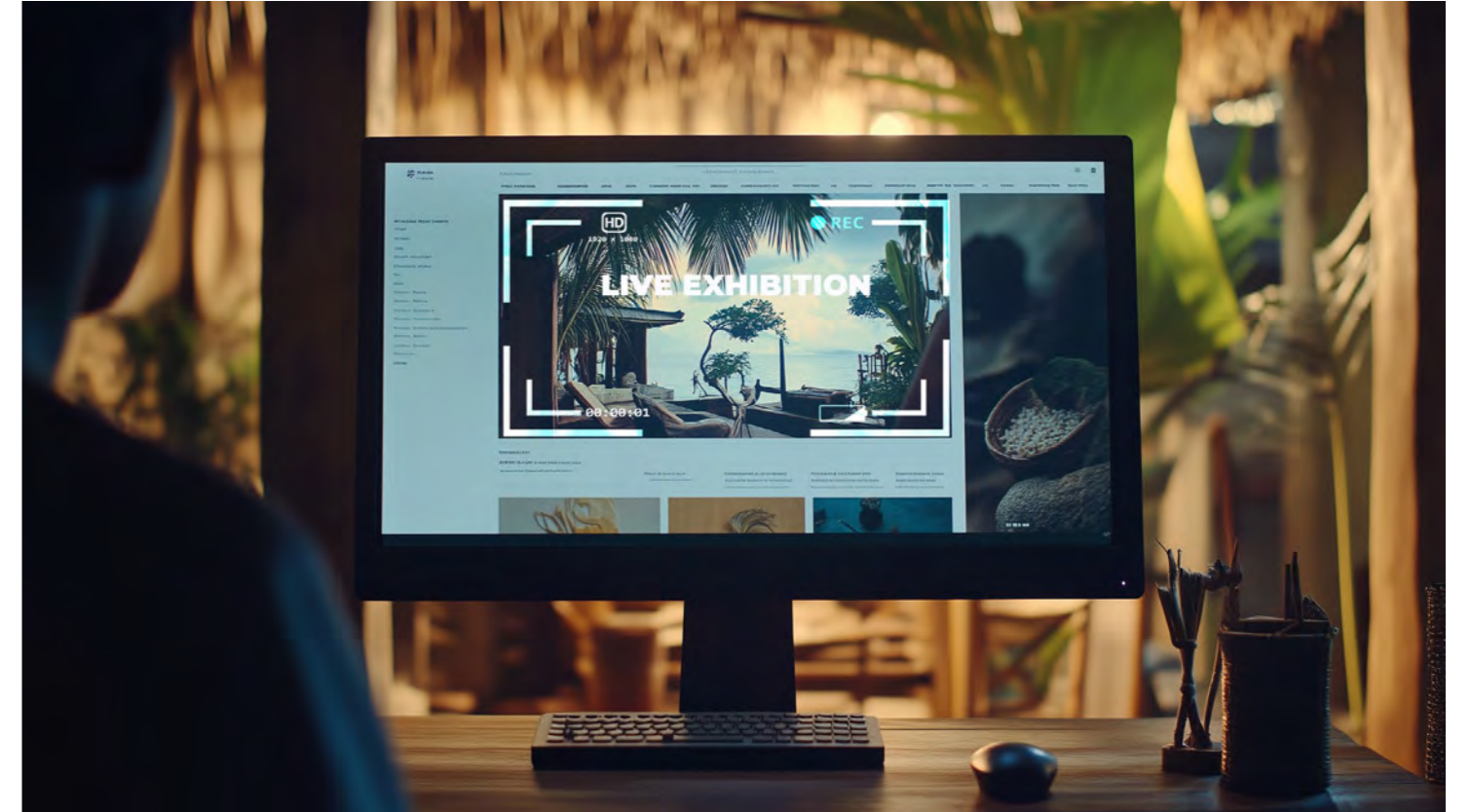

Description: The screen shows live streaming of the virtual exhibition website in collaboration with crafts week London. Generated by MidJourney AI

Scene: Style:	Scene: Style:	Scene: 19 Style: Set	Scene: 20 Style: Set
VIRTUAL EXHIBITION	CATALOG		
Description:	Description:	Description: The scene shifts from quilt image from lodges to workshop whose making of quilt is happening	Description: Tsunami survivor's story quilt, showing traditional patterns made contemporary context depicting the story
Sound:	Sound:	Sound:	Sound:

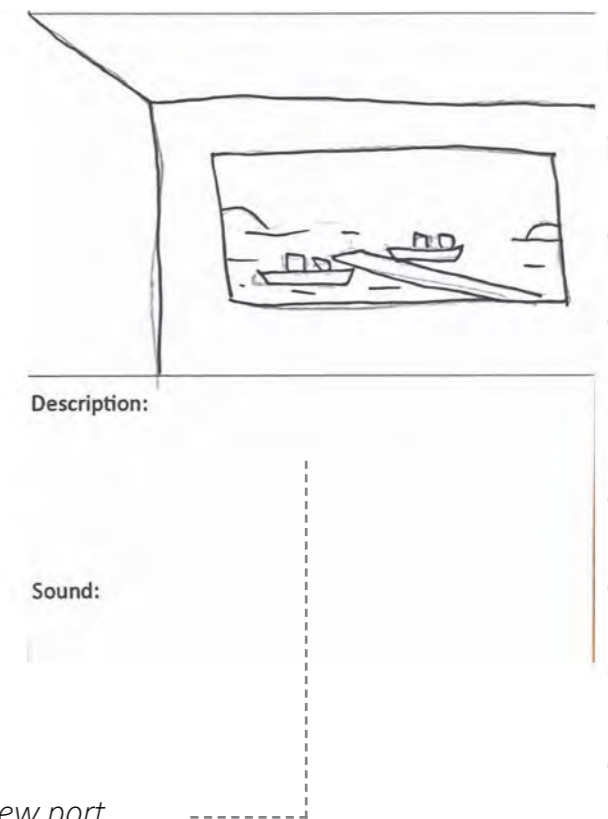

Ending scene showing a new port with ships coming in for business and researchers to develop their concept

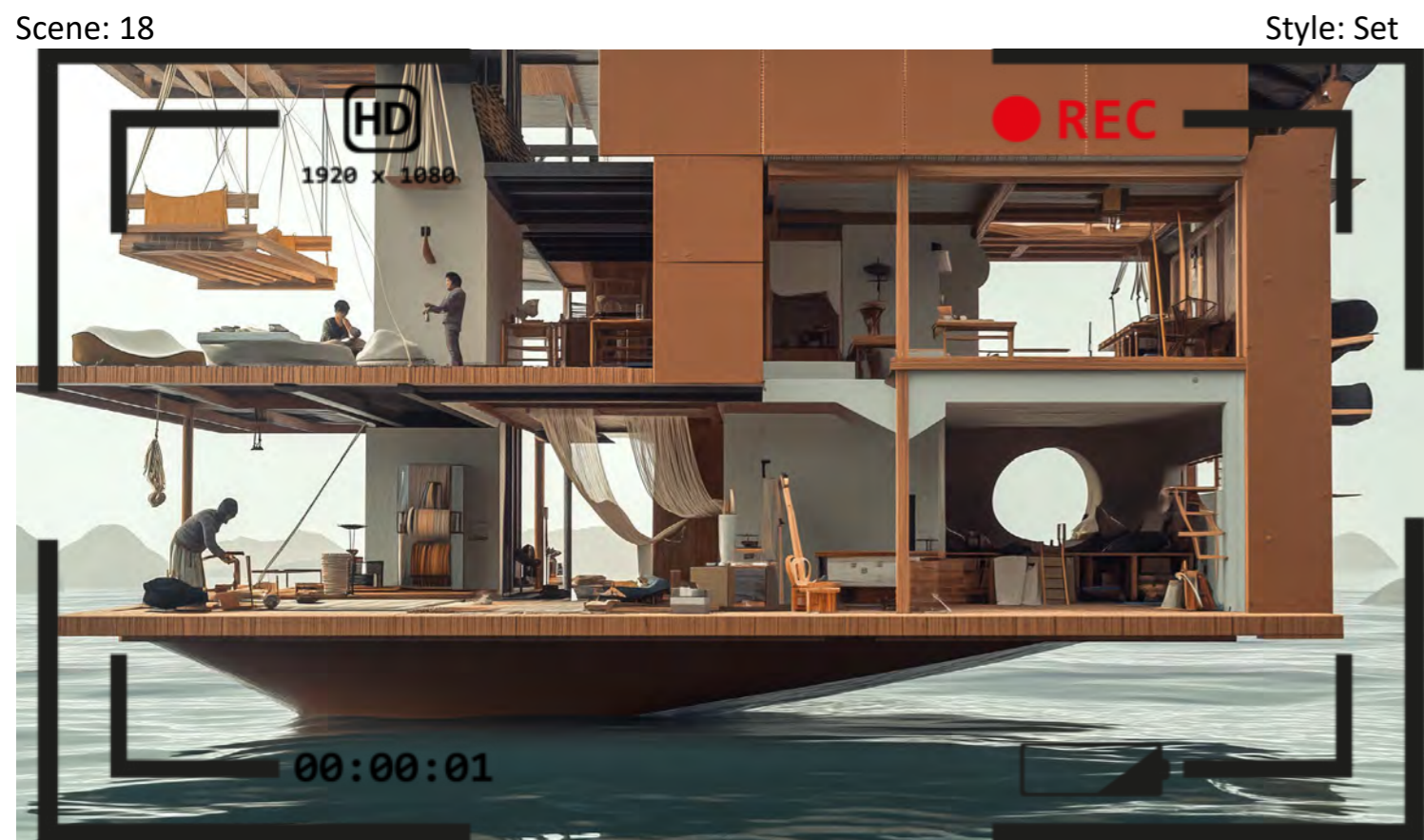

Description: The scene shifts from calling out for help to workshop where making of textiles is happening with designer to look them from a design perspective with the aim of developing new patterns, encouraging innovation in material usage, and refining craft work skills. Generated by MidJourney AI



Description: Tsunami survivor's story tapestry, showing traditional patterns with contemporary touch in the new context depicting their story. Generated by MidJourney AI

# Tides of Resilience: (voice over) Narrative Script

Written by Vaishali Odedra

I remember that winter morning of December 12th 2035, so clearly—as I walked along the shore, searching for solace, unaware that this quiet journey would forever alter the course of my life. As I walked, memories washed over me. I saw my mother—strong, silent, and full of dreams—confined to a life of duty. Day after day, she served in silence, while my father sat waiting; his restless glare spoke volumes about a world where her aspirations carried no weight.

Then came the morning when nature's fury unleashed itself—a day marked by devastating earthquakes and a relentless tsunami. In the aftermath, darkness and loss became all too real as destruction swept away everything we once knew.

Three years on, our island has changed forever. Rising seas swallowed the land—an echo of humanity's reckless pursuit of development and tourism. Yet, from this loss emerged a new beginning.

In the midst of this rebirth, I witnessed the resilience of our people—especially our women. Traces of old lives emerged in every corner—artisans and craftspeople reviving traditional skills to rebuild homes and communities such as partitions made out of discarded fishnet or bamboo mats weaved with age-old techniques and communal farms sprouting atop the ship's decks. These gardens supply our food and raw materials for everyday life, creating a local economy. Even the ship's central structure was inspired from India's ancient step-wells —carved like a perfect geometric maze, symmetrically descending to a central well that once served as water source, gathering place, and sacred rite. This blend of heritage design and sustainable practice embodies both our ingenuity and our commitment to a self-reliant future. I found myself at a crossroads. In a quiet room, I sat with my father, the weight of our shared history and hopes hanging in the air. I spoke of my desire to reshape our economy after cruise ship ban—once dependent solely on tourism—by blending contemporary design through innovations with our tradition techniques that define us. My father, ever the guardian of our customs, worried that rapid change might disturb the delicate balance between our identity and ancestral ways. Yet, in his reflective silence, I sensed his understanding: adapting did not mean abandoning our roots.

In the debris of the wreckage, I discovered hope. Among rusted metal scraps and tangled fishnets, a vision spark ignited—weaving the current future to the crafts. With renewed passion, I reached out to our community, posting a call for help—a rallying cry to blend the old with the new, to honor our heritage while embracing sustainable innovation.

Later, in the soft glow of my computer screen, I curated a digital exhibition & shop for LondonCraftsWeek—a catalog showcasing innovative crafts born from reclaimed metal, each piece a fusion of our storied past and a promising future.

Here, shipscape as our new home & life unfolds seamlessly—living, working, learning, and leisure all within a few minutes' walk. Top-deck farms, cow and chicken sheds, and shared workshops ensure that every need—water, food, healthcare, education—is met within our community. Crucially, our women can access resources and opportunities without forsaking home or family. Digital literacy programs, entrepreneurial support, and partnerships with designers and innovators have become woven into our daily lives. Workshops hum with creativity, each thread and metal shard a mark of our resilience and ingenuity. Remnants of a once-grand cruise ship have been repurposed, forming the very foundation of our new home—a living bridge connecting our past with a future we are determined to build.

Now, as I gaze out over a new port where ships and dreams converge, I see more than just structures and commerce—I see the heartbeat of a community, our women and it's economy reborn. We have learned that blending tradition with innovation is not a betrayal of our past but a celebration of it, a way to honor the legacy of our ancestors while stepping confidently into a future of sustainable promise.

I am Rebecca Charles, and this is my story—a journey from solitude on a beach to the forging of a new destiny. In blending the old with the new, we have not only rebuilt our community but also rekindled the spirit of our ancestors. Through loss, transformation, and the courage to embrace change & empower our women. In every wave that crashes, every rusted scrap reborn, and every heartbeat of this land, our heritage endures, guiding us toward a dawn filled with hope and renewal.

# Character Arcs & Thematic Exploration



**Saw Charles**

## Background:

- Raised in a strict, orthodox household with little modern exposure.
- Life molded by ancestral customs of nature preservation.
- Instilled traditional values in his daughter, expecting her to follow his path.

## Relationships:

- Complex bond with his daughter—deep care mixed with frustration over her progressive ideas.
- Respected by traditional peers but at odds with modern influences.

## Age & Occupation:

- In his early 50s; a dedicated forester committed to nature and traditional ways.

## Goals & Motivations:

- Preserve time-honored cultural practices.
- Protect his daughter from modern influences.
- Maintain community stability amid change.

## Character Arc:

- Begins as a rigid traditionalist.
- Confronts inner conflict as his daughter's progress challenges him.
- Learns to blend tradition with change and support her vision.

## Age & Occupation:

- 26-year-old taught artist blending traditional crafts with modern techniques.
- Skilled in digital marketing and journalism.

## Goals & Motivations:

- Determined to elevate and preserve her community's identity by integrating tradition with modern ideas.
- Faces societal pressure and conventional expectations.

## Character Arc:

- Begins burdened by fear and societal pressures.
- Transforms into a confident leader who revitalizes her community's cultural identity.



**Rebecca Charles**

## Background:

- Raised in Webi Village, Andaman Islands, as a proud member of the Karen community.
- Only child in a traditional household: father (forester) instilled respect for nature; mother (craftswoman) inspired creativity.
- Learned the value of hard work and a desire to break free from traditional limitations.

## Relationships:

- Complex dynamic with her father, whose traditional views challenge and motivate her.
- Supported by community mentors and local artisans.

# Poster For Call To Help

Scene: 15

Style: Live action



Description: The scene shows calling out for help in joining this movement of change through putting out poster and arranging community meeting to use existing materials and traditional techniques, emphasizing the need to preserve their methods and culture through adaptation.



**Call for Help—**  
*an urgent rallying cry for a re-generative future.*

*Revive the Past,  
Innovate the Future  
Sustain Heritage  
Embrace Change*

**Community Meeting: "Revive & Innovate"**  
When: Saturday, May 10, 2030, 3–6 PM  
Where: Andaman Cultural Center, Port Road

Who: Local Artisans, Environmental Advocates & Creative Thinkers  
Join us to exchange ideas on repurposing traditional crafts for a sustainable future.

For details, call: +91 12345 67890 or ask at the Community Center.



## Props as Storytellers



A symbolic prop representing the Roots Exchange Pass by Resilient Roots Collective organization, a women-led climate initiative enabling trade, skills exchange, and sustainability rewards through an NFC-enabled pass. It embodies a cashless, circular economy where reclaimed materials, community labor, and green practices are fairly valued—amplifying women’s agency in climate-affected regions.



A visual memory archive from the protagonist’s childhood, revealing her mother’s silent resilience and sowing the seeds of her future voice and action.



# Resilient Roots Collective – Digital Front

A fictional website designed as part of the film's world-building, this digital platform showcases a virtual exhibition in collaboration with London Craft Week and hosts an e-commerce catalog of sustainable crafts. ([Click on image below or on this text for link](#))

Resilient Roots Collective

[Shop All](#)

[About](#)

[Contact](#)

[Events](#)

## THREADS OF HERITAGE, HANDS OF CHANGE



Resilient  
Roots Collective

Where Women Weave Identity,  
Memory, and Power

In floating studios built from reclaimed ships, Andaman's artisans transform craft into a living archive—preserving tradition while shaping futures through creativity and entrepreneurship.

[Shop Now](#)

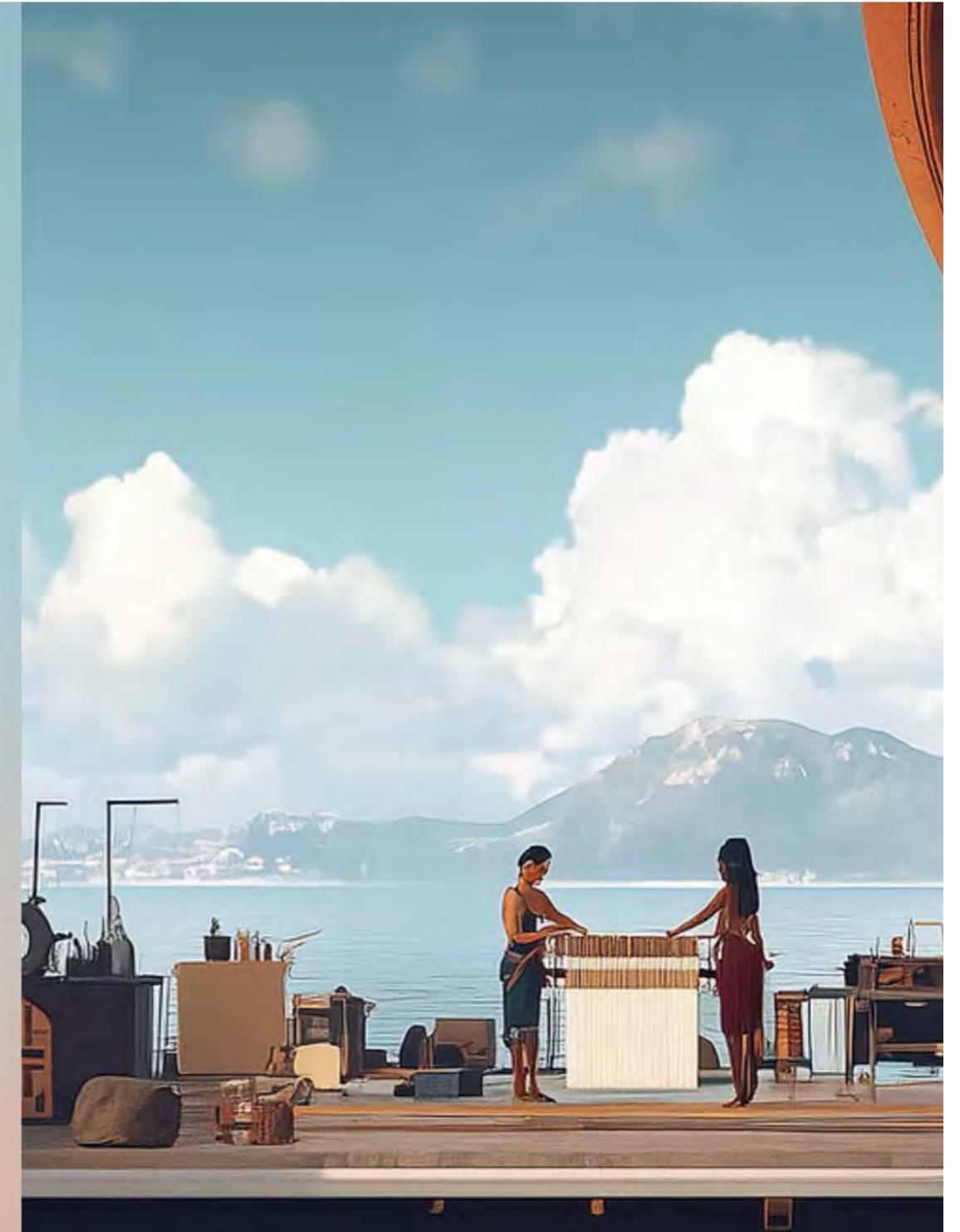

# Hybrid Craft: Film Techniques & Visual Language

The film combines AI-generated imagery, such as future tsunami scenes in Kling created using Midjourney along with that 1:50 scale physical models and live-action close-ups. This blend of handcrafted techniques and emerging technologies mirrors the film's core message: integrating tradition with innovation to envision futures. While the visuals are color-graded in warm orange tones, reinforcing the project's theme enthusiasm, energy, warmth, and creativity.

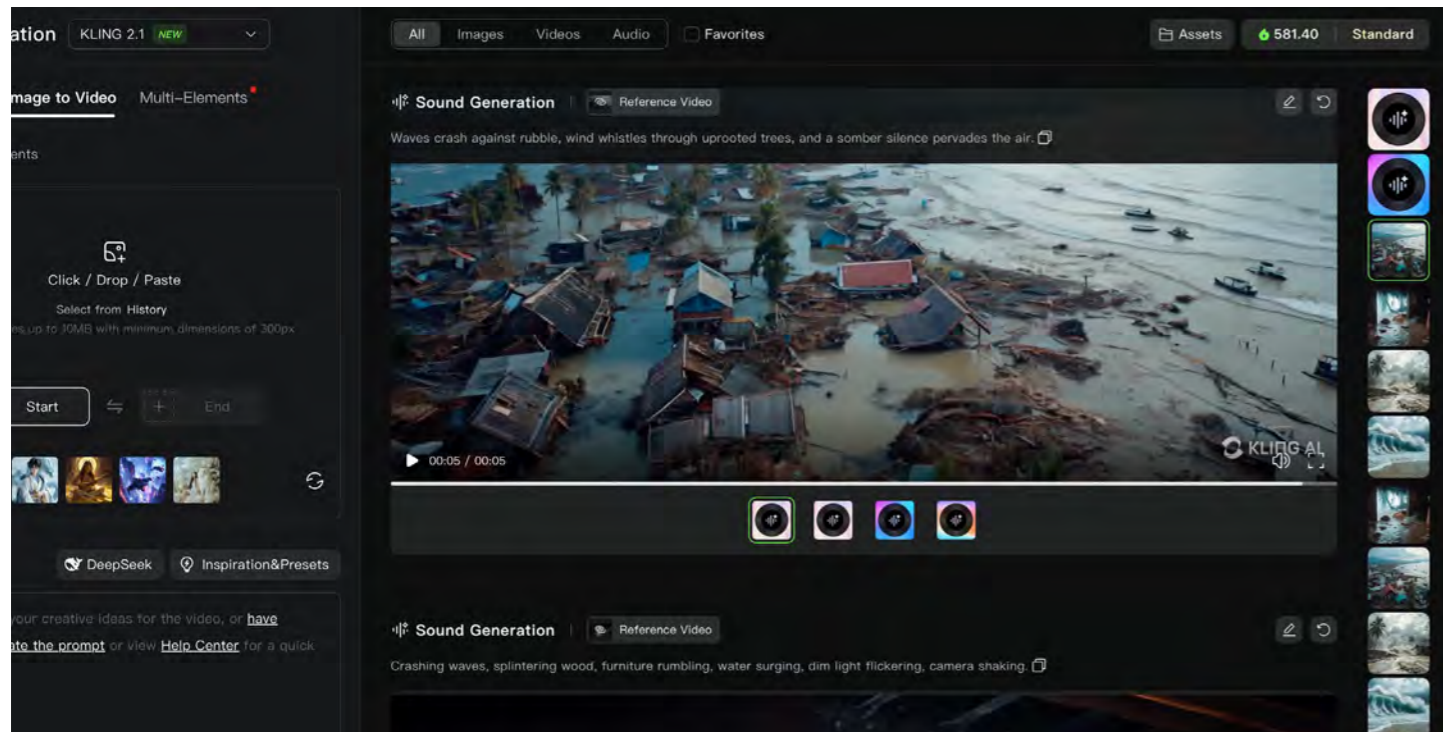

# Production Capture: Visual & Sound

From test collages blending set and backdrop to final wide and close-up shots of the physical model, the visual style was meticulously crafted for cinematic realism. Voice-over narrative recording in the sound studio adds depth and intimacy, bringing the protagonist's journey and the film's emotional core to life.



## Contextual Grounding: Shoot Locations as Stand-ins

Filming took place in carefully selected locations, Portugal's coastline was used to mirror the beaches of Andaman, while Kew Gardens offered tropical vegetation, thatched roofs, and wooden interiors resembling traditional island homes.

These real-world stand-ins were chosen to authentically evoke the environmental and cultural textures of the Andaman Islands.



Sesimbra, Portugal  
38.4442° N, 9.1015° W



Kew gardens, London  
51.4787° N, 0.2956° W



# The Living Model: Spaces in Dialogue

Handcrafted from MDF, bamboo, fabric, printed paper, metal mesh, and fishnet, the physical model maps the interrelation of communal, agricultural, and living zones.



# TIDES OF RESILIENCE

*an urgent rallying cry for a  
re-generative future*  
- a film by Vaishali Odedra

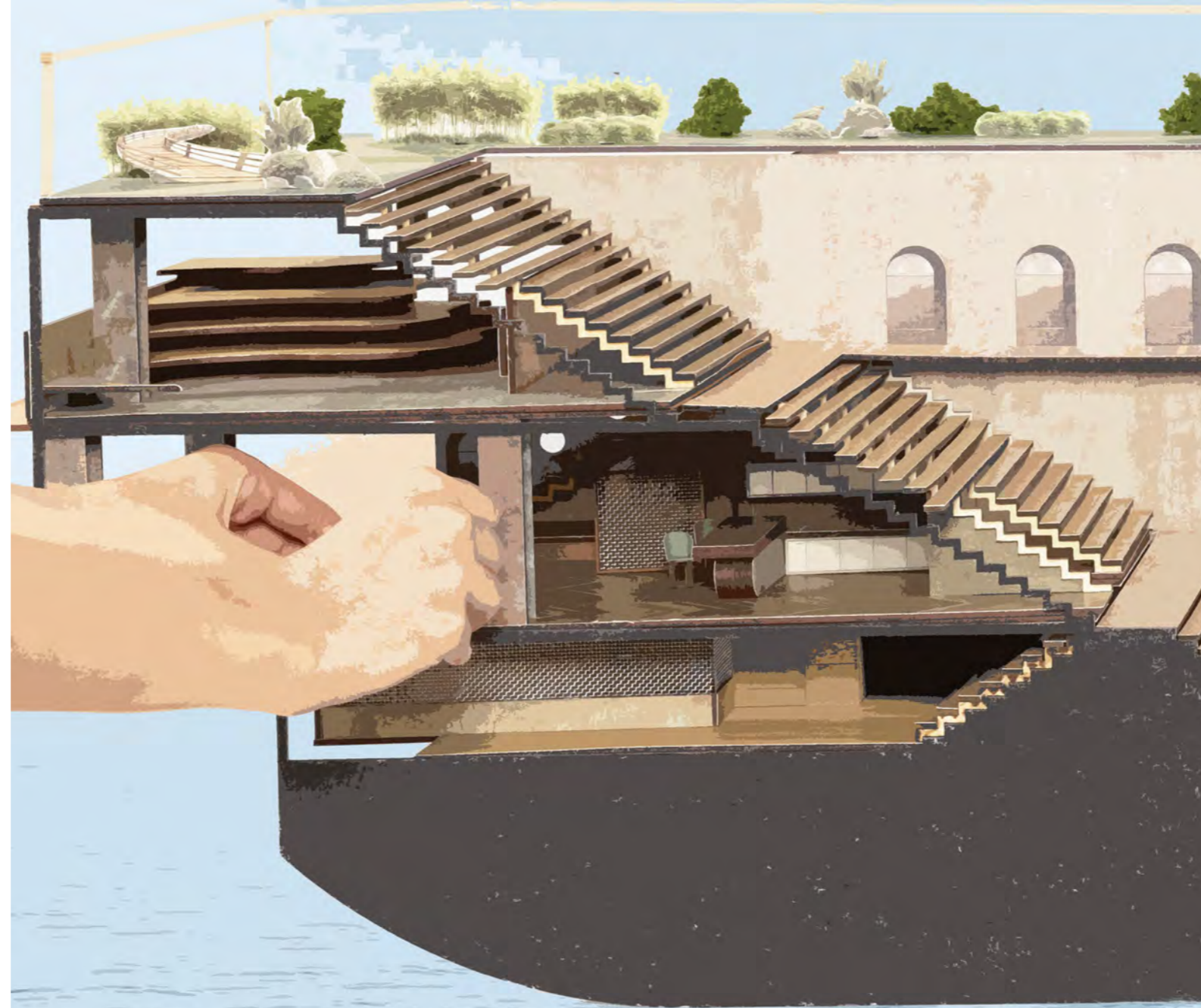

**COMING SUMMER 2025**

STARRING: Vaishali Odedra • Sham Salim  
WRITTEN & DIRECTED BY: Vaishali Odedra  
#TidesOfResilience #ClimateResilience #AndamanRising #WomenInFilm



[\(Click on this text or on play icon below for film link\)](#)



SI  
IT  
OF  
8  
Y  
9  
2  
4  
E  
S  
I  
00  
1  
2  
3  
4  
5  
6  
7  
8  
9  
10  
11  
12



Learning centre/Auditorium space for women to develop entrepreneurial skills and platforms for economic empowerment.



Left section where with spaces learning centre in top, middle are living quarters and below are chicken sheds. Adjences are such living quarters are accesible to both the spaces easily.



Living quarters on left section of structure showing various elements such as metal and fishnet along with local materials such as wooden flooring and bamboo weave cupboard front.

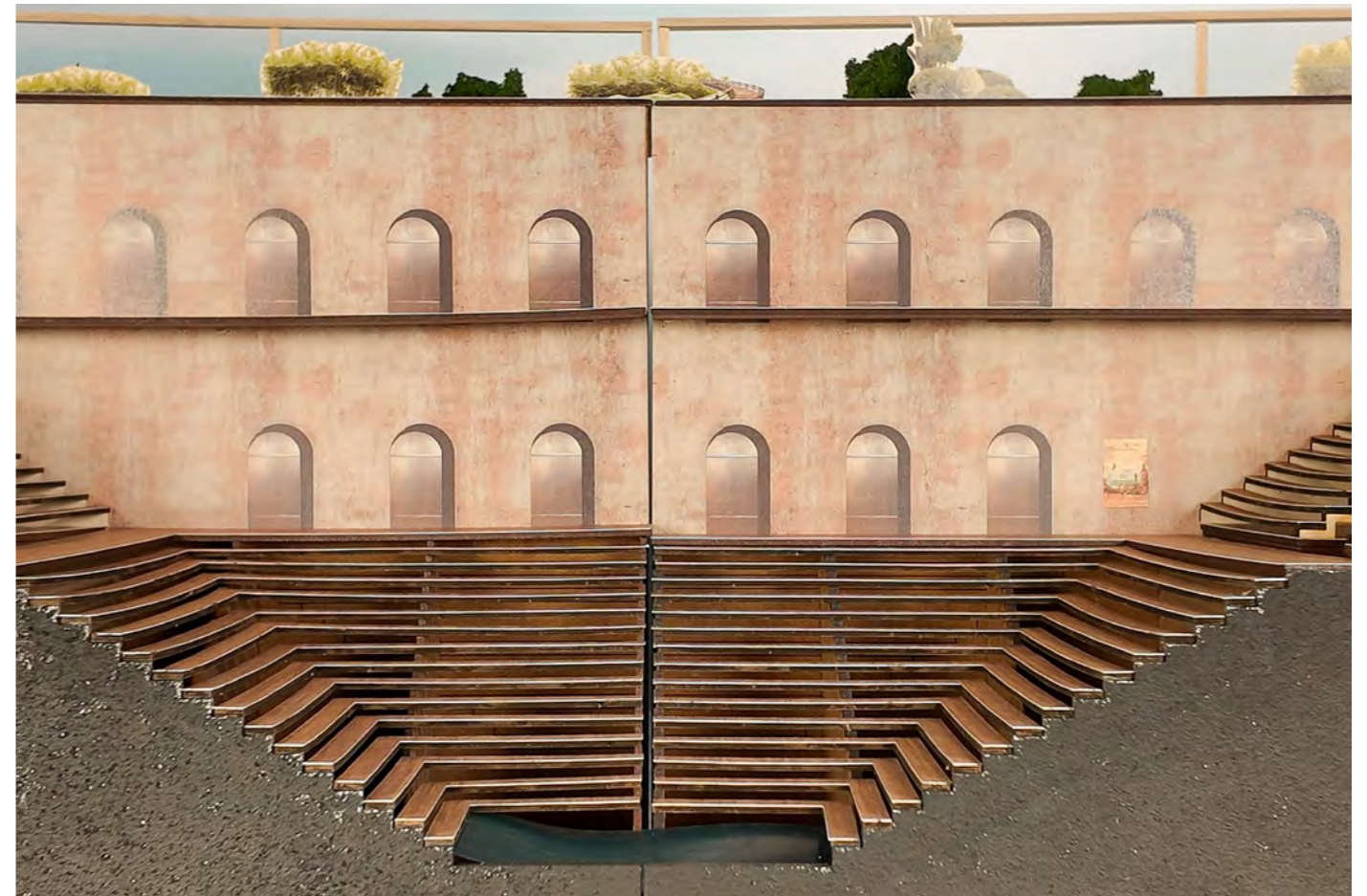

A tiered central stepwell, inspired by traditional Indian typology, acts as a sacred communal (cascading platforms) verandah which blending ritual, gathering, and shared cultural space.



Workshop and collaborative space where designers and artisans make art and products



Right section where with spaces workshops in top, middle are living quarters and below are cow sheds. Adjences are such living quarters are accesible to both the spaces easily.



Living quarters on right section of structure showing various elements such as fishnet along with local materials such as wooden flooring and bamboo weave cupboard front.

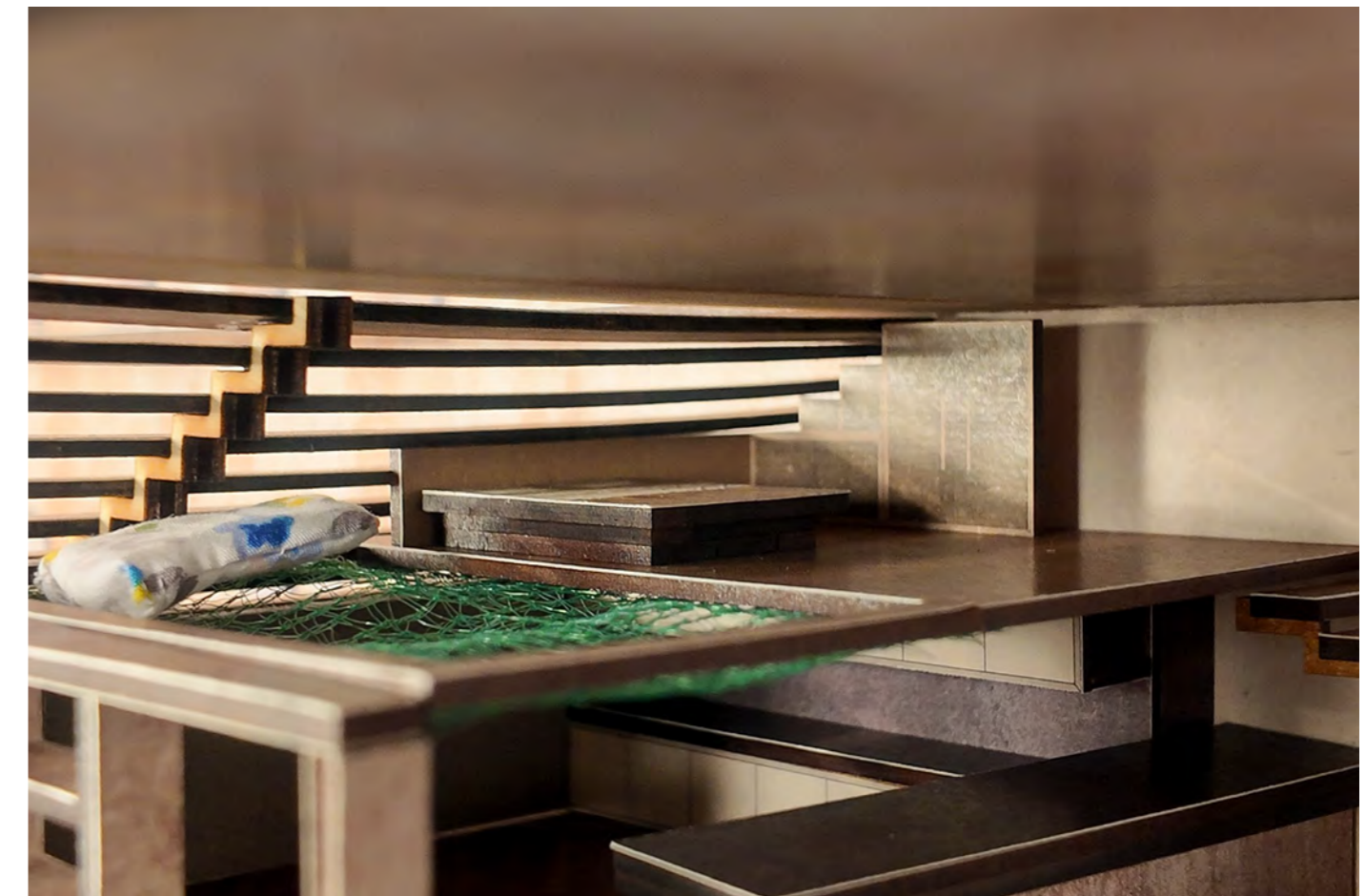

Living quarters on right section of structure showing various elements such as fishnet along with local materials such as wooden flooring and bamboo weave cupboard front.

# 1. Memory Mosaic: Postcard Sequence

A close-up of AI-generated childhood enlarged postcards laid over a traditional sari evokes the mother's silent oppression and its cultural roots as the catalyst for the protagonist's future agency.

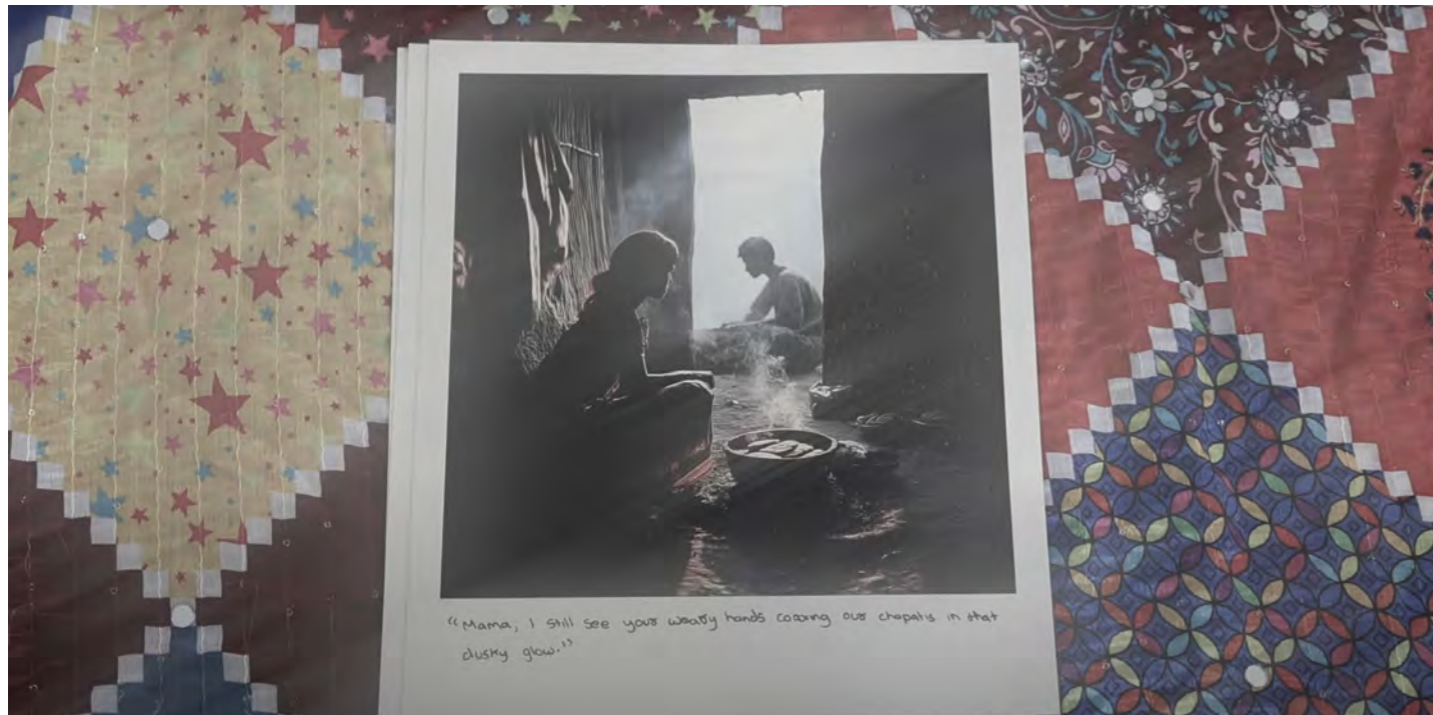

# 3. Weaving Resilience

Close-up of the protagonist at her back-strap loom on a wooden deck, surrounded by her design sketches, Roots Exchange Pass, and fruit basket—merging ancestral craft, designer insight, and community trade.



# 2. Spiral Harvest Descent

A top-down shot of the protagonist descending a rusted spiral staircase laden with fresh produce, highlighting the seamless integration of shipscape structure and garden.



# 4. Portside Workshop Perspective

Through the workshop's rusted window frame, artisans weave traditional crafts on the shipscape model as the new port—driven by e-commerce—bustles beyond, underscoring the irony of future progress.

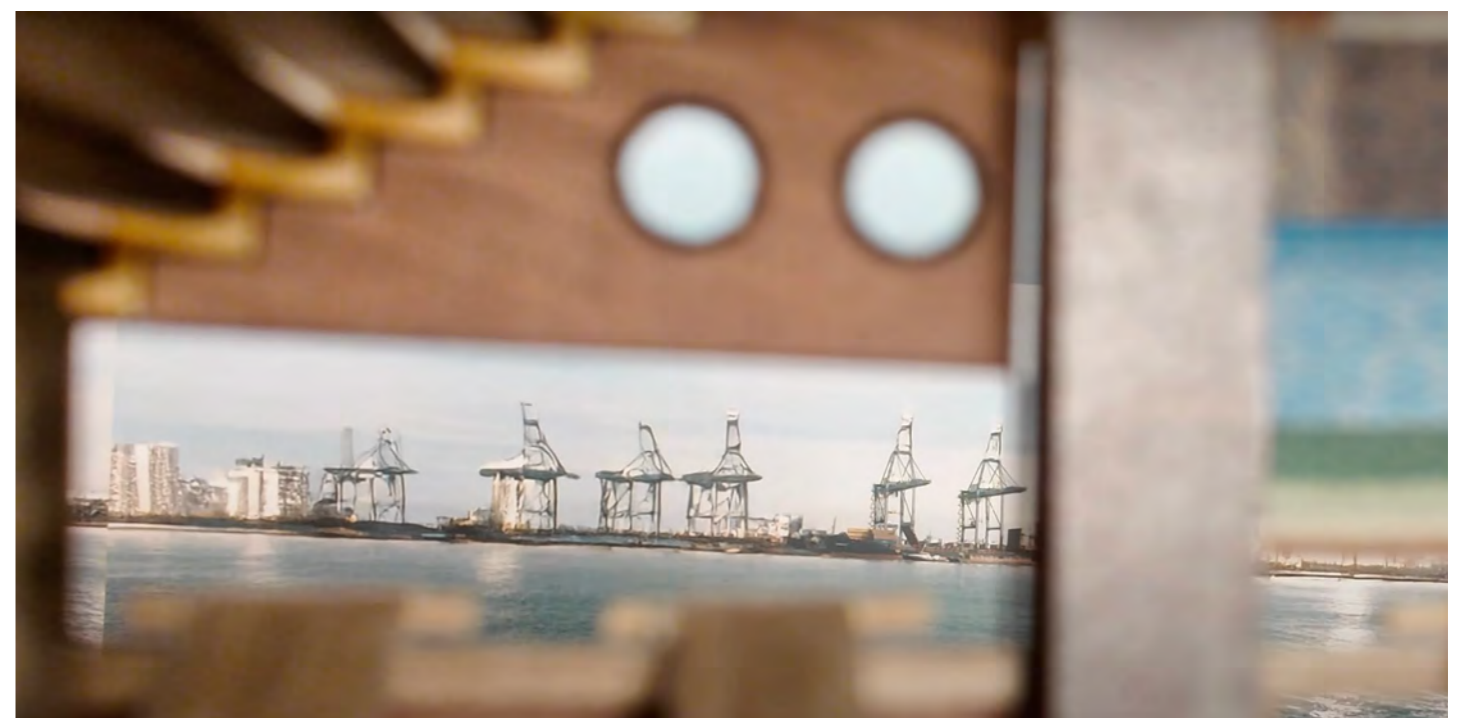

SI  
IT  
OF  
8  
9  
2  
4  
E  
5  
I  
00  
1  
2  
3  
4  
5  
6  
7  
8  
9  
10  
11  
12

# Vaishali Odedra

10044363@network.rca.ac.uk  
vaishaliodedra01@gmail.com

