

16 Blossom ST.

LONDON MATERIAL CENTRE

Historical material library & storage

Some slides contain animated GIFs to aid understanding.
For the best experience, please click the link below
to view the presentation on Google Slides.

[HERE](#)

SHINJAE KIM

Background

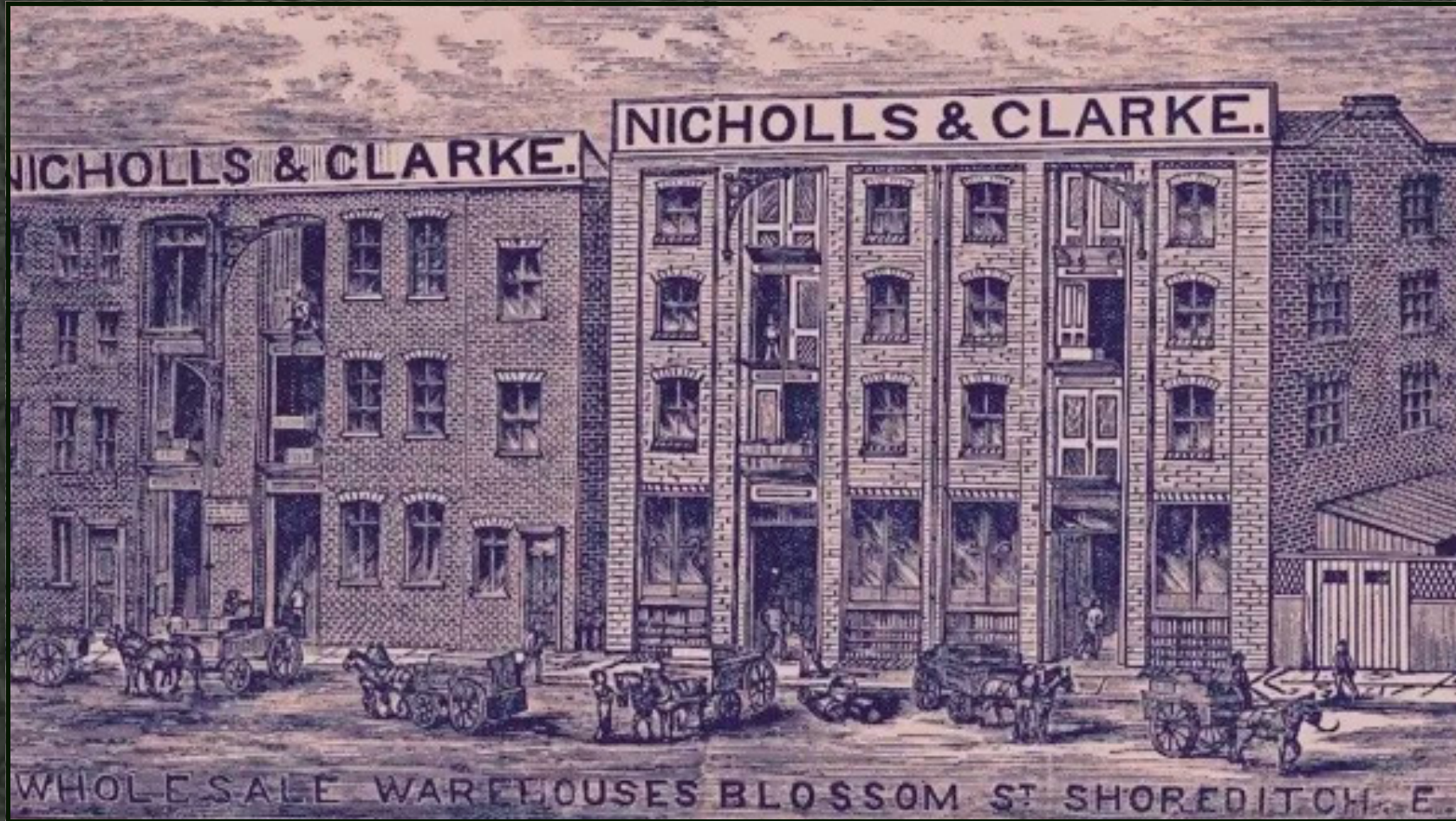
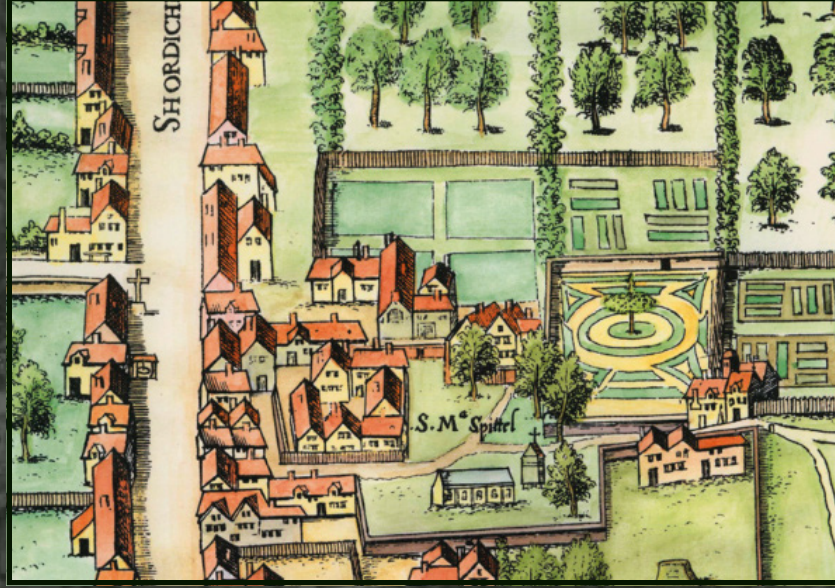

SPITALFIELD

LONDON BRIDGE

Find the interesting spots

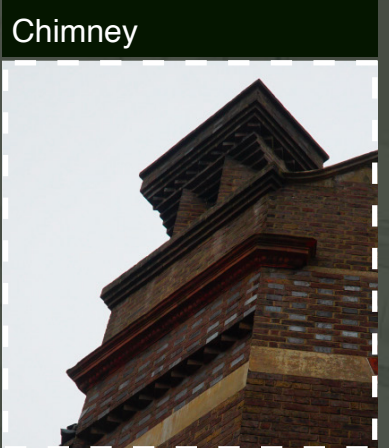
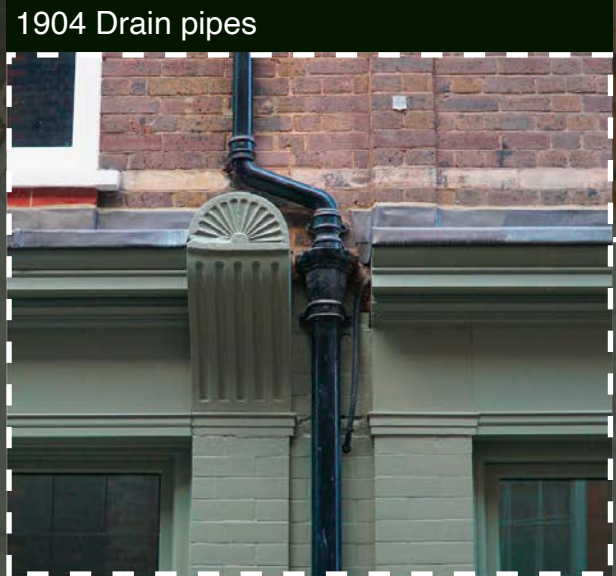
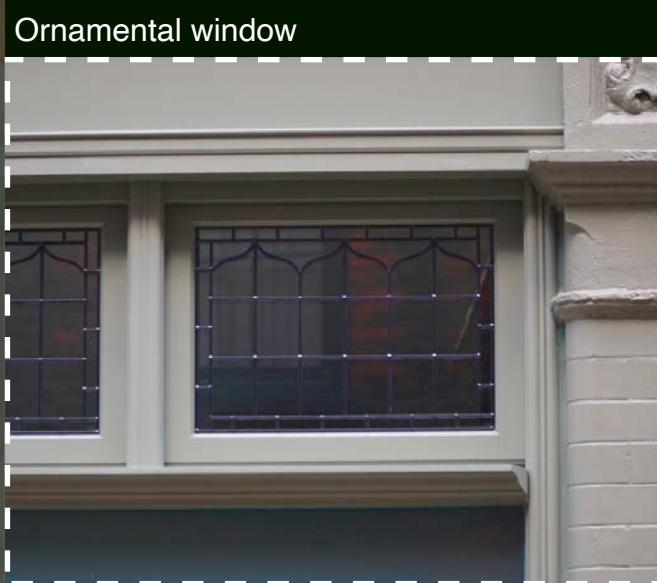
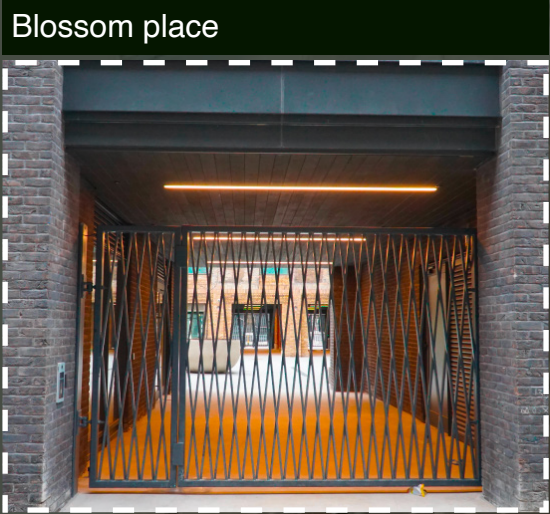

Maquettes



Totem



Pipes:
Where two different eras connect



Thesis question

How can designers ensure the coexistence of traditional materials and designs, such as ornaments, with modern materials, preserving them as a heritage in contemporary design?



Pipe hunting

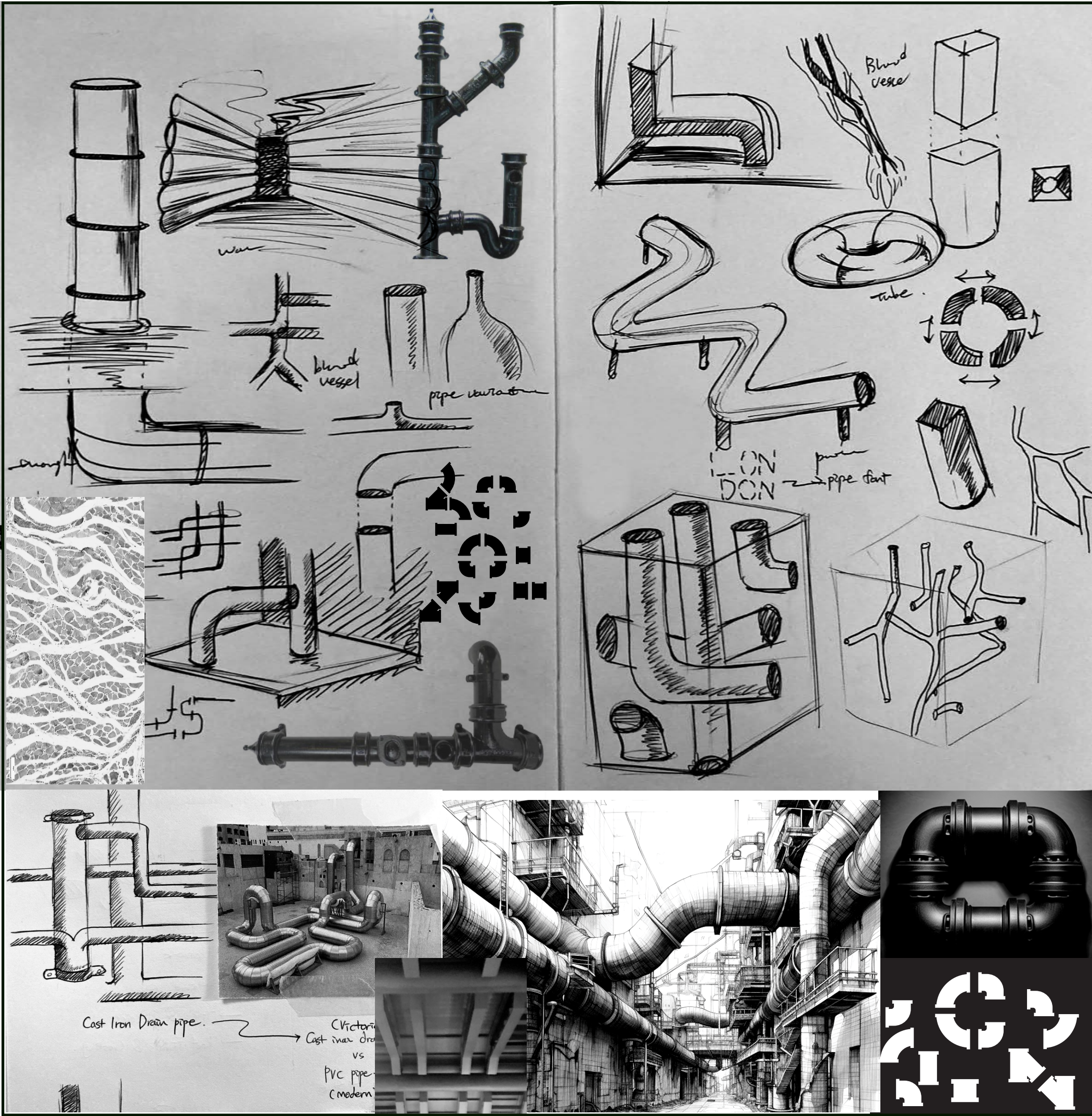

Why pipes from different eras are connectable



David Ghilchik (1892~1972)

CASTING

: Continuity through standardization

The country that standardized brick dimensions is UK. In the 19th century, England developed standardized size-standard shapes for bricks, which were later adopted and modified by other countries.

Also, The country that first established the standard specifications for drainage pipes is the UK. The UK played a significant role in developing and improving water supply and drainage systems over thousands of years, contributing to the standardization of drainage pipes.

Moulding study

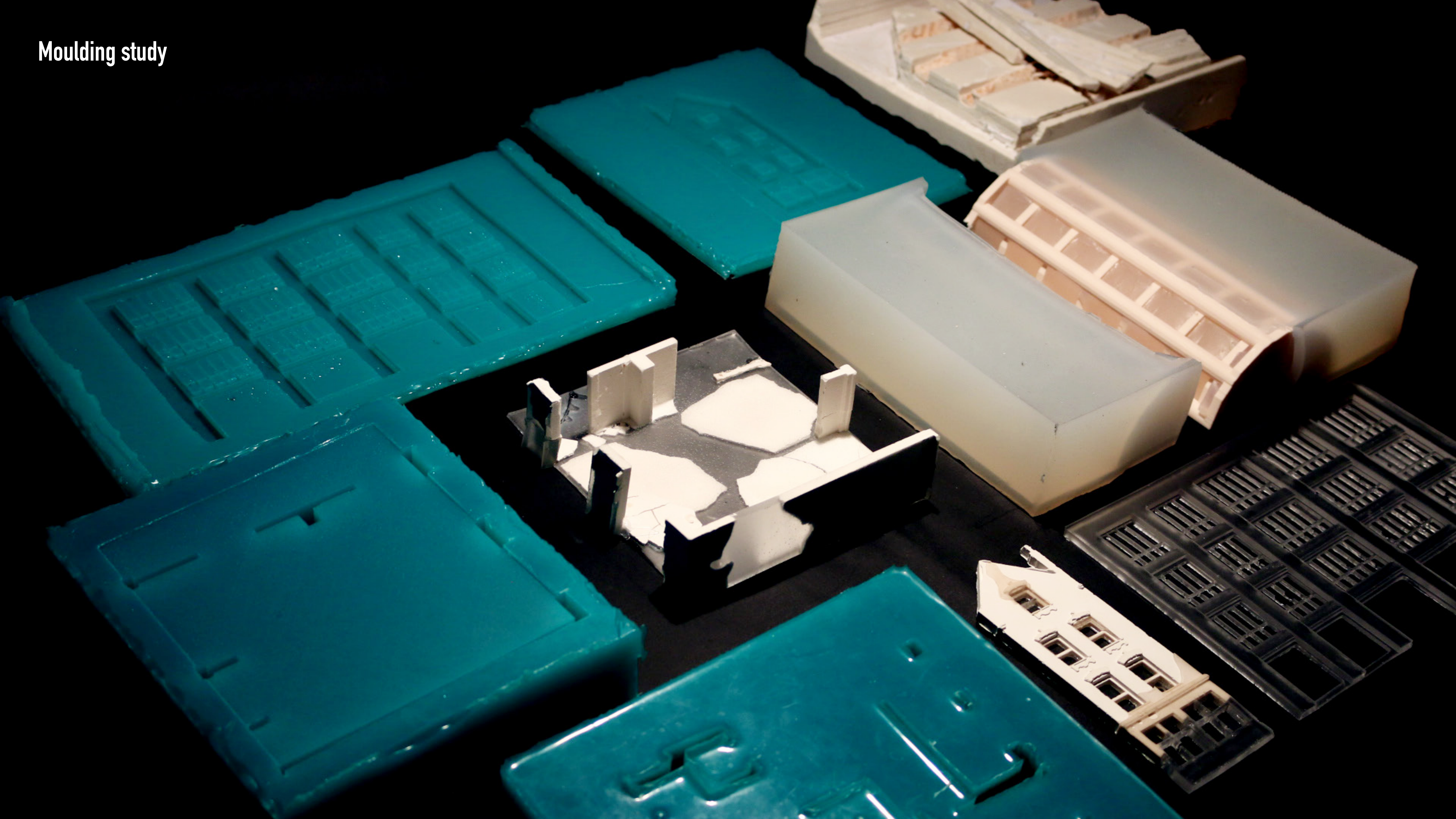

Imagine with AI (prompt)

 /imagine prompt / Interior design inspired by Casting mould. Negative space, Pipe and brick.



Imagine with AI (prompt & Rendering)

 /imagine prompt / Interior design inspired by Casting mould. Negative space, Pipe and brick.

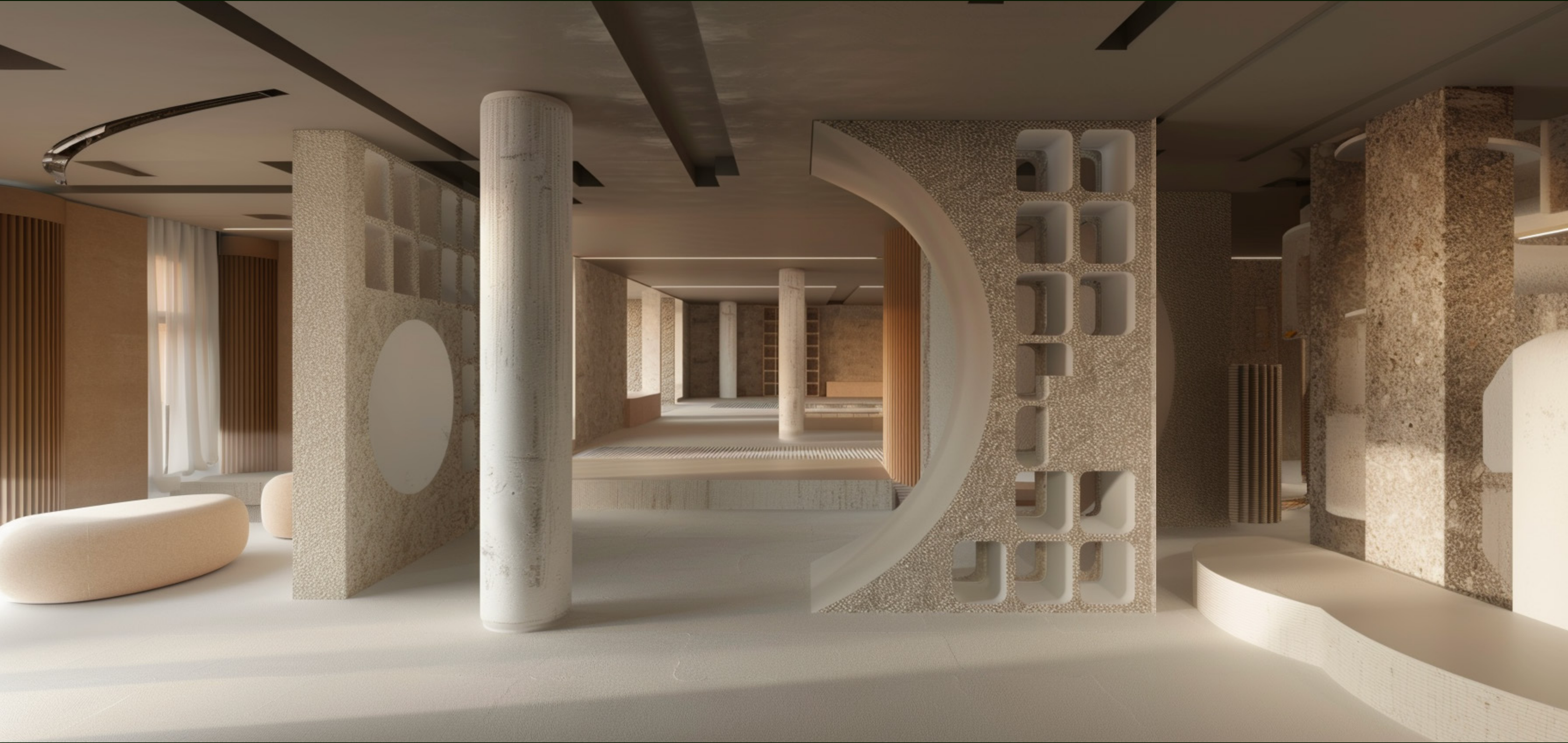

Plan ideation & Sketch

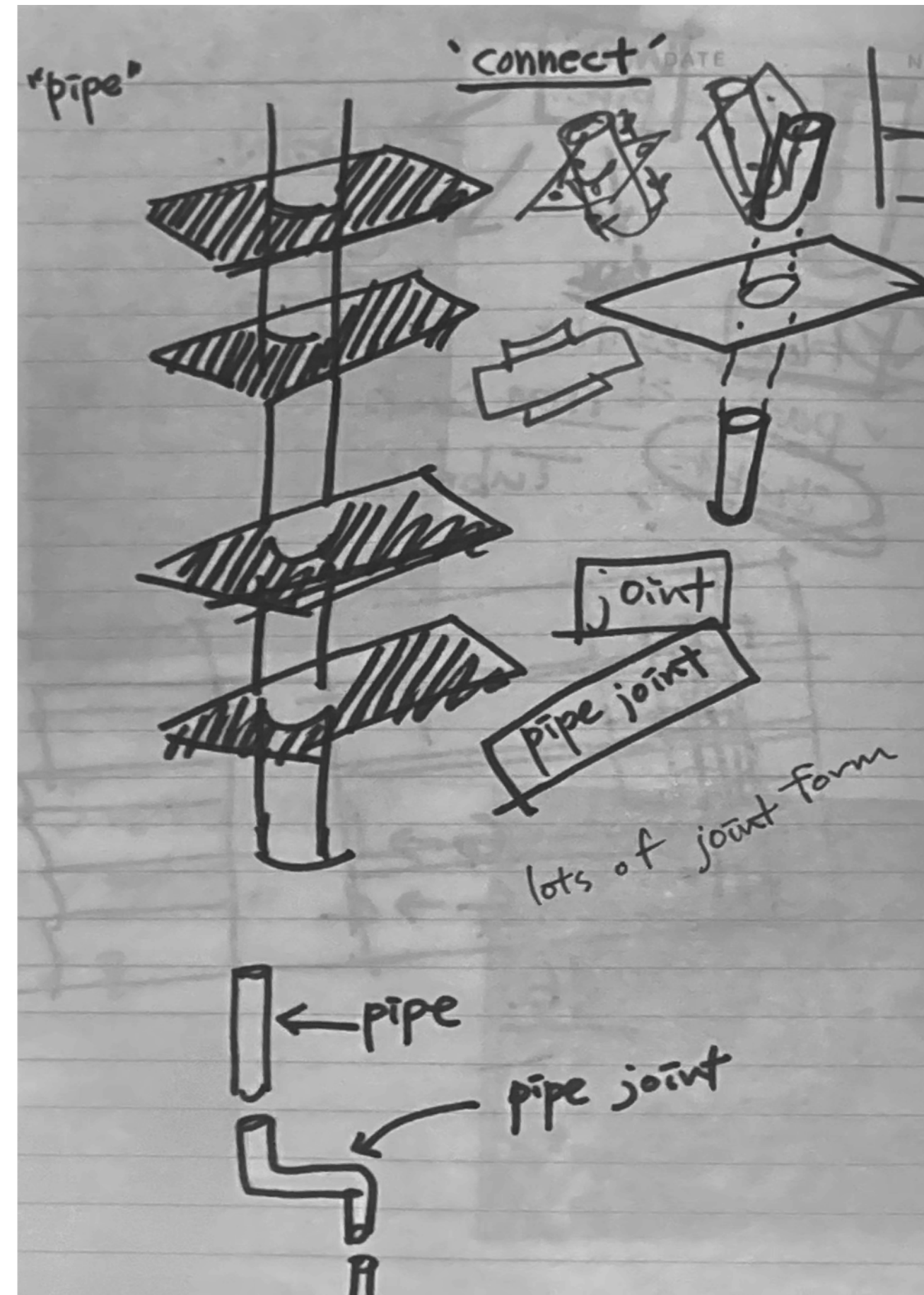
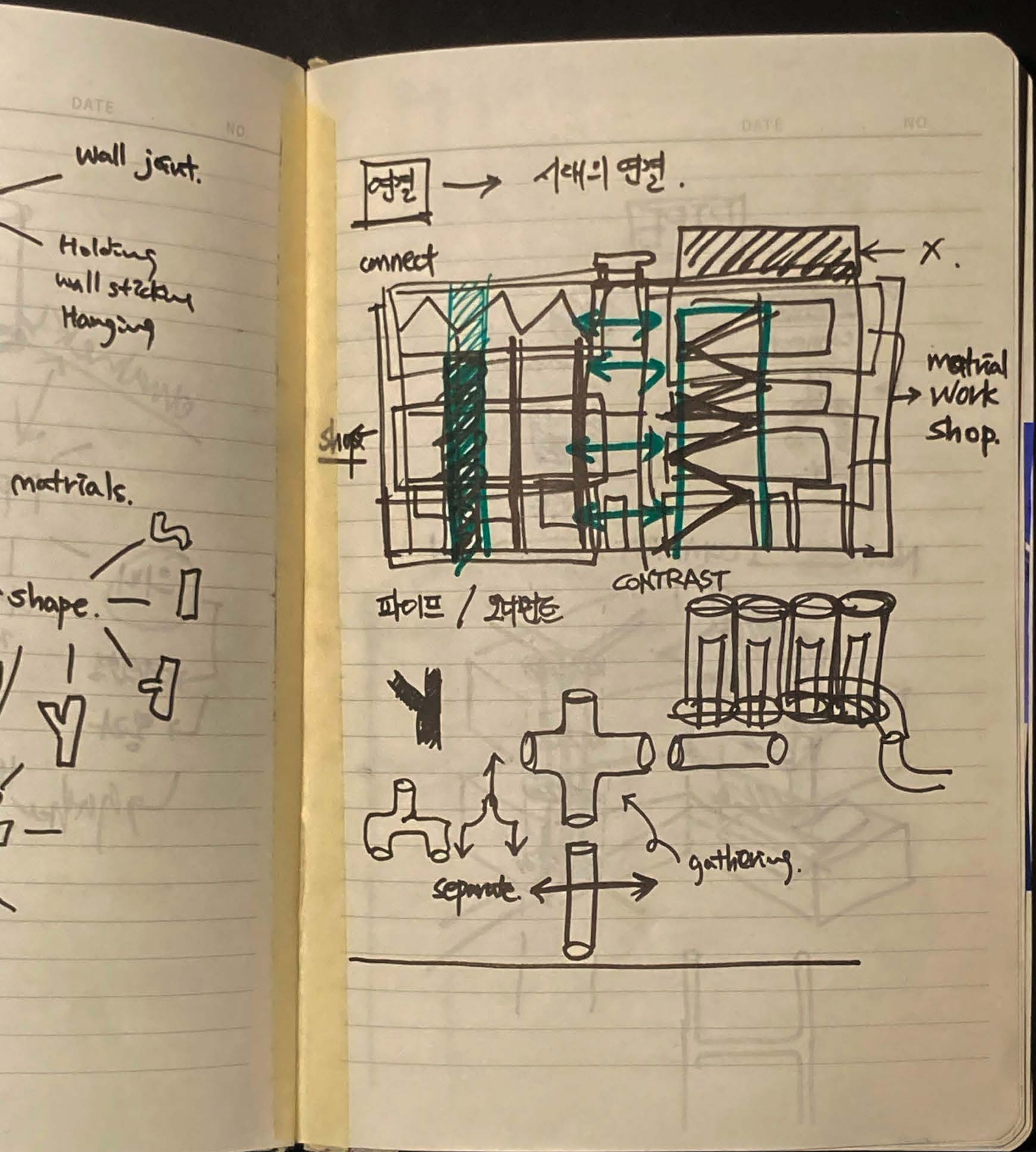

Inspired by connection between old (cast iron) pipes and new (cast plastic) pipes.

Section plan



Section plan with Carbon Footprint of Building Materials

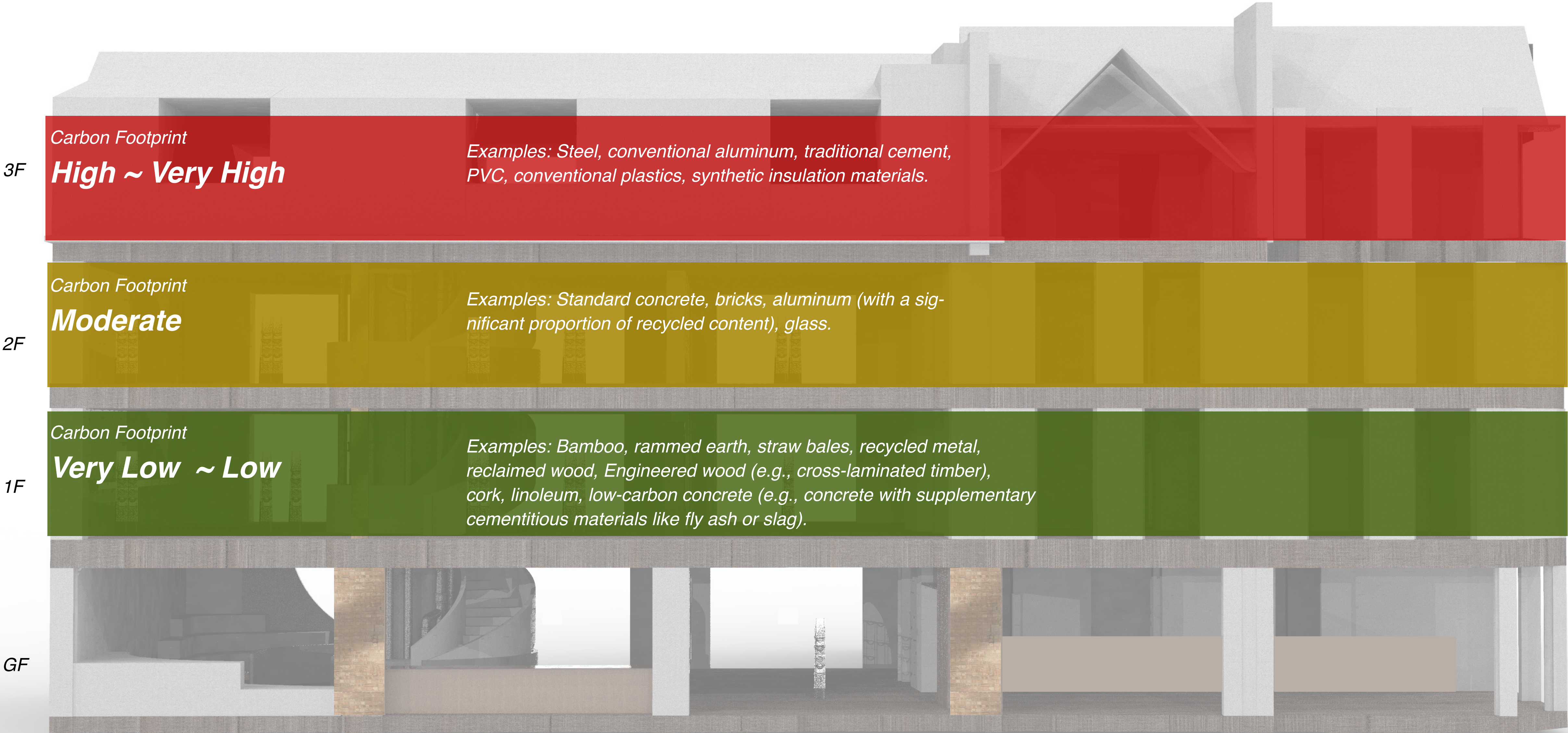

Floor plan - Ground floor

Material shop, Cafe, and Cafe Lounge

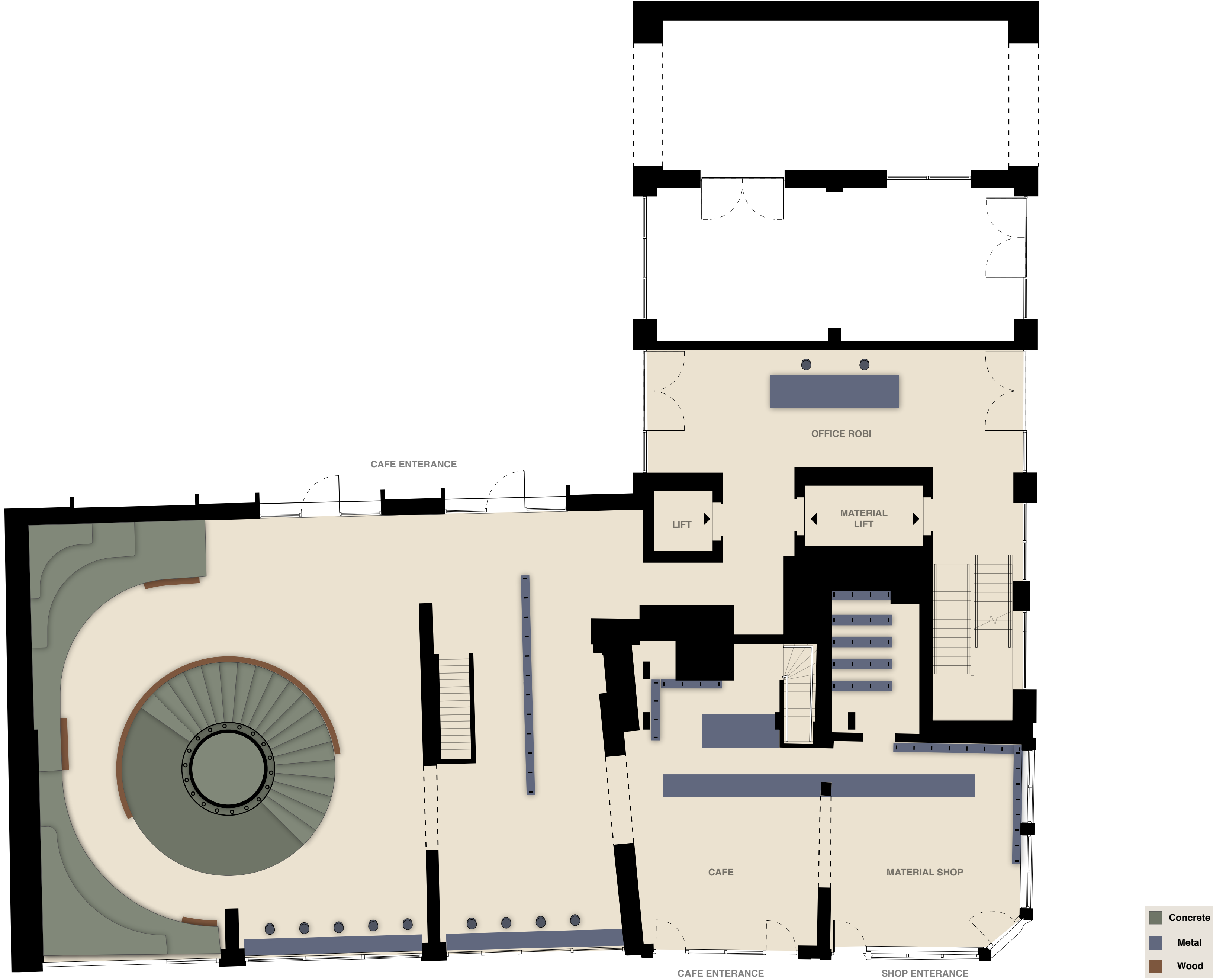

Floor plan - 1F & 2F

Material Library and Material warehouse

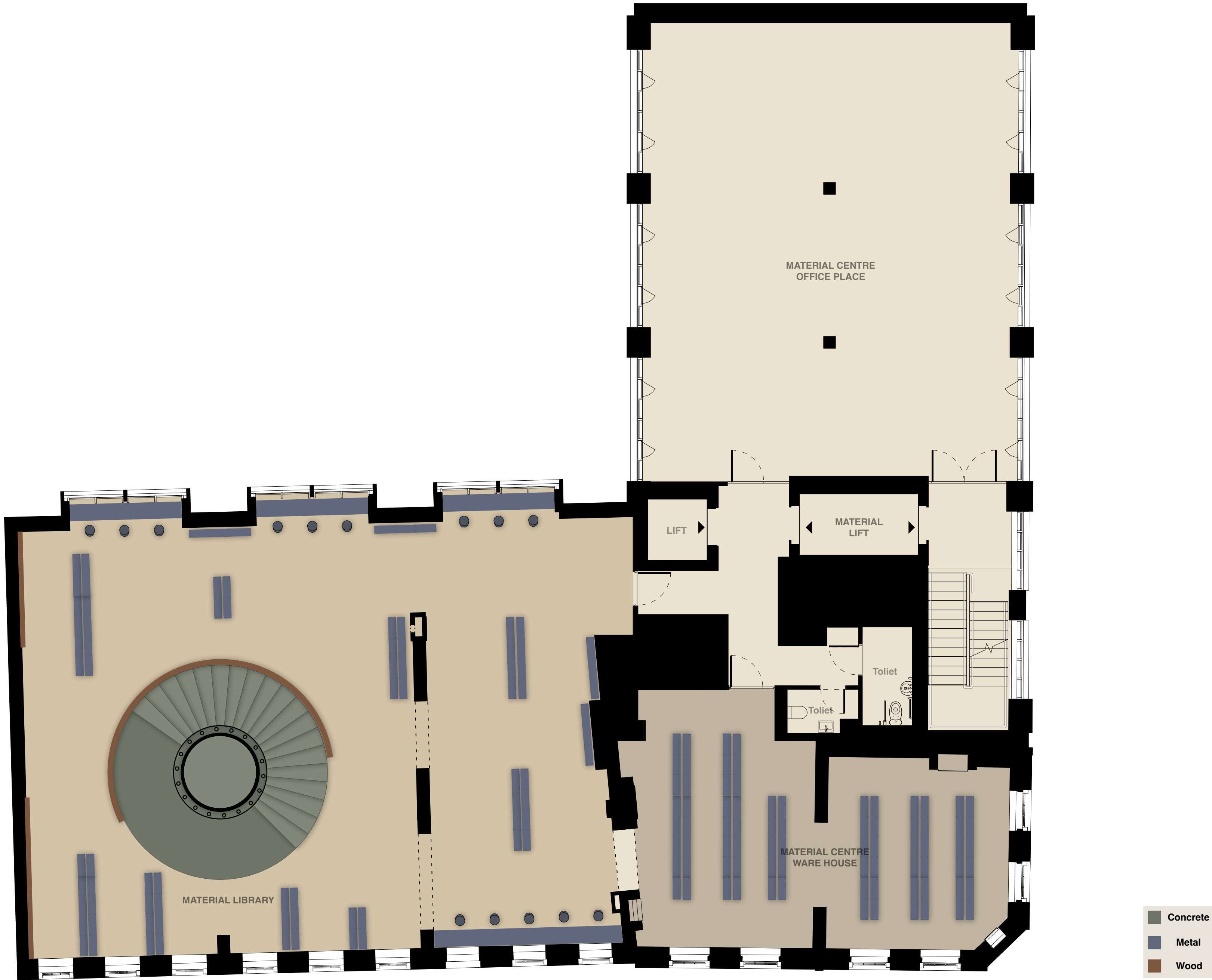

Material palette with AI

Old materials

- Wasted cast-iron pipes
- Cast-iron tiles
- Bricks

New materials

- Aluminium
- Stainless buliding system parts
- Bolts and nuts
- Modern deco stones



Material palette with AI



Mid-journey image

Book-shelf for material display



Inspired by building system joint & design method



Mid-journey image

Book-shelf for material display

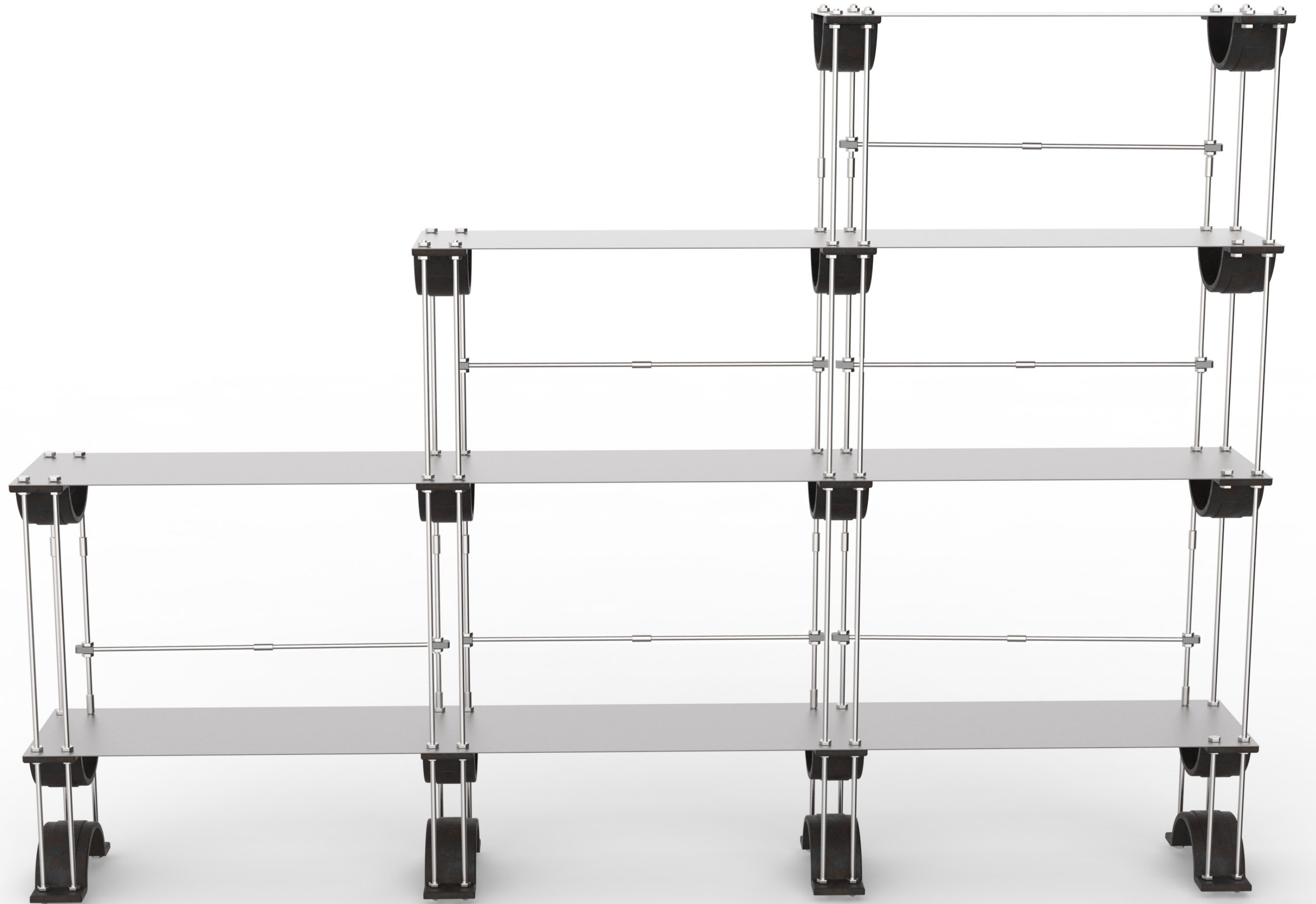
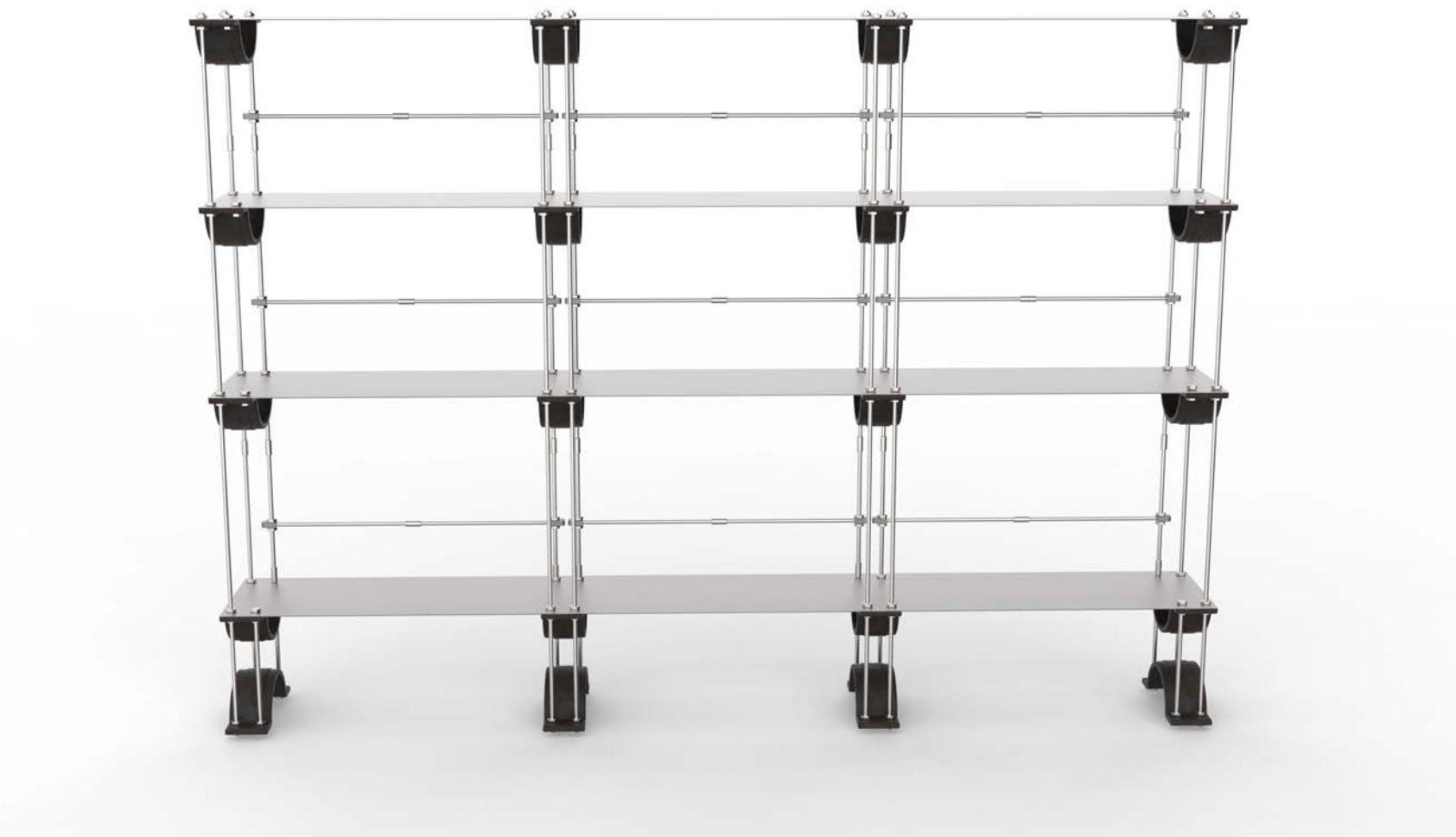

Chair design with wasted ornaments



Chair with wasted ornaments

LONDON
MATERIAL
CENTRE

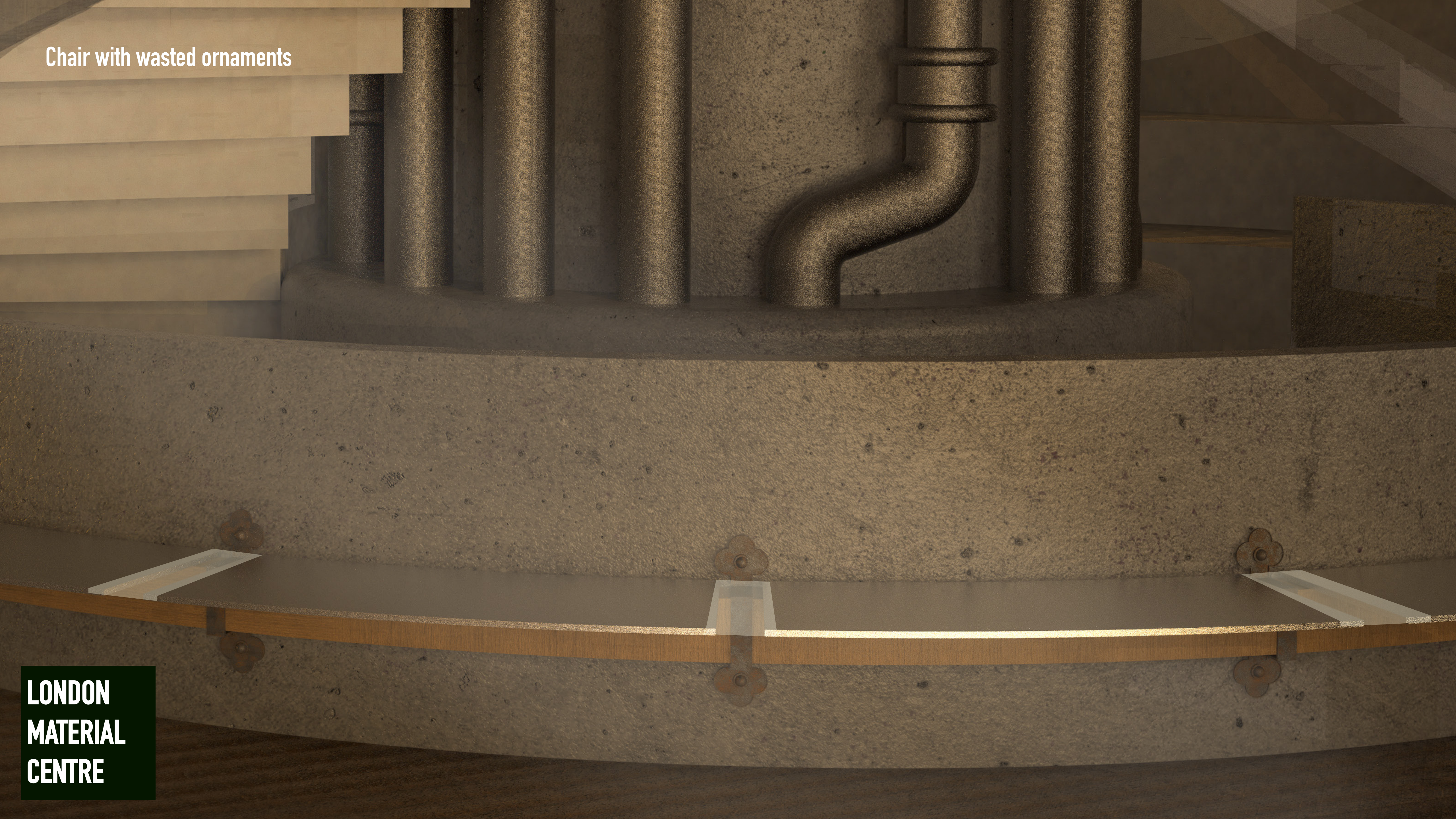

The London Material Centre is a material library that aims to sustain and preserve disappearing materials and designs. It stores and sells a variety of historic materials from modern and contemporary eras.

**LONDON
MATERIAL
CENTRE**

GF: Cafe lounge



**LONDON
MATERIAL
CENTRE**

1F: Material Library

**LONDON
MATERIAL
CENTRE**



The hidden beauty of building service



The hidden beauty of building services



The hidden beauty of building service

