

B R I X T O N
THE TAILORS

Bespoke

custom suits, made according to the needs of the individual





Precision



Sophistication

Afro-Caribbean

a person who comes from, or whose family comes from, the Caribbean and is a member of a group of people originally from Africa



Africanism

a feature of language or culture regarded as characteristically African,
redefined African luxury





Richness



Vibrancy



Brixton

A district of south London. It is well known as one of the most multicultural parts of London, with large communities of Afro-Caribbean people, and smaller communities from many European, African and Asian countries.

History of Brixton

In the 1870s, the Chatham Main Line was built, which linked Brixton to the centre of London, and transformed Brixton into a middle class suburb between the 1860s and 1930s. The railway brought about a boom in infrastructure, and shopping center, marketplaces, theaters and music halls sprung up in the area. But, Brixton was unprepared for WWII, and much of the neighborhood was destroyed.

The first wave of immigrants (492 individuals) who formed The British African-Caribbean community arrived in 1948 at Tilbury Docks on the HMT Empire Windrush from Jamaica. They were temporary housed in the Clapham South deep shelter. As they settled in, they began to transform the neighborhood — they sold yams, plantains and green bananas at the marketplace and introduced their colorful wax fabric. But, deep social and economic problems—high unemployment, high crime, poor housing, no amenities — plagued the African-Caribbean community, and in April 1981, they rioted against the Brixton police.

After the riots, local authorities instated a rebuilding program in order to give the African-Caribbean community more opportunities and alleviate the social and economic programs. There is debate regarding whether Brixton's recent renaissance is regeneration or gentrification. Some believe the area has slowly undergone a process of gentrification since the 1990s and has resulted in many wealthy middle-class people taking advantage of the area's location and the thriving Bohemian art scene. However, others argue that the area is undergoing exciting regeneration.



Location

Brixton is 2.7 miles (4.3 km) south-southwest from the geographical centre of London near Brixton Underground station on the Victoria Line.







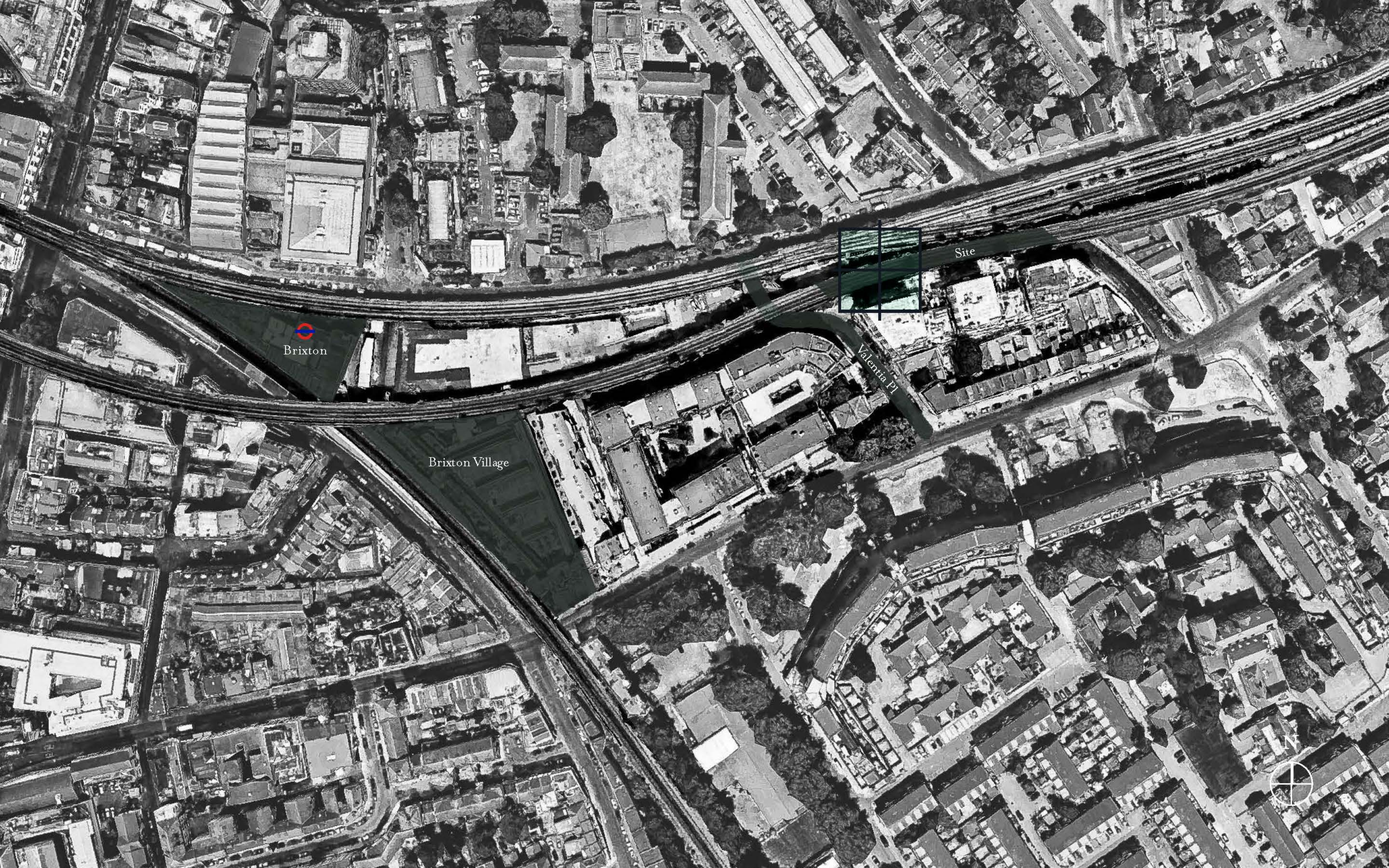

Brixton

Brixton Village

Site

Valentia Pl



The Arch

The raily way arches are located between Valentia Road and Gresham Road.







West

East

Taylor Wimpey
taylorwimpey.com

JLC
Constructio

EK66 RDY



Tailor Made



Detail

A dark, textured wall with a gold-colored rectangular frame. The wall has a fine, repeating pattern of small, dark, curved lines. The frame is composed of thin, gold-colored lines forming a rectangle. The text "Dark & Warm" is centered in the upper portion of the frame.

Dark & Warm

A close-up of a dark green, draped fabric. The fabric has a soft, velvety texture and is shown in deep, vertical folds. The lighting creates highlights and shadows that emphasize the texture and the way the fabric hangs.

Soft

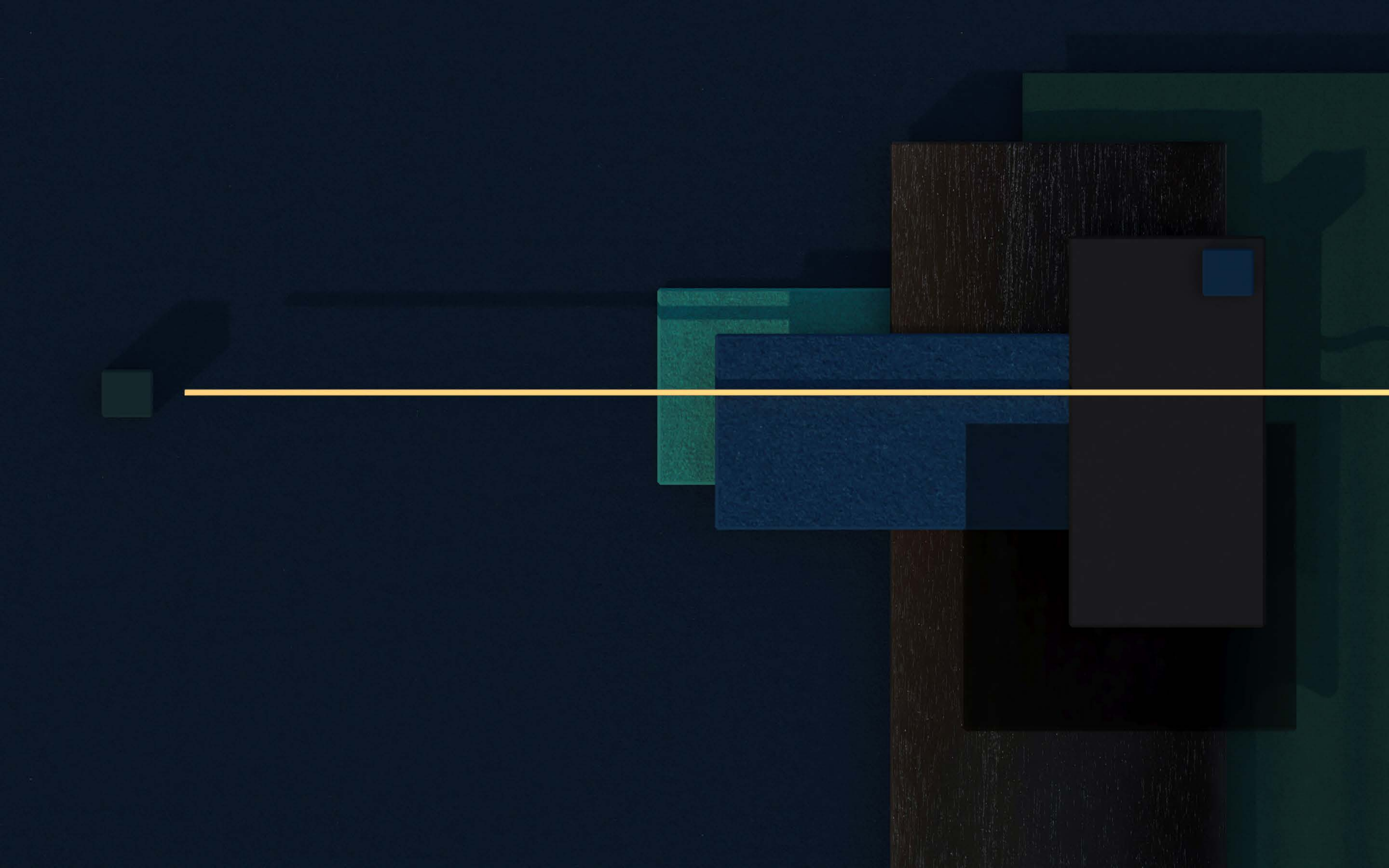

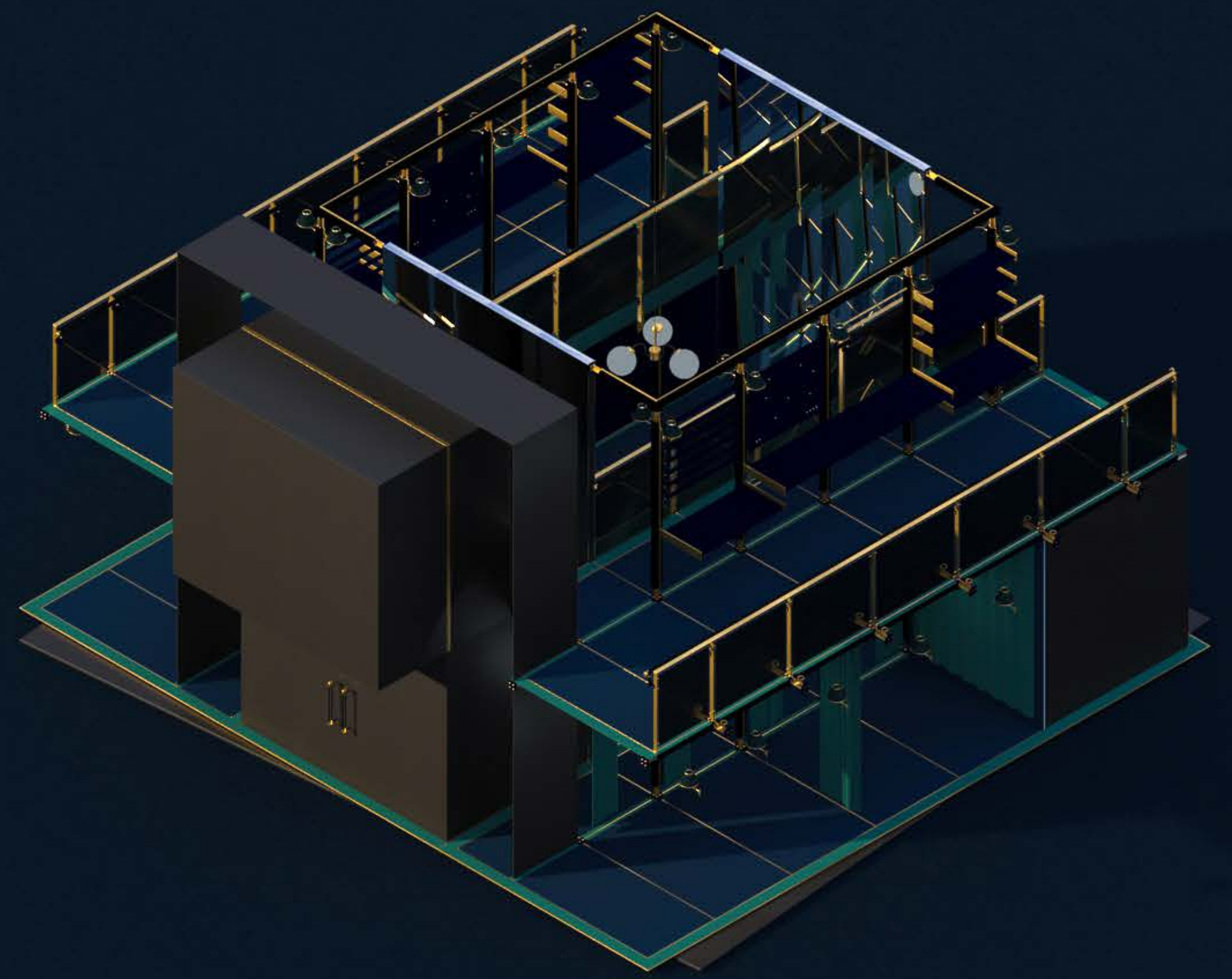
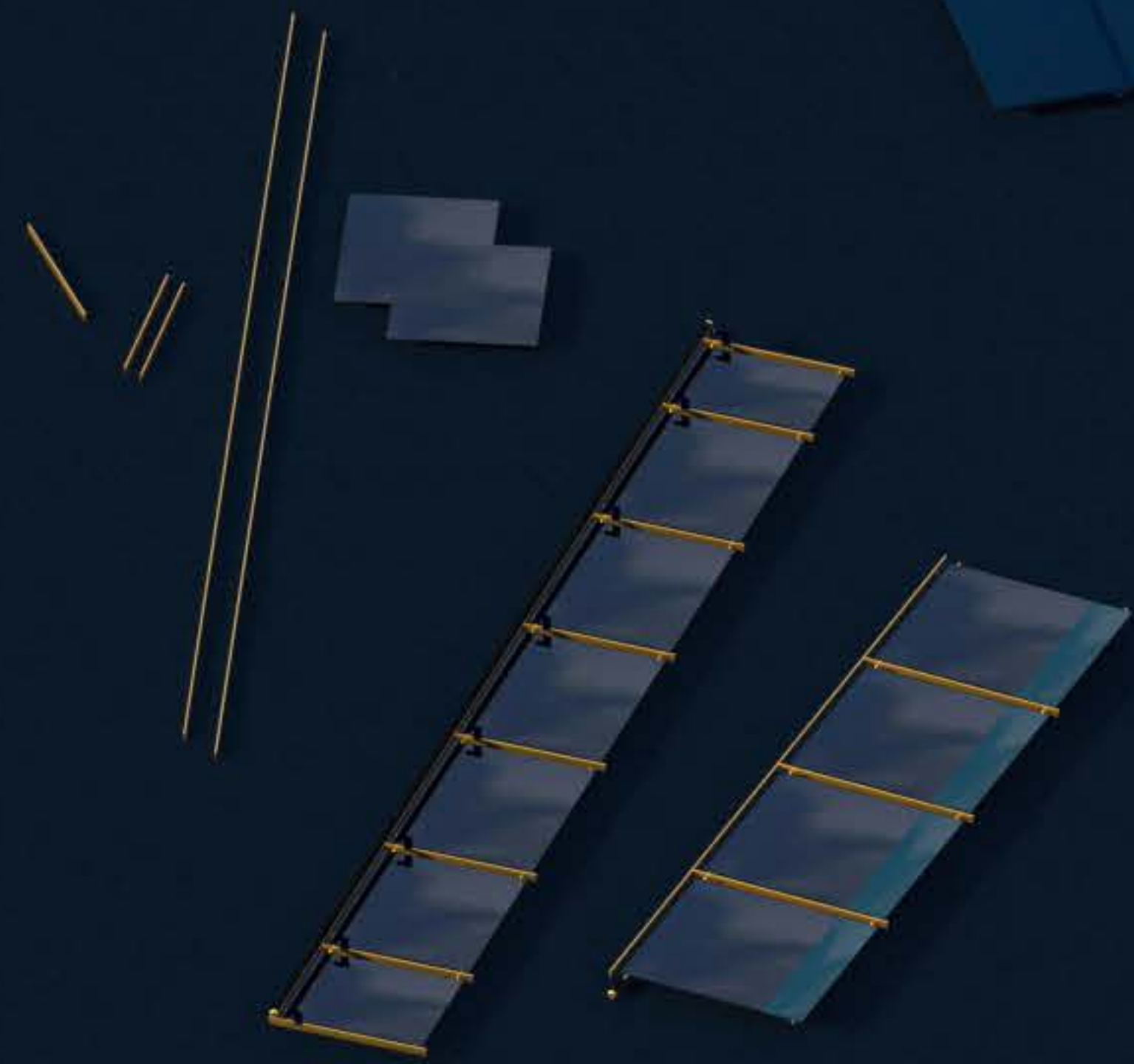
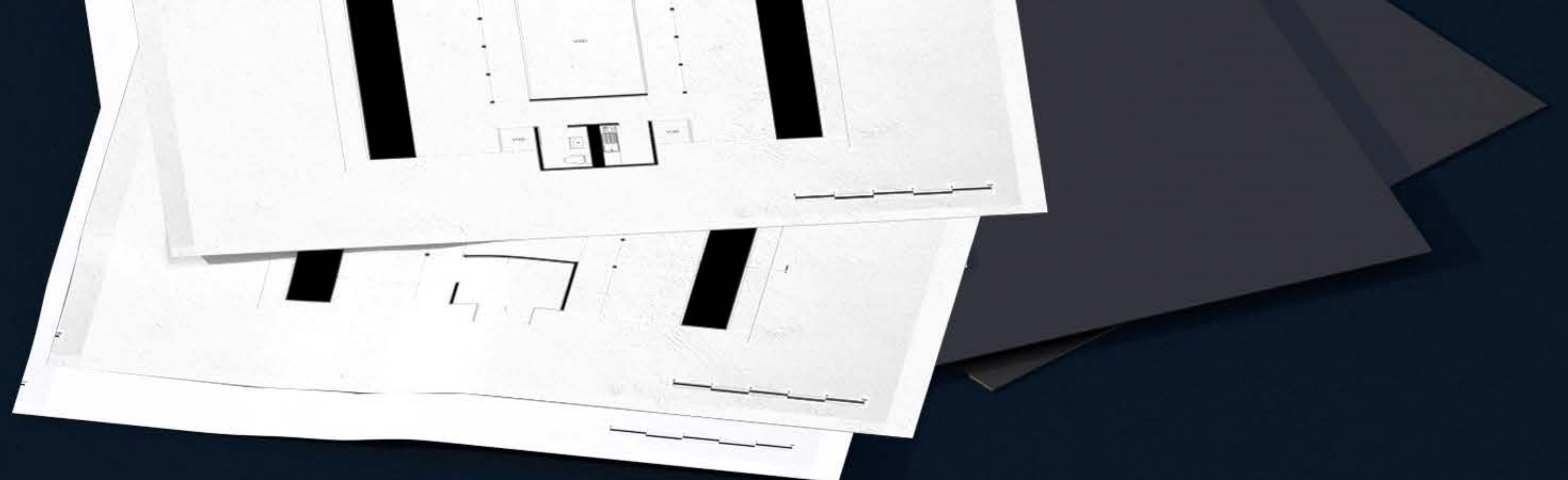
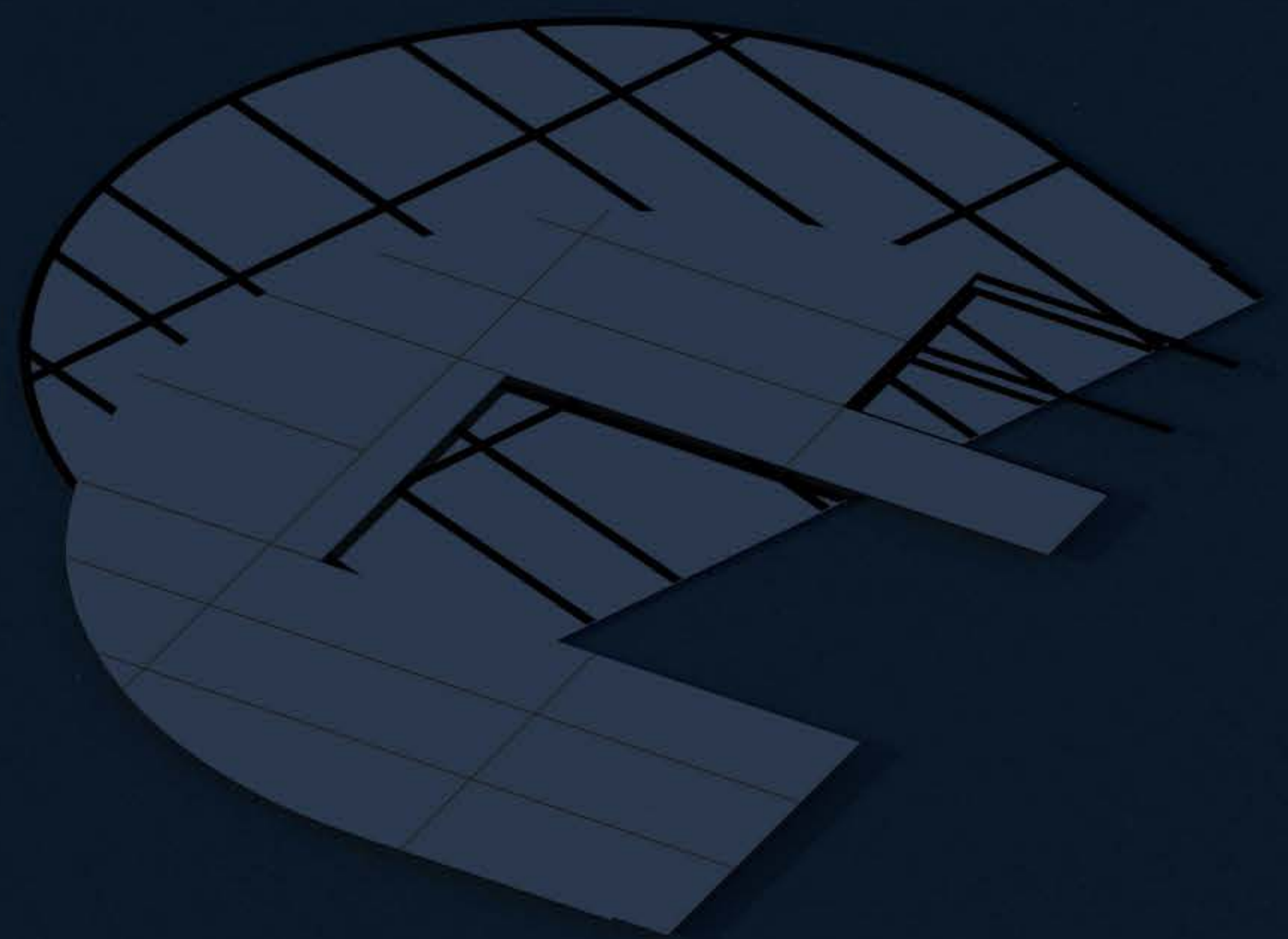

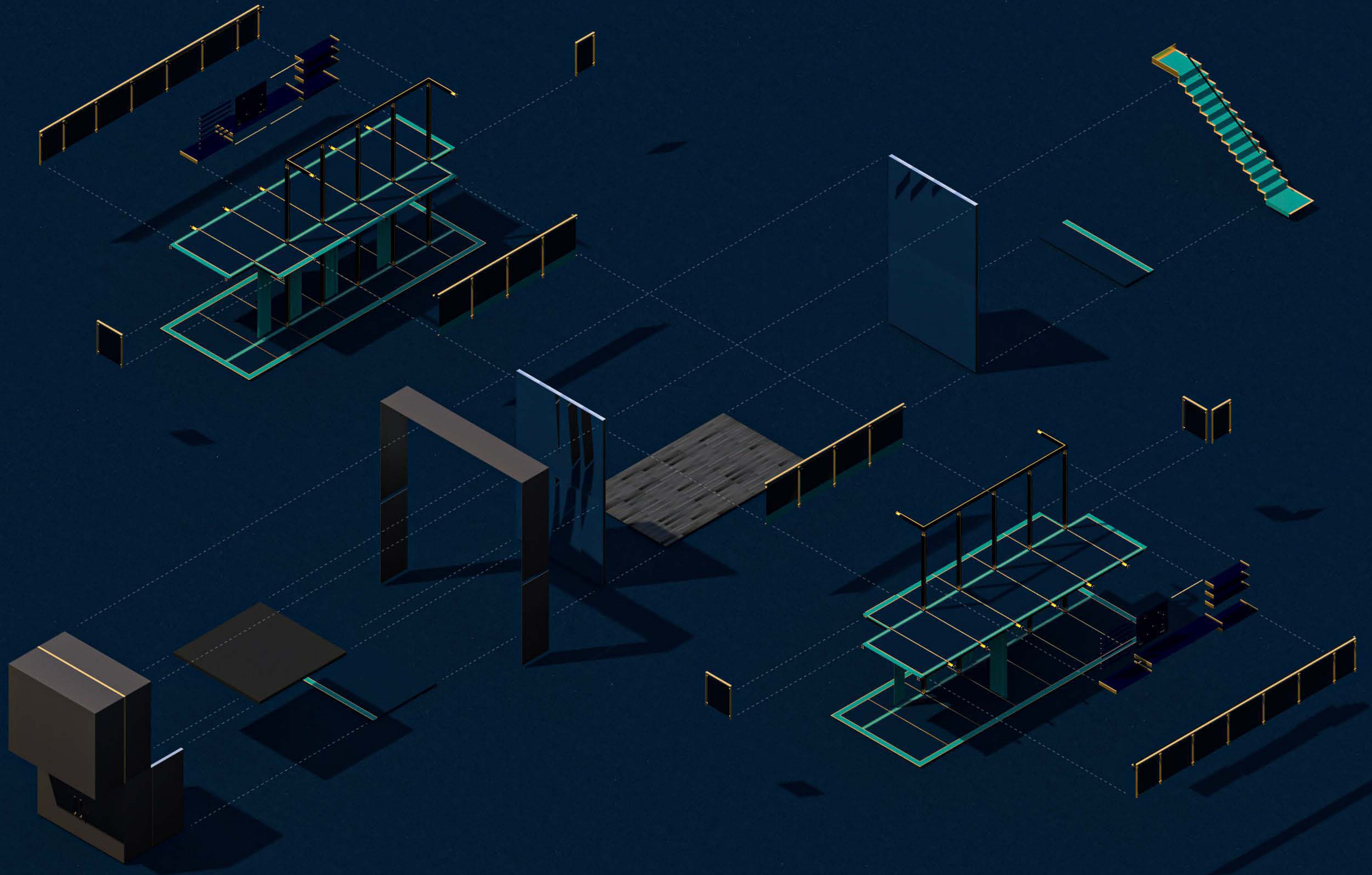



Ground Floor



First Floor







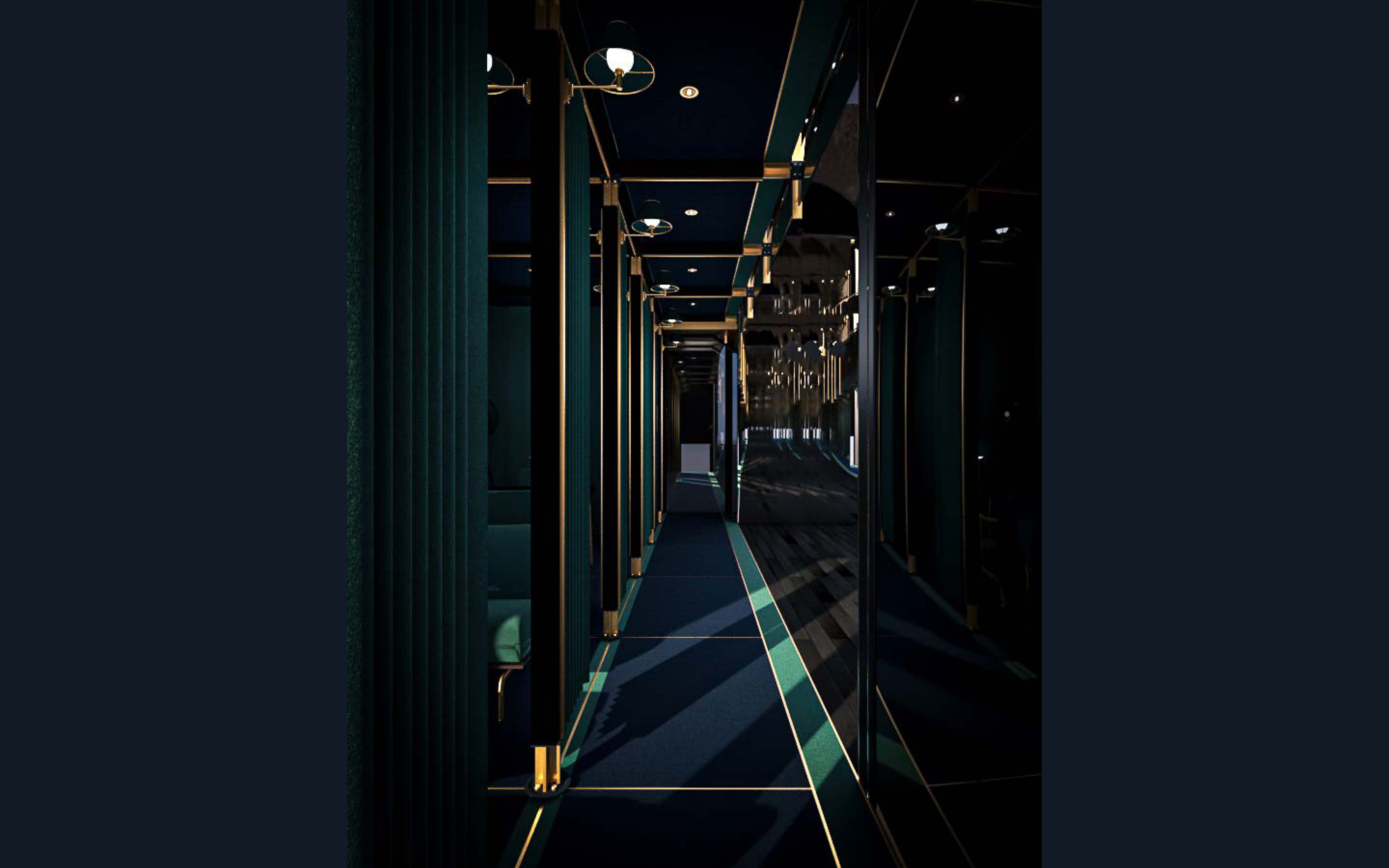













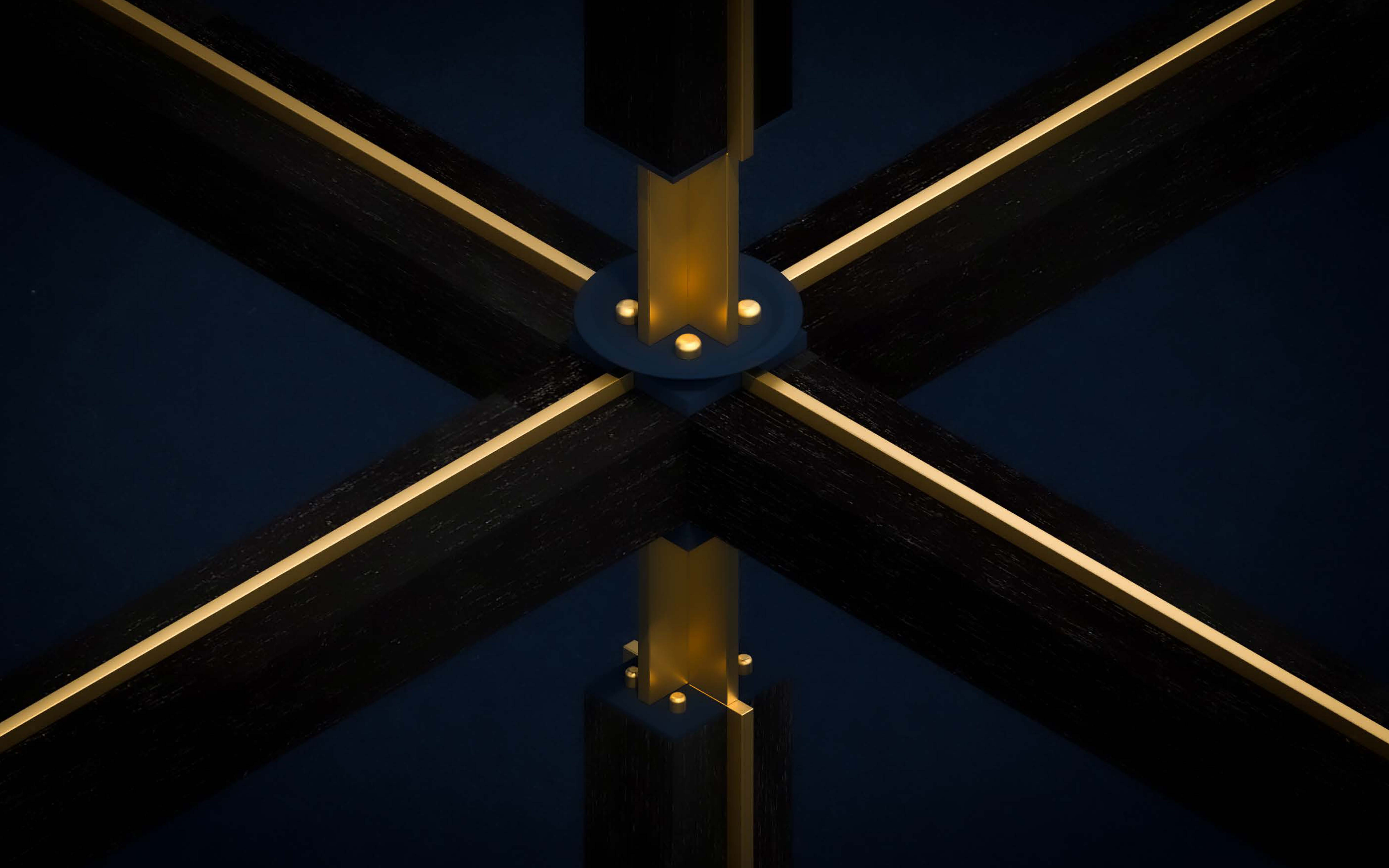

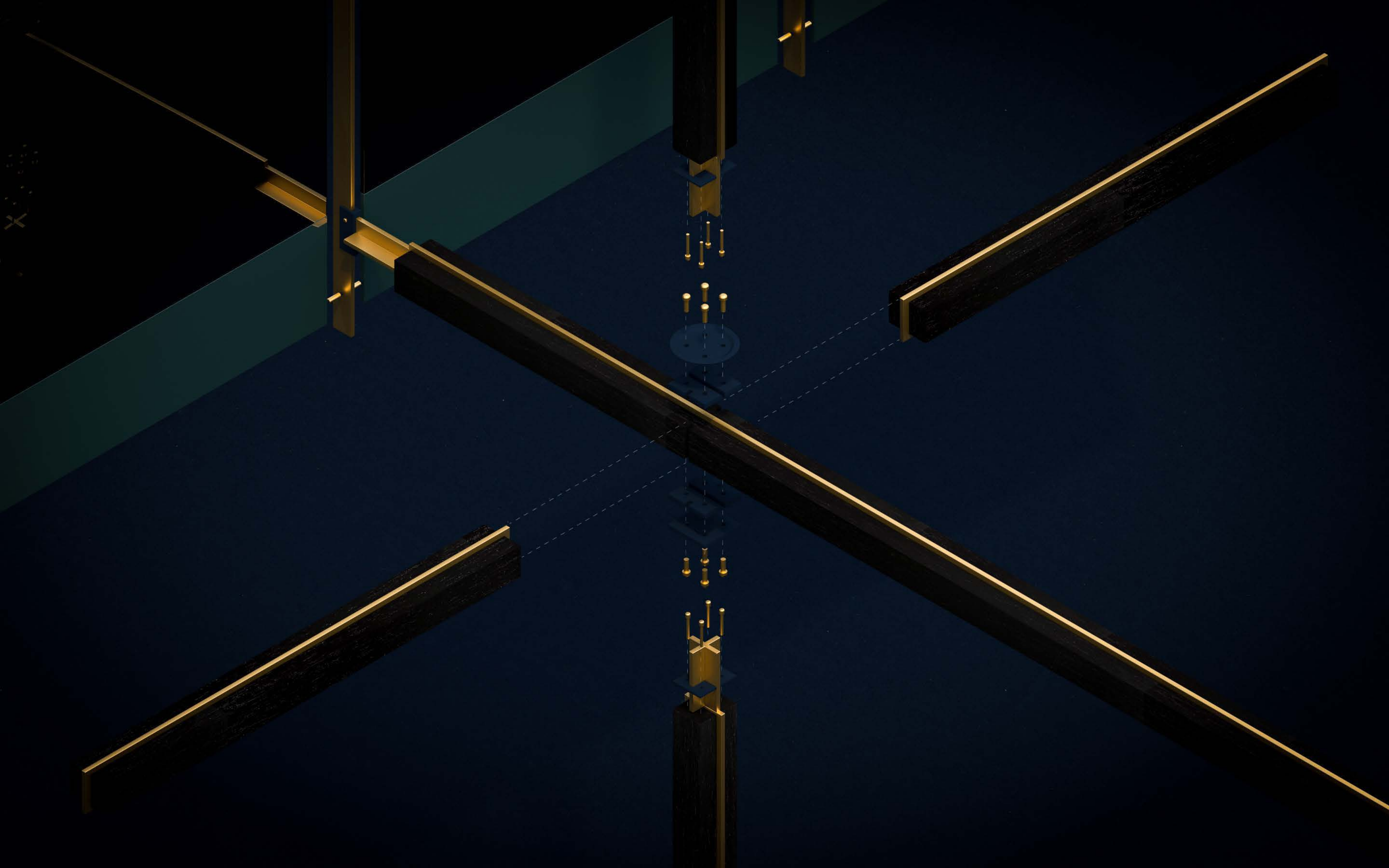

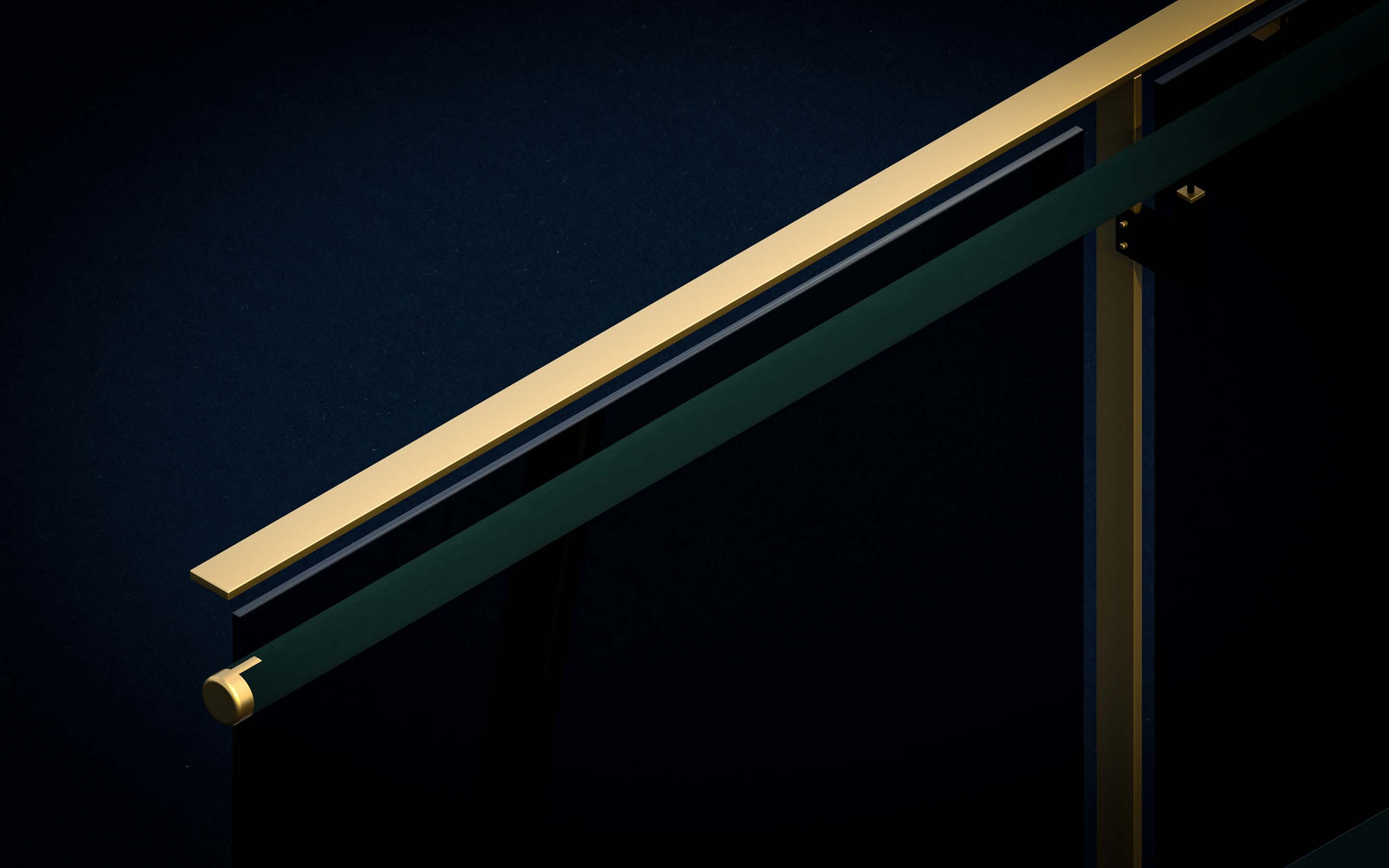

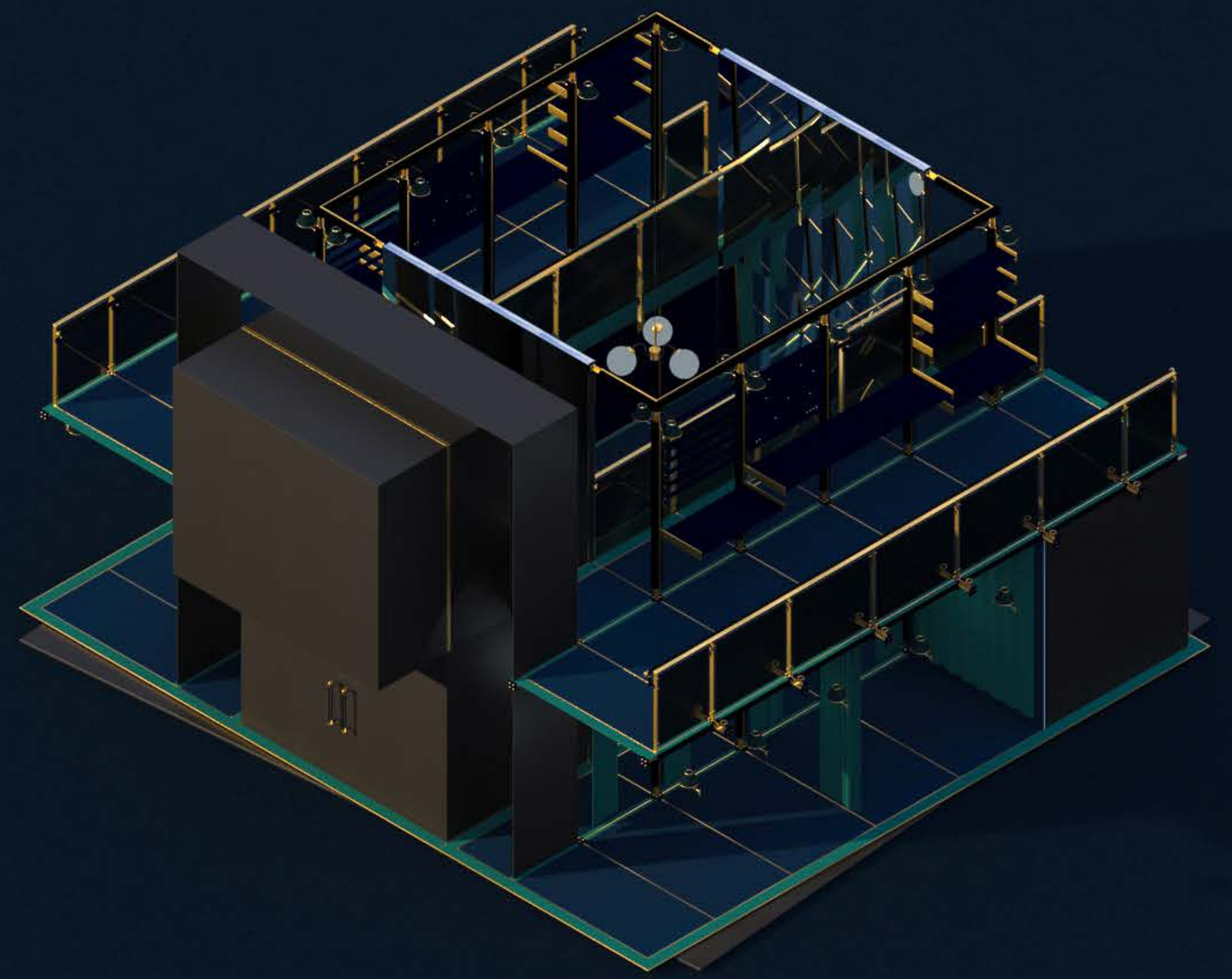
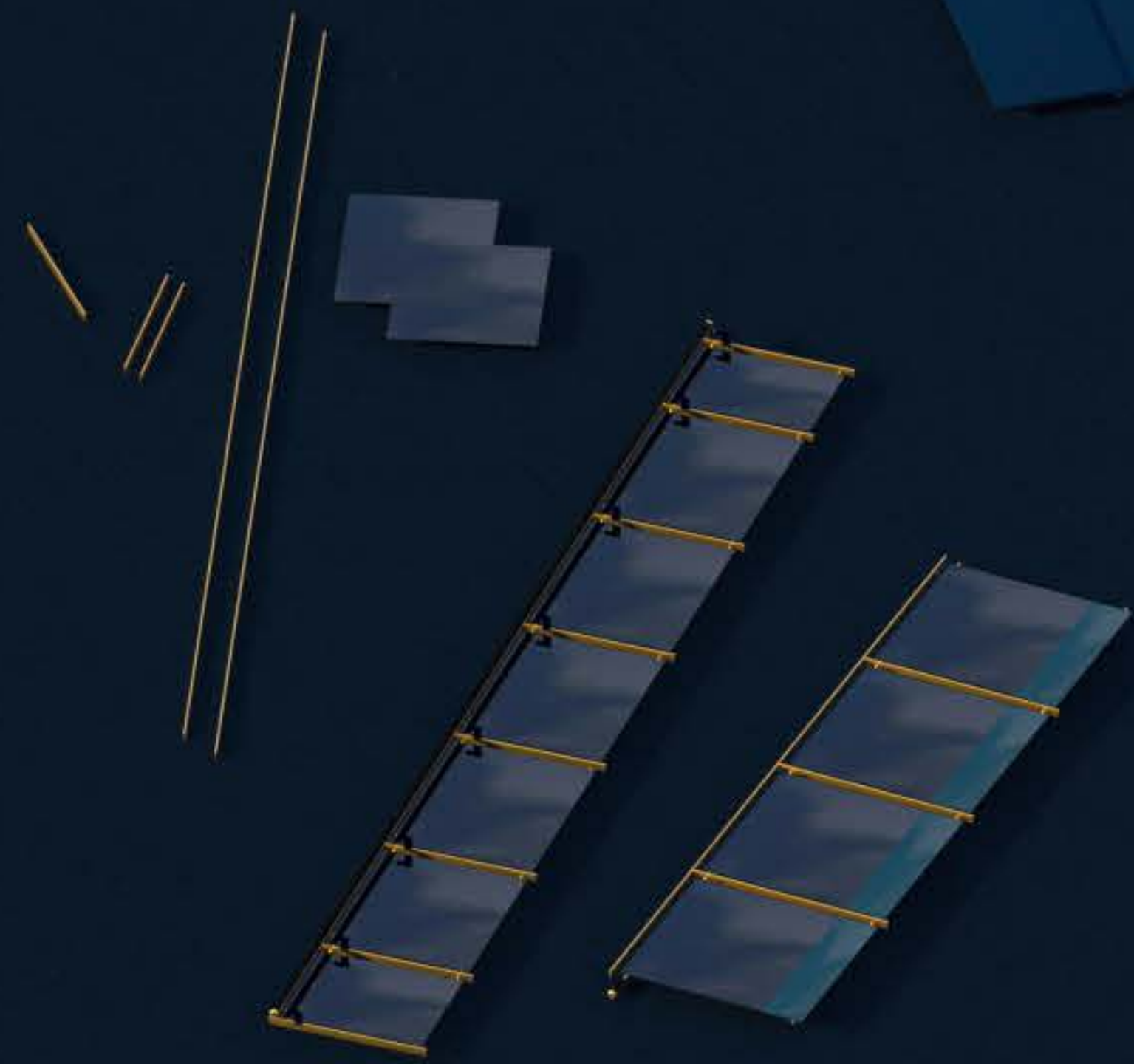
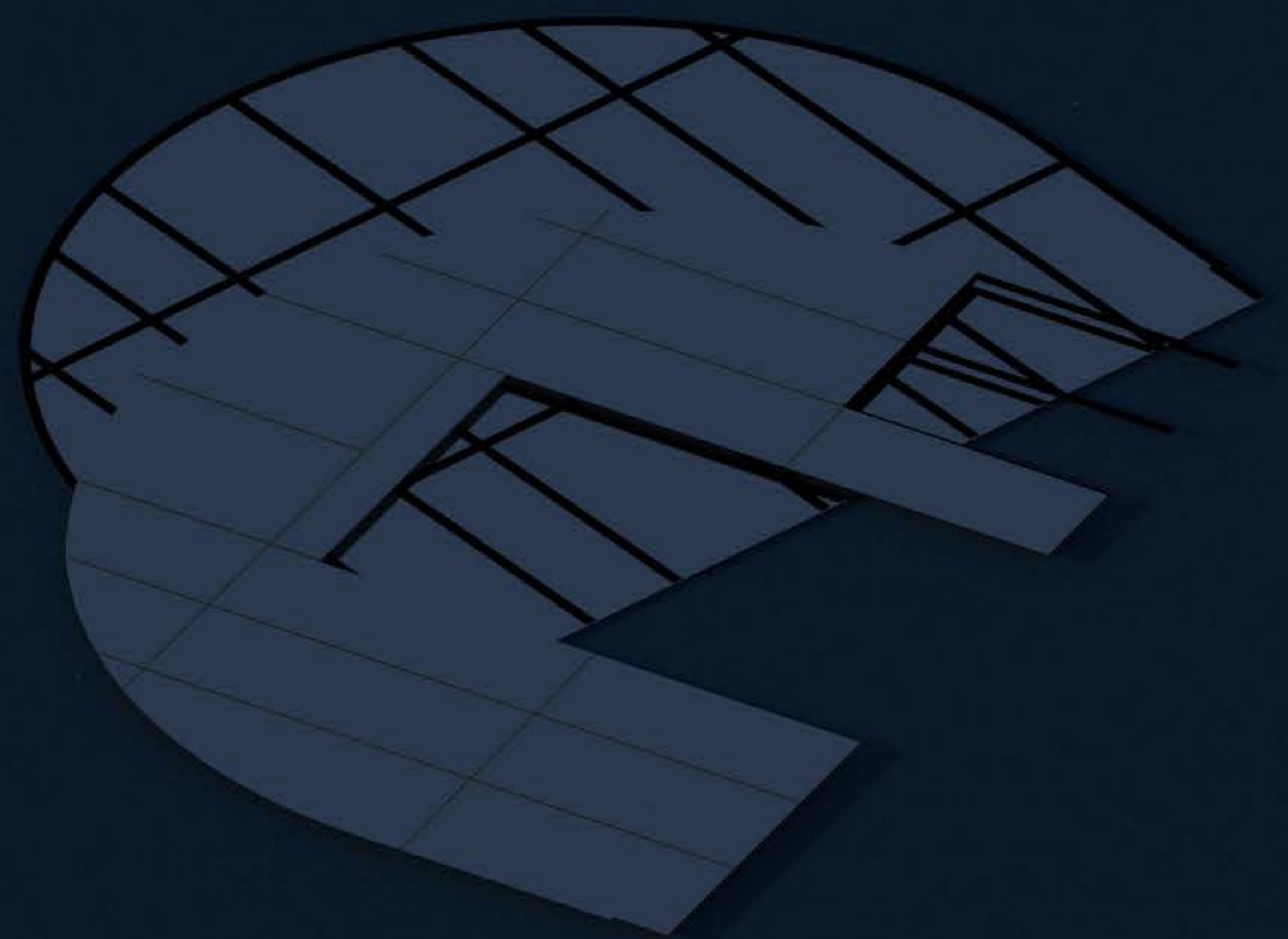

B R I X T O N
THE TAILORS